

F.A.I. RTE.	SECTION	COUNTY	TOTAL SHEETS	SHEET NO.
57	2122-B	COOK	75	12
STA.		TO STA.		
FED. ROAD DIST. NO.	ILLINOIS	FED. AID PROJECT		

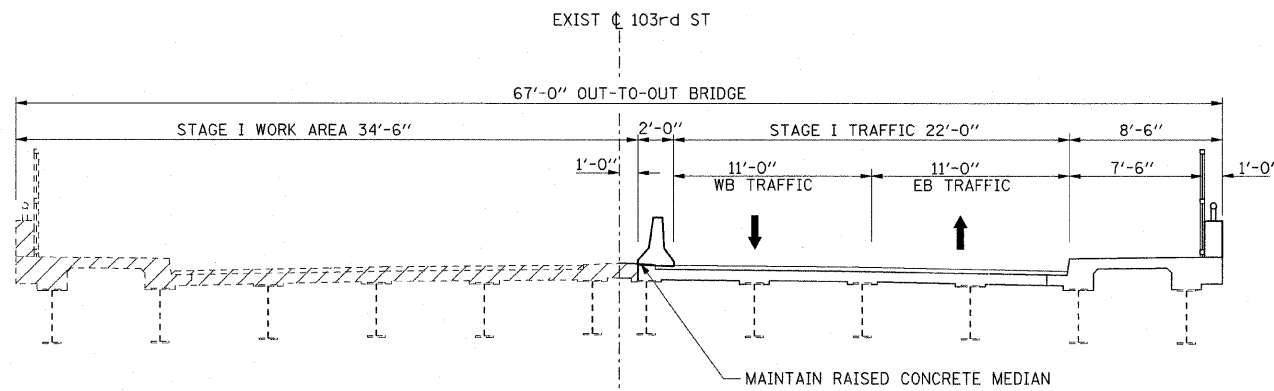

STAGE I
(LOOKING EAST)

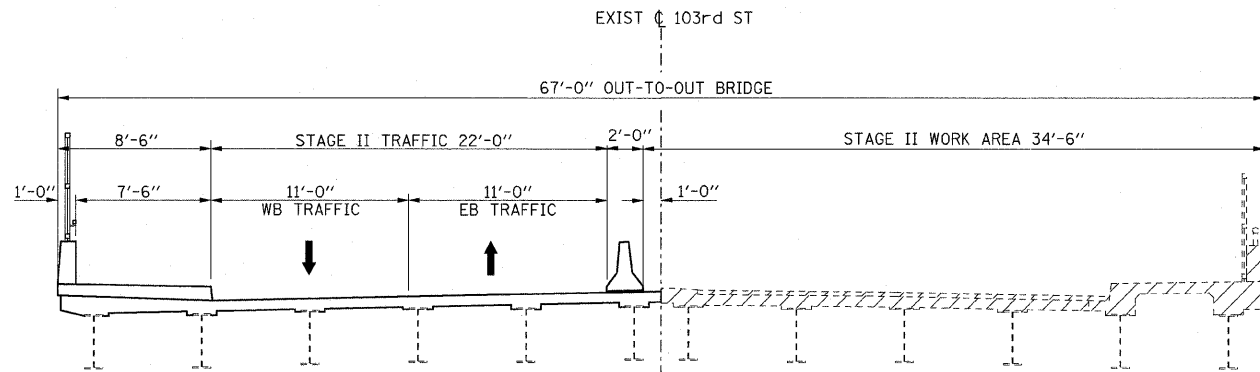

STAGE II
(LOOKING EAST)

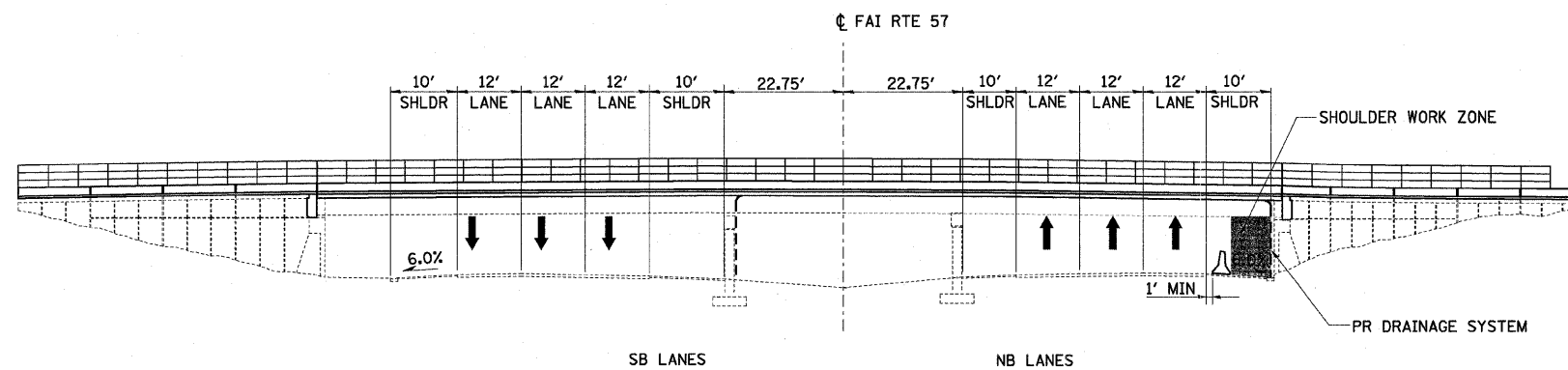

I-57 TYPICAL SECTION
STAGES I AND II

TRUCK ROUTE

R14-1
(30 X 24 IN)

3

DETOUR



M4-9
(30 X 24 IN)

1

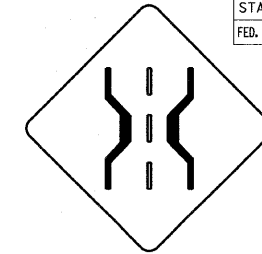

W5-2g
(36 X 36 IN)

2

DETOUR



M4-9
(30 X 24 IN)

5

END DETOUR

M4-8A
(24 X 18 IN)

4

TEMPORARY SIGN ASSEMBLY DETAILS
FOR OVERSIZE TRUCK DETOUR

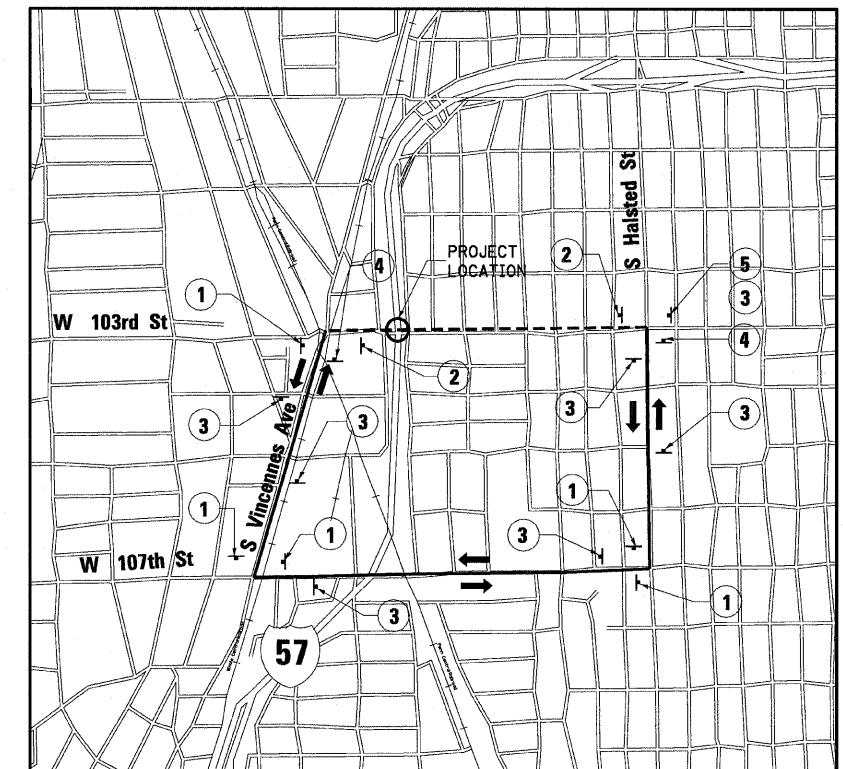

OVERSIZE TRUCK DETOUR ROUTE
NO SCALE

NOTE:

THE OVERSIZE TRUCK DETOUR SHALL BE PAID FOR AS "TRAFFIC CONTROL AND PROTECTION FOR TEMPORARY DETOUR" IN ACCORDANCE WITH THE SPECIAL PROVISIONS.

REVISIONS	
NAME	DATE

ILLINOIS DEPARTMENT OF TRANSPORTATION

**STAGE CONSTRUCTION
TYPICAL SECTIONS & DETOUR PLAN
103rd STREET
OVER FAI 57**

SCALE: NONE

DATE: 15-JAN-2009

DRAWN BY: T.W.K.

CHECKED BY: A.A.C.

Stanley Consultants INC.
650 West Higgins Road, Suite 730, Chicago, Illinois 60631-2801
www.stanleygroup.com
Illinois Firm Registration No. 04-00533
ITB 693-9624