

STATE OF ILLINOIS
DEPARTMENT OF TRANSPORTATION

ROUTE NO.	SECTION	COUNTY	STATE SHEETS	SHEET NO.	SHEET NO. 7 32 SHEETS
F.A.I. 57	★	COOK	75	35	
FED. ROAD DIST. NO. 7		ILLINOIS	FED. AID PROJECT		

Contract 60366
★ 2122B

NORTH EDGE OF PAVEMENT

Location	Station	Offset	Theoretical Grade Elevations
Bk W Appr Pvmt	Sta 4+36.817	-24.000	617.261
A	Sta 4+46.817	-24.000	617.194
B	Sta 4+56.817	-24.000	617.132
Bk W Closure Pour	Sta 4+61.817	-24.000	617.104

NORTH LANE LINE

Location	Station	Offset	Theoretical Grade Elevations
Bk W Appr Pvmt	Sta 4+36.817	-12.000	617.511
A	Sta 4+46.817	-12.000	617.444
B	Sta 4+56.817	-12.000	617.382
Bk W Closure Pour	Sta 4+61.817	-12.000	617.354

☉ 103rd STREET & PG

Location	Station	Offset	Theoretical Grade Elevations
Bk W Appr Pvmt	Sta 4+36.817	0.000	617.699
A	Sta 4+46.817	0.000	617.632
B	Sta 4+56.817	0.000	617.570
Bk W Closure Pour	Sta 4+61.817	0.000	617.541

SOUTH LANE LINE

Location	Station	Offset	Theoretical Grade Elevations
Bk W Appr Pvmt	Sta 4+36.817	12.000	617.511
A	Sta 4+46.817	12.000	617.444
B	Sta 4+56.817	12.000	617.382
Bk W Closure Pour	Sta 4+61.817	12.000	617.354

SOUTH EDGE OF PAVEMENT

Location	Station	Offset	Theoretical Grade Elevations
Bk W Appr Pvmt	Sta 4+36.817	24.000	617.261
A	Sta 4+46.817	24.000	617.194
B	Sta 4+56.817	24.000	617.132
Bk W Closure Pour	Sta 4+61.817	24.000	617.104

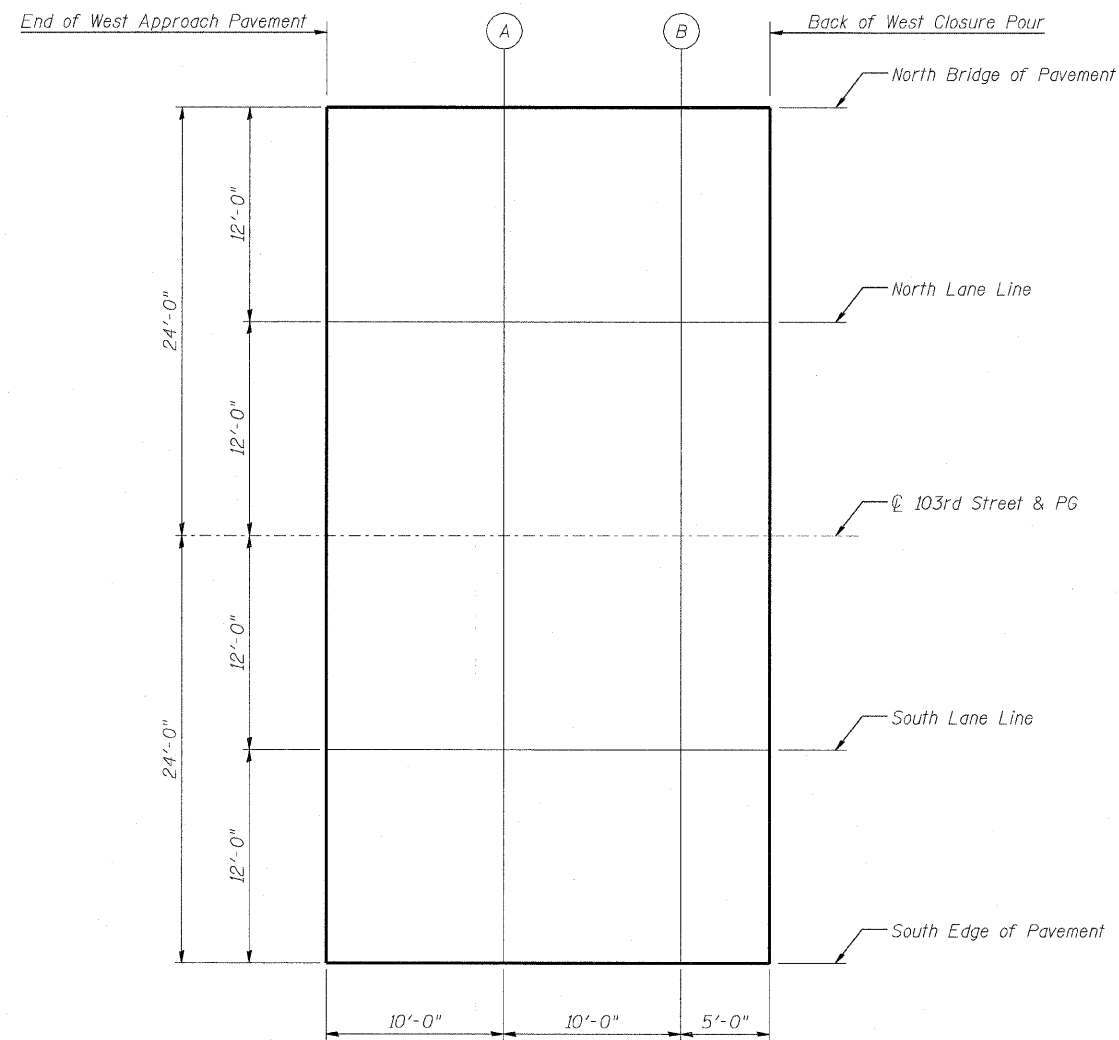

PLAN

DESIGNED	NDR
CHECKED	DSE
DRAWN	RTT
CHECKED	DSE
DATE	JAN 16, 2009

E-AS 10-1-08

Illinois Firm Registration No. 04-00533



TOP OF WEST APPROACH SLAB ELEVATIONS
103RD STREET OVER
FAI 57 (DAN RYAN-WEST LEG)
FAI RTE 57 SECTION 2122B
COOK COUNTY
STA 5+47.40
STRUCTURE NO 016-2127