

F.A.I.	SECTION	COUNTY	TOTAL SHEETS	SHEET NO.
57	1919.2B	COOK	119	21
FED. ROAD DIST. NO.		ILLINOIS FED. AID PROJECT		
CONTRACT 60371				

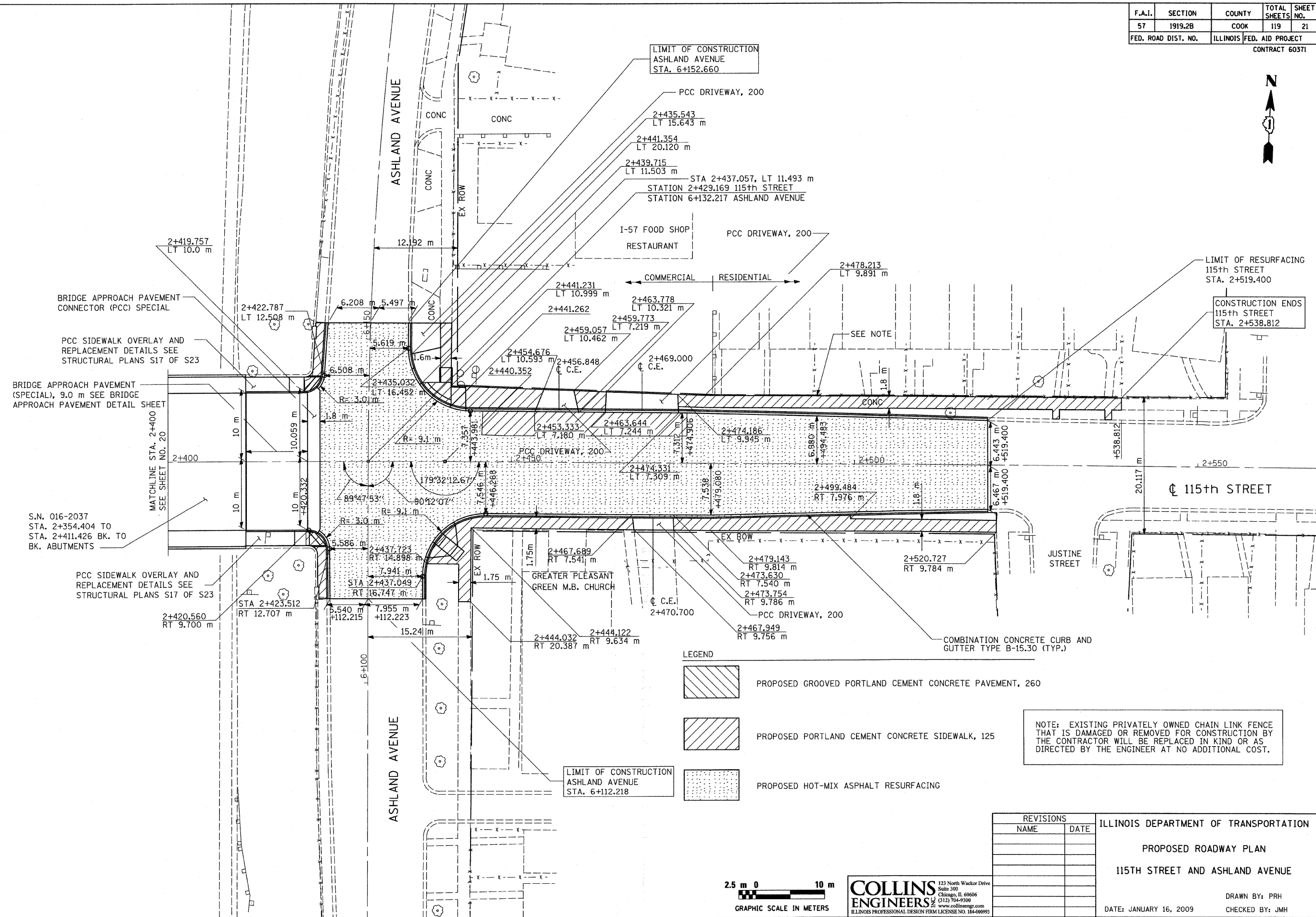

BRIDGE APPROACH PAVEMENT CONNECTOR (PCC) SPECIAL

PCC SIDEWALK OVERLAY AND REPLACEMENT DETAILS SEE STRUCTURAL PLANS S17 OF S23

BRIDGE APPROACH PAVEMENT (SPECIAL), 9.0 m SEE BRIDGE APPROACH PAVEMENT DETAIL SHEET

MATCHLINE STA. 2+400 SEE SHEET NO. 20

S.N. 016-2037 STA. 2+354.404 TO STA. 2+411.426 BK. TO BK. ABUTMENTS

PCC SIDEWALK OVERLAY AND REPLACEMENT DETAILS SEE STRUCTURAL PLANS S17 OF S23

- LEGEND**
- PROPOSED GROOVED PORTLAND CEMENT CONCRETE PAVEMENT, 260
 - PROPOSED PORTLAND CEMENT CONCRETE SIDEWALK, 125
 - PROPOSED HOT-MIX ASPHALT RESURFACING

NOTE: EXISTING PRIVATELY OWNED CHAIN LINK FENCE THAT IS DAMAGED OR REMOVED FOR CONSTRUCTION BY THE CONTRACTOR WILL BE REPLACED IN KIND OR AS DIRECTED BY THE ENGINEER AT NO ADDITIONAL COST.

FILE: g:\2304\civil\exhibit\2304030.dgn DATE: 21-Aug-08 14:24



COLLINS ENGINEERS
123 North Wacker Drive
Suite 300
Chicago, IL 60606
(312) 704-9300
www.collinsengr.com
ILLINOIS PROFESSIONAL DESIGN FIRM LICENSE NO. 184-000993

REVISIONS	
NAME	DATE

ILLINOIS DEPARTMENT OF TRANSPORTATION

PROPOSED ROADWAY PLAN

115TH STREET AND ASHLAND AVENUE

DATE: JANUARY 16, 2009

DRAWN BY: PRH
CHECKED BY: JMH