

F.A.I. RTE.	SECTION	COUNTY	TOTAL SHEETS	SHEET NO.
90	1414B	COOK	74	12
STA.		TO STA.		
FED. ROAD DIST. NO. 7		ILLINOIS FED. AID PROJECT		
CONTRACT NO. 60384				

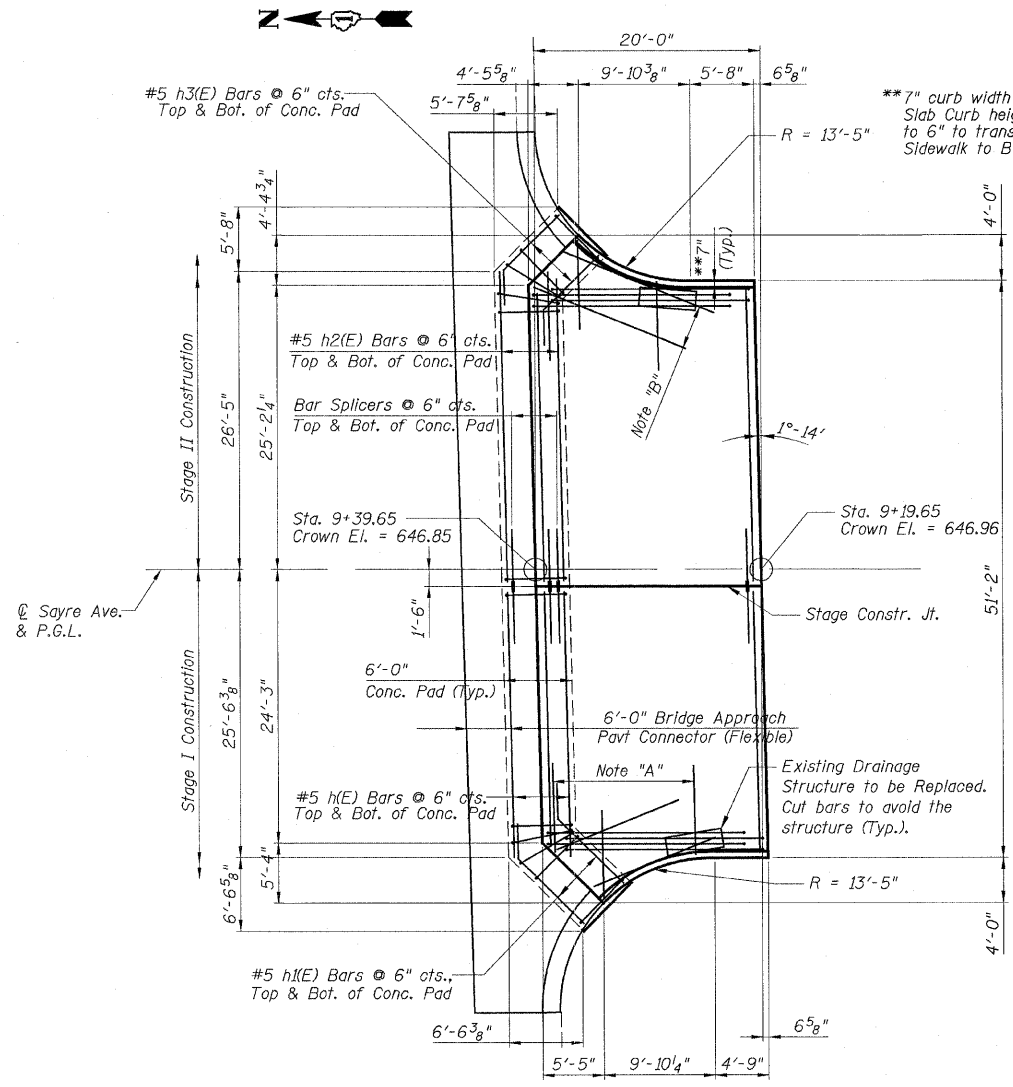

NORTH BRIDGE APPROACH PAVEMENT PLAN

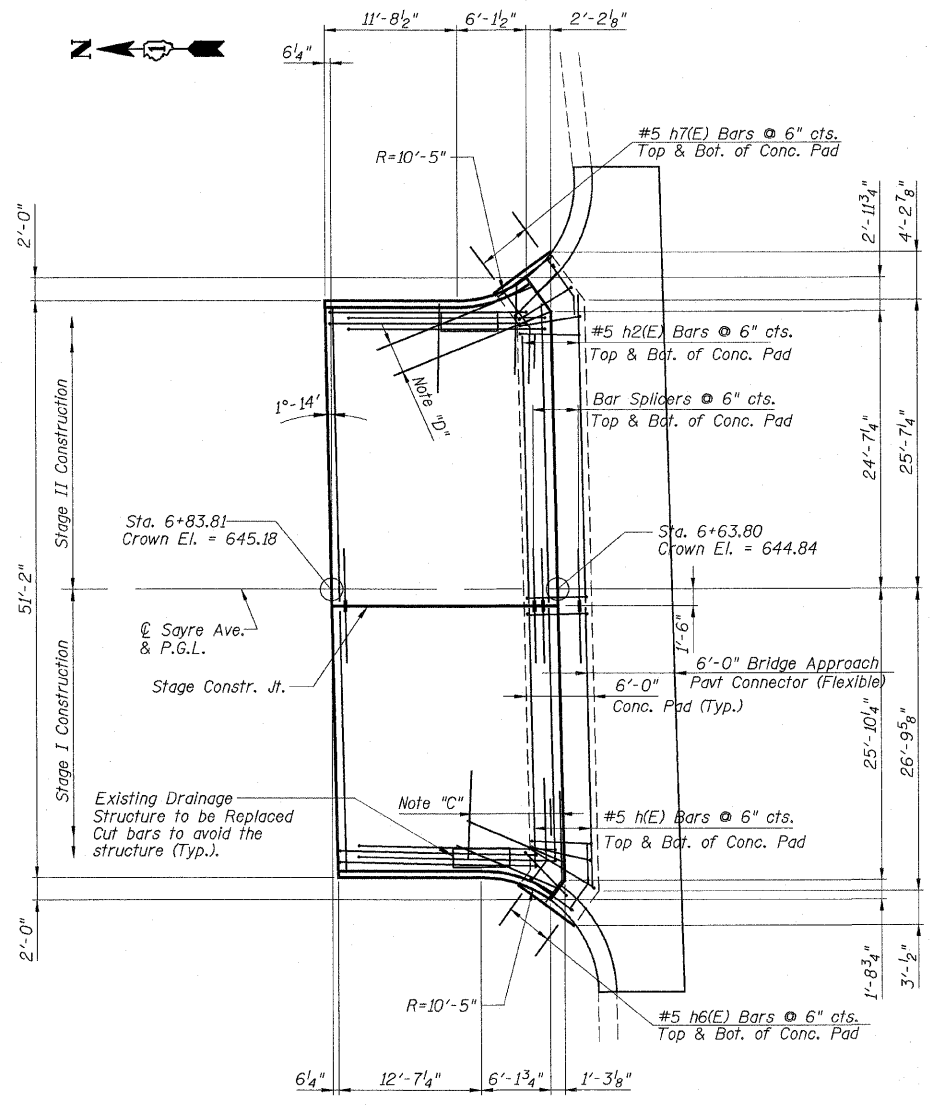

SOUTH BRIDGE APPROACH PAVEMENT PLAN

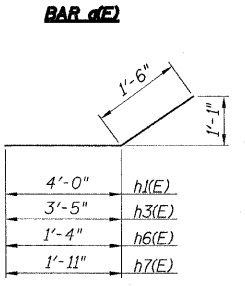
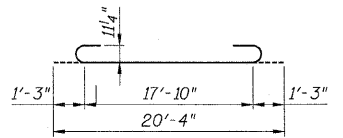

- NOTES:**
 FOR ADDITIONAL DETAILS SEE IDOT STANDARD DRAWING 420401.
- "A" 5-#4 b4(E) Bars, 7'-0" long, @ ±4'-0" cts., Top of Slab & 16-#5 b5(E) Bars, 7'-6" long, @ 12" cts., Bottom of Slab (Typ. N. Bridge Appr. Pav't.)
 - "B" 6-#5 a4(E) Bars, 10'-3" long, @ 12" cts., Top of Slab & 12-#7 a5(E) Bars, 11'-6" long, @ 6" cts., Bottom of Slab (Typ. N. Bridge Appr. Pav't.)
 - "C" 3-#4 b6(E) Bars, 7'-0" long, @ ±4'-0" cts., Top of Slab & 9-#5 b5(E) Bars, 7'-6" long, @ 12" cts., Bottom of Slab (Typ. S. Bridge Appr. Pav't.)
 - "D" 4-#5 a4(E) Bars, 10'-3" long, @ 12" cts., Top of Slab & 8-#7 a5(E) Bars, 11'-6" long, @ 6" cts., Bottom of Slab (Typ. S. Bridge Appr. Pav't.)

BILL OF MATERIAL

Item	Unit	Quantity
* Bridge Approach Pavement (Special)	Sq. Yd.	238
Bridge Approach Pavement Connector (FLX)	Sq. Yd.	96

* See Special Provisions

REVISIONS	
NAME	DATE

ILLINOIS DEPARTMENT OF TRANSPORTATION
 SAYRE AVENUE OVER I-90
 BRIDGE APPROACH
 PAVEMENT (SPECIAL)

SCALE: NONE
 DATE: DEC. 2001

DRAWN BY: RJC
 CHECKED BY: GJH