

F.A.I. RTE.	SECTION	COUNTY	TOTAL SHEETS	SHEET NO.
90	1213B-1	COOK	94	21
STA. 0+800		TO STA. 1+075		
FED. ROAD DIST. NO. 1 ILLINOIS FED. AID PROJECT				
CONTRACT NO. 60640				

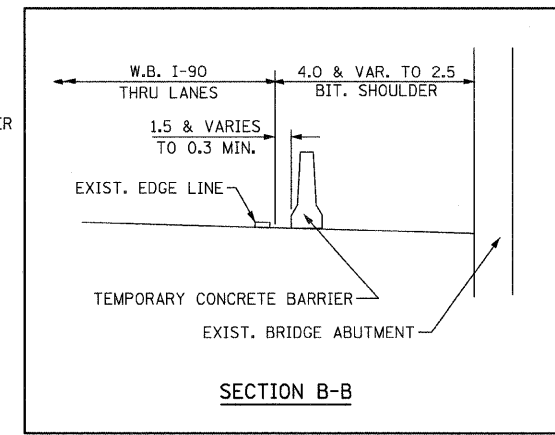
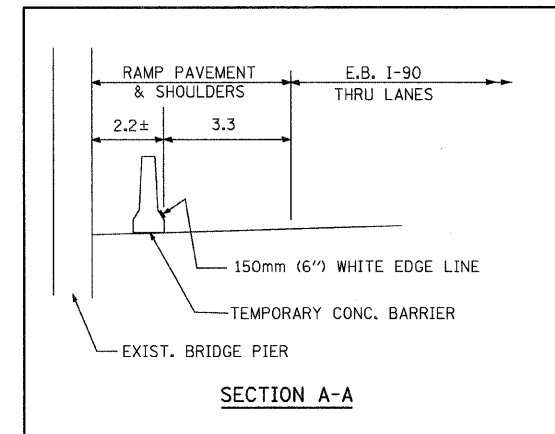
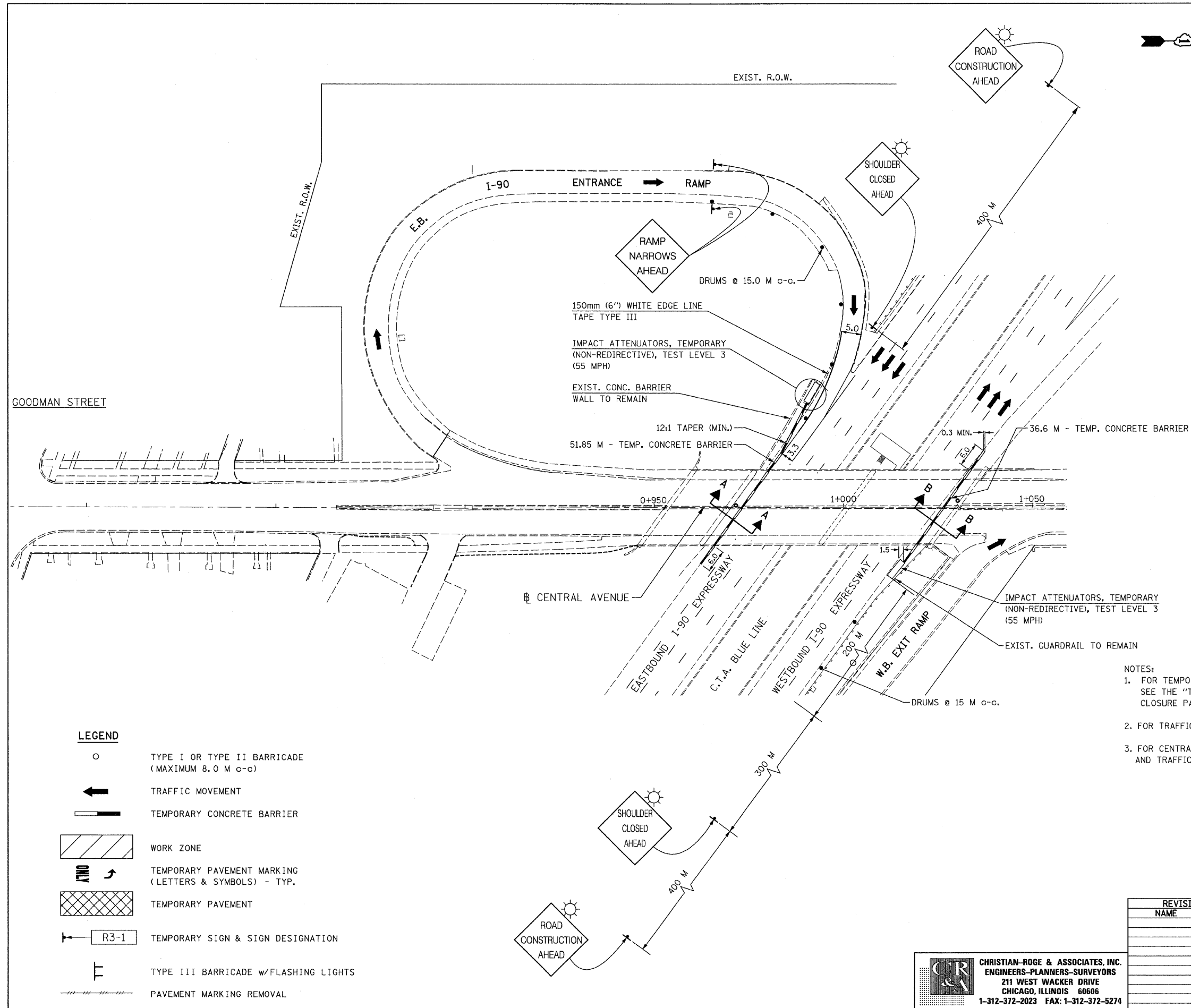

LEGEND

- TYPE I OR TYPE II BARRICADE (MAXIMUM 8.0 M c-c)
- TRAFFIC MOVEMENT
- TEMPORARY CONCRETE BARRIER
- WORK ZONE
- TEMPORARY PAVEMENT MARKING (LETTERS & SYMBOLS) - TYP.
- TEMPORARY PAVEMENT
- TEMPORARY SIGN & SIGN DESIGNATION
- TYPE III BARRICADE w/FLASHING LIGHTS
- PAVEMENT MARKING REMOVAL

NOTES:

1. FOR TEMPORARY CONCRETE BARRIER LAYOUT AND ADDITIONAL DETAILS SEE THE "TC-17 - TRAFFIC CONTROL DETAILS FOR FREEWAY SHOULDER CLOSURE PARTIAL RAMP CLOSURES" ON SHEET NO. 91.
2. FOR TRAFFIC CONTROL AND STAGING NOTES SEE SHEET NO. 17.
3. FOR CENTRAL AVENUE SUGGESTED STAGES OF CONSTRUCTION AND TRAFFIC CONTROL SEE SHEET NO. 19 & NO. 20.

REVISIONS	
NAME	DATE

ILLINOIS DEPARTMENT OF TRANSPORTATION
SUGGESTED STAGES OF CONSTRUCTION
AND TRAFFIC CONTROL
E.B. I-90 ENTRANCE RAMP
W.B. I-90 OUTSIDE SHOULDER
STAGES I & II

SCALE: 1 : 500
DATE: NOVEMBER 2007

DRAWN BY: B.K.
CHECKED BY: S.J.P.

CHRISTIAN-ROGE & ASSOCIATES, INC.
 ENGINEERS-PLANNERS-SURVEYORS
 211 WEST WACKER DRIVE
 CHICAGO, ILLINOIS 60606
 1-312-372-2023 FAX: 1-312-372-5274