

F.A.I. RTE.	SECTION	COUNTY	TOTAL SHEETS	SHEET NO.
90	1213B-1	COOK	94	25
STA. 0+800		TO STA. 1+075		
FED. ROAD DIST. NO. 1 ILLINOIS FED. AID PROJECT				

CONTRACT NO. 60640

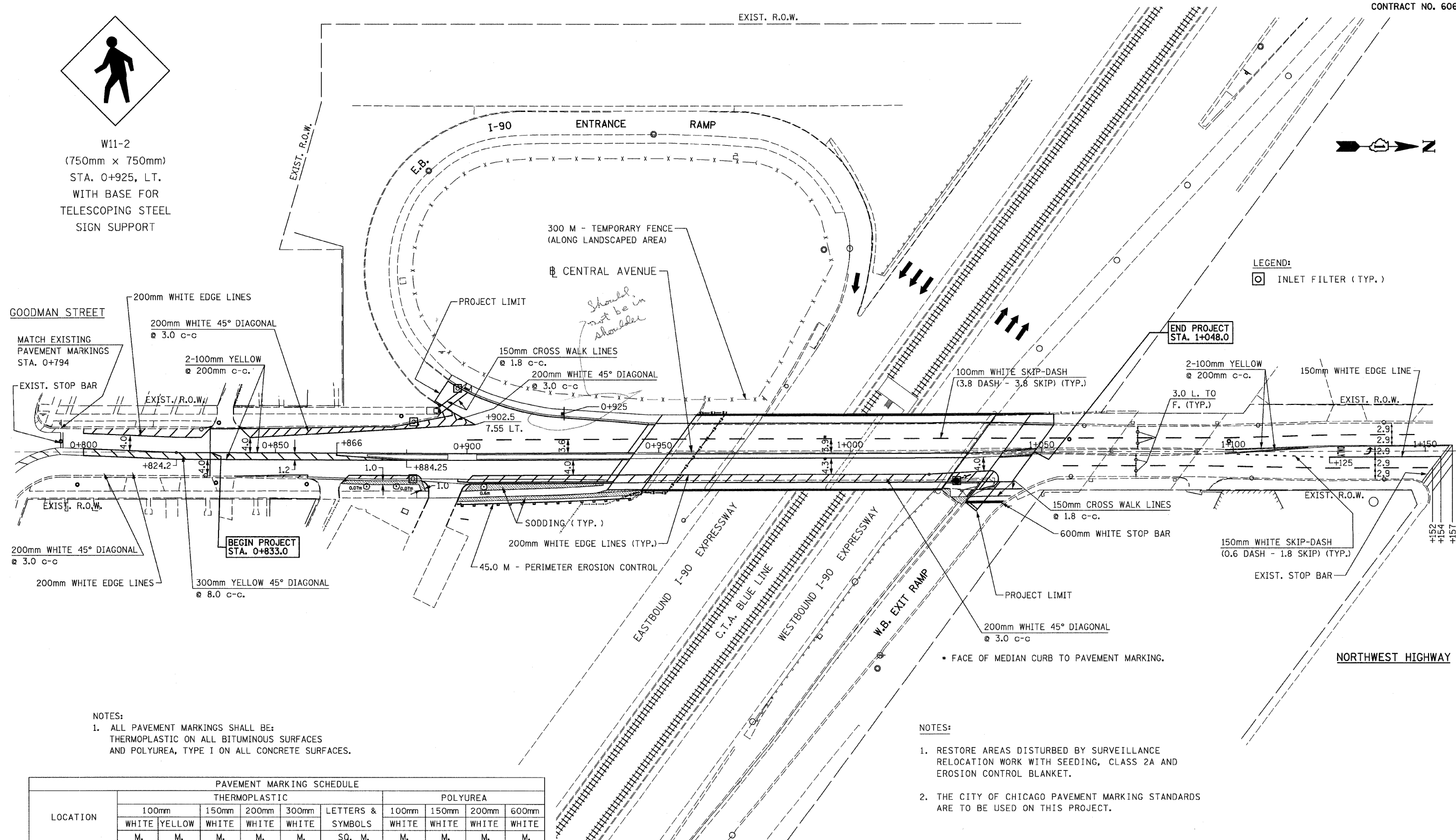

W11-2  
(750mm x 750mm)  
STA. 0+925, LT.  
WITH BASE FOR  
TELESCOPING STEEL  
SIGN SUPPORT



LEGEND:  
[Symbol] INLET FILTER (TYP.)

GOODMAN STREET  
MATCH EXISTING  
PAVEMENT MARKINGS  
STA. 0+794  
EXIST. STOP BAR

200mm WHITE EDGE LINES  
200mm WHITE 45° DIAGONAL  
@ 3.0 c-c  
2-100mm YELLOW  
@ 200mm c-c.

200mm WHITE 45° DIAGONAL  
@ 3.0 c-c  
200mm WHITE EDGE LINES

BEGIN PROJECT  
STA. 0+833.0  
300mm YELLOW 45° DIAGONAL  
@ 8.0 c-c.

END PROJECT  
STA. 1+048.0

2-100mm YELLOW  
@ 200mm c-c.  
3.0 L. TO  
F. (TYP.)

150mm WHITE EDGE LINE  
EXIST. R.O.W.  
150mm CROSS WALK LINES  
@ 1.8 c-c.  
600mm WHITE STOP BAR  
150mm WHITE SKIP-DASH  
(0.6 DASH - 1.8 SKIP) (TYP.)  
EXIST. STOP BAR

NOTES:  
1. ALL PAVEMENT MARKINGS SHALL BE:  
THERMOPLASTIC ON ALL BITUMINOUS SURFACES  
AND POLYUREA, TYPE I ON ALL CONCRETE SURFACES.

NOTES:  
1. RESTORE AREAS DISTURBED BY SURVEILLANCE  
RELOCATION WORK WITH SEEDING, CLASS 2A AND  
EROSION CONTROL BLANKET.  
2. THE CITY OF CHICAGO PAVEMENT MARKING STANDARDS  
ARE TO BE USED ON THIS PROJECT.

LOCATION	PAVEMENT MARKING SCHEDULE									
	THERMOPLASTIC						POLYUREA			
	100mm WHITE M.	150mm YELLOW M.	200mm WHITE M.	300mm WHITE M.	LETTERS & SYMBOLS SQ. M.	100mm WHITE M.	150mm WHITE M.	200mm WHITE M.	600mm WHITE M.	
CENTRAL AVENUE 0+778 - 0+943	11	324		322	27					
0+943 - 1+063						36		185		
1+063 - 1+156	47	168	36		3.3					
OFF-RAMP							20	23	9.0	
ON-RAMP			18	14						
PROJECT TOTAL	58	492	54	336	27	36	20	208	9.0	

**CR & A**  
CHRISTIAN-ROGE & ASSOCIATES, INC.  
ENGINEERS-PLANNERS-SURVEYORS  
211 WEST WACKER DRIVE  
CHICAGO, ILLINOIS 60606  
1-312-372-2023 FAX: 1-312-372-5274

REVISIONS	
NAME	DATE

ILLINOIS DEPARTMENT OF TRANSPORTATION  
**PROPOSED PAVEMENT MARKING,  
LANDSCAPING, AND  
EROSION CONTROL PLAN**  
SCALE: 1 : 500  
DATE: NOVEMBER 2007  
DRAWN BY: B.K.  
CHECKED BY: S.J.P.