

F.A.I. RTE.	SECTION	COUNTY	TOTAL SHEETS	SHEET NO.
90	1213B-1	COOK	94	52
STA.		TO STA.		
FED. ROAD DIST. NO. 1		ILLINOIS FED. AID PROJECT		

CONTRACT NO. 60640

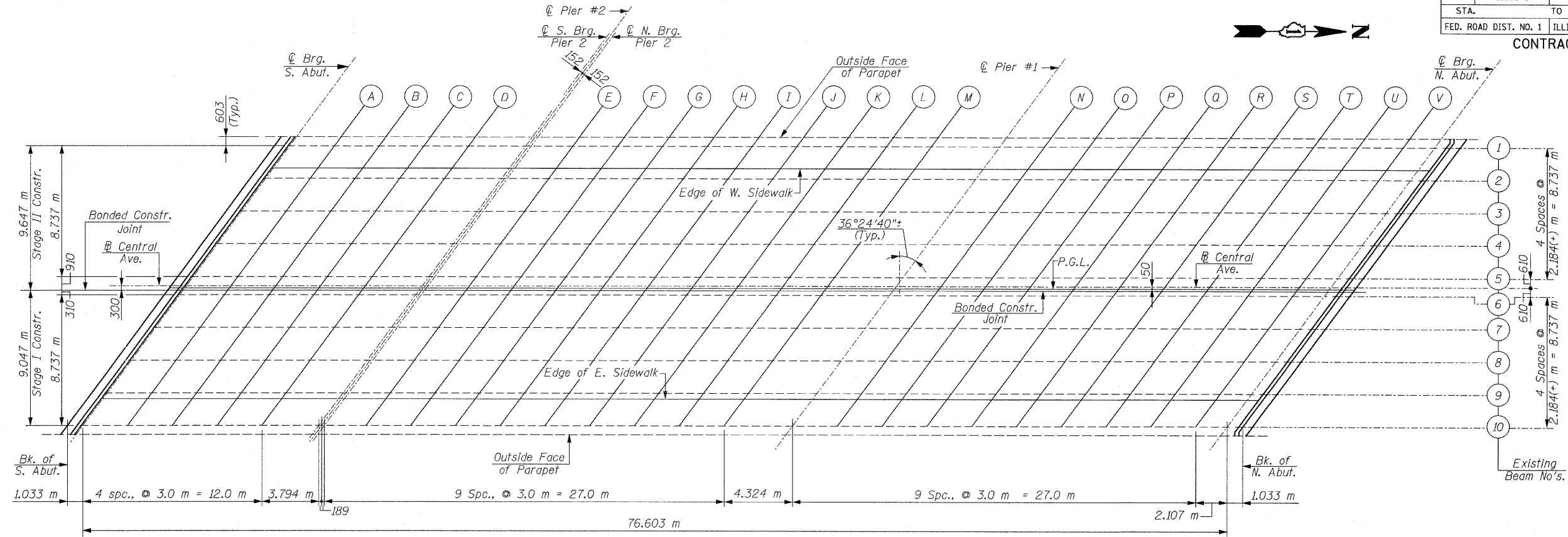

PLAN

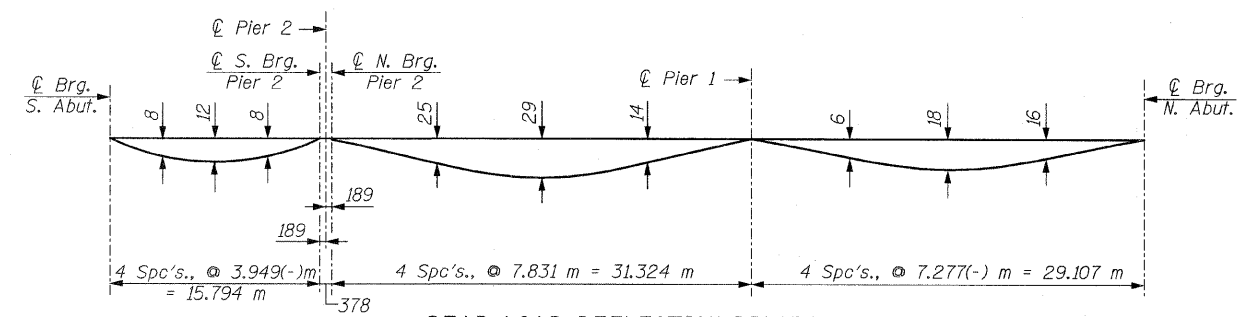

DEAD LOAD DEFLECTION DIAGRAM
(Includes the weight of concrete only)

NOTE:
The above deflections are not to be used in the field if the Engineer is working from the Grade Elevations Adjusted For Dead Load Deflections as shown on Sheets S6 thru S9.

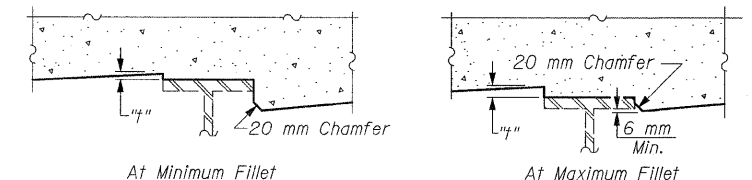
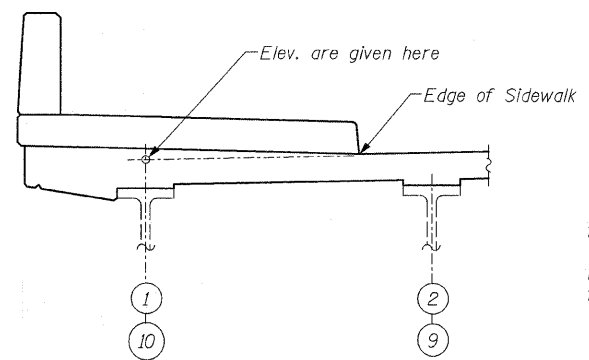

FILLET HEIGHTS
To determine "t": After all existing structural steel are in final position, elevations of the top flanges of the beams shall be taken at intervals shown on Sht's. S6 thru S9. These elevations subtracted from the "Theoretical Grade Elevations Adjusted For Dead Load Deflection" shown on Sht's. S6 thru S9 minus slab thickness, equal the fillet heights "t" above top flange of beams.

NOTES:
All Dimensions are in millimeters (mm) except as noted.
All Elevations and Offsets are in meters.

REVISIONS	
NAME	DATE

ILLINOIS DEPARTMENT OF TRANSPORTATION
TOP OF SLAB ELEVATIONS-I
CENTRAL AVENUE (F.A.U. RTE. 2798)
OVER
INTERSTATE 90 (KENNEDY EXPWY.) & C.T.A.
F.A.I. RTE. 90 SECTION: 1213B-1
COOK COUNTY STATION 1+000.000
STRUCTURE NO. 016-0659
SCALE: NONE DRAWN BY: D.L./F.M.
DATE: JANUARY 16, 2009 CHECKED BY: B.N.S./J.C.N.
CHRISTIAN-ROGE & ASSOC., INC.
CHICAGO ILLINOIS