

STAGE II

STAGE II NOTES

- SEQUENCE OF CONSTRUCTION: PAVEMENT PATCHING, HMA SURFACE REMOVAL AND PROPOSED HMA COURSES AS DETAILED IN EACH OPERATION SECTION. WORK CAN OCCUR CONCURRENTLY, BUT SEQUENCE SHALL BE MAINTAINED AND NOT CONFLICT. THE TWO LANE SECTION OF I-94 WILL FOLLOW THE SEQUENCE OF LANES 1 AND 3 IN THE OPERATION SECTIONS. RAMP WORK WILL BE COMPLETED USING DISTRICT DETAIL TC-8 - FREEWAY AND EXIT RAMP CLOSURE DETAILS.
- LANE AND RAMP CLOSURES ALLOWED AS STIPULATED IN THE SPECIAL PROVISIONS.
- HMA SURFACE REMOVAL AND RESURFACING OPERATIONS SHALL NOT BEGIN UNTIL STAGE I IS COMPLETED AND THE I-94 ALTERNATE ROUTE IS SET UP.
- LANE CLOSURES PER STANDARDS 701400, 701401 AND 701446.
- REDUCE LANE WIDTH USING 35:1 TAPER PER DISTRICT DETAIL TC-9 - TRAFFIC CONTROL DETAILS FOR FREEWAY SINGLE AND MULTI-LANE WEAVE, A W5-1 (48 x 48) ROAD NARROWS SIGN WILL BE ERECTED 500' IN ADVANCE OF THE TAPER.
- THE CONTRACTOR SHALL ERECT ROAD CONSTRUCTION AHEAD SIGNS (W20-I103(K)-48) WITH FLASHING BEACON ON ALL ARTERIAL ROADWAYS APPROACHING INTERCHANGE RAMP.
- GRADE DIFFERENTIAL BETWEEN LANES SHALL NOT EXCEED 2".
- PARTIAL MILLING OF PAVEMENT FOR AN OPERATION WILL NOT BE PAID FOR SEPARATELY, BUT WILL BE PAID FOR AT THE FINAL MILLING THICKNESS SHOWN ON THE TYPICAL SECTIONS.
- REMOVAL OF TEMPORARY PAVEMENT MARKING, WHEN REQUIRED, SHALL BE PAID FOR AS "WORK ZONE PAVEMENT MARKING REMOVAL".
- REMOVAL OF EXISTING PAVEMENT MARKING, WHEN REQUIRED, SHALL BE PAID FOR AS "PAVEMENT MARKING REMOVAL".
- EXISTING OR TEMPORARY PAVEMENT MARKINGS REMOVED DURING MILLING OPERATIONS WILL NOT BE PAID FOR SEPARATELY.
- CASTINGS EXPOSED IN TRAVEL LANES SHALL BE PROTECTED PER APPLICABLE PORTIONS OF ARTICLE 603.07 OF THE STANDARD SPECIFICATIONS. THIS WORK WILL NOT BE PAID FOR SEPARATELY, BUT SHALL BE INCLUDED IN THE VARIOUS HMA BINDER AND SURFACE COURSES PLACED.

LEGEND

- ① EXISTING PAVEMENT MARKING
- ② WET REFLECTIVE TEMPORARY TAPE, TYPE III, 5" (10' DASH - 30' SKIP)
- ③ WET REFLECTIVE TEMPORARY TAPE, TYPE III, 4" (YELLOW LEFT & WHITE RIGHT) INSTALLED WITHIN 24 HOURS OF MILLING OR BINDER PLACEMENT.
- ④ PROPOSED PAVEMENT MARKING. SEE PAVEMENT MARKING PLANS.
- ⑤ VERTICAL BARRICADES WITH STEADY BURNING MONO DIRECTIONAL LIGHT AT 100' C-C SPACING. VERTICAL BARRICADES ALONG SHOULDERS WILL REMAIN IN PLACE THROUGHOUT OPERATIONS TO PREVENT SHOULDER RIDING. DURING EACH OPERATION VERTICAL BARRICADES WILL THEN BE USED TO SEPARATE THE WORK ZONE AND OPERATING LANES.

BITUMINOUS SURFACE REMOVAL

HMA SURFACE COURSE

NOTE

STRUCTURAL WORK ON BRIDGES TO BE ACCOMPLISHED IN STAGE II DURING ALLOWABLE SHOULDER AND LANE CLOSURES IDENTIFIED IN THE SPECIAL PROVISIONS. THE CONTRACTOR SHALL COORDINATE THE ROADWAY AND STRUCTURAL WORK SO BITUMINOUS MATERIALS ARE NOT TRACKED ON THE BRIDGE DECKS BEFORE BEING SEALED.

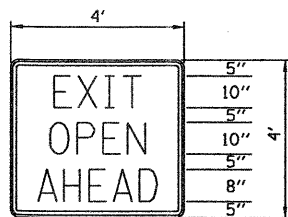

1" BORDER LINE
GREEN REFLECTIVE BACKGROUND
WITH WHITE LEGEND

THIS SIGN SHALL BE INSTALLED
IN ADVANCE OF ALL OPEN/EXIT
RAMPS WHEN THE RIGHT
LANES ARE CLOSED.



W8-11
48" x 48"

NOTE:
THIS SIGN SHALL BE INSTALLED
ON BOTH SIDES OF THE ROADWAY
500' IN ADVANCE OF AREAS WHERE
THERE IS A GRADE DIFFERENTIAL
BETWEEN LANES, AFTER EACH
ENTRANCE RAMP AND A MINIMUM
OF EVERY MILE.

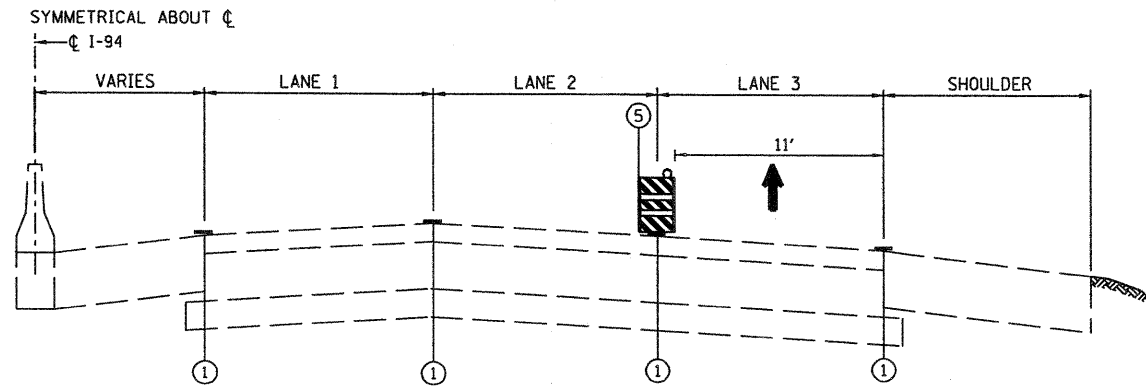

STAGE II - OPERATION ONE - I-94
PATCH LANES 1 & 2 AND INSIDE SHOULDER

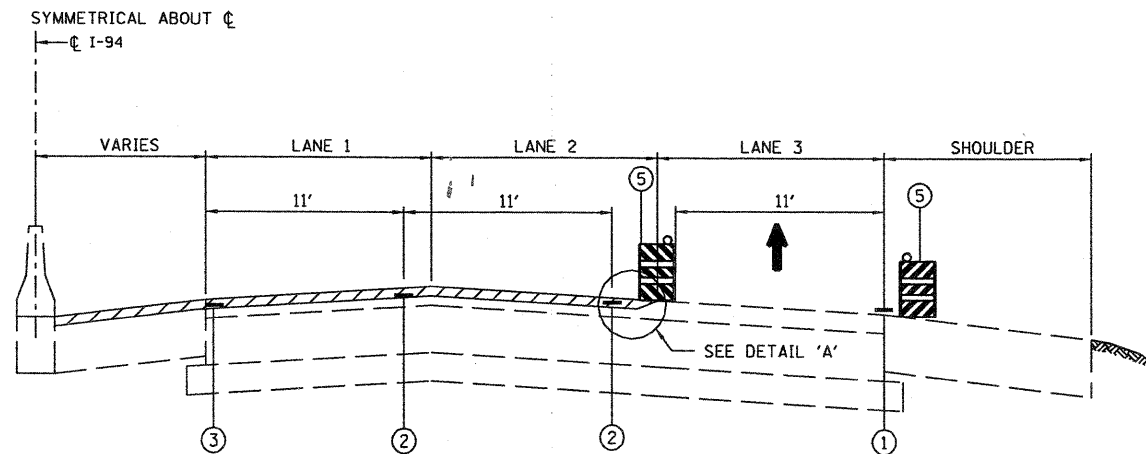

STAGE II - OPERATION TWO - I-94
HMA SURFACE REMOVAL 2" - LANES 1 & 2 & INSIDE SHOULDER

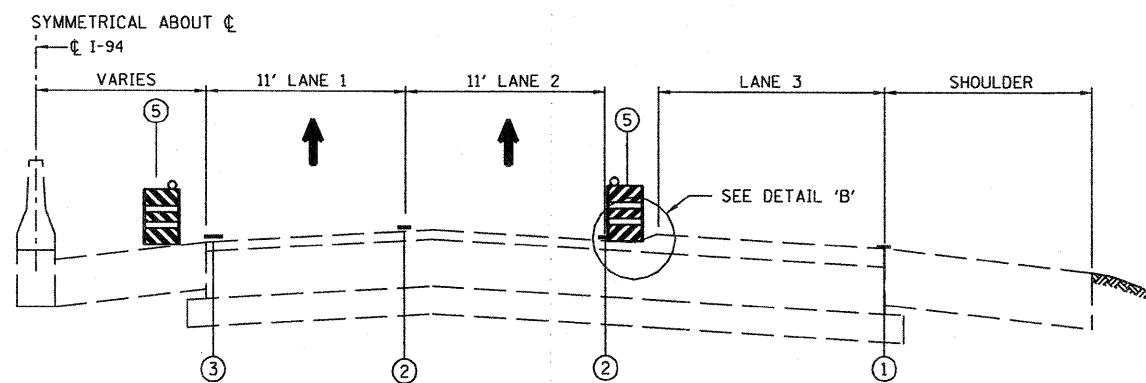

STAGE II - OPERATION THREE - I-94
PATCH LANE 3 AND OUTSIDE SHOULDER

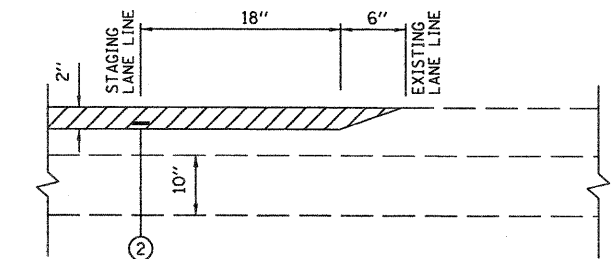

DETAIL 'A'

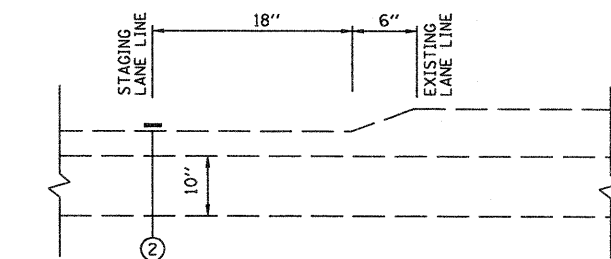

DETAIL 'B'

FILE NAME = D168C08-063-STAGE.II.A.dgn	USER NAME = dwoznarski	DESIGNED -	REVISED -	STATE OF ILLINOIS DEPARTMENT OF TRANSPORTATION	BISHOP FORD EXPRESSWAY (I-94) SUGGESTED MAINTENANCE OF TRAFFIC	F.A.I. RTE.	SECTION	COUNTY	TOTAL SHEETS	SHEET NO.	
	PLOT SCALE = N/A	DRAWN - DWH	REVISED -			94	0312-708W, ETC. & 1315RS-4	COOK	167	63	
	PLOT DATE = 2/6/2009	CHECKED -	REVISED -			CONTRACT NO. 60C08					
		DATE = 2/6/2009	REVISED -			SCALE: N/A	SHEET NO. 4 OF 9 SHEETS	STA.	TO STA.	FED. ROAD DIST. NO. ILLINOIS FED. AID PROJECT	