

STATE OF ILLINOIS
DEPARTMENT OF TRANSPORTATION

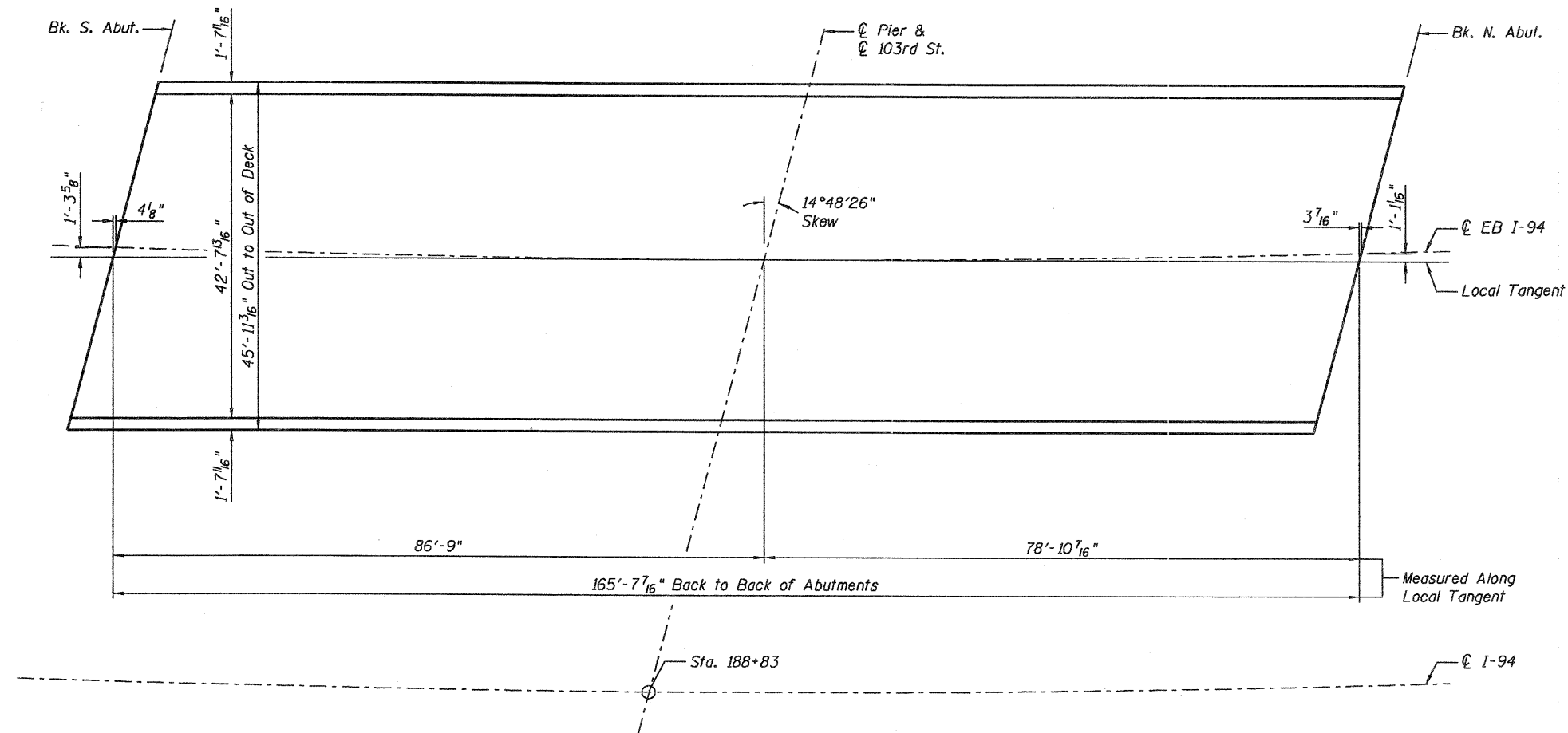

PLAN

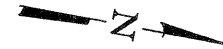

TOTAL BILL OF MATERIAL

Item	Unit	Total
Concrete Sealer	Sq. Ft.	8320

Concrete Sealer to be placed on deck surface, top and front face of parapets.

Plan dimensions and details relative to existing plans are subject to nominal construction variations. The Contractor shall field verify existing dimensions and details affecting new construction and make necessary approved adjustments prior to construction or ordering of materials. Such variations shall not be cause for additional compensation for a change in the scope of work, however, the Contractor will be paid for the quantity actually furnished at the unit price bid for the work.

DESIGNED	LAS
CHECKED	DAZ
DRAWN	SAW
CHECKED	LAS

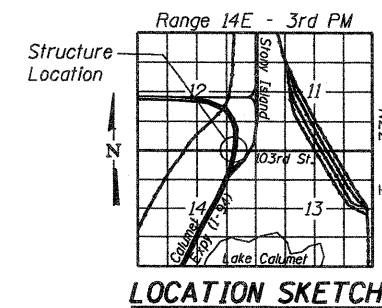

ZROKA
engineering

Zroka Engineering, P.C.
4216 North Hermitage
Chicago, IL 60613

SHEET NO. 10 OF 13 SHEETS	F.A.I. RTE.	SECTION	COUNTY	TOTAL SHEETS	SHEET NO.
	94	(0312-708W,ETC. & 1315)RS-4	COOK	167	118
S.N. 016-2733			CONTRACT NO. 60C08		
FED. ROAD DIST. NO. 7 ILLINOIS FED. AID PROJECT					

GENERAL PLAN
BISHOP FORD EXPRESSWAY (I-94)
EASTBOUND I-94 OVER
103RD STREET
COOK COUNTY
STATION 188+83
STRUCTURE NO. 016-2733