

F.A. RTE.	SECTION	COUNTY	TOTAL SHEETS	SHEET NO.
94		COOK	167	136
STA.		TO STA.		
FED. ROAD DIST. NO.		ILLINOIS FED. AID PROJECT		

• (0312-708W, ETC. & 1315RS-4

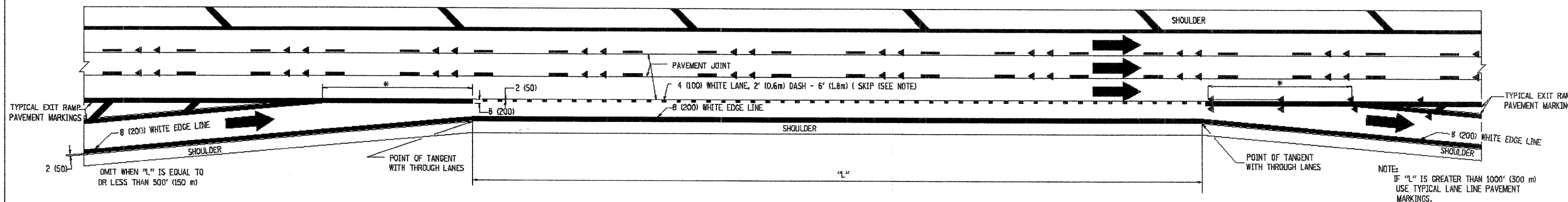

**TYPICAL ENTRANCE/EXIT RAMP COMBINATION PAVEMENT MARKINGS**

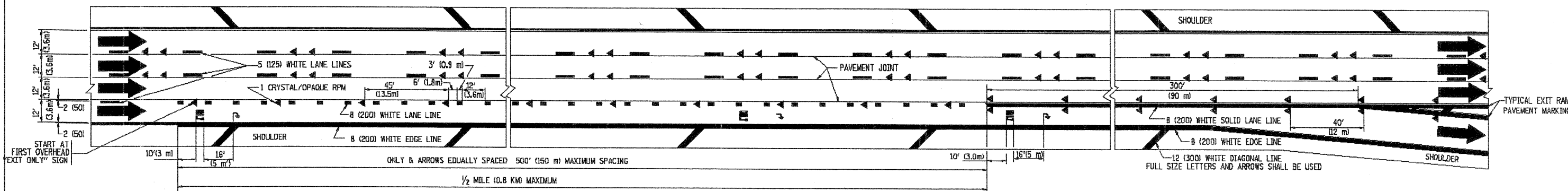

**TYPICAL EXIT ONLY LANE PAVEMENT MARKINGS**

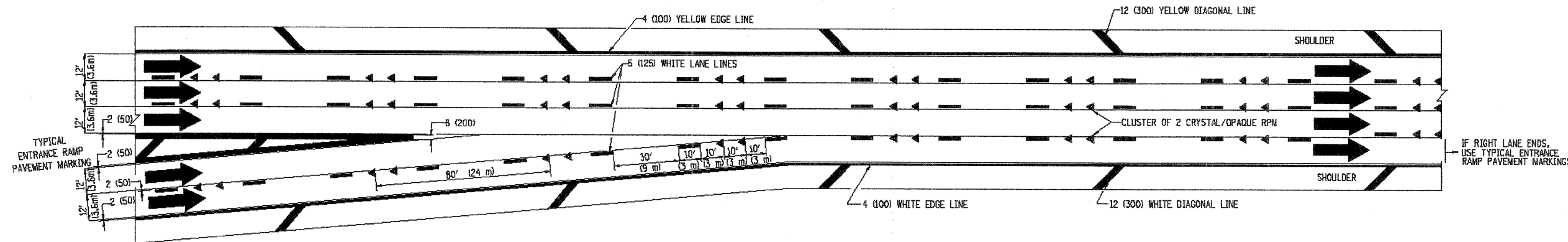

**TYPICAL TWO LANE ENTRANCE RAMP PAVEMENT MARKINGS**

REVISIONS	
NAME	DATE
DWS	1/90
DWS	5/91
SPB	1/07

ILLINOIS DEPARTMENT OF TRANSPORTATION

**MULTI-LANE FREEWAY  
PAVEMENT MARKING  
DETAILS**

SCALE: NONE

DRAWN BY C.A.D.D.

CHECKED BY

TC12 SHEET 2 OF 2

PLT DATE = 3/6/2007  
FILE NAME = I:\projects\60c08\136-136-DISTRICT DETAIL.S.dgn  
USER NAME = bawdell  
D:\60C08-136-DISTRICT DETAIL.S.dgn