

SEE SHEET 14 OF 24

- LEGEND AND NOTES:**
- WORK ZONE
  - ARROW BOARD
  - DIRECTION INDICATOR BARRICADE WITH STEADY BURNING MONODIRECTIONAL LIGHT AT 50' C-C SPACING
  - DRUM WITH STEADY BURNING MONODIRECTIONAL LIGHT AT 25' C-C SPACING AT RAMP, 50' C-C SPACING IN LANE TAPERS AND 100' C-C SPACING AT ALL OTHER LOCATIONS.
  - VERTICAL PANEL AT 200' C-C SPACING ON TANGENT AND 100' C-C SPACING ON CURVE. NOT REQUIRED WITH GUARDRAIL.
  - IMPACT ATTENUATORS, TEMPORARY (FULLY REDIRECTIVE, NARROW), TEST LEVEL 3

SEE SHEET 14 OF 24

1. ALL PAVEMENT MARKINGS SHALL BE WET REFLECTIVE TEMPORARY TAPE, TYPE III.
2. SEE STANDARDS 701401-05 AND 701411-05 AND DISTRICT DETAIL TC-9 IN ADDITION TO TRAFFIC CONTROL ITEMS SHOWN ON THIS SHEET.

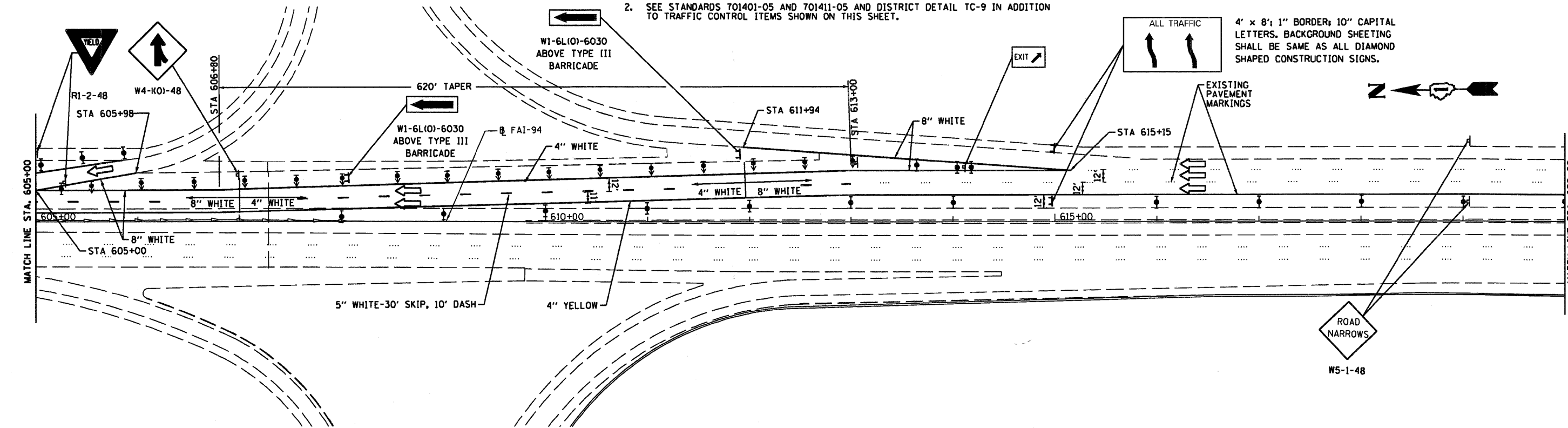

4' x 8'; 1" BORDER; 10" CAPITAL LETTERS. BACKGROUND SHEETING SHALL BE SAME AS ALL DIAMOND SHAPED CONSTRUCTION SIGNS.

FILE NAME = D168021-848-STAGE_PLAN.STG1.dgn	USER NAME = dwoznarski	DESIGNED - DRAWN -	REVISED - REVISED -	<b>STATE OF ILLINOIS DEPARTMENT OF TRANSPORTATION</b>	<b>BISHOP FORD EXPRESSWAY (I-94) SUGGESTED MAINTENANCE OF TRAFFIC - STAGE I PLAN</b>		F.A.I. RTE. 94	SECTION (0405,ETC,42-780707RS-11)	COUNTY COOK	TOTAL SHEETS 133	SHEET NO. 40	
PLOT SCALE = 100.00' / IN.	CHECKED -	REVISED -	REVISED -		SCALE: 1" = 50'	SHEET NO. 12 OF 24 SHEETS	STA. 590+0	TO STA. 620+00	CONTRACT NO. 60021			
PLOT DATE = 2/5/2009	DATE -	REVISED -	REVISED -		FED. ROAD DIST. NO.   ILLINOIS FED. AID PROJECT							