

STATE OF ILLINOIS
DEPARTMENT OF TRANSPORTATION

Existing structure:
The original structure was built in 1947 as Route SA-66, Section 066-505.2-MFT, 1975-079-BR. In 1981, the bridge was widened and reconstructed with a new deck and new line of steel beams on each side and the superstructure was cleaned and painted.

Bench Mark:
"X" scribed in chiseled box on top of concrete barrier wall at the southeast corner of bridge structure for Westbound FAI-94 over the Little Calumet River
Elev 606.96 (Assumed Local Datum)

Stage construction shall be utilized to maintain traffic during construction.
No salvage

DESIGN SPECIFICATIONS
2002 AASHTO 17th Edition

DESIGN STRESSES
FIELD UNITS
f'c = 3,500 psi
fy = 60,000 psi (Reinforcement)
fy = 36,000 psi (M270 Grade 36)

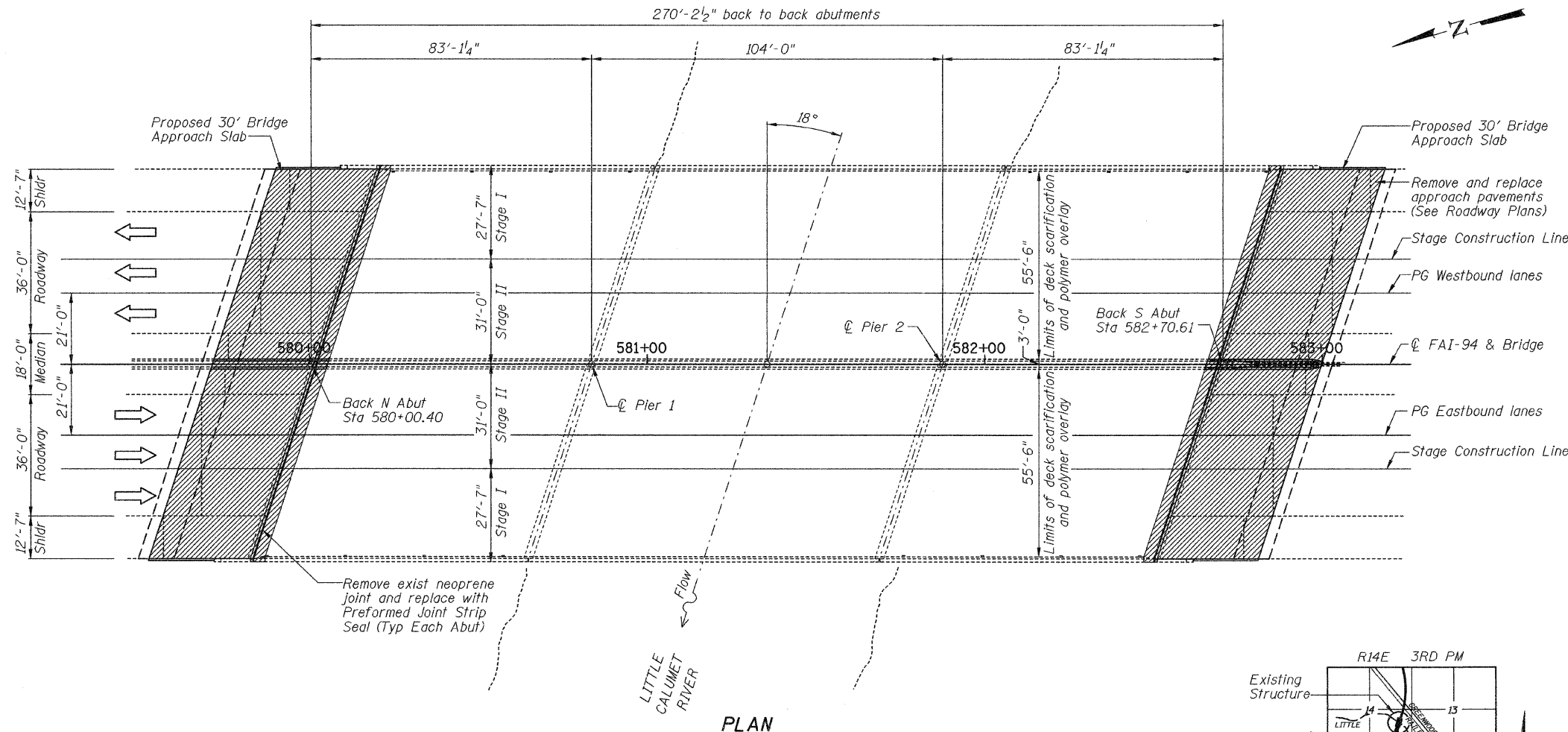
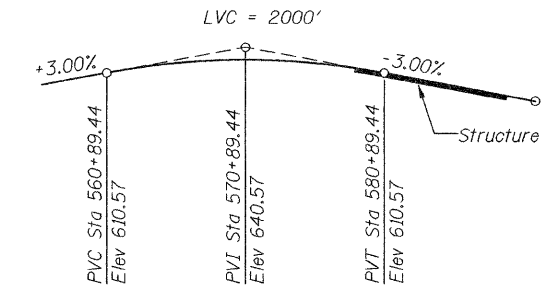
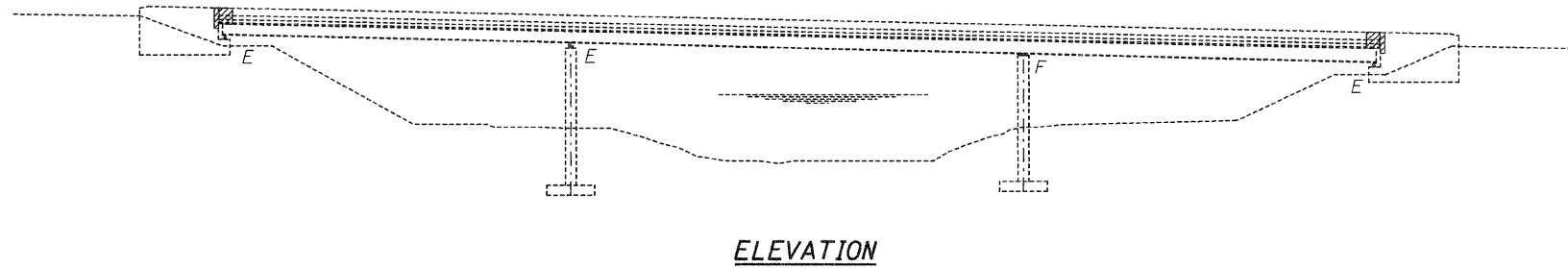

EXISTING PROFILE GRADE FAI-94

SCOPE OF WORK

- Shot blast the existing deck and apply a thin anti-icing overlay 3/8" min thickness.
- Replace deck joints at each abutment with Preformed Joint Strip Seal.
- Replace bridge approach pavements.
- Jack and remove bearings and replace with elastomeric bearings at each abutment.
- Remove debris from abutment bearing seats.
- Clean and paint steel beam ends and end diaphragms at abutments.
- Repair spall in the east parapet in the south approach, westbound lanes with formed concrete repair.
- Re-seal joint between center parapets.

**GENERAL PLAN AND ELEVATION
BISHOP FORD EXPRESSWAY (I-94)
LITTLE CALUMET RIVER
COOK COUNTY
STATION
STRUCTURE NUMBER 016-0163**

DESIGNED -	 DECATUR (217) 422-8544 CHICAGO (773) 714-0050 ROCKFORD (815) 489-0050 184-001597
CHECKED -	
DRAWN -	
CHECKED -	

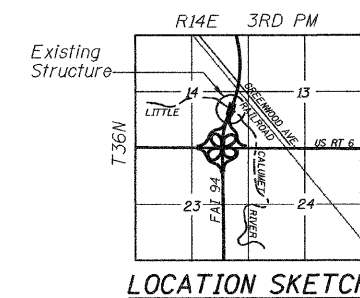

SHEET NO. 1	F.A.I. RTE.	SECTION	COUNTY	TOTAL SHEETS	SHEET NO.
OF 17 SHEETS	94	(0405,ETC,42-7&0707)RS-11	COOK	133	87
BISHOP FORD EXPRESSWAY (I-94)			CONTRACT NO. 60D21		
FED. ROAD DIST. NO. - ILLINOIS FED. AID PROJECT					