

STATE OF ILLINOIS
DEPARTMENT OF TRANSPORTATION

EAST CURB LINE

Location	Station	Offset	Theoretical Grade Elevations
End at S Abut	582+88.90	57.58	603.83
A	582+98.90	57.58	603.53
B	583+08.90	57.58	603.23
End of South appr pavement	583+18.90	57.58	602.93

EAST MEDIAN CURB LINE

Location	Station	Offset	Theoretical Grade Elevations
End at S Abut	582+70.68	1.50	604.73
A	582+80.68	1.50	604.43
B	582+90.68	1.50	604.13
End of South appr pavement	583+00.68	1.50	603.83

PG EASTBOUND LANES

Location	Station	Offset	Theoretical Grade Elevations
End at S Abut	582+63.37	-21.00	605.35
A	582+73.37	-21.00	605.05
B	582+83.37	-21.00	604.75
End of South appr pavement	582+93.37	-21.00	604.45

PG WESTBOUND LANES

Location	Station	Offset	Theoretical Grade Elevations
End at S Abut	582+77.01	21.00	604.94
A	582+87.01	21.00	604.64
B	582+97.01	21.00	604.34
End of South appr pavement	583+07.01	21.00	604.04

WEST MEDIAN CURB LINE

Location	Station	Offset	Theoretical Grade Elevations
End at S Abut	582+69.70	-1.50	604.76
A	582+79.70	-1.50	604.46
B	582+89.70	-1.50	604.16
End of South appr pavement	582+99.70	-1.50	603.86

WEST CURB LINE

Location	Station	Offset	Theoretical Grade Elevations
End at S Abut	582+51.48	-57.58	604.95
A	582+61.48	-57.58	604.65
B	582+71.48	-57.58	604.35
End of South appr pavement	582+81.48	-57.58	604.05

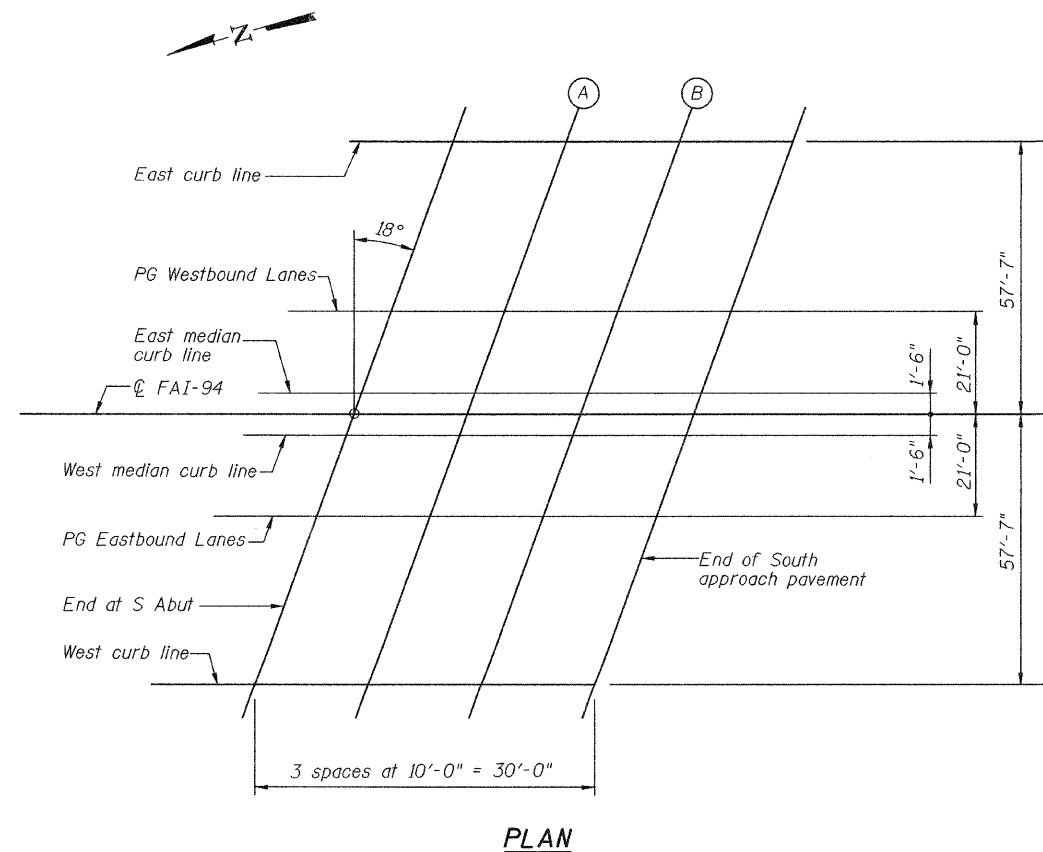

TOP OF SOUTH APPROACH
SLAB ELEVATIONS
BISHOP FORD EXPRESSWAY (I-94)
LITTLE CALUMET RIVER
COOK COUNTY
STATION
STRUCTURE NUMBER 016-0163

DESIGNED -
CHECKED -
DRAWN -
CHECKED -

HOMER L. CHASTAIN & ASSOCIATES, LLP
CONSULTING ENGINEERS
DECATUR (217) 422-8544
CHICAGO (773) 714-0050
ROCKFORD (815) 489-0050
184-001597

SHEET NO. 15	F.A.I. RTE.	SECTION	COUNTY	TOTAL SHEETS	SHEET NO.
OF 17 SHEETS	94	(0405,ETC,42-7&0707)RS-11	COOK	133	101
BISHOP FORD EXPRESSWAY (I-94)			CONTRACT NO. 60D21		
FED. ROAD DIST. NO. _ ILLINOIS FED. AID PROJECT					