

QUANTITY
 4 (100) LINE = 64.1 ft. (19.7 m)
 21.1 sq. ft. (1.97 sq. m)

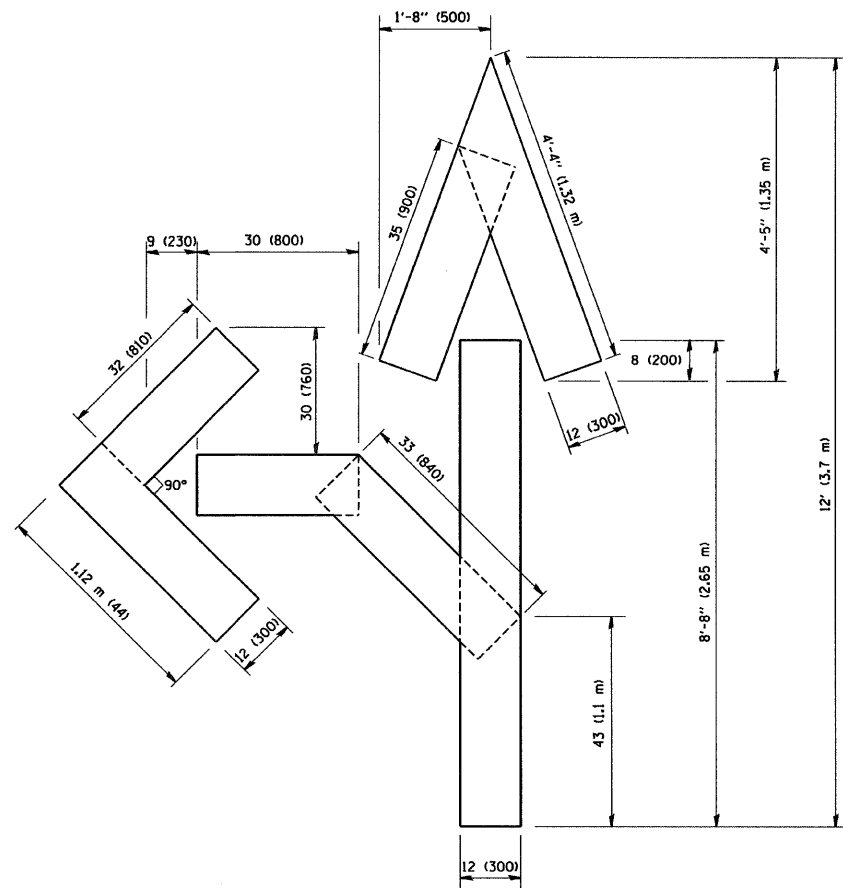

QUANTITY
 4 (100) LINE = 82.5 ft. (25.3 m)
 27.5 sq. ft. (2.53 sq. m)

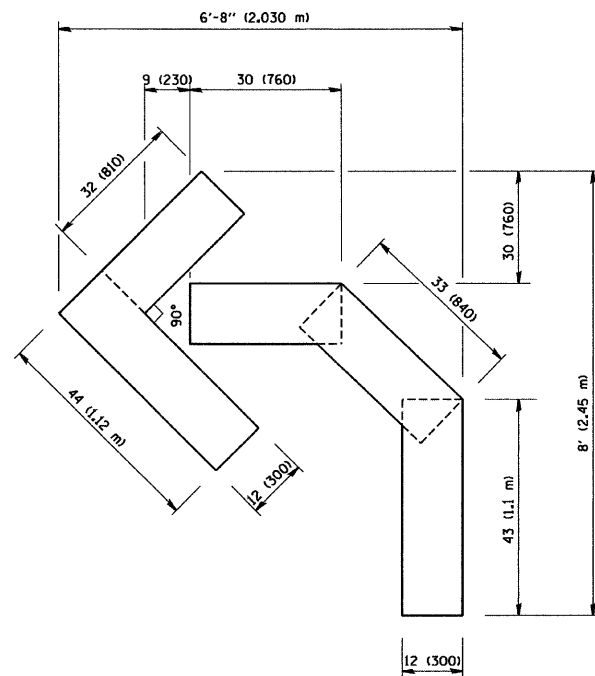

QUANTITY
 4 (100) LINE = 45.5 ft. (13.9 m)
 15.2 sq. ft. (1.39 sq. m)

All dimensions are in Inches (millimeters) unless otherwise shown.

FILE NAME =
 W:\diststd\22x34\tc16.dgn

USER NAME = geglennobt	DESIGNED -	REVISED - T. RAMMACHER 06-05-96
PLOT SCALE = 50.0000' / IN.	DRAWN -	REVISED - T. RAMMACHER 11-04-97
PLOT DATE = 1/4/2008	CHECKED -	REVISED - T. RAMMACHER 03-02-98
	DATE - 09-18-94	REVISED - E. GOMEZ 08-28-00

STATE OF ILLINOIS
 DEPARTMENT OF TRANSPORTATION

PAVEMENT MARKING LETTERS AND SYMBOLS
 FOR TRAFFIC STAGING

SCALE: NONE SHEET NO. 1 OF 1 SHEETS STA. TO STA.

F.A. RTE. 352	SECTION 56 B-I-2	COUNTY LAKE	TOTAL SHEETS 26	SHEET NO. 25
TC-16		CONTRACT NO.		
FED. ROAD DIST. NO. 1 ILLINOIS FED. AID PROJECT				