

REMOVAL PLAN

REMOVAL NOTES

1 - REMOVE EXISTING UNDERPASS LIGHTING AND RETURN TO IDOT. REMOVE ASSOCIATED CONDJITS AND JUNCTION BOXES UP TO RISER POINT AT GRADE. REMOVE ASSOCIATED WIRES UP TO PRIOR ROADWAY JUNCTION BOX AT FRANKLIN CONNECTOR.

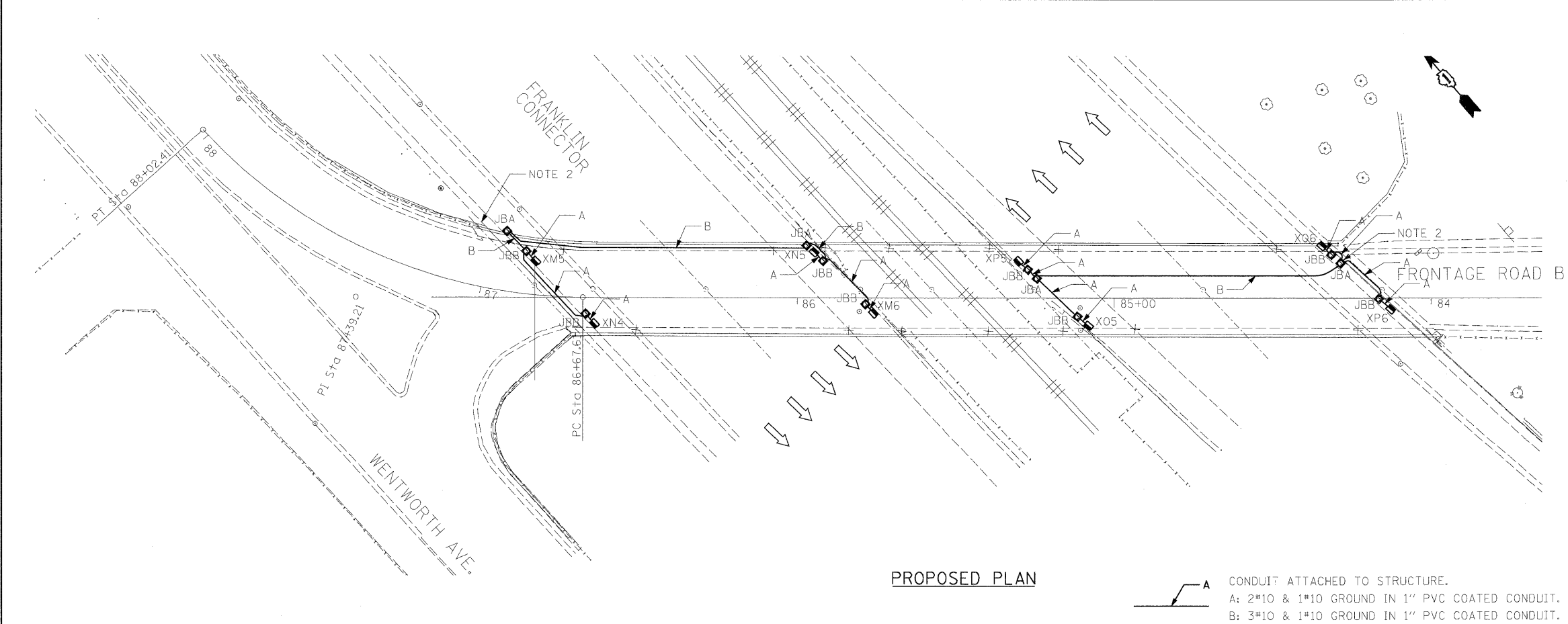

PROPOSED PLAN

PROPOSED NOTES

1 - PROVIDE NEW 150W HPS UNDERPASS LIGHTING. PROVIDE CONDUITS AND WIRES AS SHOWN. RECONNECT PROPOSED UNDERPASS LUMINAIRES TO EXISTING CIRCUIT AT ROADWAY JUNCTION BOX ON FRANKLIN CONNECTOR.

2- PROVIDE NEW CONDUIT FROM CONDUIT RISER POINT AT GRADE TO JUNCTION BOX. SEE DETAILS FOR MORE INFORMATION.

CONDUIT ATTACHED TO STRUCTURE.
 A: 2*10 & 1*10 GROUND IN 1" PVC COATED CONDUIT.
 B: 3*10 & 1*10 GROUND IN 1" PVC COATED CONDUIT.

FILE NAME = p:\2008\c\15600\Electrical\Cadd\E3\Frontage Road B Bridge Underpass Lighting Plan.dwg JACOBS PLOT DATE = 1/12/2009	DESIGNED - HS DRAWN - HS CHECKED - CDS DATE - 01/13/09	REVISED - REVISED - REVISED - REVISED -	STATE OF ILLINOIS DEPARTMENT OF TRANSPORTATION	F.A.P. 392 FRANKLIN CONNECTOR (AT 26th STREET AND AT I-55 FRONTAGE ROAD B) E3 FRONTAGE ROAD B BRIDGE UNDERPASS LIGHTING PLAN				F.A.P. RTE. 392 SECTION 1717.2-3B-R COUNTY COOK TOTAL SHEETS 114 SHEET NO. 40 CONTRACT NO. 62197
				SCALE: 1" = 20'-0" SHEET NO. OF SHEETS STA. TO STA.	FED. ROAD DIST. NO. ILLINOIS FED. AID PROJECT			