

Bench Mark: Monument O, 23rd. & Canal, C.G. K135 1947 Elev. 593.72 (NAVD88)

Existing Structure: Structure No. 016-1093 was built in 1964 as the Frontage Road "B" Grade Separation, Section SW-1717.2-3B. The superstructure consists of a three span continuous, composite, steel plate girder system, with a total 8" thick deck including a 2 1/2" latex modified overlay applied in 1990. The length back to back of abutments is approximately 274'-0" measured along the centerline of Frontage Road "B". The deck out to out dimension is 30'-3" and varies at the west end. The substructure consists of closed abutments supported by pedestal footings on rock and two hammerhead piers supported by spread footings on rock. The bridge will be closed and traffic will be rerouted during rehabilitation.

No Salvage.

STATION 85+60.68
RE-BUILT 2010 BY
STATE OF ILLINOIS
F.A.I. ROUTE 55
SECTION 1717-2-3B-R
LOADING HS20
STRUCTURE NO. 016-1093

NAME PLATE

See Std. 515001

Note: Locate on Pier 3 as shown on Sheet No. SB21.

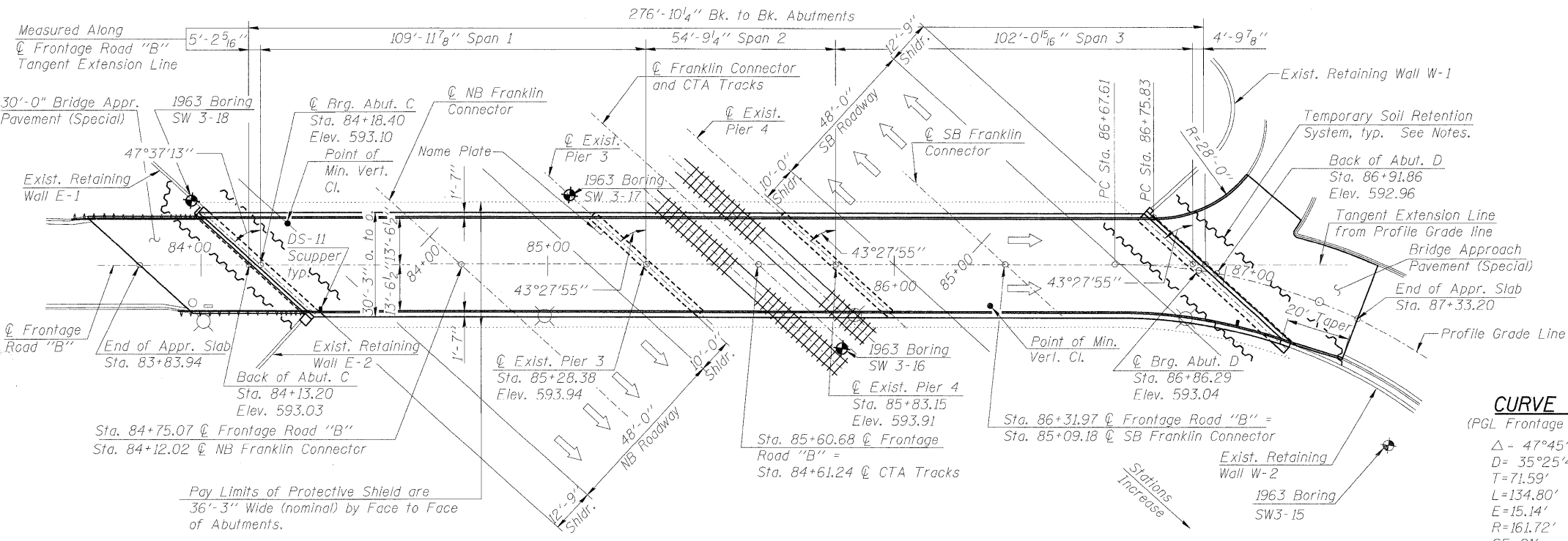
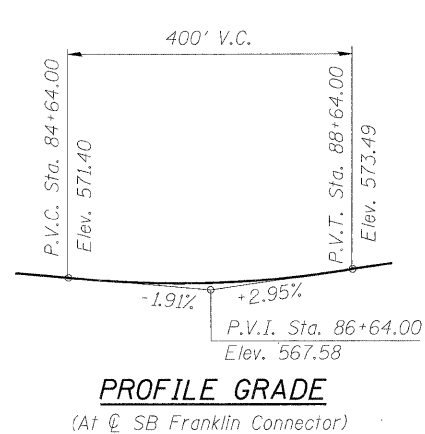
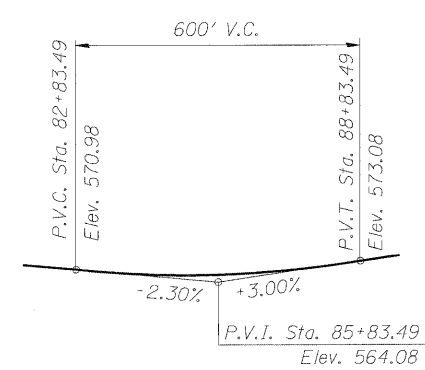
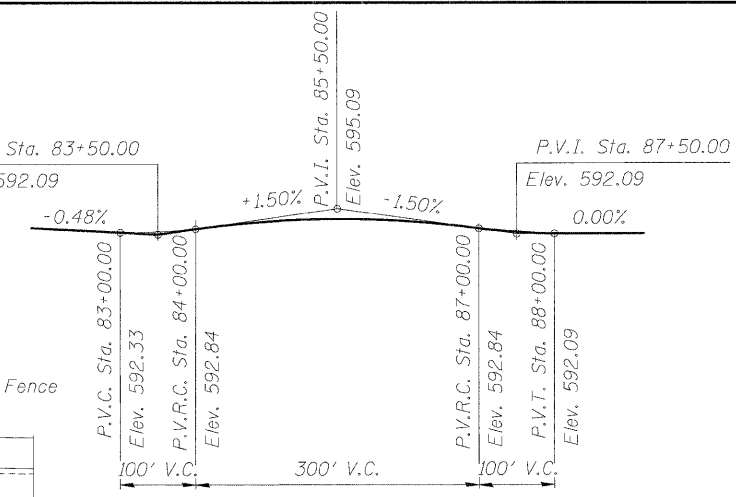
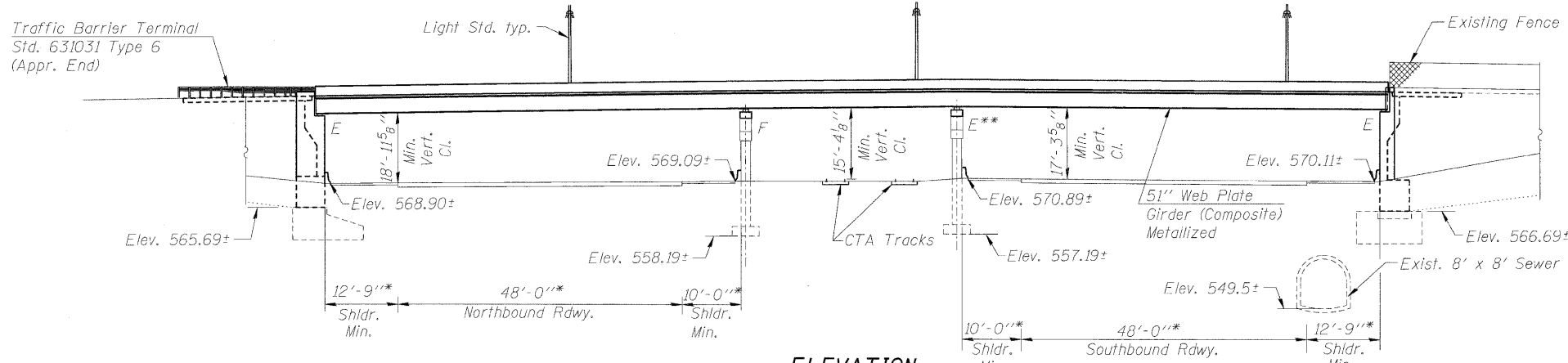

CURVE DATA

(PGL Frontage Road "B")
 $\Delta = 47^\circ 45' 29''$
 $D = 35^\circ 25' 44''$
 $T = 71.59'$
 $L = 134.80'$
 $E = 15.14'$
 $R = 161.72'$
 $SE = 2\%$
 $P.C. = Sta. 86+67.61$
 $P.T. = Sta. 88+02.41$
 $P.I. = Sta. 87+35.01$

APPROVED
FOR STRUCTURAL ADEQUACY ONLY
Ralph E. Anderson (TRD)
ENGINEER OF BRIDGES AND STRUCTURES

DESIGN SPECIFICATIONS

2002 AASHTO, 17th Edition.

LOADING HS20-44

Allow 50 #/sq. ft. for future wearing surface.

SEISMIC DATA

Seismic Performance Category (SPC) = A
 Bedrock Acceleration Coeff. (A) = 0.04g
 Site Coefficient (S) = 1.0

DESIGN STRESSES

FIELD UNITS

New Construction:
 $f'_c = 3,500$ psi
 $f_y = 60,000$ psi (Reinforcement)
 $f_y = 50,000$ psi (M270 Grade 50) - Primary
 $f_y = 36,000$ psi (M270 Grade 36)

Existing Construction:
 $f'_c = 3,500$ psi
 $f_y = 40,000$ psi (Reinforcement)

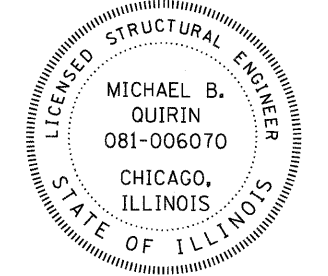

SIGNED *Michael B. Quirin*

DATE: 1-13-09

EXPIRES: 11-30-10

NOTES:

- For existing utility information, see roadway drawings.
- For Bridge Approach Pavement details, see roadway drawings.
- For additional geometry related to the offset of Frontage Road "B" near Abutment D, see Sheet No. SB2.
- Temporary Soil Retention System is included in the cost for Braced Excavation.

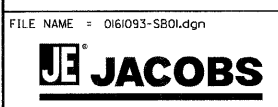
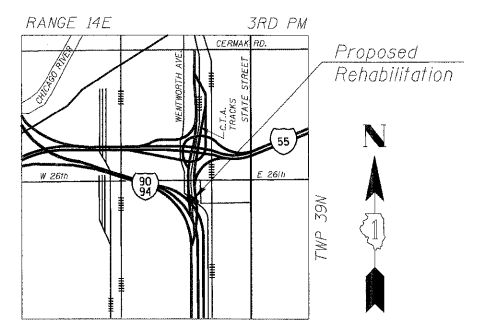

FILE NAME = 0161093-SB01.dgn	DESIGNED - LSD	REVISED -
	DRAWN - JJN	REVISED -
	CHECKED - TNS	REVISED -
PLOT DATE = 1/12/2009	DATE = 1/13/09	REVISED -

STATE OF ILLINOIS
DEPARTMENT OF TRANSPORTATION

GENERAL PLAN AND ELEVATION		
F.A.P. 392 FRANKLIN CONNECTOR (AT I-55 FRONTAGE ROAD B)		
STRUCTURE NO. 016-1093		
SCALE: NTS	SHEET NO. SB1 OF SB24 SHEETS	STA. 85+60.68

F.A.P. RTE.	SECTION	COUNTY	TOTAL SHEETS	SHEET NO.
392	1717-2-3B-R	COOK	114	79
FED. ROAD DIST. NO. 7 ILLINOIS FED. AID PROJECT			CONTRACT NO. 62197	