

**LEGEND**

- ▣ UNDERPASS LUMINAIRE, 70W HPS
- ▣ JUNCTION BOX, STAINLESS STEEL, ATTACHED TO STRUCTURE, SIZE NOTED
- ⊕ CONDUIT ATTACHED TO STRUCTURE, 1" DIA. UNLESS OTHERWISE NOTED.
- DENOTES PHASE CONDUCTORS (#10 AWG MIN.)
- DENOTES NEUTRAL CONDUCTOR
- DENOTES GROUND CONDUCTOR (#10 INSULATED.)

**NOTES:**

1. UNLESS OTHERWISE INDICATED, ALL ITEMS OF WORK SHOWN ON THESE PLANS ARE PROPOSED NEW ITEMS OF WORK.
2. THERE SHALL NOT BE ANY UNDERGROUND SPLICES.
3. EXISTING UNDERPASS LUMINAIRES SHALL BE TRANSFERRED TO STATE STOCK AFTER REMOVAL
4. THE EXISTING ELECTRICAL CONNECTION TO THE BRIDGE MOUNT SIGN LUMINAIRE(S) SHALL BE TEMPORARILY DISCONNECTED BY THE CONTRACTOR PRIOR TO REMOVAL OF THE SIGN STRUCTURE, AND SHALL BE RE-CONNECTED BY THE CONTRACTOR UPON RE-ERECTION OF THE SIGN STRUCTURE AND SIGN PANEL. THIS WORK SHALL NOT BE PAID FOR SEPARATELY, BUT SHALL BE INCLUDED IN THE COST OF REMOVAL OF EXISTING CONCRETE DECK.

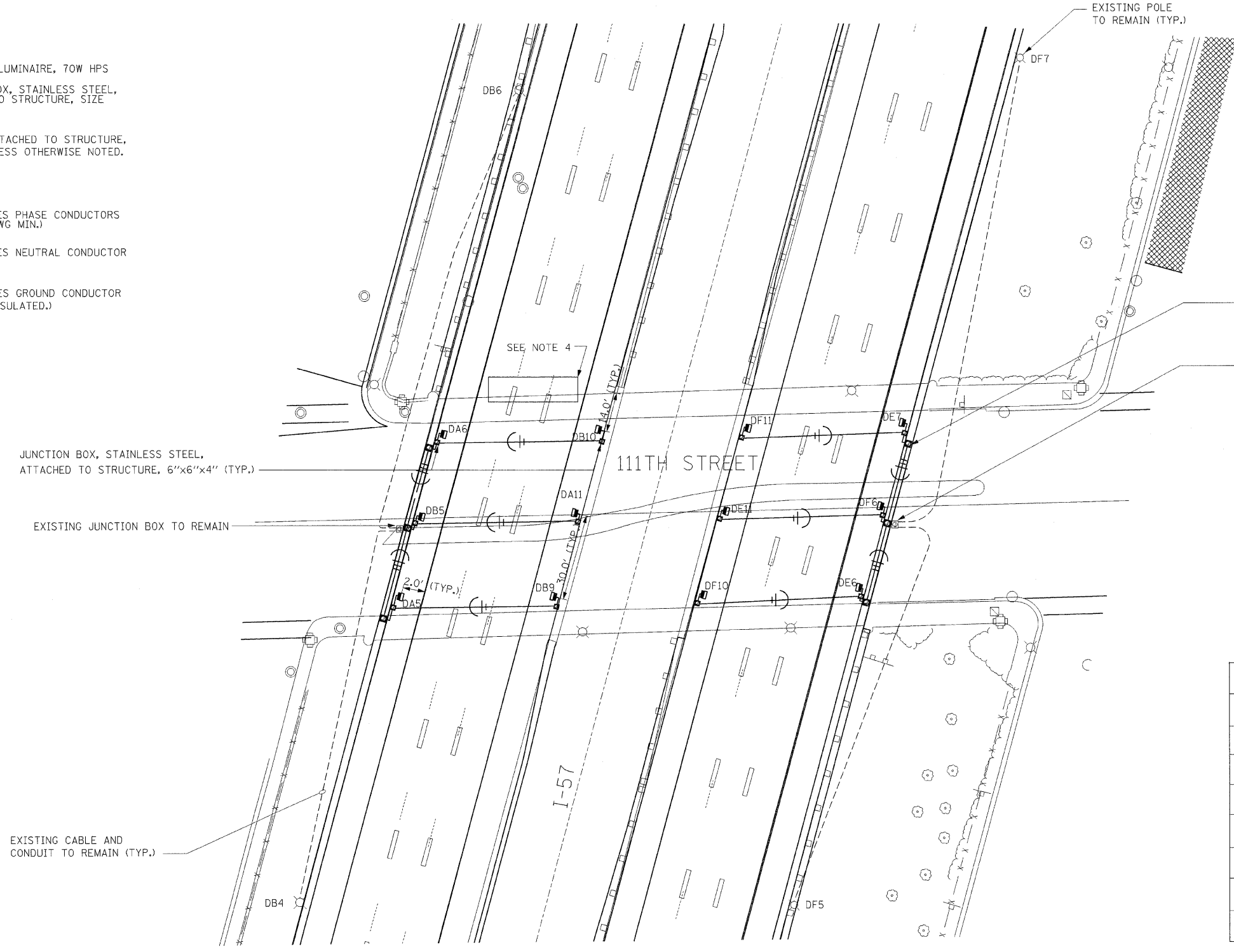

JUNCTION BOX, STAINLESS STEEL, ATTACHED TO STRUCTURE, 12" X 10" X 6" (TYP.)

EXISTING JUNCTION BOX TO REMAIN

JUNCTION BOX, STAINLESS STEEL, ATTACHED TO STRUCTURE, 6" X 6" X 4" (TYP.)

EXISTING JUNCTION BOX TO REMAIN

EXISTING CABLE AND CONDUIT TO REMAIN (TYP.)

**BILL OF MATERIALS**

ITEM	UNIT	QUANTITY
CONDUIT ATTACHED TO STRUCTURE, 1" DIAMETER, RIGID GALVANIZED STEEL, PVC COATED	FOOT	820
JUNCTION BOX, STAINLESS STEEL, EMBEDDED IN STRUCTURE, 12" X 10" X 6"	EACH	6
JUNCTION BOX, STAINLESS STEEL, EMBEDDED IN STRUCTURE, 6" X 6" X 4"	EACH	12
ELECTRIC CABLE IN CONDUIT, 600V, (EPR-TYPE RHW) 1/C NO. 10	FOOT	2860
UNDERPASS LUMINAIRE, 70 WATT, HPS VAPOR, STAINLESS STEEL HOUSING	EACH	12
REMOVE EXISTING UNDERPASS LUMINAIRE	EACH	12
MAINTENANCE OF LIGHTING SYSTEM	CAL MO	8
PROTECT AND MAINTAIN EXISTING UNDERPASS LUMINAIRE	L SUM	1

E-4

REVISIONS	
NAME	DATE

ILLINOIS DEPARTMENT OF TRANSPORTATION  
111TH STREET OVER  
F.A.I ROUTE 57 (INTERSTATE 57)  
IDOT UNDERPASS LIGHTING PLAN

SCALE: 1" = 20'  
DATE: 01/16/09

DRAWN BY: ACL  
CHECKED BY: PR



..\ALTO07FF.DGN, ..\RDW005V6.DGN, ..\RDW005B3.DGN, ..\RDW005L6.DGN, ..\TP00014F.DGN, ..\WITH ST BORDER.DGN  
 F:\DOCUMENT\930806\CIVIL\DON\KXH000\PP.DGN  
 1 2 3 4 5 6 7 8 9 10 11 12 13 14 15 16 17 18 19 20 21 22 23 24 25 26 27 28 29 30 31 32 33 34 35 36 37 38 39 40 41 42 43 44 45 46 47 48 49 50 51 52 53 54 55 56 57 58 59 60 61 62 63