

STATE OF ILLINOIS  
 DEPARTMENT OF TRANSPORTATION  
 DIVISION OF HIGHWAYS  
**PROPOSED  
 HIGHWAY PLANS**

F.A. RTE.	SECTION	COUNTY	TOTAL SHEETS	SHEET NO.
OR 37	2004-076 RS	COOK	17	1
FED. ROAD DIST. NO.	ILLINOIS	CONTRACT NO. 62793		

D -91-272-04

FOR INDEX OF SHEETS, SEE SHEET NO. 2

THE PROJECT IS LOCATED IN THE VILLAGE OF RIVERSIDE

OR 37 (DES PLAINES AVE.)  
 26TH TO 31ST  
 SECTION: 2004-076 RS  
 RESURFACING (MAINTENANCE)  
 COOK COUNTY  
 C-91-272-04

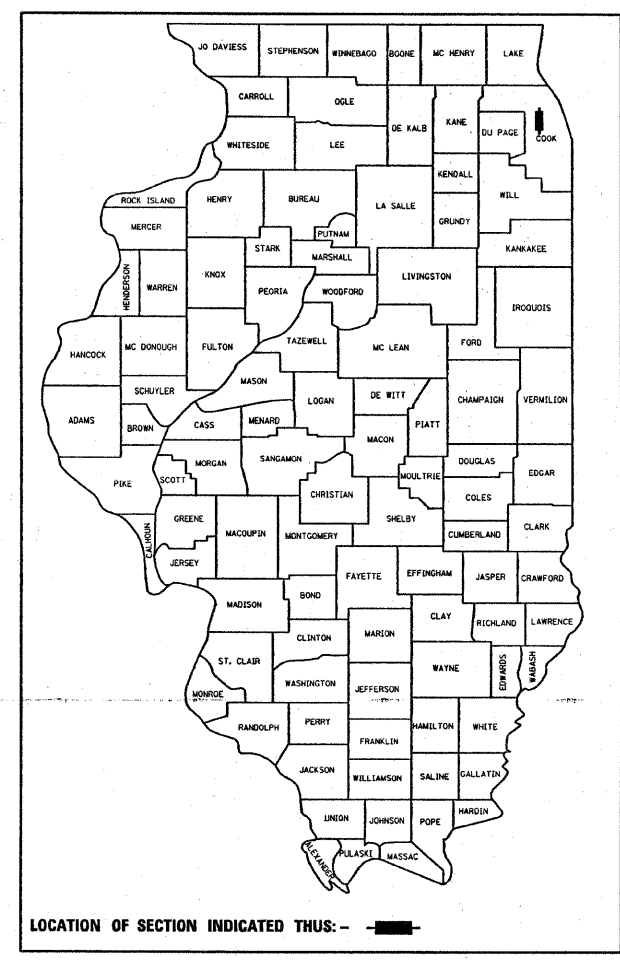

IMPROVEMENT BEGINS  
 STA. 15+03

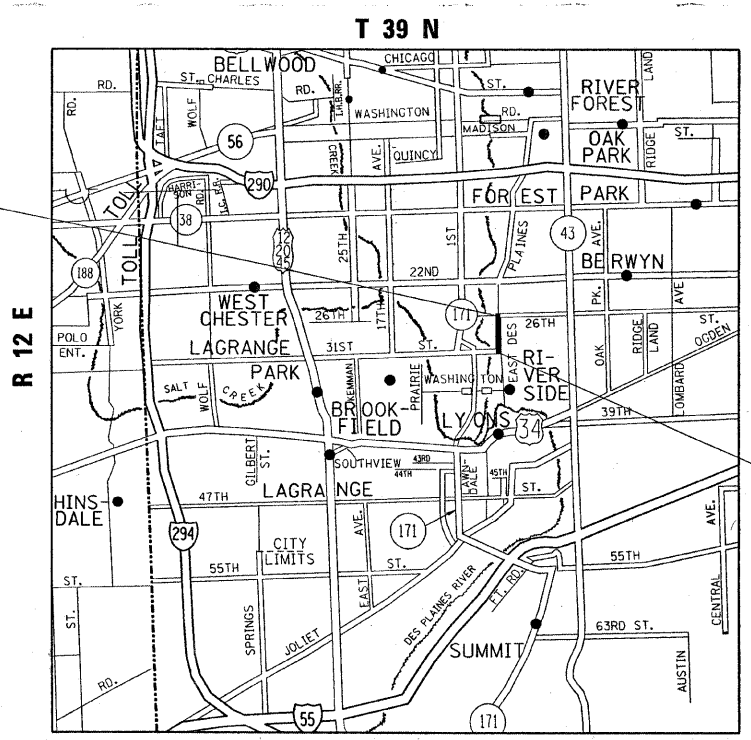

**TRAFFIC DATA**  
 2006 ADT = 12,900  
 POSTED SPEED LIMIT = 30 MPH

IMPROVEMENT ENDS  
 STA. 40+10

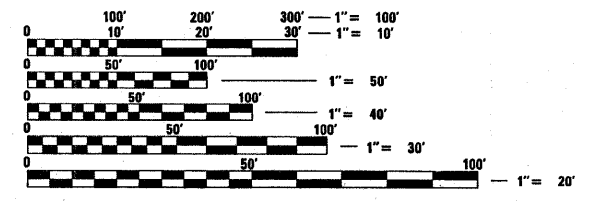

FULL SIZE PLANS HAVE BEEN PREPARED USING STANDARD ENGINEERING SCALES. REDUCED SIZED PLANS WILL NOT CONFORM TO STANDARD SCALES. IN MAKING MEASUREMENTS ON REDUCED PLANS, THE ABOVE SCALES MAY BE USED.

J.U.L.I.E.  
 JOINT UTILITY LOCATION INFORMATION FOR EXCAVATION  
 1-800-892-0123  
 OR 811

PROJECT ENGINEER  
 PROJECT MANAGER KEN ENG (847) 705-4247

GROSS & NET LENGTH OF PROJECT = 2,507 LINEAL FEET = 0.47 MILE

CONTRACT NO. 62793

STATE OF ILLINOIS  
 DEPARTMENT OF TRANSPORTATION  
 DIVISION OF HIGHWAYS

SUBMITTED JANUARY 8, 20 09

*Diana M. O'Keefe*  
 DEPUTY DIRECTOR OF HIGHWAYS, REGION ENGINEER  
 March 13, 20 09

*Charles J. Ingemoll*  
 ENGINEER OF DESIGN AND ENVIRONMENT

March 13, 20 09  
*Christina M. Reed*  
 DIRECTOR OF HIGHWAYS, CHIEF ENGINEER

PRINTED BY THE AUTHORITY  
 OF THE STATE OF ILLINOIS