

SCHEDULE OF QUANTITIES
MAGNETIC DETECTOR AND LOOP DETECTOR REPLACEMENT

QUANTITY	UNIT	PAY ITEM
504'	FOOT	ELECTRIC CABLE IN CONDUIT, LEAD-IN, NO. 14 1 PAIR
2	EACH	INDUCTIVE LOOP DETECTOR
132'	FOOT	DETECTOR LOOP, TYPE I
525'	FOOT	DETECTOR LOOP REPLACEMENT
1	EACH	MAINTENANCE OF EXISTING TRAFFIC SIGNAL INSTALLATION
0	FOOT	TRENCH AND BACKFILL FOR ELECTRICAL WORK
2	EACH	DRILL EXISTING HANDHOLE
430'	FOOT	REMOVE ELECTRICAL CABLE FROM CONDUIT

NOTE:
 THIS PLAN IS FOR THE PURPOSE OF REPLACING THE DETECTOR LOOPS ONLY. ALL OTHER INFORMATION SHOWN IS NOT RELATED AND WILL BE DISREGARDED

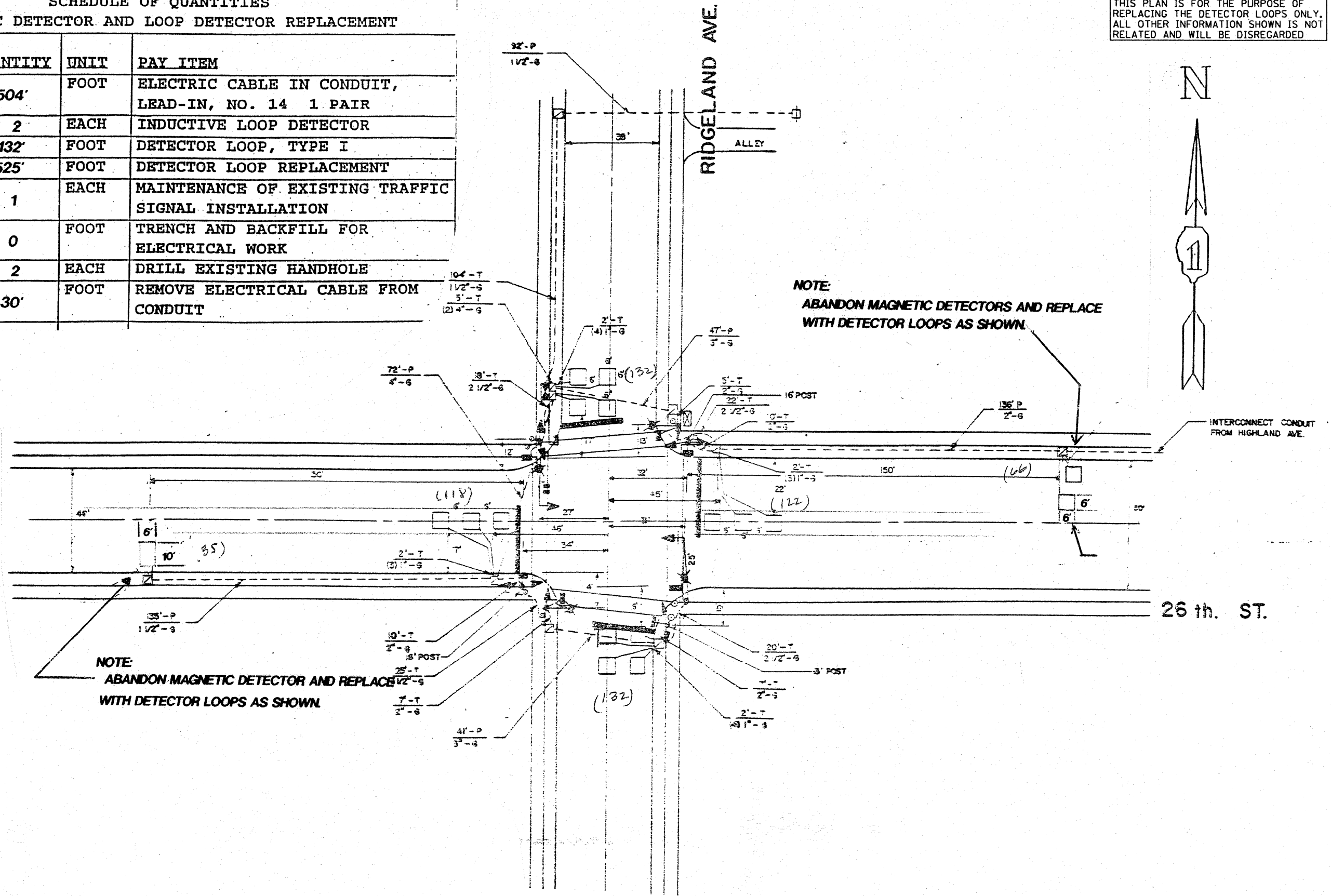

NOTE:
 ABANDON MAGNETIC DETECTOR AND REPLACE WITH DETECTOR LOOPS AS SHOWN

NOTE:
 ABANDON MAGNETIC DETECTORS AND REPLACE WITH DETECTOR LOOPS AS SHOWN

FILE NAME =	USER NAME = guillaumefp	DESIGNED -	REVISED -	STATE OF ILLINOIS DEPARTMENT OF TRANSPORTATION	26TH STREET /25TH PLACE (IL 43 TO IL 50) 26TH STREET & RIDGELAND AVENUE	F.A.U. RTE.	SECTION	COUNTY	TOTAL SHEETS	SHEET NO.	
ca:\pwwork\VPWIDDT\GUILLAUMEFP\d0117416\131984-Design.dgn	131984-Design.dgn	DRAWN -	REVISED -			1459	(0505.1, 0606 & 0707) RS-12	COOK	32	17	
PLOT SCALE = 1/8" = 1' / IN.		CHECKED -	REVISED -			SCALE: SHEET NO. OF SHEETS STA. TO STA.		CONTRACT NO. 62818			
PLOT DATE = 1/6/2009		DATE -	REVISED -			FED. ROAD DIST. NO. 1 ILLINOIS FED. AID PROJECT					