

NOTE:
 THIS PLAN IS FOR THE PURPOSE OF REPLACING THE DETECTOR LOOPS ONLY. ALL OTHER INFORMATION SHOWN IS NOT RELATED AND WILL BE DISREGARDED

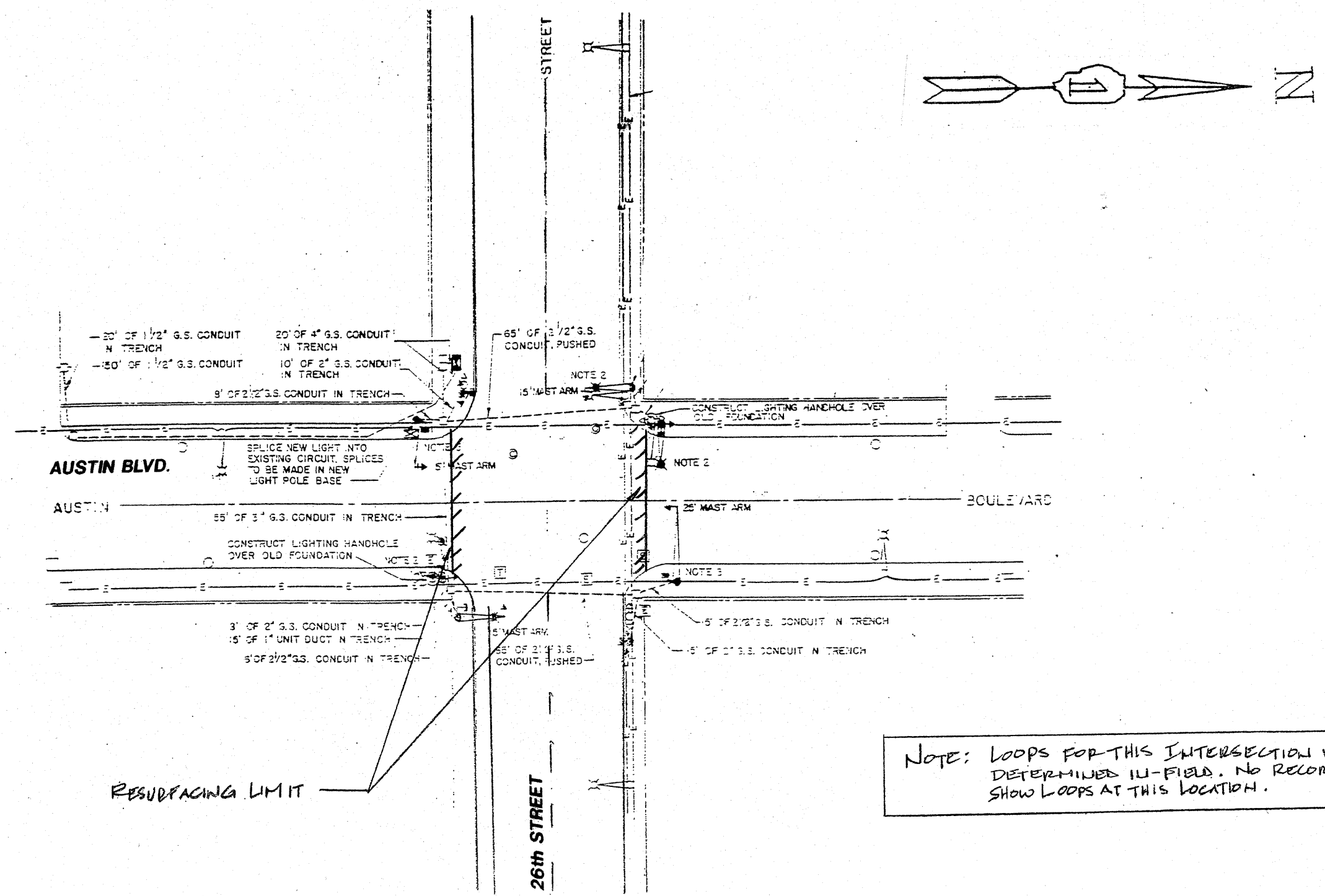

NOTE: LOOPS FOR THIS INTERSECTION WILL BE DETERMINED IN-FIELD. NO RECORD PLANS SHOW LOOPS AT THIS LOCATION.

**REPLACE ALL DETECTOR LOOPS AS SHOWN
 (WITHIN THE RESURFACING LIMITS)**

CODE NO.	QUANTITY	UNIT	ITEM
88600600	(SEE NOTE)	FOOT	DETECTOR LOOP REPLACEMENT