

F.A.P. RTE.	SECTION	COUNTY	TOTAL SHEETS	SHEET NO.
681	(115)RS-1	LIVINGSTON	279	58
STA.	155+00.00	TO STA.	161+00	
FED. ROAD DIST. NO.	ILLINOIS	FED. AID PROJECT		
CONTRACT NO. 66375				

**GENERAL EROSION CONTROL NOTES:**

1. TREE ROOT PRUNING WILL BE REQUIRED FOR THIS PROJECT. TREE ROOT PRUNING WILL BE DETERMINED BY THE ENGINEER AT THE START OF CONSTRUCTION. PAY ITEMS HAVE BEEN INCLUDED IN THE SUMMARY OF QUANTITIES AND SCHEDULES HAVE BEEN PROVIDED.
2. THE CONTRACTOR WILL BE REQUIRED TO SUBMIT CERTIFICATION STATEMENT (NPDES ATTACHMENT 6). FULL COMPLIANCE WITH ALL TERMS OF THE NPDES PERMIT MUST BE STRICTLY ADHERED TO.
3. ALL STRUCTURES NOTED FOR INLET AND PIPE PROTECTION OR AS DIRECTED BY THE ENGINEER ARE TO BE PROVIDED AND MAINTAINED. PAY ITEM HAVE BEEN INCLUDED IN THE SUMMARY OF QUANTITIES AND SCHEDULES HAVE BEEN PROVIDED.

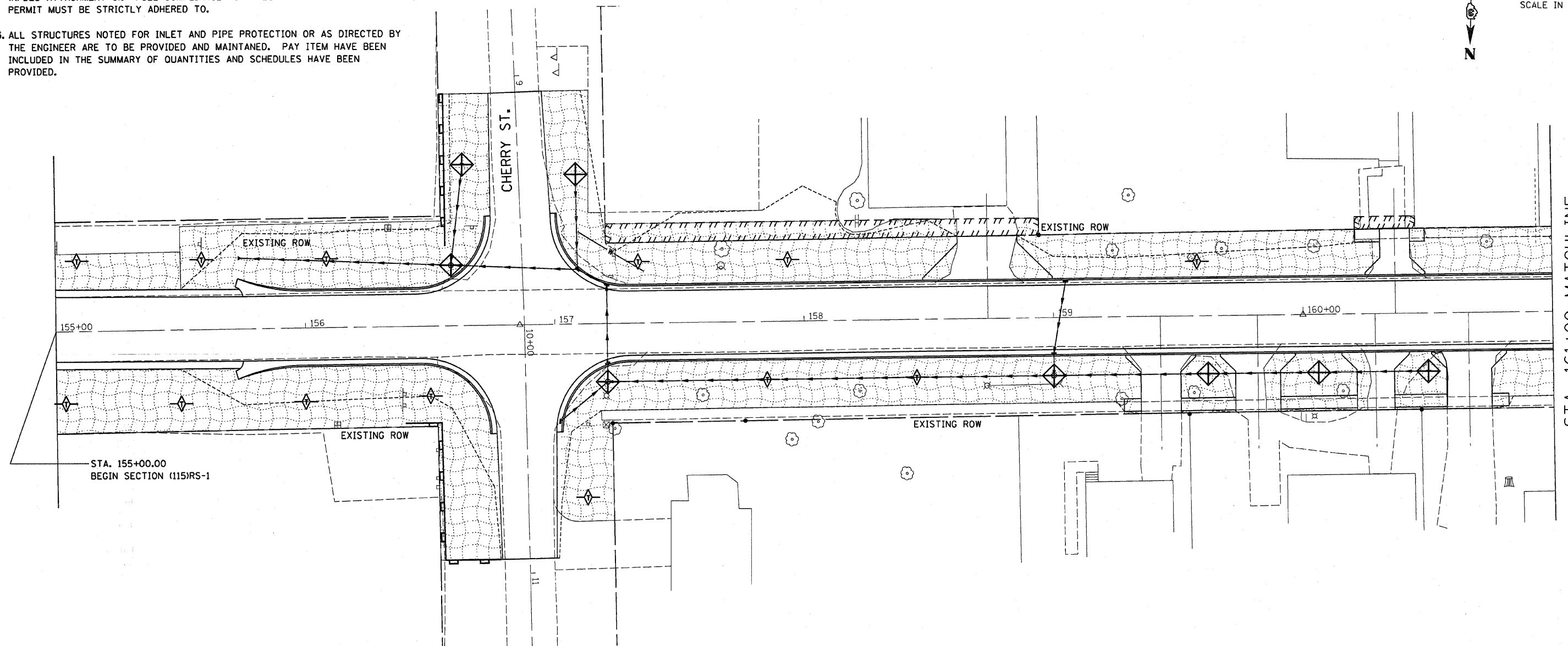
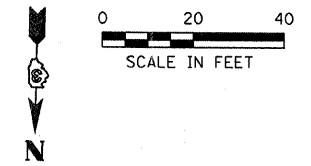

**LEGEND**

- RIPRAP
- TEMPORARY EROSION CONTROL SEEDING
- TEMPORARY EASEMENT
- INLET & PIPE PROTECTION
- DITCH CHECK
- PROPOSED STORM SEWER
- DECIDUOUS TREE/SIZE TO BE REMOVED
- EX DECIDUOUS TREE/SIZE
- EX EVERGREEN TREE/SIZE
- PERIMETER EROSION BARRIER (SEE NOTE 2)

**NOTES:**

1. THE CONSTRUCTION LIMITS WILL BE STAKED BY THE ENGINEER PRIOR TO COMMENCING CONSTRUCTION. THE CONSTRUCTION LIMITS MAY BE ADJUSTED BY THE ENGINEER TO PRESERVE TREES AND NO ADDITIONAL COMPENSATION WILL BE PAID TO THE CONTRACTOR FOR CHANGED CONSTRUCTION LIMITS.
2. PERIMETER EROSION BARRIER SHALL BE ERECTED ADJACENT TO TEMPORARY CONSTRUCTION FENCE. THE RESIDENT ENGINEER SHALL HAVE FINAL DETERMINATION OF THE PLACEMENT AND LOCATION OF THE PERIMETER EROSION BARRIER.
3. SEE LANDSCAPING PLANS FOR SODDING INFORMATION.
4. SEE CROSS SECTIONS FOR GRADING INFORMATION.
5. SEE PROPOSED DRAINAGE PLANS FOR STORM SEWER INFORMATION.

REVISIONS	
NAME	DATE
IDOT REV. - MDS	10/08

ILLINOIS DEPARTMENT OF TRANSPORTATION  
**EROSION CONTROL PLAN**  
 FAP 681 (IL RTE. 116)  
 SECTION (115)RS-1  
 LIVINGSTON COUNTY  
 VILLAGE OF CULLOM

SCALE: AS SHOWN      DRAWN BY: EJR  
 DATE      CHECKED BY: TMM

**McDonough-Whitlow, P.C.**  
 Consulting Engineers & Land Surveyors

138 East Wood Street  
 Havana, IL 62449  
 Phone: 217.532.5233  
 Fax: 217.532.6300  
 MW PROJ. # 03-080