

F.A.P. NO.	SECTION	COUNTY	TOTAL SHEETS	SHEET NO.
681	(115)RS-1	LIVINGSTON	279	65
STA. 196+00		TO STA. 202+00		
FED. ROAD DIST. NO.	ILLINOIS FED. AID PROJECT			
CONTRACT NO. 66375				

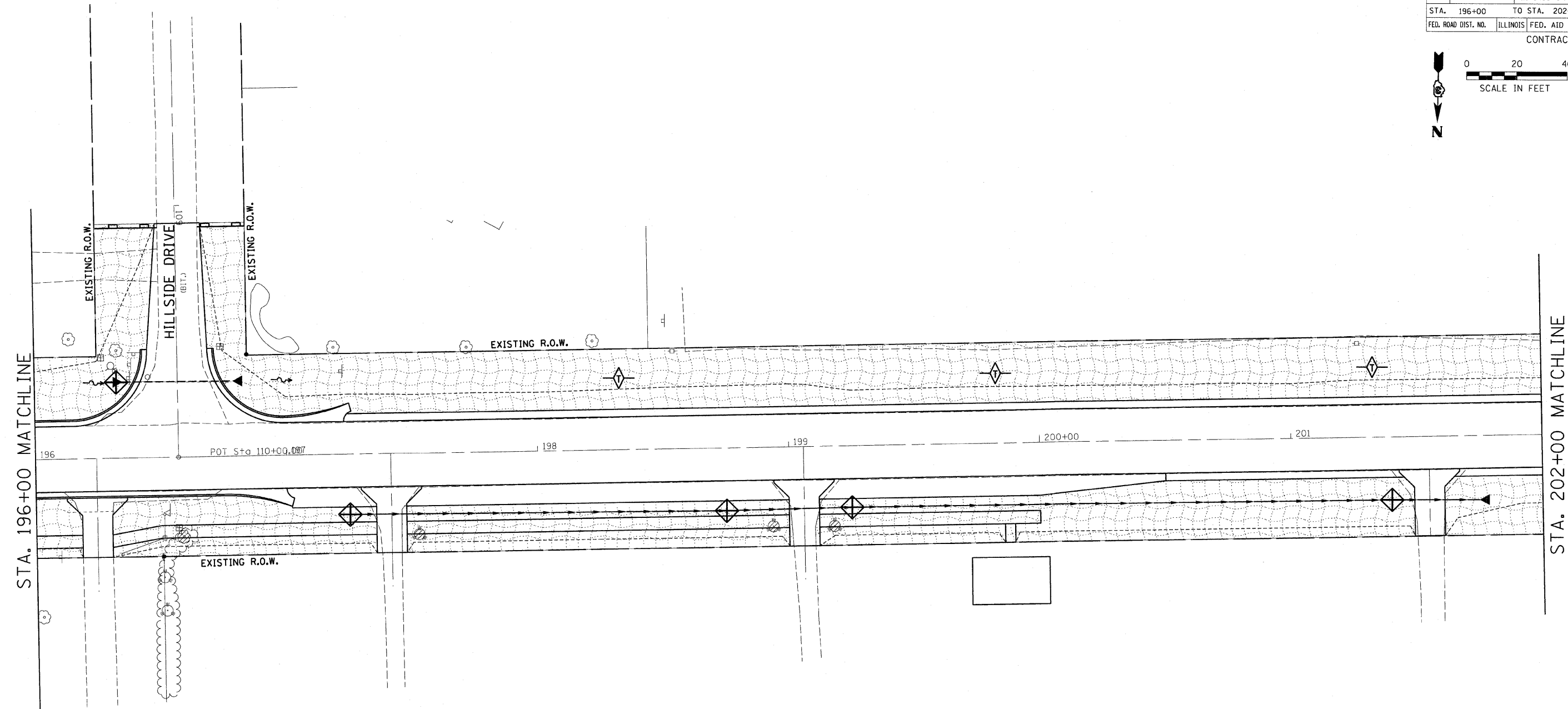
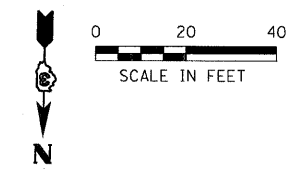

REVISIONS	
NAME	DATE

ILLINOIS DEPARTMENT OF TRANSPORTATION

EROSION CONTROL PLAN

FAP 681 (IL RTE. 116)
SECTION (115)RS-1
LIVINGSTON COUNTY
VILLAGE OF CULLOM

SCALE: AS SHOWN DRAWN BY: EJR

DATE CHECKED BY: TMM

McDonough-Whitlow, P.C.
Consulting Engineers & Land Surveyors

138 East Wood Street
Hillboro, IL 62049
Phone: 217.532.9233
Fax: 217.532.6300
WWW.MCDONOUGH-WHITLOW.COM

1/8/2009 9:24:45 AM LA:\03145\DRAWINGS\EROSION.dgn