

F.A.P. RTE.	SECTION	COUNTY	TOTAL SHEETS	SHEET NO.
681	115RS-1	LIVINGSTON	219	200
STA. 176+08.89		TO STA. 176+52.57		
FED. ROAD DIST. NO. ILLINOIS		FED. AID PROJECT		
CONTRACT NO. 66375				

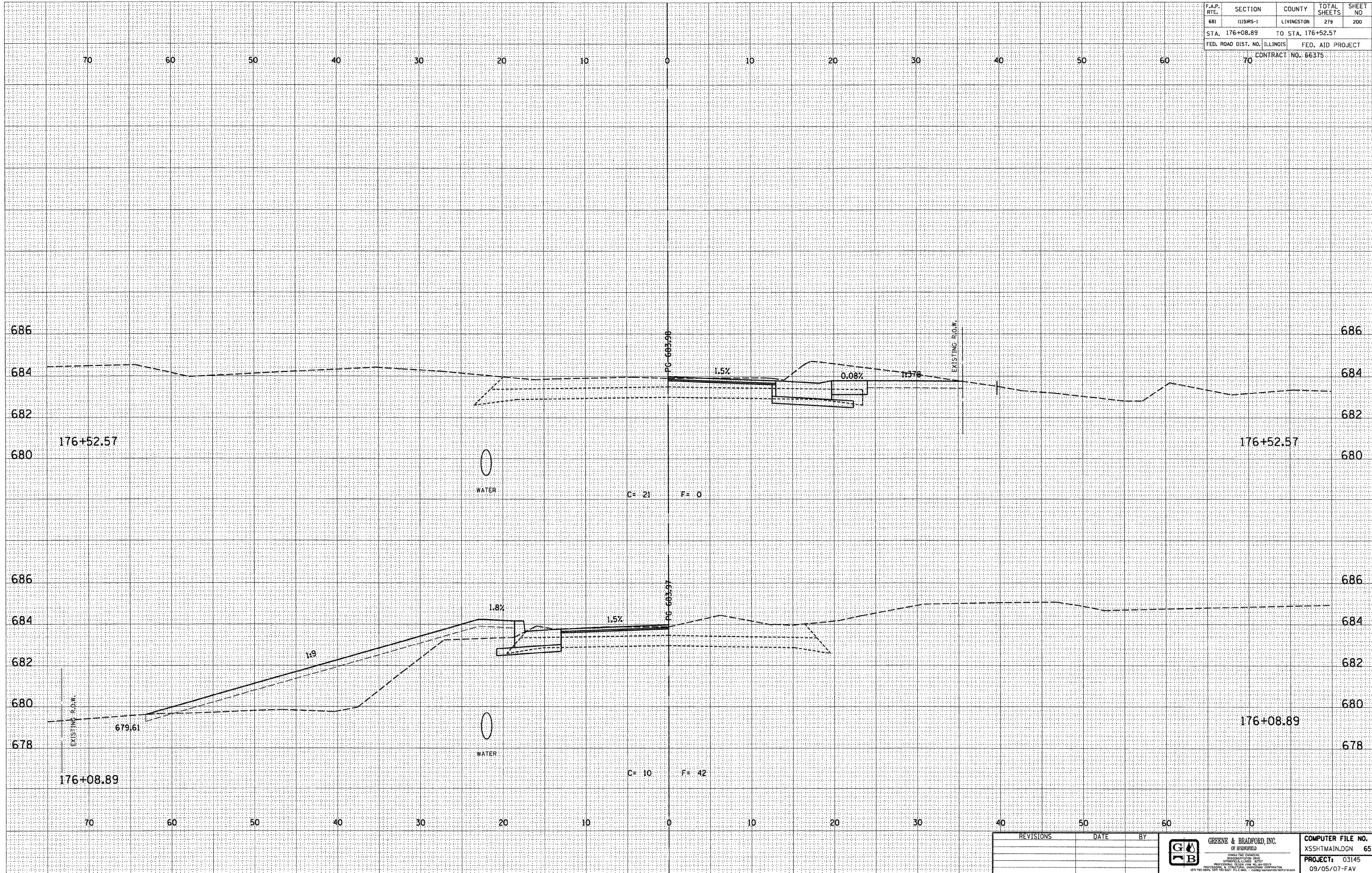

DESIGN		
INT.	DATE	REASON

BY	DATE

FINAL SURVEY	SURVEYED	DATE
NOTE BOOK	PLOTTED	DATE
NO.	AREAS CHECKED	AREAS CHECKED

PLOTS & CHECKS			
INT.	DATE	NO.	REASON

BY	DATE

ORIGINAL SURVEY	SURVEYED	DATE
NOTE BOOK	PLOTTED	DATE
NO.	AREAS CHECKED	AREAS CHECKED

CHECKS		
INT.	DATE	REASON

REVISIONS	DATE	BY

	GREENE & BRADFORD, INC. OF STURDFIELD	COMPUTER FILE NO. XSSHTMAIN.DGN 65
	REGISTERED PROFESSIONAL ENGINEERS ILLINOIS LICENSE NO. 03145	PROJECT: 03145
	PROFESSIONAL ENGINEER ILLINOIS LICENSE NO. 09/05/07-FAV	DATE: 09/05/07-FAV

E-XSEC 2:1 06/09/03

CROSS SECTIONS - FAP 681 (IL RTE. 116) LIVINGSTON COUNTY  
STA. 176+08.89 TO STA. 176+52.57