



SEE DETAIL FOR HMA SURFACE REMOVAL- BUTT JOINT  
SHEET 40 OF 56

STATION EQUATION  
STA. 765+84.00 BK =  
STA. 0+00.00 AH =  
STA. 350+15.3 (ARTHUR RD.)

SEE PAVEMENT MARKING DETAIL  
SHEET 48 OF 56

PROJECT BEGINS  
BUTT JOINT  
STA. 759+39 - 759+69

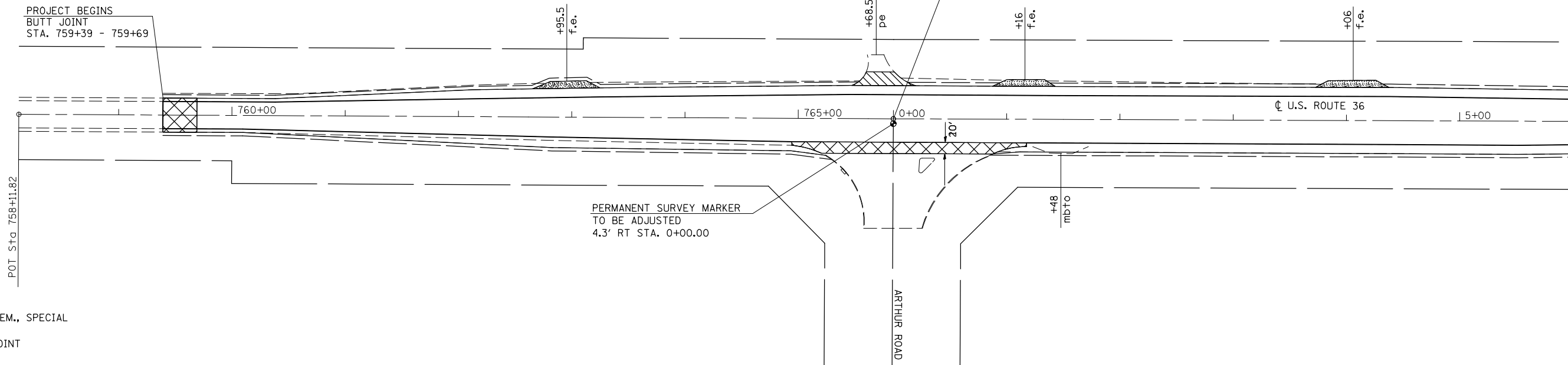

PERMANENT SURVEY MARKER  
TO BE ADJUSTED  
4.3' RT STA. 0+00.00

POT Sta 758+11.82

MATCHLINE STA. 6+00

- PCC SURF. REM., SPECIAL
- HMA BUTT JOINT
- INCIDENTAL BIT SURF.
- HMA SURF. REM., SPECIAL

SEC. 1, T. 15 N., R. 6 E., 3RD P.M.  
MOULTRIE COUNTY

SEC. 6, T. 15 N., R. 7 E., 3RD P.M.  
DOUGLAS COUNTY



STATION EQUATION  
STA. 18+37.66 BK =  
STA. 18+78.66 AH =

MATCHLINE STA. 6+00

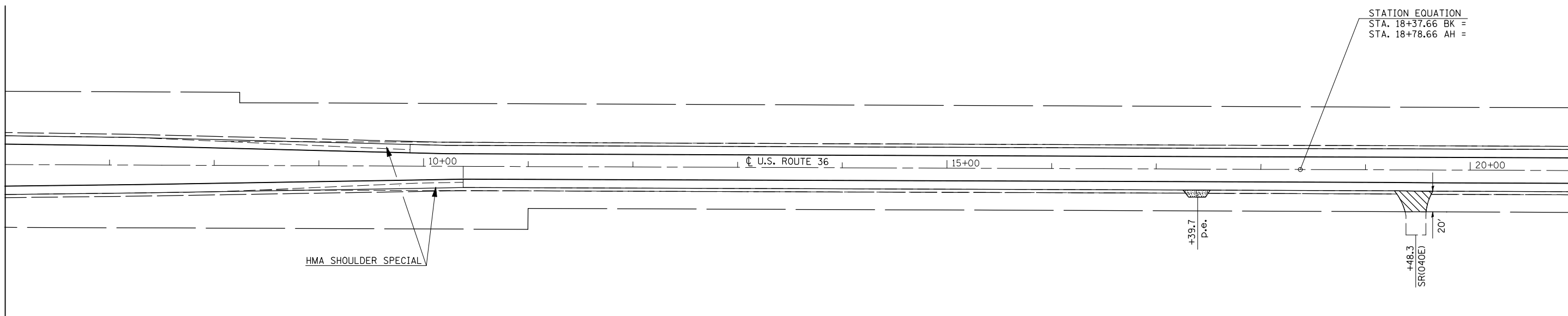

HMA SHOULDER SPECIAL

MATCHLINE STA. 21+00

SEC. 6, T. 15 N., R. 7 E., 3RD P.M.  
DOUGLAS COUNTY

• (143-R,144)RS-4      \*\* DOUGLAS & PIATT

FILE NAME =	USER NAME = austinr1	DESIGNED -	REVISED -
ct:\pw\work\PIWIDOT\AUSTINRL\dms86981\70256plansheets.dgn		DRAWN -	REVISED -
	PLOT SCALE = 100.0000' / IN.	CHECKED -	REVISED -
	PLOT DATE = 1/23/2009	DATE -	REVISED -

**STATE OF ILLINOIS**  
**DEPARTMENT OF TRANSPORTATION**

**U.S. 36 PLAN SHEETS**

SCALE: 50      SHEET NO.      OF      SHEETS      STA. 759+39      TO STA. 21+00

F.A.P. RTE.	SECTION	COUNTY	TOTAL SHEETS	SHEET NO.
323	*	**	56	21
FED. ROAD DIST. NO.			ILLINOIS FED. AID PROJECT	
			CONTRACT NO. 70256	