

F.A.I. RTE.	SECTION	COUNTY	TOTAL SHEETS	SHEET NO.
74	(74,10-4,1)RS-1	PIATT & CHAMPAIGN	69	1

★ 69+4=73

STATE OF ILLINOIS  
DEPARTMENT OF TRANSPORTATION  
DIVISION OF HIGHWAYS

**PROPOSED  
HIGHWAY PLANS**

F.A.I. ROUTE 74  
SECTION (74,10-4,1)RS-1  
PIATT & CHAMPAIGN COUNTIES  
PROJECT ESP-074-5(158)166

RESURFACING (INT-2ND)  
MANSFIELD TO MAHOMET  
C-95-047-06

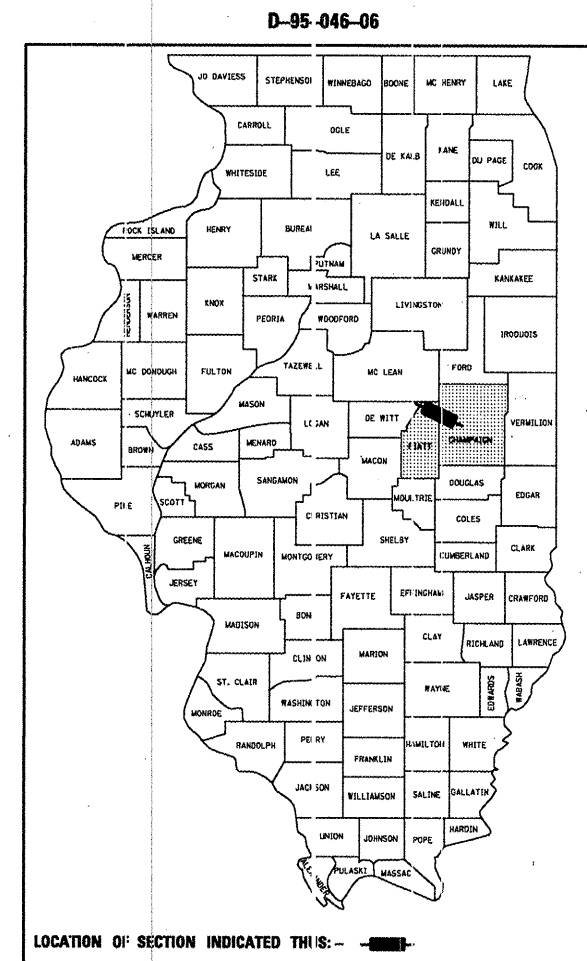

FOR INDEX OF SHEETS, SEE SHEET NO. 2  
FOR SUMMARY OF QUANTITIES, SEE SHEET NO. 5-7

PROJECT ENGINEER: KEVIN TRAPP  
SQUAD LEADER: JEFF SHERER  
DESIGNER: RANDY AUSTIN

**CURRENT TRAFFIC DATA**

CURRENT ADT	=	20,100 (2009)
20 YR ADT	=	32,700 (2009)
PU & PC %	=	64.4 (2009)
SU %	=	4.6 (2009)
MU %	=	31.0 (2009)

**DESIGN DESIGNATION**  
INTERSTATE

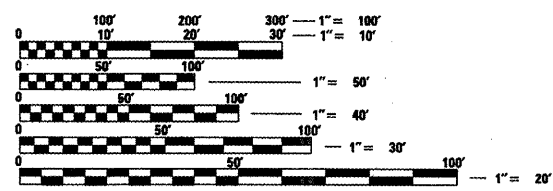

FULL SIZE PLANS HAVE BEEN PREPARED USING STANDARD ENGINEERING SCALES. REDUCED SIZED PLANS WILL NOT CONFORM TO STANDARD SCALES. IN MAKING MEASUREMENTS ON REDUCED PLANS, THE ABOVE SCALES MAY BE USED.

J.U.L.I.E.  
JOINT UTILITY LOCATION INFORMATION FOR EXCAVATION  
1-800-892-0123

CONTRACT NO. 70527

SECTION (74, 10-4, 1)RS-1 BEGINS STATION 1258+09  
SECTION (74, 10-4, 1)RS-1 ENDS STATION 1501+00

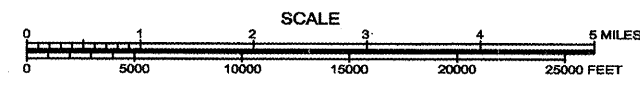
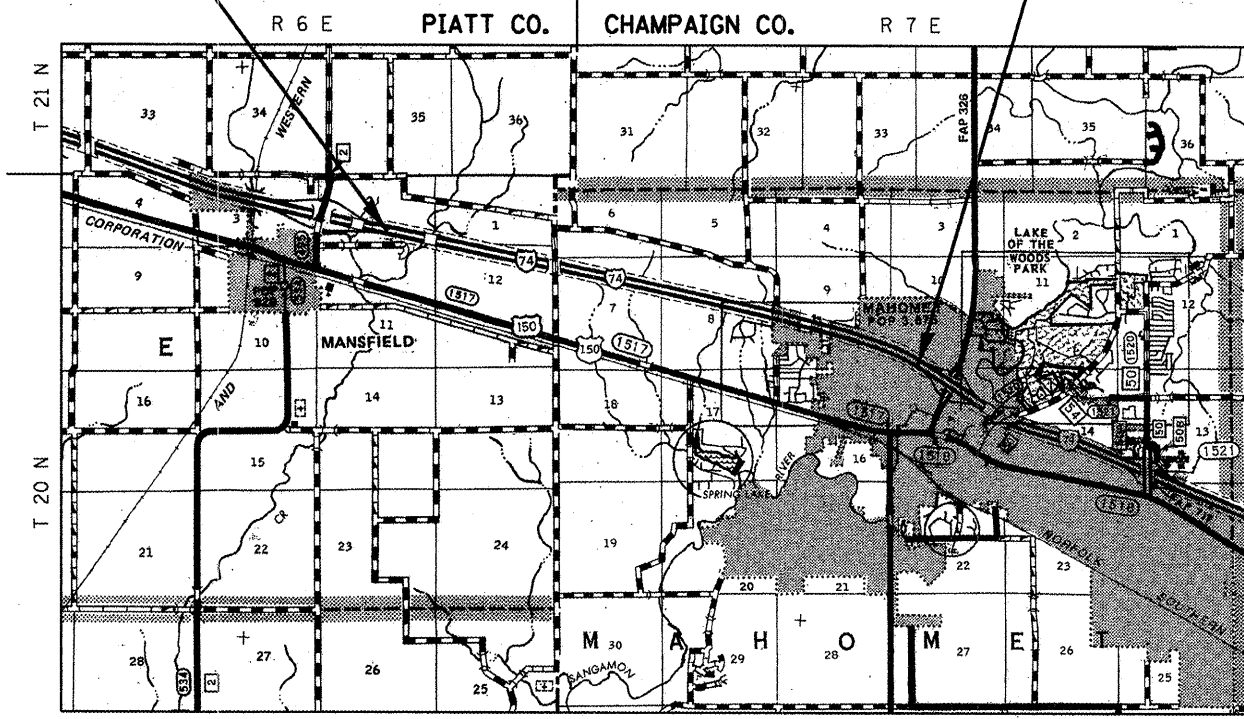

TOTAL LENGTH OF SECTION & PROJECT = 24,291.00 FEET = 4.601 MILES  
NET LENGTH OF SECTION & PROJECT = 24,291.00 FEET = 4.601 MILES

STATE OF ILLINOIS  
DEPARTMENT OF TRANSPORTATION  
DIVISION OF HIGHWAYS

SUBMITTED: 2/5, 21 09  
*Joseph M. K. Rowland*  
DEPUTY DIRECTOR OF HIGHWAYS, REGION THREE ENGINEER

March 13, 21 09  
*Charles G. Snay, III*  
ENGINEER OF DESIGN AND ENVIRONMENT

March 13, 21 09  
*Christine M. Reed*  
DIRECTOR OF HIGHWAYS, CHIEF ENGINEER

PRINTED BY THE AUTHORITY  
OF THE STATE OF ILLINOIS