

STATE OF ILLINOIS
DEPARTMENT OF TRANSPORTATION
DIVISION OF HIGHWAYS

**PROPOSED
HIGHWAY PLANS**

F.A.S. ROUTE 513
SECTION (48,54,55,0-1-15D,58)I-2
PROJECT ESP-0513(103)
PAVEMENT PATCHING
VERMILION COUNTY

F.A.S. RTE.	SECTION	COUNTY	TOTAL SHEETS	SHEET NO.
513	(48,54,55,0-1-15D,58)I-2	VERMILION	13	1
		ILLINOIS	CONTRACT NO. 70771	

FOR INDEX OF SHEETS, SEE SHEET NO. 2
FOR SUMMARY OF QUANTITIES, SEE SHEET NO. 3

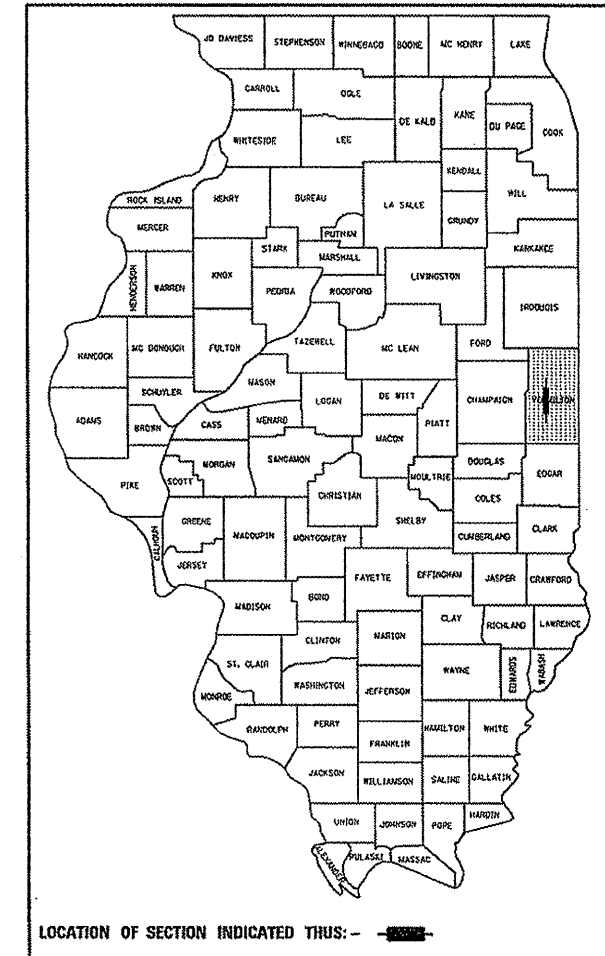

CURRENT ADT
F. A. S. 513 = 1300

DESIGN DESIGNATION
N/A

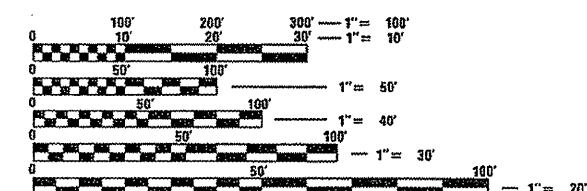

FULL SIZE PLANS HAVE BEEN PREPARED USING STANDARD ENGINEERING SCALES. REDUCED SIZED PLANS WILL NOT CONFORM TO STANDARD SCALES. IN MAKING MEASUREMENTS ON REDUCED PLANS, THE ABOVE SCALES MAY BE USED.

J.U.L.I.E.
JOINT UTILITY LOCATION INFORMATION FOR EXCAVATION
1-800-892-0123
OR 811 SIDELL, JAMAICA AND VANCE TOWNSHIPS

PROJECT ENGINEER
PROJECT MANAGER: BRIAN TRYGG
217-465-4181
CONTRACT NO. 70771

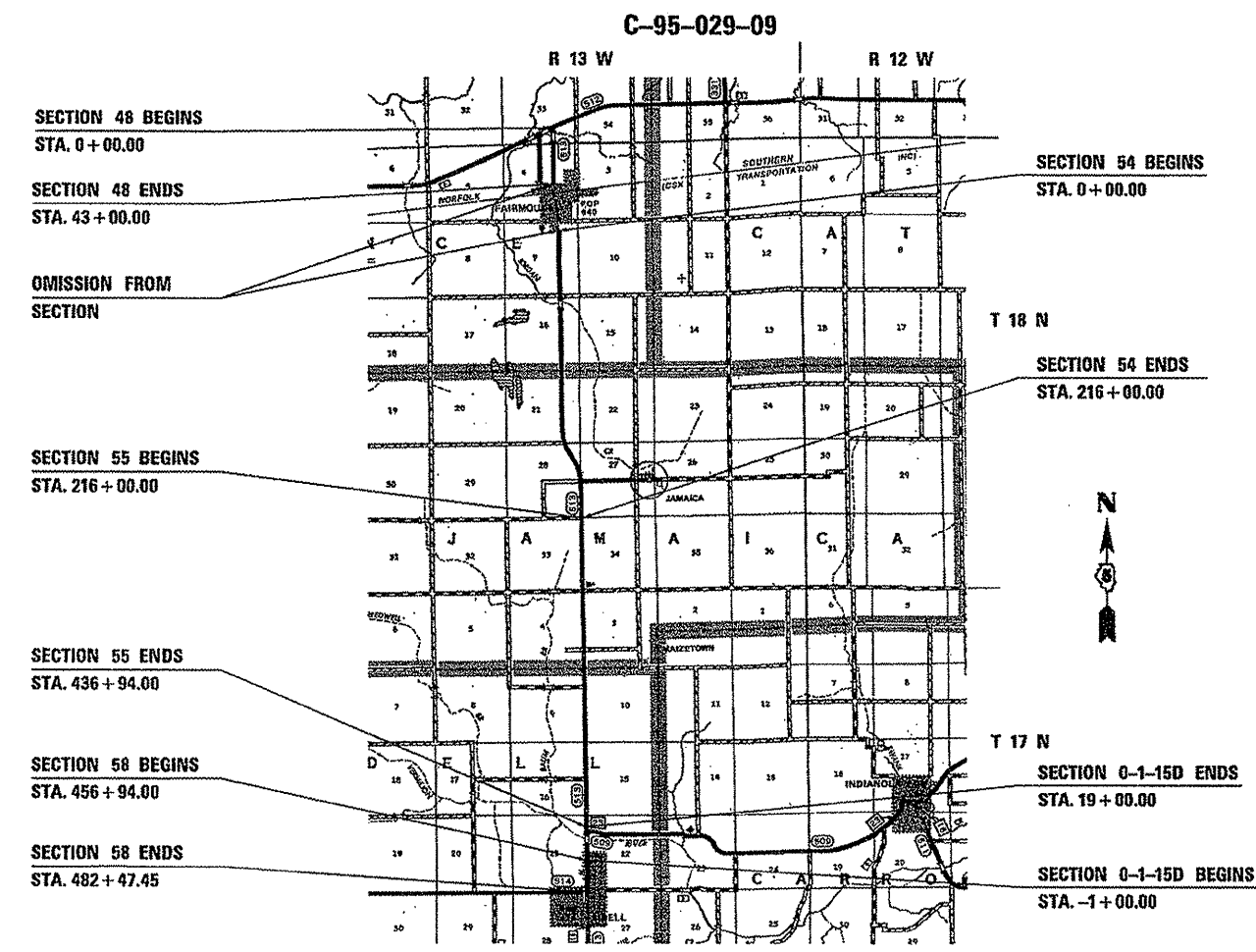

GROSS LENGTH = 55,070.40 FT. = 10.430 MILES
NET LENGTH = 53,903.45 FT. = 10.038 MILES

STATE OF ILLINOIS
DEPARTMENT OF TRANSPORTATION
DIVISION OF HIGHWAYS
SUBMITTED 2/17 20 09
Joseph K. Goussard
DEPUTY DIRECTOR OF HIGHWAYS, REGION ENGINEER
March 13, 20 09
Charles G. Ingersoll
ENGINEER OF DESIGN AND ENVIRONMENT
March 13, 20 09
Christiane M. Reed
DIRECTOR OF HIGHWAYS, CHIEF ENGINEER

**PRINTED BY THE AUTHORITY
OF THE STATE OF ILLINOIS**