

EXIST. CURVE C1  
 PI STA. = 56+88.93  
 $\Delta = 8^\circ 24' 53''$  (LT)  
 $D = 1^\circ 00' 44''$   
 $R = 5,660.83'$   
 $T = 416.43'$   
 $L = 831.36'$   
 $E = 15.30'$   
 $e = 1.7\%$   
 $T.R. = 36.86'$   
 $S.E. RUN = 41.77'$   
 $P.C. STA. = 52+72.50$   
 $P.T. STA. = 61+03.86$

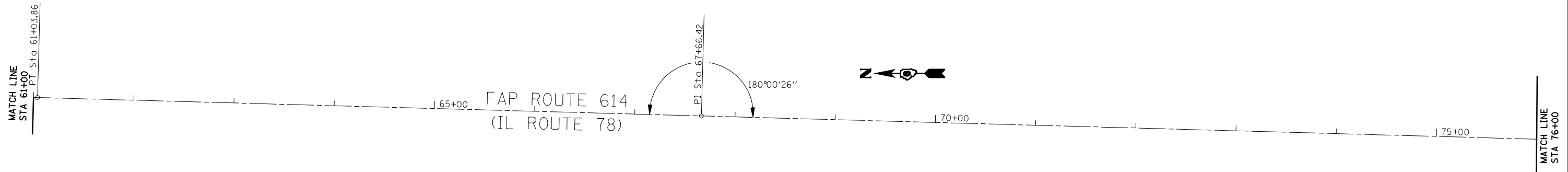

FILE NAME = c:\pwwork\pwwid\LAUGHLINRL\dms26347\alignm.dgn	USER NAME = laughlinr1	DESIGNED -	REVISED -	<b>STATE OF ILLINOIS DEPARTMENT OF TRANSPORTATION</b>	<b>ALIGNMENT</b>			F.A.P. RTE.	SECTION	COUNTY	TOTAL SHEETS	SHEET NO.
	PLOT SCALE = 100.0000' / IN.	CHECKED -	REVISED -					614	(141,143)RS-5	MASON	40	21
PLOT DATE = Feb-06-2009 02:36:46PM	DATE -	REVISED -	REVISED -		SCALE: 1" = 50'			SHEET NO. OF SHEETS STA. TO STA.		FED. ROAD DIST. NO. ILLINOIS FED. AID PROJECT		
								CONTRACT NO. 72835				