

Benchmark: JJ20 - Found Chiseled "□" on S.E. Wingwall of S.N. 009-2002.
 Station 217+67.0, 21.7' Rt., El. 570.33
 Existing Structure: S.N. 009-2002 built in 1955 as a Double Barrel 8'-8" x 8'-4"
 R.C. Box Culvert with a Culvert Length of ±66'-4". Traffic
 to be maintained utilizing stage construction. No Salvage.

INDEX OF SHEETS

- 1 - GENERAL PLAN & ELEVATION
- 2 - NOTES & BILL OF MATERIAL
- 3 - STAGING DETAILS
- 4-6 - CULVERT DETAILS
- 7 - BAR SPLICER ASSEMBLY DETAILS
- 8 - TEMPORARY CONCRETE BARRIER DETAILS
- 9-11 - BORINGS

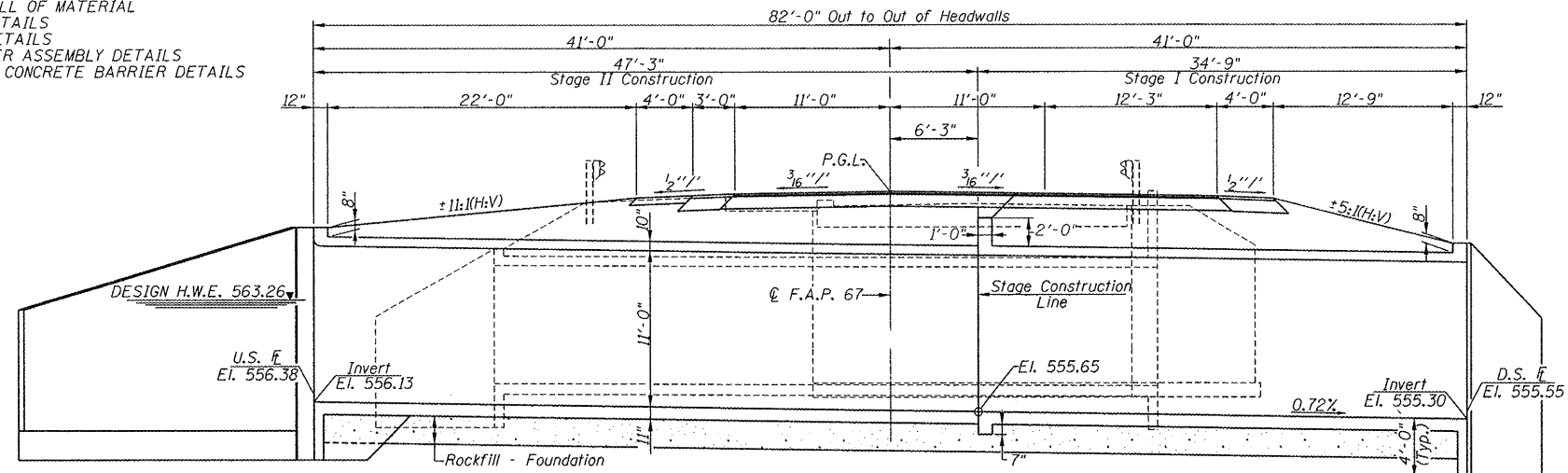

LONGITUDINAL SECTION
 (All Dimensions are at Rt. L's to C.Rdwy.)

STA. 217+27.64
 BUILT 20 BY
 STATE OF ILLINOIS
 F.A.P. RTE. 67 SECTION (6X-1)B-2
 LOADING HS 20-44
 STR. NO. 009-2507

NAME PLATE
 (Standard 515001)

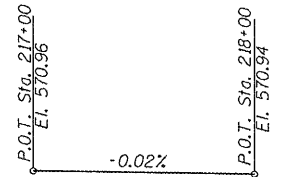

PROFILE GRADE
 (Along C.Rdwy.)

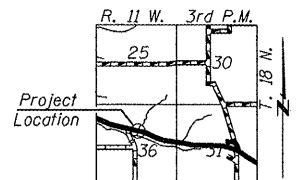

LOCATION SKETCH

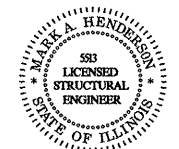

Mark A. Henderson 2/4/09
 Expiration Date: 11/30/2010

APPROVED
 For Structural Adequacy Only

Ralph E. Anderson (ms)
 Engineer of Bridges & Structures

GENERAL PLAN
 IL. ROUTE 125 OVER
 TRIBUTARY TO LOST CREEK
 F.A.P. ROUTE 67 - SECTION (6X-1)B-2
 CASS COUNTY
 STA. 217+67.54
 S.N. 009-2507

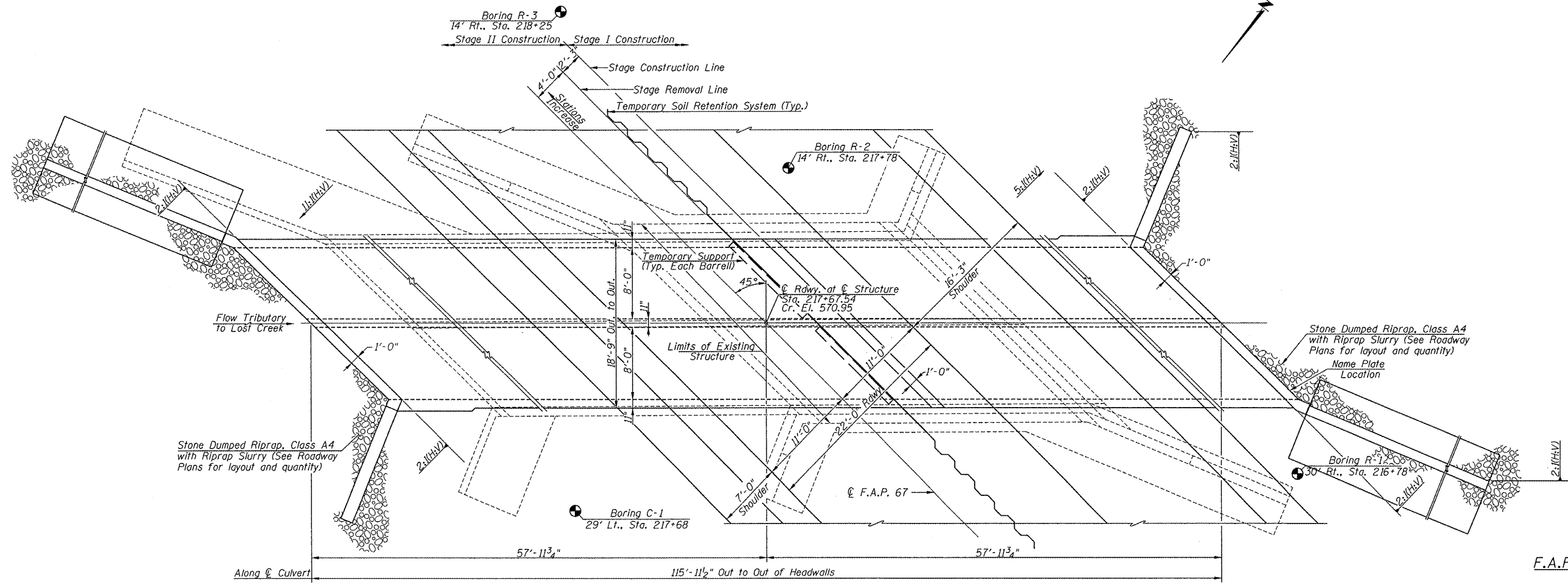

PLAN



Allen Henderson & Associates, Inc.
 Civil and Structural Engineers Springfield, IL
 62703 Phone: (217)544-8033 IL Design Firm
 No. 184-001907

SHEET NO. 1
 OF 11 SHEETS

F.A.P. RTE.	SECTION	COUNTY	TOTAL SHEETS	SHEET NO.
67	(6X-1)B-2	CASS	71	44
CONTRACT NO. 72875				
FED. ROAD DIST. NO. - ILLINOIS FED. AID PROJECT				