

150 140 130 120 110 100 90 80 70 60 50 40 30 20 10 0 10 20 30 40 50 60 70 80 90 100 110 120 130 140 150

BEGIN SHOULDER TAPER - STA. 143+38 LT. & RT.

ST II C - 6
F - 12
EL. 540.78
ST I C - 2
F - 4

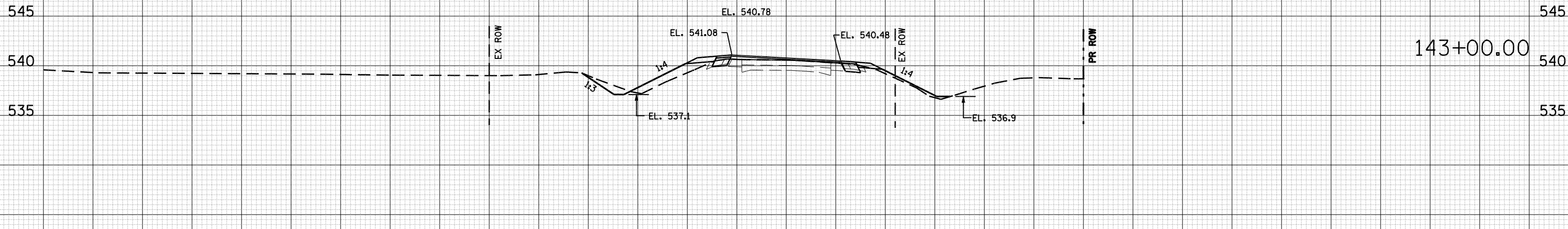

BEGIN SUPERELEVATION TRANSITION - STA. 142+03

ST II C - 6
F - 14
EL. 540.44
ST I C - 9
F - 0
V.D. REM. WIDTH = 11'

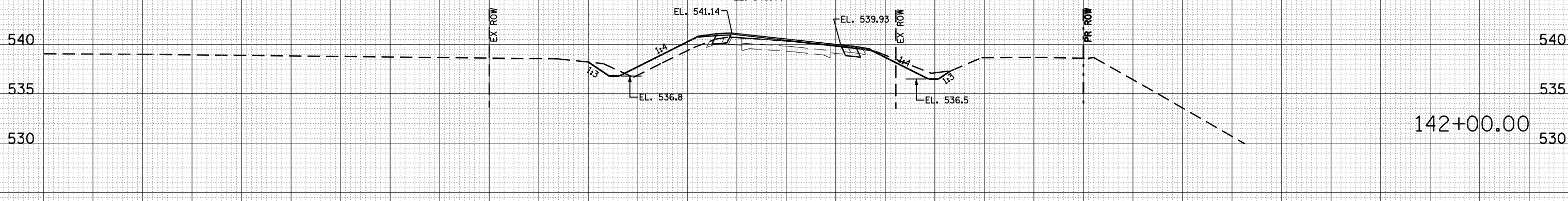

ST II C - 5
F - 4
EL. 539.64
ST I C - 2
F - 0
V.D. REM. WIDTH = 10'

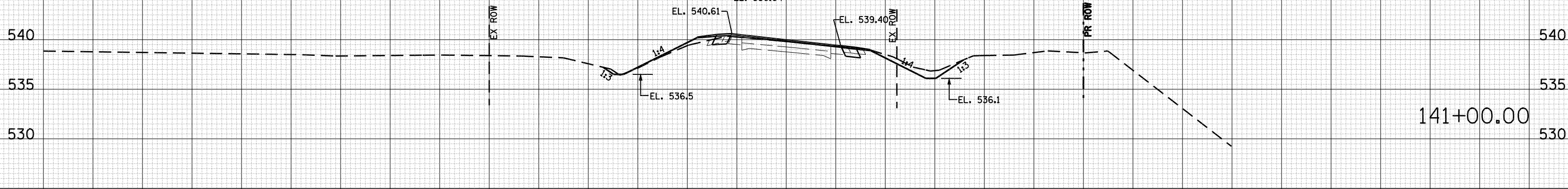

150 140 130 120 110 100 90 80 70 60 50 40 30 20 10 0 10 20 30 40 50 60 70 80 90 100 110 120 130 140 150

DATE	
BY	
SURVEYED	
PLOTTED	
TEMPLATE	
AREAS	
CHECKED	
FINAL SURVEY	
NOTE BOOK	
NO.	

DATE	
BY	
SURVEYED	
PLOTTED	
TEMPLATE	
AREAS	
CHECKED	
ORIGINAL SURVEY	
NOTE BOOK	
NO.	

FILE NAME = D672875-sht-xssht2.dgn

USER NAME =
DESIGNED - RKA
DRAWN - RKA
CHECKED - CPK
DATE - 3/25/08
PLOT SCALE =
PLOT DATE = Jan-30-2009 09:41:44AM

REVISED -
REVISED -
REVISED -
REVISED -



Allen Henderson & Associates, Inc.
Civil and Structural Engineers Springfield, IL.
62708 Phone: (217)544-8033 IL Design Firm
No. 184-001907

CROSS SECTIONS
STA. 136 + 64.40 /S.N. 009-2506
SCALE: VARIES SHEET NO. 63 OF 71 SHEETS STA. TO STA.

F.A.P. RTE.	SECTION	COUNTY	TOTAL SHEETS	SHEET NO.
67	(6X-1)B-2	CASS	71	63
CONTRACT NO. 72875				
FED. ROAD DIST. NO. ILLINOIS FED. AID PROJECT				