

**LEGEND**

- ① THERMOPLASTIC PAVEMENT MARKING - LINE 5"
- ② THERMOPLASTIC PAVEMENT MARKING - LINE 8"
- ③ THERMOPLASTIC PAVEMENT MARKING - LINE 12"
- ④ PREFORMED PLASTIC PAVEMENT MARKING, TYPE B- LINE 5"
- ⑤ PREFORMED PLASTIC PAVEMENT MARKING, TYPE B- LINE 6"
- ⑥ PREFORMED PLASTIC PAVEMENT MARKING, TYPE B - LINE 24"
- ⑦ PREFORMED PLASTIC PAVEMENT MARKING, TYPE B - LETTERS & SYMBOLS  
SEE DETAIL A ON SHEET 13

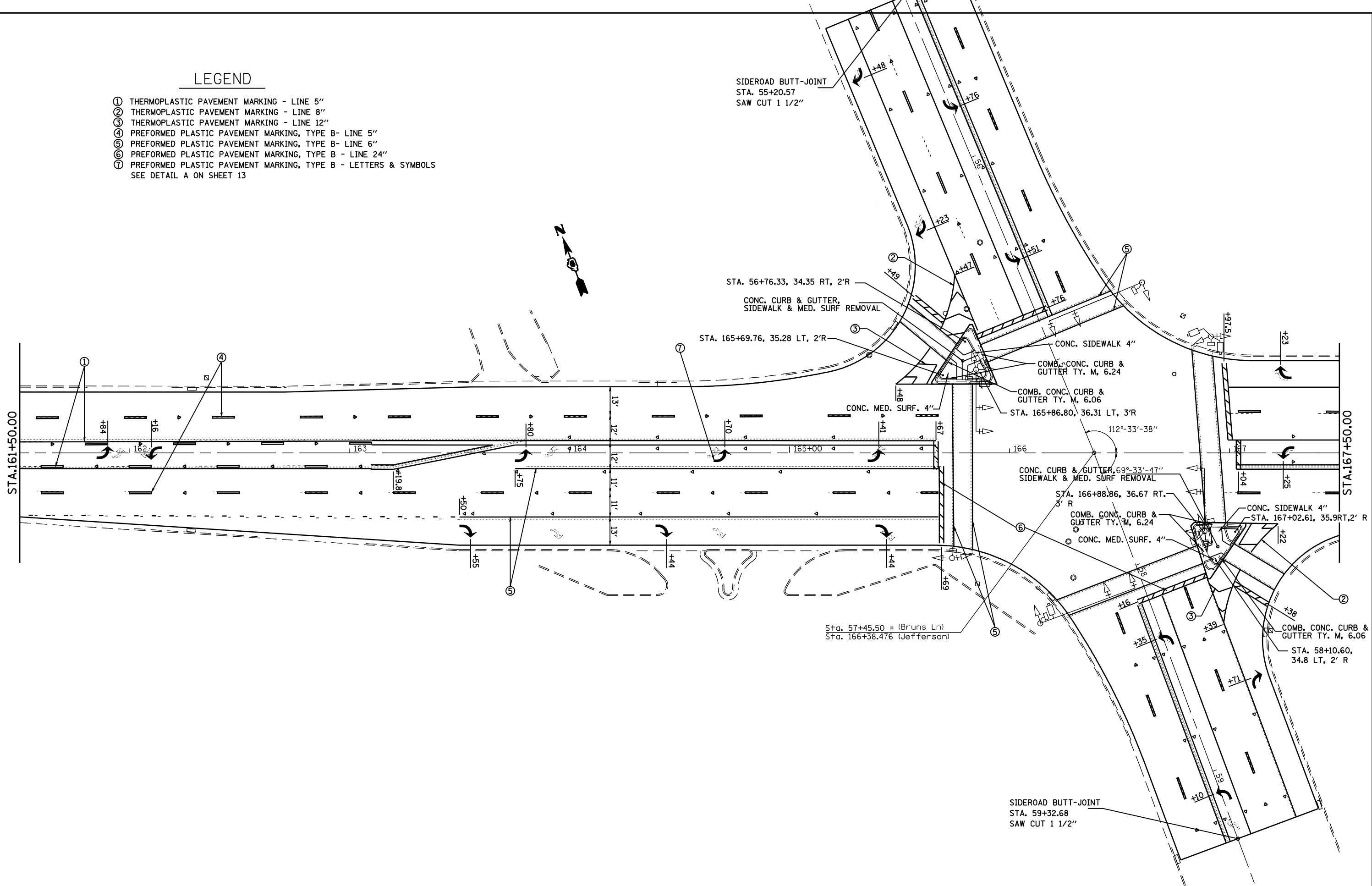

FILE NAME =	USER NAME = laughlinr1	DESIGNED -	REVISED -
S:\CADD\72C40 (D9601709)\D672C40\CADD\	CAD\sheeta\D672C40-sht-plan.dgn	DRAWN -	REVISED -
	PLOT SCALE = 40.0000 ' / IN.	CHECKED -	REVISED -
	PLOT DATE = Jan-15-2009 05:37:03PM	DATE -	REVISED -

**STATE OF ILLINOIS  
DEPARTMENT OF TRANSPORTATION**

<b>PLAN</b>	
SCALE:	SHEET NO. OF SHEETS STA. TO STA.

F.A.P. RTE.	SECTION	COUNTY	TOTAL SHEETS	SHEET NO.
67	(SIRS-5)(107Z)RS-8	Sangamon	41	15
CONTRACT NO. 72C40			ILLINOIS FED. AID PROJECT	