

F.A.P. RTE.	SECTION	COUNTY	TOTAL SHEETS	SHEET NO.
781	2ZRS-1	CRAWFORD	191	46
STA. 3+150		TO STA. 3+325		
FED. ROAD DIST. NO.		ILLINOIS	FED. AID PROJECT	

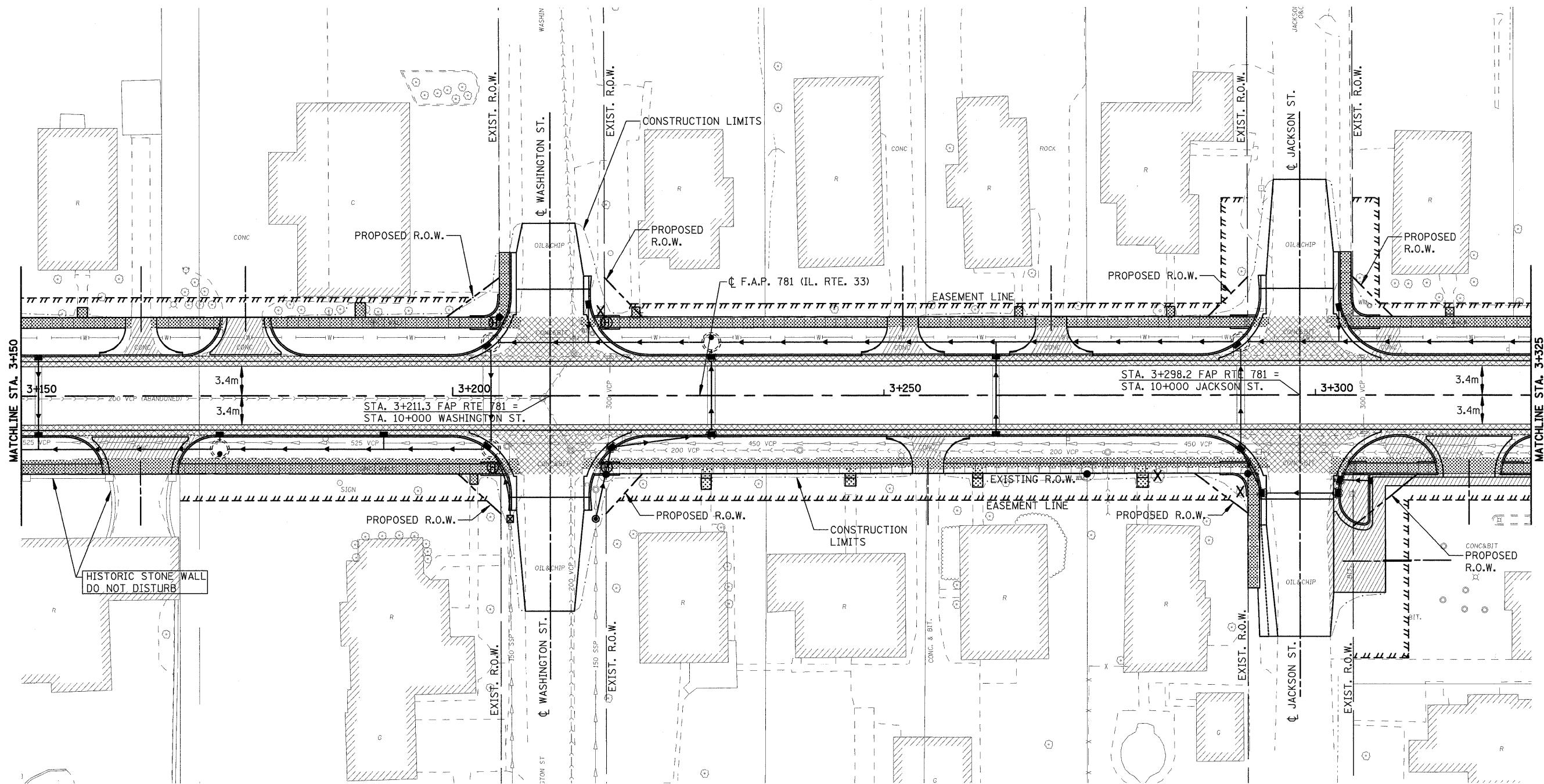

MATCHLINE STA. 3+150

MATCHLINE STA. 3+325

LEGEND

- DRIVEWAY PAVEMENT REMOVAL (INCLUDES ALL MATERIAL ENCOUNTERED)
- PAVEMENT REMOVAL (INCLUDES ALL MATERIAL ENCOUNTERED)
- SIDEWALK REMOVAL (INCLUDES STEPS)

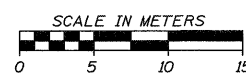

REVISIONS	
NAME	DATE

ILLINOIS DEPARTMENT OF TRANSPORTATION

REMOVAL ITEMS

SCALE _____ DRAWN BY EDW
 DATE FEBRUARY 6, 2009 CHECKED BY LWJ

PLOT DATE = 2/5/2009
 FILE NAME = H:\1428\Contract 74349\SH1_046.REN250_04.dgn

H. M. & G. NO. 4420