

| F.A.P. RTE. | SECTION | COUNTY | TOTAL SHEETS | SHEET NO. |
|---------------------|-----------------|--------------------|--------------|-----------|
| 885 | D9 SMART FY10-1 | JACKSON | 18 | 1 |
| FED. ROAD DIST. NO. | ILLINOIS | CONTRACT NO. 98825 | | |

STATE OF ILLINOIS
DEPARTMENT OF TRANSPORTATION
DIVISION OF HIGHWAYS

**PROPOSED
HIGHWAY PLANS**

FAP 885 (IL 146)
SECTION D9 SMART FY10-1
PROJECT: *ESP-0885(040)*
JOHNSON COUNTY
MILLING AND RESURFACING

C-99-076-03

FOR INDEX OF SHEETS, SEE SHEET NO. 3

ADT: (2007) 2150
MU = 40; SU = 125

D-99-042-03

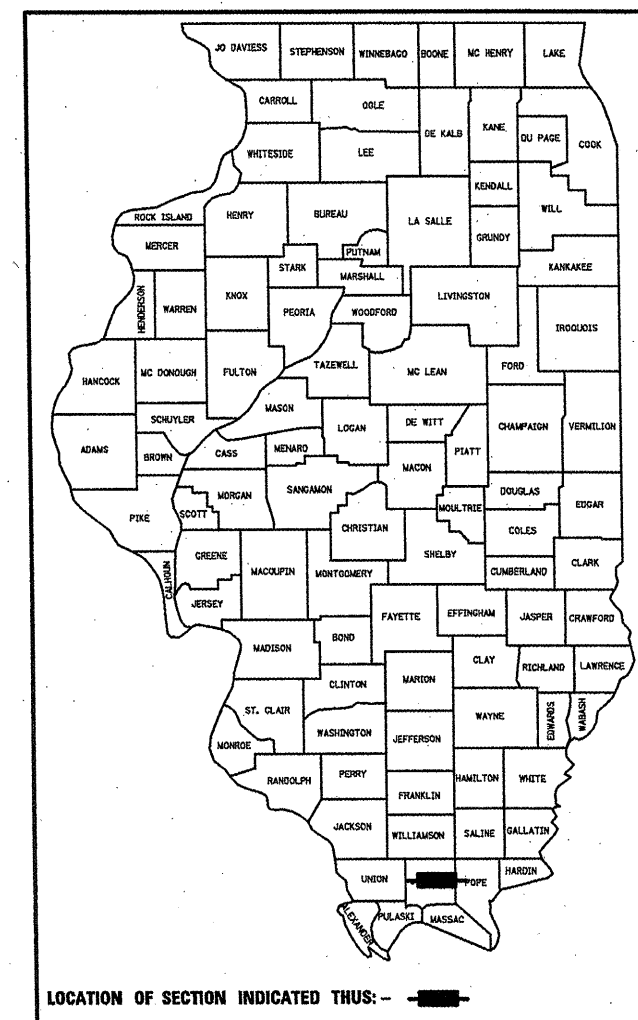

STRUCTURES TO BE OMITTED:
S.N. 044-0020 STA. 488+54 TO STA. 490+35
S.N. 044-0022 STA. 510+00 TO STA. 515+00
S.N. 044-0056 STA. 573+94 TO STA. 584+00

PROP. PROJECT BEGINS ON FAP 885 (IL. 146)
STA. 129+37 (EX. BUTT JT.)

TOWNSHIPS: VIENNA & GRANTSBURG

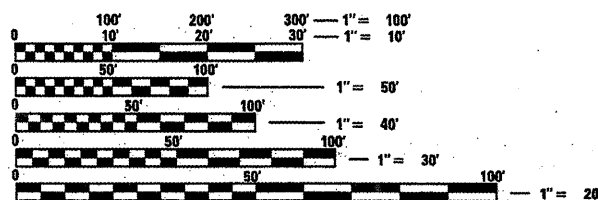

FULL SIZE PLANS HAVE BEEN PREPARED USING STANDARD ENGINEERING SCALES. REDUCED SIZED PLANS WILL NOT CONFORM TO STANDARD SCALES. IN MAKING MEASUREMENTS ON REDUCED PLANS, THE ABOVE SCALES MAY BE USED.

J.U.L.I.E.
JOINT UTILITY LOCATION INFORMATION FOR EXCAVATION
1-800-892-0123
OR 811

PROJECT ENGINEER - CHARLES STEIN (618) 351-5210
PROJECT DESIGNER - KATHI MCCORD (618) 351-5126

CONTRACT NO. 98825

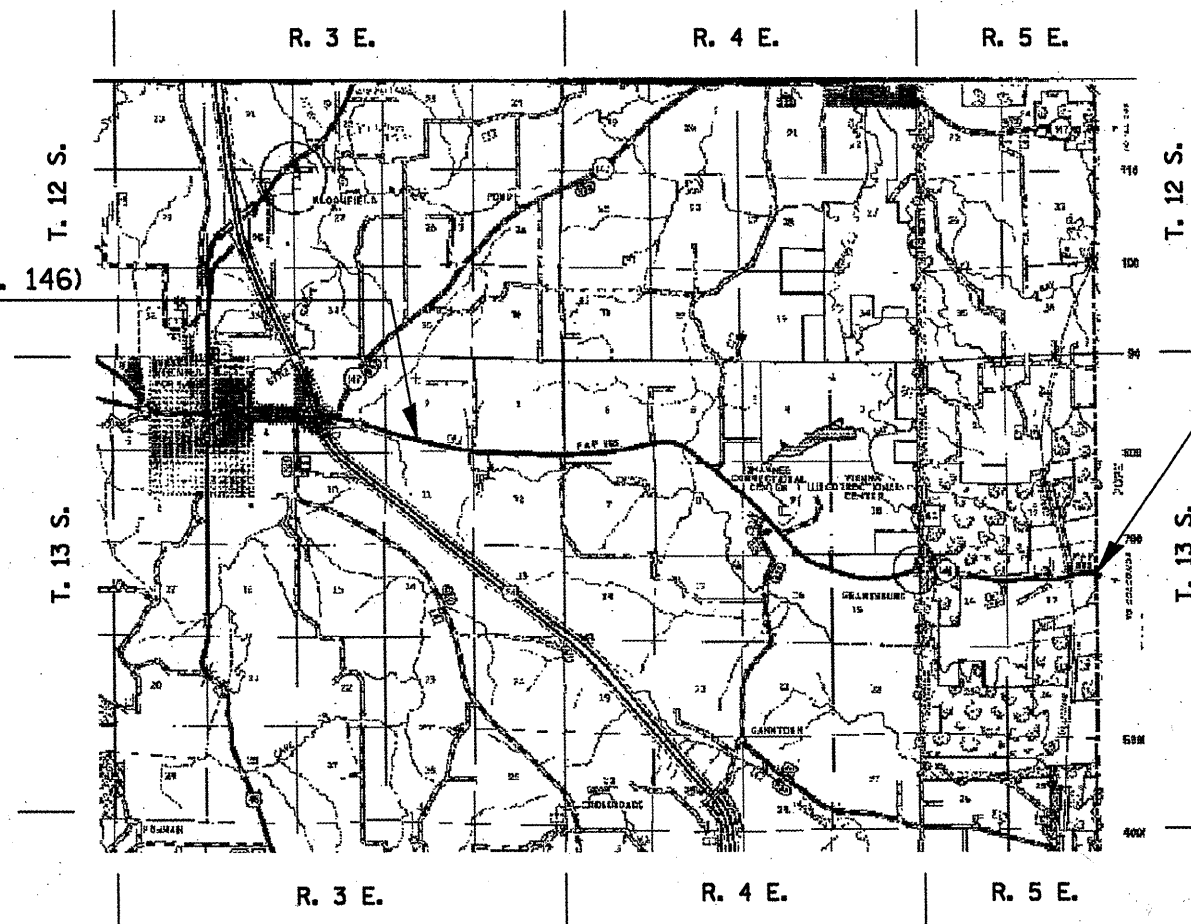

GROSS LENGTH = 46,363 FT. = 8.78 MILE
NET LENGTH = 44,676 FT. = 8.46 MILE



PROP. PROJECT ENDS OF FAP 885 (IL. 146)
STA. 593+00 AT THE JOHNSON/POPE CO. LINE

STATE OF ILLINOIS
DEPARTMENT OF TRANSPORTATION
DIVISION OF HIGHWAYS

SUBMITTED *Jan 14, 2009*
Meg Adams
DEPUTY DIRECTOR OF HIGHWAYS, REGION ENGINEER

March 13, 2009
Charles J. Jernovall
ENGINEER OF DESIGN AND ENVIRONMENT

March 13, 2009
Christine M. Reed
DIRECTOR OF HIGHWAYS, CHIEF ENGINEER

**PRINTED BY THE AUTHORITY
OF THE STATE OF ILLINOIS**

PROJECT ENGINEER: CHARLES STEIN - (618) 351-5210
DESIGNER: KATHI MCCORD - (618) 351-5126

Prepared By: Joe Bolandewicz
DISTRICT STUDIES & PLANS ENGINEER

Examined By: James Travis Emery
DISTRICT LAND ACQUISITION ENGINEER

Examined By: Carrie Nelson
DISTRICT PROGRAM DEVELOPMENT ENGINEER

Examined By: Scott Hiley
DISTRICT OPERATIONS ENGINEER

Examined By: Jim Smother
DISTRICT CONSTRUCTION ENGINEER

Examined By: Bruce Seabler
DISTRICT MATERIALS ENGINEER

Examined By: Jim Smother
DISTRICT PROJECT IMPLEMENTATION ENGINEER

Examined By: Danny L. Danton
ASSISTANT REGIONAL ENGINEER

Approved By: My C. Kami
DEPUTY DIRECTOR OF HIGHWAYS, REGION ENGINEER

DATE Jan 14 2009

| | | | |
|--|------------------------------|------------|-----------|
| FILE NAME = | USER NAME = maaordkr | DESIGNED - | REVISED - |
| c:\pwwork\pwwork\DOT\MCCORDKR\d0105162\d93925-shf-misc.dgn | | DRAWN - | REVISED - |
| | PLOT SCALE = 100.0000' / IN. | CHECKED - | REVISED - |
| | PLOT DATE = 1/5/2009 | DATE - | REVISED - |

**STATE OF ILLINOIS
DEPARTMENT OF TRANSPORTATION**

SCALE: _____ SHEET NO. ___ OF ___ SHEETS STA. _____ TO STA. _____

| | | | | |
|--------------------|-----------------|---------|---|-----------|
| F.A.P. RTE. | SECTION | COUNTY | TOTAL SHEETS | SHEET NO. |
| 885 | 09 SMART FY10-1 | JOHNSON | 18 | 2 |
| CONTRACT NO. 98825 | | | FED. ROAD DIST. NO. ILLINOIS FED. AID PROJECT | |

INDEX OF SHEETS

| SHEET NO. | DESCRIPTION |
|-----------|---|
| 1 | COVER SHEET |
| 2 | SIGNATURE SHEET |
| 3 | INDEX OF SHEETS AND HIGHWAY STANDARDS, AND STRUCTURE RATINGS |
| 4 | GENERAL NOTES; MIXTURE REQUIREMENTS |
| 5 | SUMMARY OF QUANTITIES |
| 6 - 7 | TYPICAL SECTIONS |
| 8 | SCHEDULES FOR MAINLINE RESURFACING AND GUARDRAIL |
| 9 | SCHEDULE FOR PAVEMENT MARKING |
| 10 | LOCATION MAP FOR FAP 885 (IL 146) FROM STA. 129+37 (EAST OF IL 147) TO STA. 593+00 AT THE JOHNSON/POPE CO. LINE |
| 11 - 15 | PLAN LAYOUT SHEETS - FAP 331 (IL 13/WALNUT ST.) |
| 16 | DETAILS; BUTT JT AT BEGINNING AND END OF PROJECT AND AT STRUCTURES |
| 17 | STANDARD DETAILS - TEMP. HOT-MIX ASPHALT TRANSITIONS |
| 18 | STANDARD DETAILS - ROUGH GROOVED SURFACE SIGN; UNEVEN LANE SIGN |

HIGHWAY STANDARDS

| | |
|-----------|-----------|
| 442201-03 | 701311-03 |
| 635006-02 | 701336-05 |
| 635011-02 | 701901-01 |
| 701201-03 | 780001-02 |
| 701301-03 | 781001-03 |
| 701306-02 | |

STRUCTURE RATINGS

| STRUCTURE NO. | INV. RATING | OPER. RATING | SUFF. RATING |
|------------------|-------------|--------------|--------------|
| FAP 885 (IL 146) | | | |
| 044-0020 | 30.0 | 50.1 | 59.8 |
| 044-0022 | 18.6 | 29.7 | 65.0 |
| 044-0056 | 39.8 | 55.0 | 97.4 |

GENERAL NOTES

THE THICKNESS OF BITUMINOUS MIXTURE SHOWN ON THE PLANS IS THE NOMINAL THICKNESS. DEVIATIONS FROM THE NOMINAL THICKNESS WILL BE PERMITTED WHEN SUCH DEVIATIONS OCCUR DUE TO IRREGULARITIES IN THE EXISTING SURFACE OR BASE ON WHICH THE BITUMINOUS MIXTURE IS PLACED.

FACTORS USED FOR ESTIMATING PLAN QUANTITIES ARE AS FOLLOWS AND SHALL NOT BE USED FOR THE BASIS OF FINAL QUANTITIES EXCEPT FOR QC/QA OF BITUMINOUS MIXTURES:

ALL HOT-MIX ASPHALT.....2.016 TONS/CU.YD.
 ALL AGGREGATE.....2.05 TONS/CU.YD.
 BITUMINOUS MATERIALS (PRIME COAT)
 ON PAVEMENT.....0.09 GALS./SQ. YD.
 ON AGG. SURFACE.....0.32 GALS./SQ. YD.
 AGGREGATE (PRIME COAT).....0.0015 TONS/SQ. YD.

THE QUANTITY OF SHORT TERM PAVEMENT MARKING SHOWN IN THE PLANS WAS BASED ON ONE APPLICATION EACH FOR THE PRIME COAT AND SURFACE COURSE.

PRIOR TO PLACEMENT OF THE FINAL PAVEMENT MARKINGS, THE RESIDENT ENGINEER SHOULD CONTACT THE BUREAU OF OPERATIONS AND ARRANGE FOR INSPECTION AND APPROVAL OF THE PAVEMENT MARKING LAYOUT.

THE CONTRACTOR SHALL STAMP STATIONING IN THE PROPOSED BITUMINOUS MATS AT 300 FT. INTERVALS ON ALTERNATING SIDES OF THE PAVEMENT AND AS DIRECTED BY THE ENGINEER. THE STATION SYMBOL STAMPS USED SHALL BE FURNISHED BY THE CONTRACTOR. THEY SHALL BE 5/2" TALL OF A DESIGN APPROVED BY THE ENGINEER AND SHALL REMAIN THE PROPERTY OF THE CONTRACTOR.

UNLESS OTHERWISE DIRECTED BY THE ENGINEER, HOT-MIX ASPHALT RESURFACING SHALL BE PLACED IN A SEQUENCE THAT WILL MINIMIZE THE TIME THAT A LANE EDGE IS EXPOSED TO TRAFFIC.

QUANTITIES SHOWN IN THE PLANS FOR PATCHING ARE ESTIMATES. THE ACTUAL AMOUNT OF PATCHING REQUIRED SHALL BE DETERMINED BY THE ENGINEER IN THE FIELD.

THE CONTRACTOR SHALL COMPLETE ALL PATCHING PRIOR TO THE BITUMINOUS SURFACE REMOVAL.

THE SAWED JOINTS AT THE BEGINNING, END, AT AND STRUCTURE OMISSIONS SHALL BE INCLUDED IN THE COST OF THE HOT-MIX ASPHALT SURFACE COURSE.

A LOADED MTD WILL BE ALLOWED OVER STRUCTURES 044-0020 AND 044-0056 AND AN EMPTY MTD WILL BE ALLOWED OVER STRUCTURE 044-0022, BASED OF THE LOAD CARRYING CAPACITIES OF THE STRUCTURES AND AS APPROVED BY THE ENGINEER.

COMMITMENTS: NONE

MIXTURE REQUIREMENTS SHALL BE PREPARED AS DIRECTED BELOW:

FOR IL. 146 SURFACE COURSE:

| | |
|--|--|
| Mixture Use(s): | Hot-Mix Asphalt Surface Course, Mixture C, N90 |
| AC/PG: | PG64-22 |
| RAP % (Max.): | 10 |
| Design Air Voids: | 4.0%, 90 Gyration Design |
| Mixture Composition: (Gradation Mixture) | IL-9.5mm or IL-12.5 mm |
| Friction Aggregate: | C Surface |

FOR IL. 146 CLASS D PATCHING:

| | |
|--|---|
| Mixture Use(s): | Hot-Mix Asphalt Binder Course, N90, IL-19.0 |
| AC/PG: | PG64-22 |
| RAP % (Max.): | 10 |
| Design Air Voids: | 4.0%, 90 Gyration Design |
| Mixture Composition: (Gradation Mixture) | IL-19.0mm |
| Friction Aggregate: | None |

SUMMARY OF QUANTITIES

FAP 885 (IL 146)
100% FED.
JOHNSON COUNTY
CONSTRUCTION TYPE
CODE 1000

| CODE NUMBER | ITEM DESCRIPTION | UNIT | TOTAL QUANTITY |
|-------------|--|--------|----------------|
| X0322729 | MATERIAL TRANSFER DEVICE | TON | 10,820.0 |
| 40600100 | BITUMINOUS MATERIALS (PRIME COAT) | GALLON | 11,592.0 |
| 40600300 | AGGREGATE (PRIME COAT) | TON | 193.2 |
| 40600895 | CONSTRUCTING TEST STRIP | EACH | 1.0 |
| 40600990 | TEMPORARY RAMP | SQ YD | 115.2 |
| 40603320 | HOT-MIX ASPHALT SURFACE COURSE, MIX C, N90 | TON | 10,820.0 |
| 44000155 | HOT-MIX ASPHALT SURFACE REMOVAL, 1 1/2" | SQ YD | 128,810.0 |
| 44201798 | CLASS D PATCHES, TYPE I, 13 INCH | SQ YD | 8.1 |
| 44201803 | CLASS D PATCHES, TYPE II, 13 INCH | SQ YD | 862.3 |
| 44201807 | CLASS D PATCHES, TYPE III, 13 INCH | SQ YD | 23.3 |
| 44201809 | CLASS D PATCHES, TYPE IV, 13 INCH | SQ YD | 642.0 |
| 44300200 | STRIP REFLECTIVE CRACK CONTROL TREATMENT | FOOT | 89,352.0 |
| 48101200 | AGGREGATE SHOULDERS, TYPE B | TON | 1,099.0 |
| * 63100167 | TRAFFIC BARRIER TERMINAL, TYPE 1 (SPECIAL) TANGENT | EACH | 12.0 |
| 63200310 | GUARDRAIL REMOVAL | FOOT | 300.0 |
| 67000400 | ENGINEER'S FIELD OFFICE, TYPE A | CAL MO | 2.0 |
| 67100100 | MOBILIZATION | L SUM | 1.0 |
| 70100450 | TRAFFIC CONTROL AND PROTECTION, STANDARD 701201 | L SUM | 1.0 |
| 70100460 | TRAFFIC CONTROL AND PROTECTION, STANDARD 701306 | L SUM | 1.0 |
| 70100600 | TRAFFIC CONTROL AND PROTECTION, STANDARD 701336 | L SUM | 1.0 |
| 70300100 | SHORT- TERM PAVEMENT MARKING | FOOT | 5,361.0 |
| 70300220 | TEMPORARY PAVEMENT MARKING- LINE 4" | FOOT | 145,035.0 |
| 70301000 | WORK ZONE PAVEMENT MARKING REMOVAL | SQ FT | 49,631.0 |
| * 78001110 | PAINT PAVEMENT MARKING - LINE 4" | FOOT | 145,035.0 |
| * 78100100 | RAISED REFLECTIVE PAVEMENT MARKER | EACH | 563 |
| * 78200410 | GUARDRAIL MARKERS, TYPE A | EACH | 12 |
| * 78201000 | TERMINAL MARKER - DIRECT APPLIED | EACH | 12 |
| 78300200 | RAISED REFLECTIVE PAVEMENT MARKER REMOVAL | EACH | 563 |

**Specialty Items*

TYPICAL SECTION NO. 1

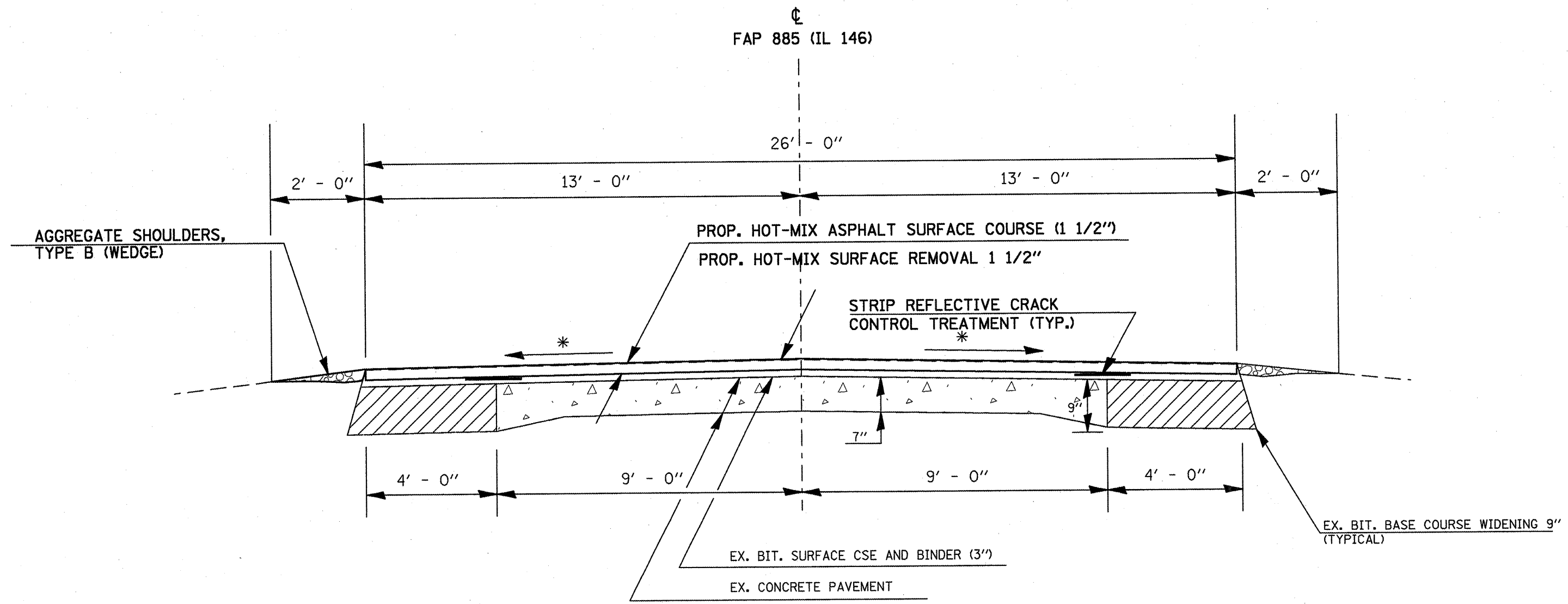

TO BE USED:
 WHERE GUTTER IS NOT ENCOUNTERED.
 STA. 129+37 TO STA. 473+11
 STA. 484+54 TO STA. 488+54
 STA. 490+35 TO STA. 510+00
 STA. 515+00 TO STA. 573+94
 STA. 584+00 TO STA. 593+00

LOCATIONS WHERE STRUCTURES
 ARE OMITTED:
 STA. 488+54 TO STA. 490+35
 STA. 510+00 TO STA. 515+00
 STA. 573+94 TO STA. 584+00

| | | | | | | | | | | | |
|--|----------------------------|------------|-----------|---|---|---------------------------|---------------------------|--------------------|-----------------|-------------|--|
| FILE NAME = | USER NAME = moorckr | DESIGNED - | REVISED - | STATE OF ILLINOIS DEPARTMENT OF TRANSPORTATION | SCALE: _____ SHEET NO. _____ OF 988 SHEETS STA. _____ TO STA. _____ | F.A.P. RTE. 885 | SECTION D9 SMART FY10-1 | COUNTY JOHNSON | TOTAL SHEETS 18 | SHEET NO. 6 | |
| ci\pwwork\pwwdot\mccordkr\d0105162\d99825-shr-misc.dgn | PLOT SCALE = 1/8" = 1' IN. | DRAWN - | REVISED - | | | FED. ROAD DIST. NO. _____ | ILLINOIS FED. AID PROJECT | CONTRACT NO. 98825 | | | |
| | PLOT DATE = 1/9/2009 | CHECKED - | REVISED - | | | | | | | | |
| | | DATE - | REVISED - | | | | | | | | |

TYPICAL SECTION NO. 2

☐
FAP 885 (IL 146)

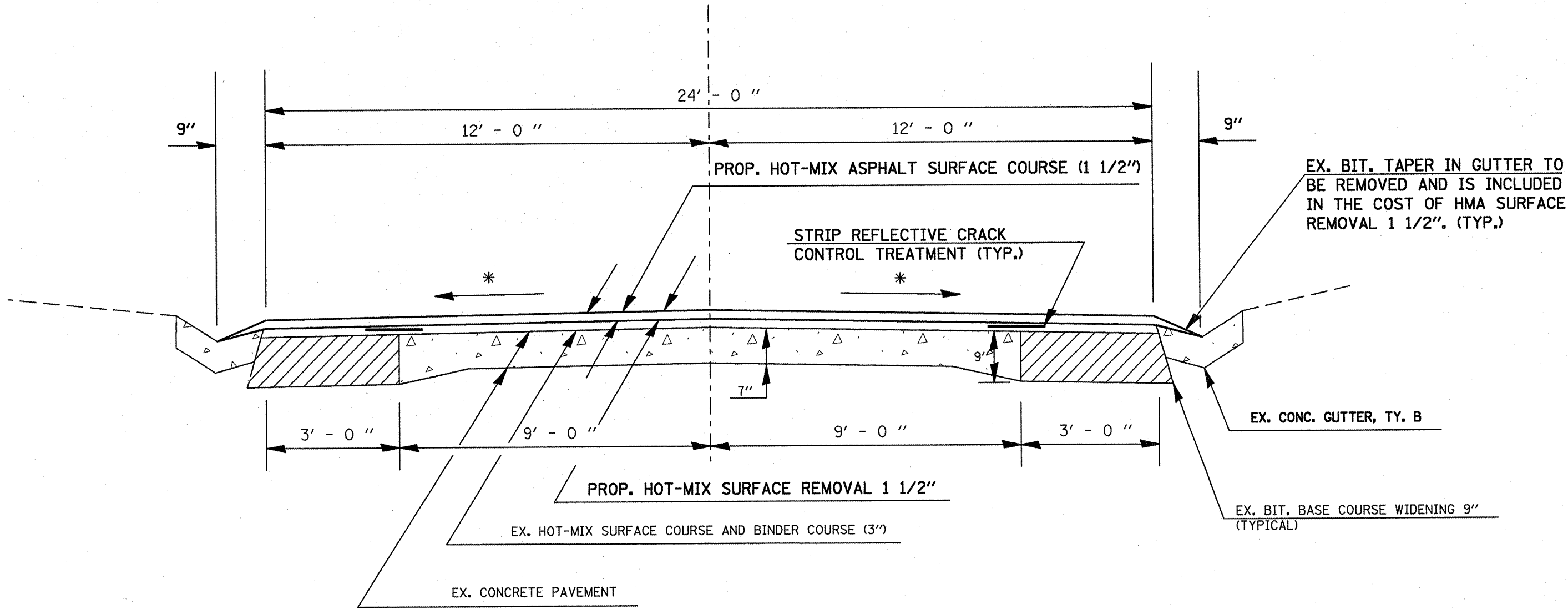

TO BE USED:
WHERE GUTTER IS ENCOUNTERED
IN GRANTSBURG
STA. 473+11 TO STA. 484+54.

| | | | | | | | | | | |
|---|----------------------|------------|-----------|---|--------------------|---------------------------------|--------------------------|---|-------------|--|
| FILE NAME = | USER NAME = mcoordkr | DESIGNED - | REVISED - | STATE OF ILLINOIS DEPARTMENT OF TRANSPORTATION | F.A.P. RTE. 885 | SECTION 09 SMART FY10-1 | COUNTY JOHNSON | TOTAL SHEETS 18 | SHEET NO. 7 | |
| c:\pwwork\pwwid\mccordkr\d0105162\d99825-ahh-miso.dgn | 825-ahh-miso.dgn | DRAWN - | REVISED - | | SCALE: _____ | SHEET NO. _____ OF _____ SHEETS | STA. _____ TO STA. _____ | FED. ROAD DIST. NO. 9 ILLINOIS FED. AID PROJECT | | |
| PLOT SCALE = 1/8" = 1' / IN. | | CHECKED - | REVISED - | | CONTRACT NO. 98825 | | | | | |
| PLOT DATE = 1/9/2009 | | DATE - | REVISED - | | | | | | | |

MAINLINE RESURFACING SCHEDULE

| LOCATION STATION TO STATION | | | LENGTH (FT) | ROADWAY WIDTH (FT) | ROADWAY AREA (SQ YD) | HMA SURF. REM. 1 1/2" (SQ YD) | TEMPORARY RAMP (SQ YD) | HMA SURF. CSE. MIX C. N90 (1 1/2") (TON) | BIT. MAT. (PRIME COAT) (GAL) | AGG. (PRIME COAT) (TON) | AGG. SHOULDER TYPE B (TON) | NOTES | |
|-----------------------------------|-----------|----|----------------|---|----------------------------|-------------------------------------|------------------------------|---|---------------------------------------|----------------------------------|-------------------------------------|-------------|--------------------------------|
| | | | | | | | | | | | | | FOR INFORMATIONAL PURPOSE ONLY |
| STA. 129+37 TO STA. 593+00 | | | | | | | | | | | | | |
| | 129+37.00 | TO | 473+11.00 | 34,374.0 | 26.0 | 99,303 | 99,303 | 14.4 | 8,341 | 8,937 | 149.0 | 867 | |
| Thru Grantsburg Limit | 473+11.00 | TO | 484+54.00 | 1,143.0 | 24.0 | 3,048 | 3,048 | | 256 | 274 | 4.6 | | Ex. Gutter Location |
| | 484+54.00 | TO | 488+54.00 | 400.0 | 26.0 | 1,156 | 1,156 | 14.4 | 97 | 104 | 1.7 | 10 | |
| | 488+54.00 | TO | 490+35.00 | OMIT S. N. 044-0020 OVER BAY CREEK | | | | | | | | | |
| | 490+35.00 | TO | 510+00.00 | 1,965.0 | 26.0 | 5,677 | 5,677 | 28.8 | 477 | 511 | 8.5 | 50 | |
| | 510+00.00 | TO | 515+00.00 | OMIT S. N. 044-0022 OVER BELL POND CREEK | | | | | | | | | |
| | 515+00.00 | TO | 573+94.00 | 5,894.0 | 26.0 | 17,027 | 17,027 | 28.8 | 1,430 | 1,532 | 25.5 | 149 | |
| | 573+94.00 | TO | 584+00.00 | OMIT S. N. 044-0056 OVER C. N. / I. C. RAILROAD | | | | | | | | | |
| | 584+00.00 | TO | 593+00.00 | 900.0 | 26.0 | 2,600 | 2,600 | 28.8 | 218 | 234 | 3.9 | 23 | |
| | | | | | | | 0 | | 0 | 0.0 | 0.0 | 0.0 | |
| | | | | | | | 0 | | 0 | 0.0 | 0.0 | 0.0 | |
| | | | | | | | 0.0 | | 0.0 | 0.0 | 0.0 | 0.0 | |
| TOTALS | | | | 44676.0 | | 128,810 | 128,810 | 115.2 | 10,820 | 11,592 | 193.5 | 1099 | |

GUARDRAIL SCHEDULE

| LOCATION | GUARDRAIL REMOVAL FOOT | TRAFFIC BARRIER TERMINAL | TERMINAL MARKERS - DA | GUARDRAIL MARKERS | REMARKS |
|--|------------------------------|--------------------------------|--------------------------|----------------------|----------------------------------|
| | | TY 1 SPL (TAN) EACH | EACH | EACH | |
| JACKSON COUNTY | | | | | |
| Lt & Rt Sta. 140+00 | | | | | |
| NW QUADRANT | 25 | 1 | 1 | 1 | NEW TERMINAL AND TERMINAL MARKER |
| NE QUADRANT | 25 | 1 | 1 | 1 | NEW TERMINAL AND TERMINAL MARKER |
| SW QUADRANT | 25 | 1 | 1 | 1 | NEW TERMINAL AND TERMINAL MARKER |
| SE QUADRANT | 25 | 1 | 1 | 1 | NEW TERMINAL AND TERMINAL MARKER |
| Lt & Rt Sta. 185+00 | | | | | |
| NW QUADRANT | 25 | 1 | 1 | 1 | NEW TERMINAL AND TERMINAL MARKER |
| NE QUADRANT | 25 | 1 | 1 | 1 | NEW TERMINAL AND TERMINAL MARKER |
| SW QUADRANT | 25 | 1 | 1 | 1 | NEW TERMINAL AND TERMINAL MARKER |
| SE QUADRANT | 25 | 1 | 1 | 1 | NEW TERMINAL AND TERMINAL MARKER |
| SN 044-0020 Lt & Rt Sta. 490+00 | | | | | |
| NE QUADRANT | 25 | 1 | 1 | 1 | NEW TERMINAL AND TERMINAL MARKER |
| SE QUADRANT | 25 | 1 | 1 | 1 | NEW TERMINAL AND TERMINAL MARKER |
| Rt Sta. 570+00 | | | | | |
| SW QUADRANT | 25 | 1 | 1 | 1 | NEW TERMINAL AND TERMINAL MARKER |
| SE QUADRANT | 25 | 1 | 1 | 1 | NEW TERMINAL AND TERMINAL MARKER |
| TOTALS | | 300 | 12 | 12 | 12 |

PAVEMENT MARKING SCHEDULE

| STATION TO STATION | | | | PAINT PAVEMENT MARKING | | | TEMPORARY | NOTES |
|---|----------|----|----------|-------------------------|---------------------|--------------------------|---------------|-------------------|
| | | | | 4 INCH YELLOW SKIP-DASH | 4 INCH YELLOW (NPZ) | 4 INCH WHITE (EDGE LINE) | 4 INCH | |
| | | | | FOOT | FOOT | FOOT | FOOT | |
| Station 129+37 To Station 593+48 | | | | | | | | |
| | 129+37.0 | TO | 136+14.0 | 169 | | | 169 | |
| | 170+51.0 | TO | 195+73.0 | 631 | | | 631 | |
| | 198+89.0 | TO | 270+32.0 | 1786 | | | 1786 | |
| | 283+75.0 | TO | 302+99.0 | 481 | | | 481 | |
| | 323+50.0 | TO | 413+46.0 | 2249 | | | 2249 | |
| | 424+46.0 | TO | 455+26.0 | 770 | | | 770 | |
| | 460+00.0 | TO | 466+05.0 | 151 | | | 151 | |
| | 496+96.0 | TO | 511+66.0 | 368 | | | 368 | |
| | 514+28.0 | TO | 531+44.0 | 429 | | | 429 | |
| | 532+49.0 | TO | 551+71.0 | 481 | | | 481 | |
| RT | 129+37.0 | TO | 170+51.0 | | 4114 | | 4114 | NPZ RIGHT |
| RT | 185+99.0 | TO | 198+89.0 | | 1290 | | 1290 | NPZ RIGHT |
| RT | 211+78.0 | TO | 219+68.0 | | 790 | | 790 | NPZ RIGHT |
| RT | 261+11.0 | TO | 283+75.0 | | 2264 | | 2264 | NPZ RIGHT |
| RT | 292+96.0 | TO | 323+50.0 | | 3054 | | 3054 | NPZ RIGHT |
| RT | 345+61.0 | TO | 352+19.0 | | 658 | | 658 | NPZ RIGHT |
| RT | 402+46.0 | TO | 424+46.0 | | 2200 | | 2200 | NPZ RIGHT |
| RT | 440+52.0 | TO | 448+42.0 | | 790 | | 790 | NPZ RIGHT |
| RT | 455+26.0 | TO | 487+84.0 | | 3258 | | 3258 | NPZ RIGHT |
| RT | 491+07.0 | TO | 496+96.0 | | 589 | | 589 | NPZ RIGHT |
| RT | 520+38.0 | TO | 532+49.0 | | 1211 | | 1211 | NPZ RIGHT |
| RT | 540+65.0 | TO | 570+92.0 | | 3027 | | 3027 | NPZ RIGHT |
| RT | 583+29.0 | TO | 593+00.0 | | 971 | | 971 | NPZ RIGHT |
| LT | 136+14.0 | TO | 182+04.0 | | 4590 | | 4590 | NPZ LEFT |
| LT | 195+73.0 | TO | 209+42.0 | | 1369 | | 1369 | NPZ LEFT |
| LT | 222+58.0 | TO | 231+00.0 | | 842 | | 842 | NPZ LEFT |
| LT | 270+32.0 | TO | 292+96.0 | | 2264 | | 2264 | NPZ LEFT |
| LT | 302+99.0 | TO | 335+07.0 | | 3208 | | 3208 | NPZ LEFT |
| LT | 355+87.0 | TO | 361+92.0 | | 605 | | 605 | NPZ LEFT |
| LT | 413+46.0 | TO | 434+99.0 | | 2153 | | 2153 | NPZ LEFT |
| LT | 449+73.0 | TO | 460+00.0 | | 1027 | | 1027 | NPZ LEFT |
| LT | 466+05.0 | TO | 487+84.0 | | 2179 | | 2179 | NPZ LEFT |
| LT | 491+07.0 | TO | 508+01.0 | | 1694 | | 1694 | NPZ LEFT |
| LT | 531+44.0 | TO | 543+81.0 | | 1237 | | 1237 | NPZ LEFT |
| LT | 551+71.0 | TO | 570+92.0 | | 1921 | | 1921 | NPZ LEFT |
| LT | 583+29.0 | TO | 593+00.0 | | 971 | | 971 | NPZ LEFT |
| LT | 129+37.0 | TO | 380+50.0 | | | 25113 | 25113 | Correctional Ent. |
| LT | 380+86.0 | TO | 394+76.0 | | 1390 | | 1390 | Correctional Ent. |
| LT | 395+12.0 | TO | 488+54.0 | | 9342 | | 9342 | |
| LT | 490+35.0 | TO | 510+00.0 | | 1965 | | 1965 | |
| LT | 515+00.0 | TO | 573+94.0 | | 5894 | | 5894 | |
| LT | 584+00.0 | TO | 593+00.0 | | 900 | | 900 | |
| RT | 129+37.0 | TO | 380+50.0 | | 25113 | | 25113 | Reevesville Rd. |
| RT | 380+86.0 | TO | 488+54.0 | | 10768 | | 10768 | |
| RT | 490+35.0 | TO | 510+00.0 | | 1965 | | 1965 | |
| RT | 515+00.0 | TO | 573+94.0 | | 5894 | | 5894 | |
| RT | 584+00.0 | TO | 593+00.0 | | 900 | | 900 | |
| SUB-TOTALS | | | | 7515 | 48276 | 89244 | 145035 | |
| TOTALS | | | | | 145035 | | 145035 | |

| | | | | | | | | | | |
|---|----------------------|------------|-----------|---|---|---------------|---------------------------------|--------------------|--------------------------|-------|
| FILE NAME = | USER NAME = mcoorder | DESIGNED - | REVISED - | STATE OF ILLINOIS DEPARTMENT OF TRANSPORTATION | F.A.P. RTE. _____ | SECTION _____ | COUNTY _____ | TOTAL SHEETS _____ | SHEET NO. _____ | |
| al\pwork\PIWIDOT\MCCORDKR\d0105162\d99825-shr-mso.dgn | | DRAWN - | REVISED - | | _____ | _____ | _____ | _____ | _____ | _____ |
| PLOT SCALE = 1/8" = 100.0000' / IN. | | CHECKED - | REVISED - | | _____ | _____ | _____ | _____ | _____ | _____ |
| PLOT DATE = 1/6/2009 | | DATE - | REVISED - | | _____ | _____ | _____ | _____ | _____ | _____ |
| | | | | | SCALE: _____ | | SHEET NO. _____ OF _____ SHEETS | | STA. _____ TO STA. _____ | |
| | | | | | FED. ROAD DIST. NO. _____ (ILLINOIS) FED. AID PROJECT | | | | | |

LOCATION MAP
 FAP 885 (IL 146)
 JOHNSON COUNTY

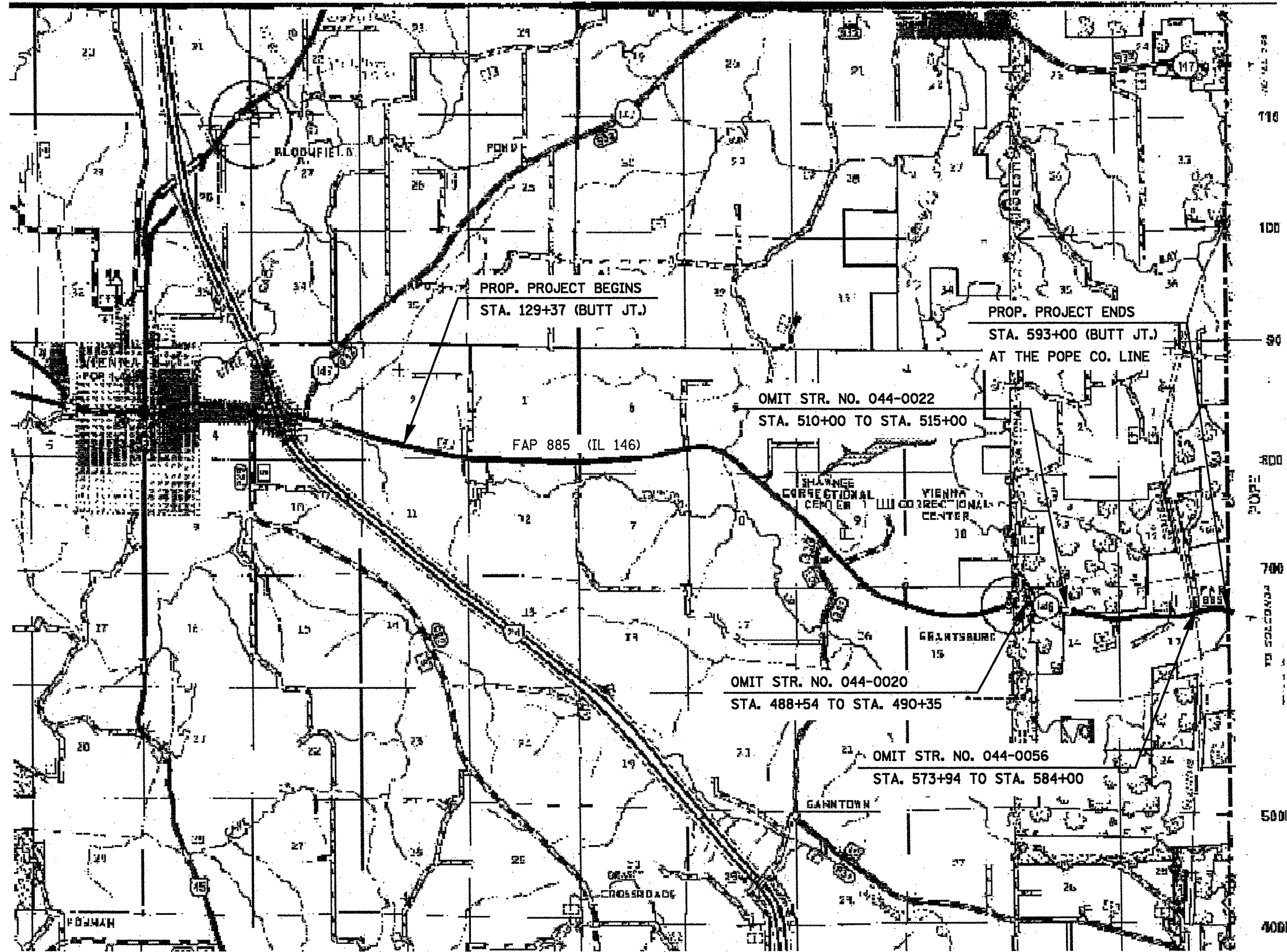

| | | | |
|------------------------------|---------------------|------------|-----------|
| FILE NAME = | USER NAME = moardkr | DESIGNED - | REVISED - |
| 9825-ah-tr-mso.dgn | | DRAWN - | REVISED - |
| PLOT SCALE = 100,0000 // IN. | | CHECKED - | REVISED - |
| PLOT DATE = 1/7/2009 | | DATE - | REVISED - |

STATE OF ILLINOIS
 DEPARTMENT OF TRANSPORTATION

SCALE: _____ SHEET NO. _____ OF _____ SHEETS STA. _____ TO STA. _____

| F.A.P. RTE. | SECTION | COUNTY | TOTAL SHEETS | SHEET NO. |
|---|-----------------|---------|--------------------|-----------|
| 885 | 09 SMART FY10-1 | JOHNSON | 18 | 10 |
| FED. ROAD DIST. NO. ILLINOIS FED. AID PROJECT | | | CONTRACT NO. 98825 | |

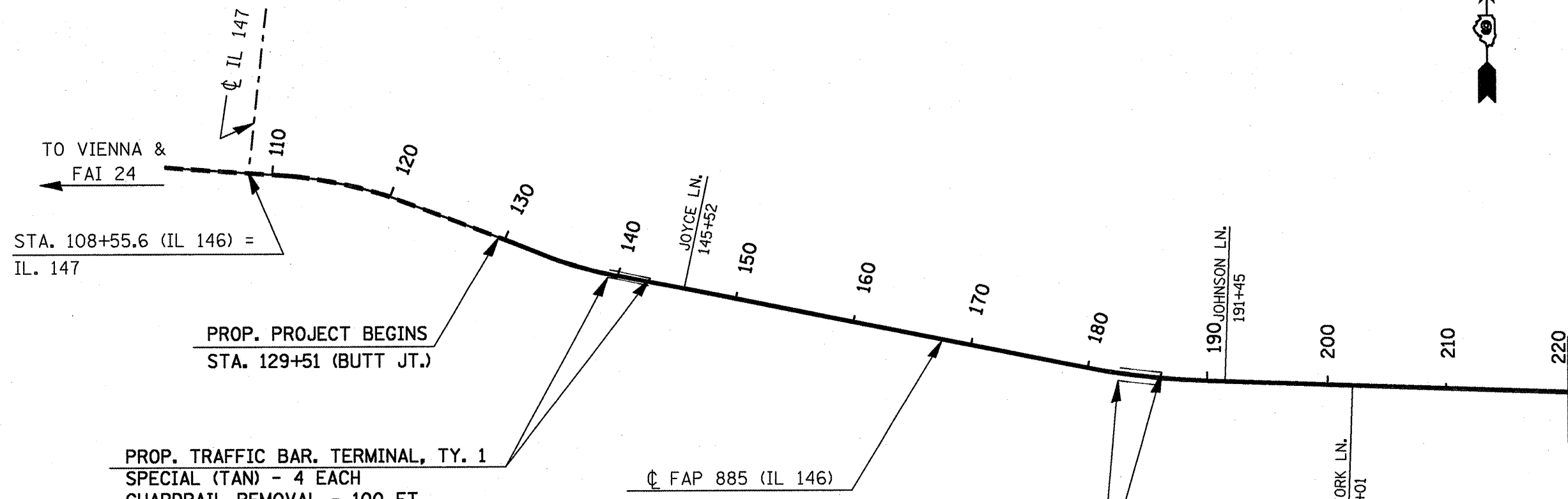

TO VIENNA &
FAI 24

STA. 108+55.6 (IL 146) =
IL. 147

PROP. PROJECT BEGINS
STA. 129+51 (BUTT JT.)

PROP. TRAFFIC BAR. TERMINAL, TY. 1
SPECIAL (TAN) - 4 EACH
GUARDRAIL REMOVAL - 100 FT.
LT. & RT. STA. 140+00 (SEE GUARDRAIL
SCHEDULE, SHT. 8)

CL FAP 885 (IL 146)

PROP. TRAFFIC BAR. TERMINAL, TY. 1
SPECIAL (TAN) - 4 EACH
GUARDRAIL REMOVAL - 100 FT.
LT. & RT. STA. 185+00 (SEE GUARDRAIL
SCHEDULE, SHT. 8)

| | | | |
|---|----------------------|------------|-----------|
| FILE NAME = | USER NAME = mcoordkr | DESIGNED - | REVISED - |
| et:\pwork\PIWIDOT\MCCORDKR\d8105162\d99825-sh1-misc.dgn | | DRAWN - | REVISED - |
| PLOT SCALE = 100.0000' / IN. | | CHECKED - | REVISED - |
| PLOT DATE = 1/12/2009 | | DATE - | REVISED - |

**STATE OF ILLINOIS
DEPARTMENT OF TRANSPORTATION**

| | | |
|--------------|-------------------------------|--------------------------|
| SCALE: _____ | SHEET NO. ____ OF ____ SHEETS | STA. _____ TO STA. _____ |
|--------------|-------------------------------|--------------------------|

| F.A.P. RTE. | SECTION | COUNTY | TOTAL SHEETS | SHEET NO. |
|---|-----------------|---------|--------------------|-----------|
| 885 | D9 SMART FY10-1 | JOHNSON | 18 | 11 |
| FED. ROAD DIST. NO. ILLINOIS FED. AID PROJECT | | | CONTRACT NO. 98825 | |

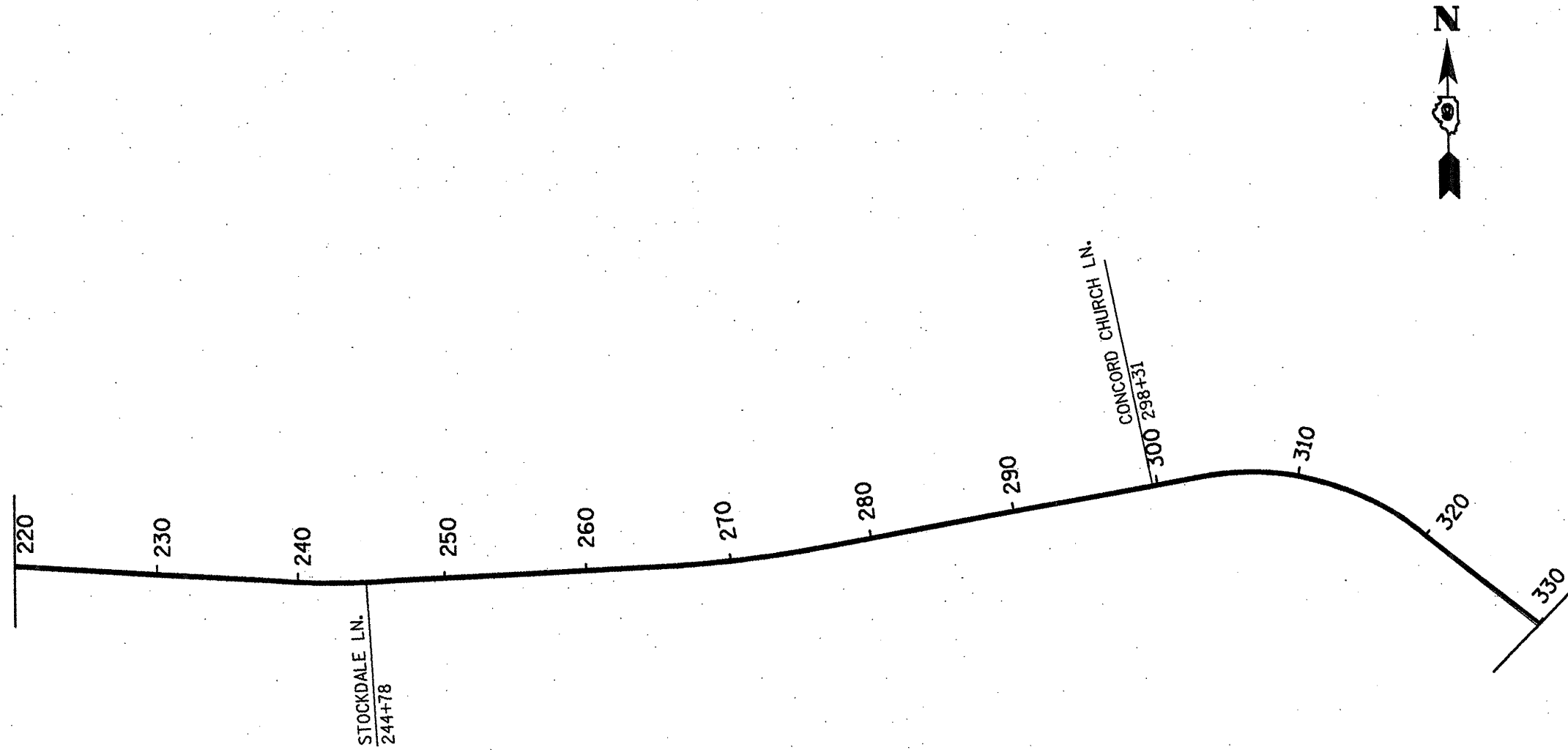

| | | | |
|--|---------------------|------------|-----------|
| FILE NAME = | USER NAME = moordkr | DESIGNED - | REVISED - |
| c:\pwork\pwork\moordkr\d0185162\499825-shr-mso.dgn | | DRAWN - | REVISED - |
| PLOT SCALE = 100.0000' / IN. | | CHECKED - | REVISED - |
| PLOT DATE = 12/30/2008 | | DATE - | REVISED - |

**STATE OF ILLINOIS
DEPARTMENT OF TRANSPORTATION**

| | | |
|--------------|---------------------------------|--------------------------|
| SCALE: _____ | SHEET NO. _____ OF _____ SHEETS | STA. _____ TO STA. _____ |
|--------------|---------------------------------|--------------------------|

| F.A.P. RTE. | SECTION | COUNTY | TOTAL SHEETS | SHEET NO. |
|--------------------|-----------------|---------|---------------------------|-----------|
| 885 | 09 SMART EY10-1 | JOHNSON | 18 | 12 |
| CONTRACT NO. 98825 | | | ILLINOIS FED. AID PROJECT | |

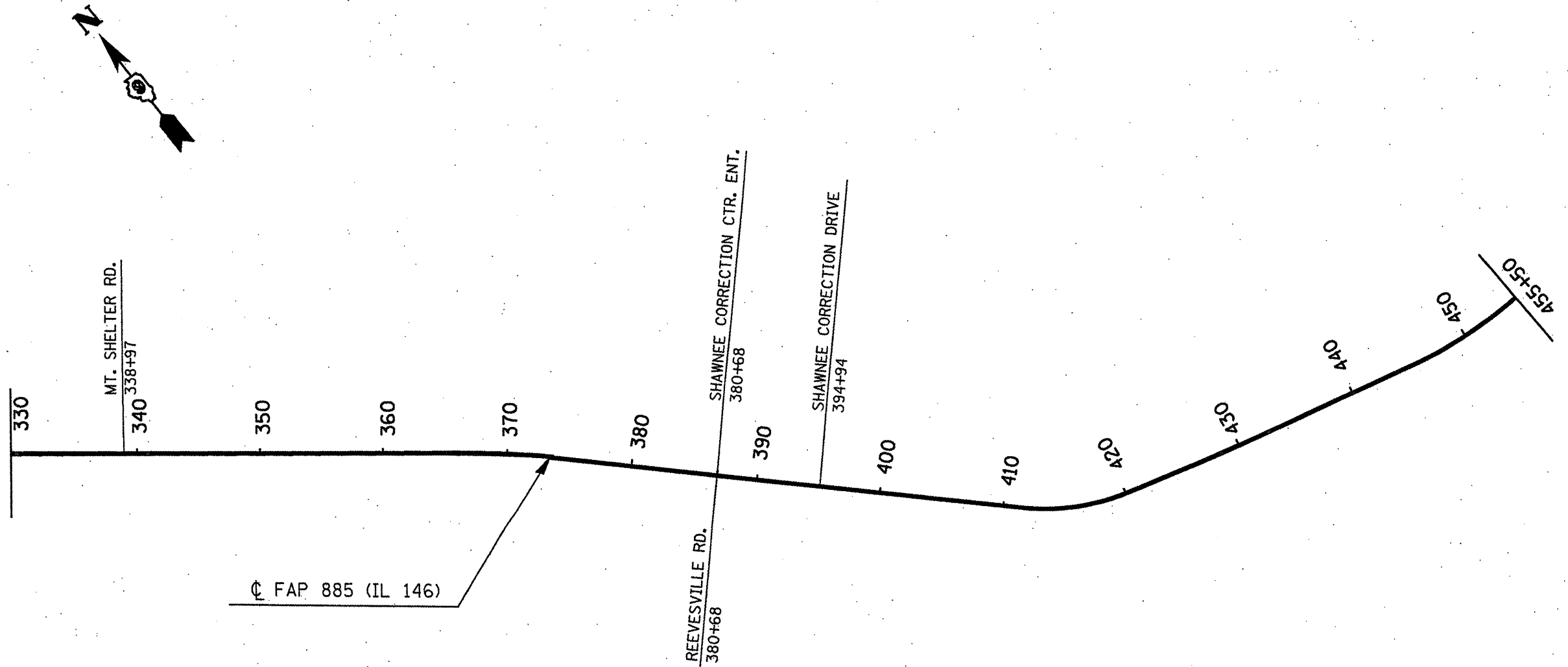

| | | | |
|--|---------------------|------------|-----------|
| FILE NAME = | USER NAME = moordkr | DESIGNED - | REVISED - |
| o:\pvc\work\p1sdo\moordkr\d0105162\d99825-ahh-m130.dgn | | DRAWN - | REVISED - |
| | | CHECKED - | REVISED - |
| | | DATE - | REVISED - |
| | | | |

**STATE OF ILLINOIS
DEPARTMENT OF TRANSPORTATION**

SCALE: _____ SHEET NO. _____ OF _____ SHEETS STA. _____ TO STA. _____

| F.A.P. RTE. | SECTION | COUNTY | TOTAL SHEETS | SHEET NO. |
|---|-----------------|---------|--------------------|-----------|
| 885 | D9 SMART FY10-1 | JOHNSON | 18 | 13 |
| FED. ROAD DIST. NO. ILLINOIS FED. AID PROJECT | | | CONTRACT NO. 98825 | |

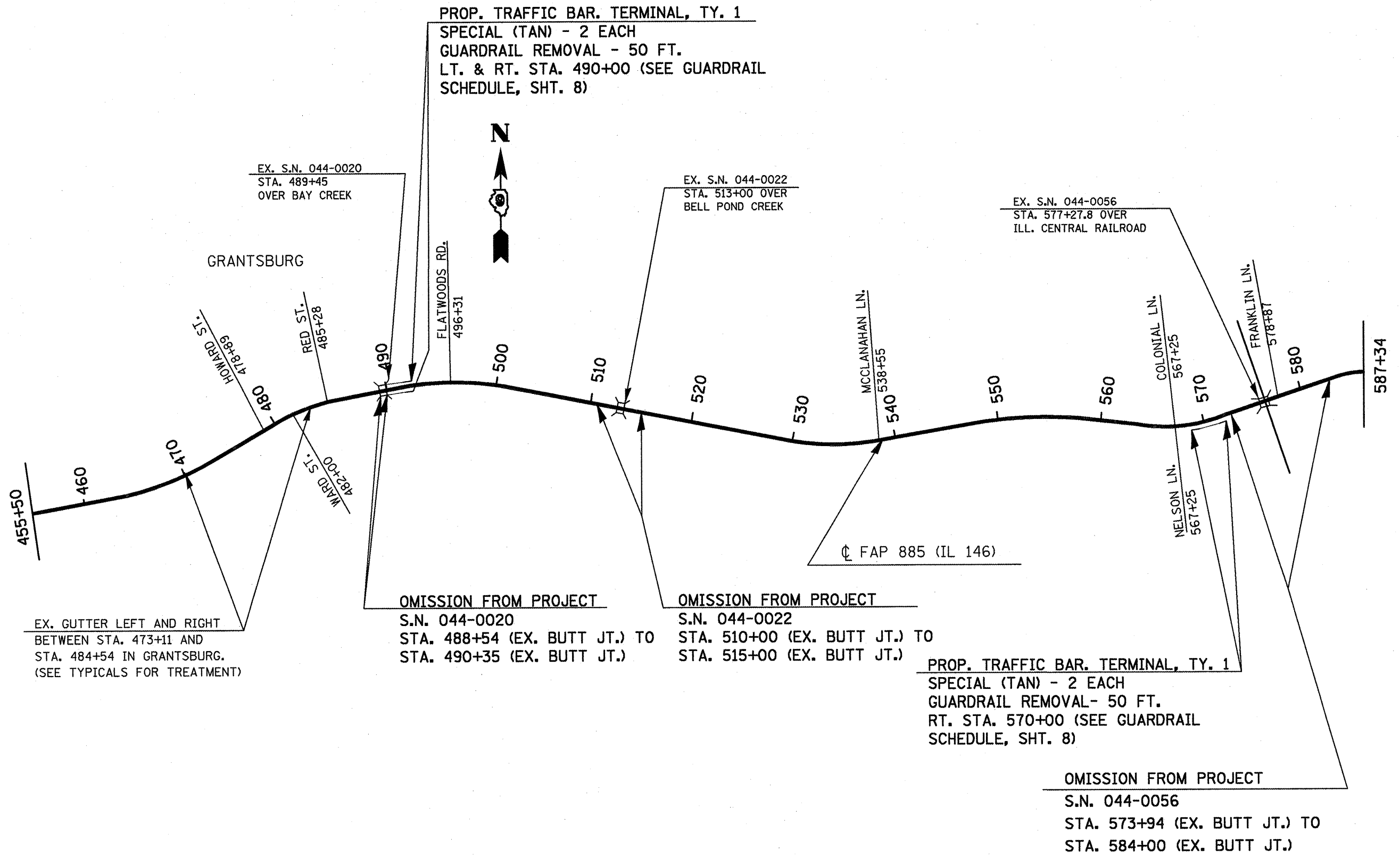

| | | | | | | | | | | | |
|---|------------------------------|------------|-----------|---|---|---|-----------------|---------|--------------|-----------|--|
| FILE NAME = | USER NAME = mcoordkr | DESIGNED - | REVISED - | STATE OF ILLINOIS DEPARTMENT OF TRANSPORTATION | SCALE: _____ SHEET NO. _____ OF _____ SHEETS STA. _____ TO STA. _____ | F.A.P. RTE. | SECTION | COUNTY | TOTAL SHEETS | SHEET NO. | |
| of\p\work\PI\DOT\MCCORDKR\d0105162\d99825-ah1-misod.dgn | PLOT SCALE = 100.0000' / IN. | DRAWN - | REVISED - | | | 885 | D9 SMART EX10-1 | JOHNSON | 18 | 14 | |
| PLOT DATE = 1/12/2009 | DATE - | CHECKED - | REVISED - | | | CONTRACT NO. 98825 | | | | | |
| | | | | | | FED. ROAD DIST. NO. - ILLINOIS FED. AID PROJECT | | | | | |

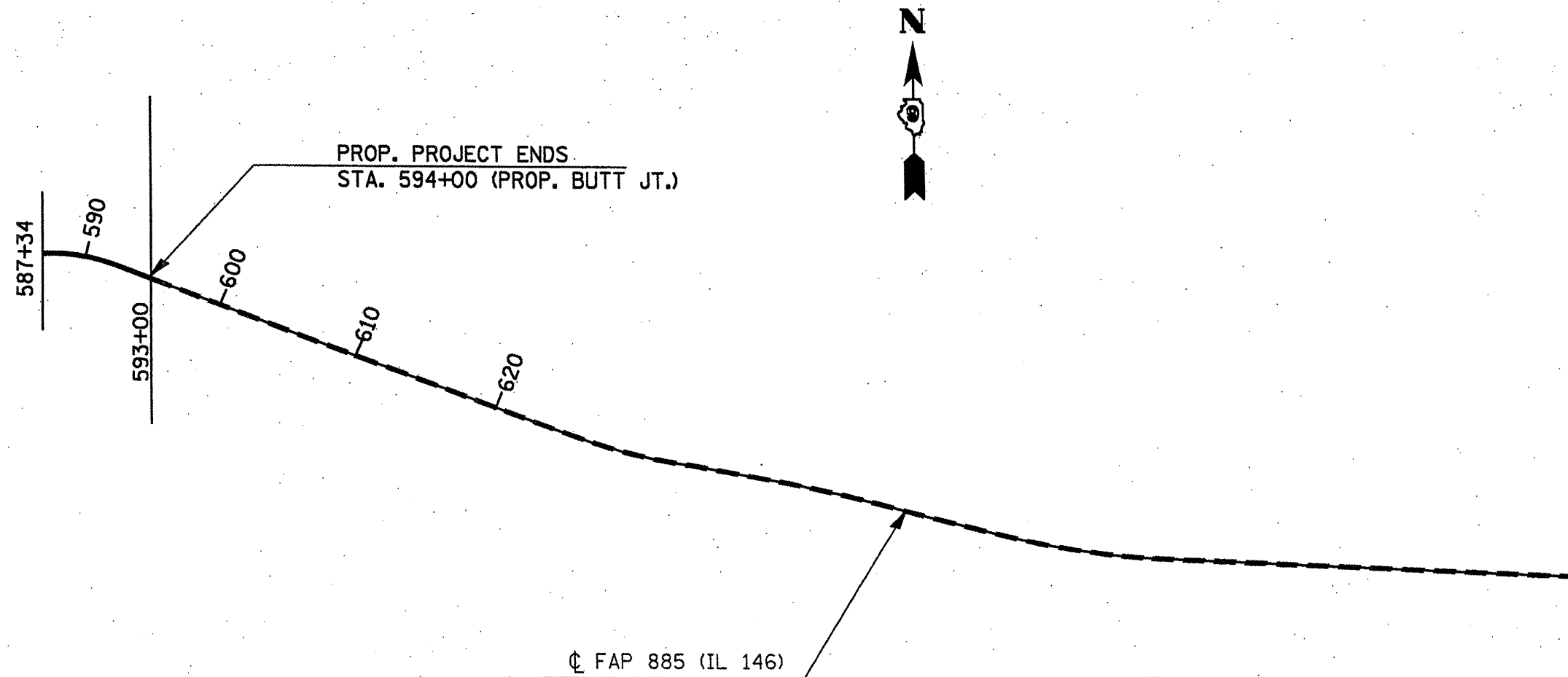

| | | | |
|--------------------------------------|------------------------------|------------|-----------|
| FILE NAME = | USER NAME = mcoordkr | DESIGNED - | REVISED - |
| of\pwork\pwork\mcoordkr\d8105182\d99 | 825-ah-miso.dgn | DRAWN - | REVISED - |
| | PLOT SCALE = 100.0000' / IN. | CHECKED - | REVISED - |
| | PLOT DATE = 12/30/2008 | DATE - | REVISED - |

**STATE OF ILLINOIS
DEPARTMENT OF TRANSPORTATION**

| | | |
|--------------|-------------------------------|--------------------------|
| SCALE: _____ | SHEET NO. ____ OF ____ SHEETS | STA. _____ TO STA. _____ |
|--------------|-------------------------------|--------------------------|

| | | | | |
|---|-----------------|---------|--------------------|-----------|
| F.A.P. RTE. | SECTION | COUNTY | TOTAL SHEETS | SHEET NO. |
| 885 | 09 SMART FY10-1 | JOHNSON | 18 | 15 |
| FED. ROAD DIST. NO. - ILLINOIS FED. AID PROJECT | | | CONTRACT NO. 98825 | |

PROP. BUTT JOINT DETAIL

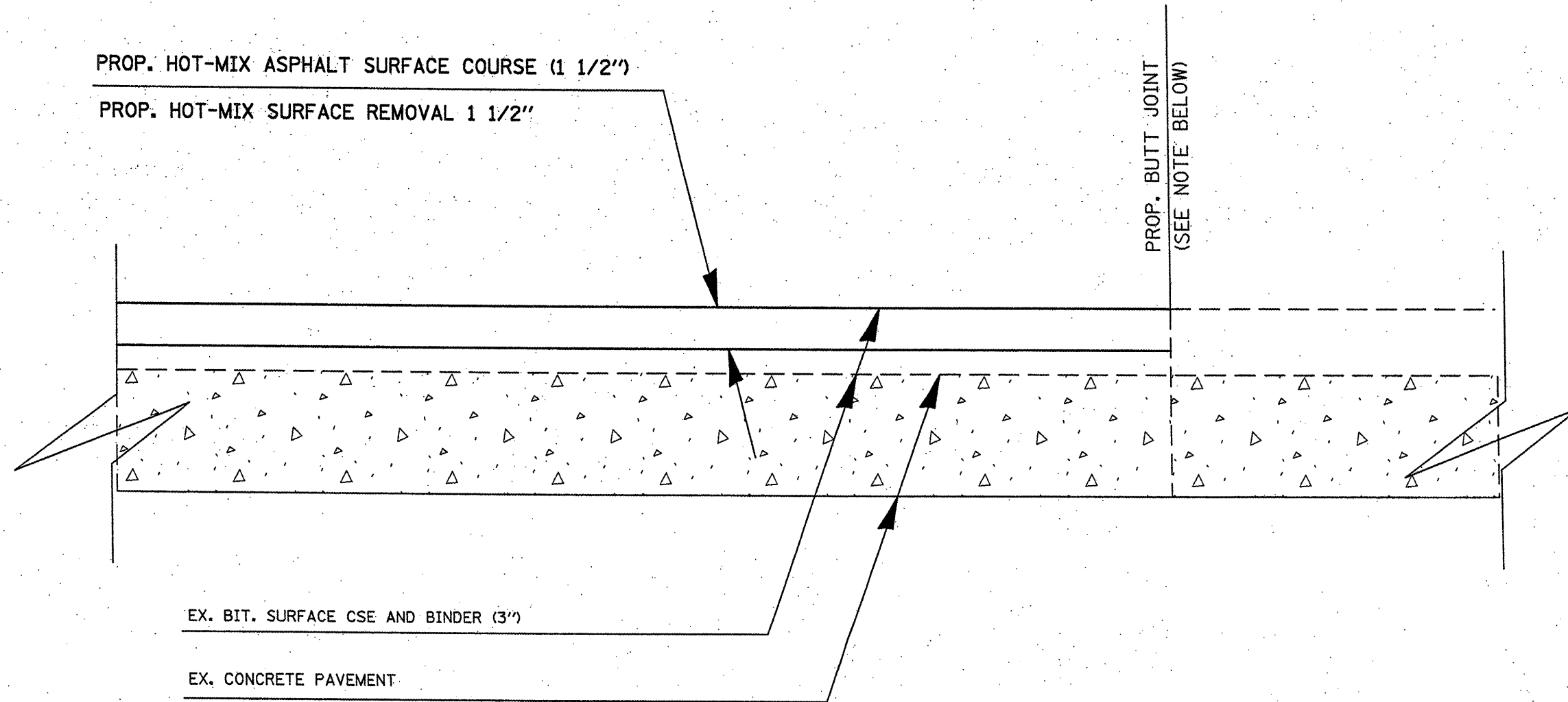

TO BE USED:
BEGINNING, END AND AT OMITTED STRUCTURES

NOTE:
PROPOSED BUTT JOINT COST IS INCLUDED IN
THE COST OF THE HMA SURFACE COURSE.

| | | | |
|--|----------------------|------------|-----------|
| FILE NAME = | USER NAME = mboardkr | DESIGNED - | REVISED - |
| o:\pwork\FWIDOT\MCCOROKR\d0105162\d98825-stt-mso.dgn | | DRAWN - | REVISED - |
| | | CHECKED - | REVISED - |
| | | DATE - | REVISED - |

**STATE OF ILLINOIS
DEPARTMENT OF TRANSPORTATION**

| | | |
|--------------|---------------------------------|--------------------------|
| SCALE: _____ | SHEET NO. _____ OF _____ SHEETS | STA. _____ TO STA. _____ |
|--------------|---------------------------------|--------------------------|

| F.A.P. RTE. | SECTION | COUNTY | TOTAL SHEETS | SHEET NO. |
|---|-----------------|---------|--------------------|-----------|
| 885 | 09 SWART FY10-1 | JOHNSON | 18 | 16 |
| FED. ROAD DIST. NO. ILLINOIS FED. AID PROJECT | | | CONTRACT NO. 98825 | |

TEMPORARY HOT-MIX ASPHALT TRANSITIONS

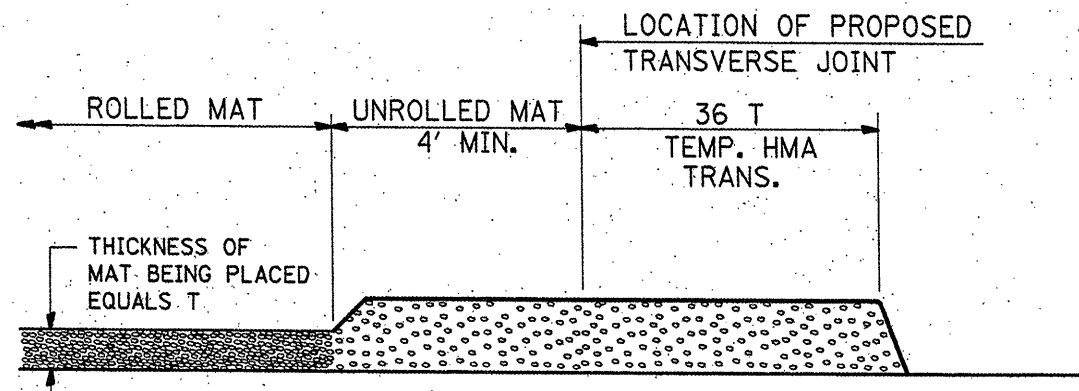

STEP I

1. PLACE HOT-MIX ASPHALT MAT, LENGTH 36 TIMES THE THICKNESS OF THE MAT BEING PLACED PAST THE PROPOSED TRANSVERSE JOINT LOCATION USING NORMAL OPERATING PROCEDURES.
2. EXTREME CARE SHOULD BE TAKEN TO MAINTAIN ENOUGH MATERIAL IN FRONT OF THE SCREED TO MAINTAIN REQUIRED PAVING DEPTH.

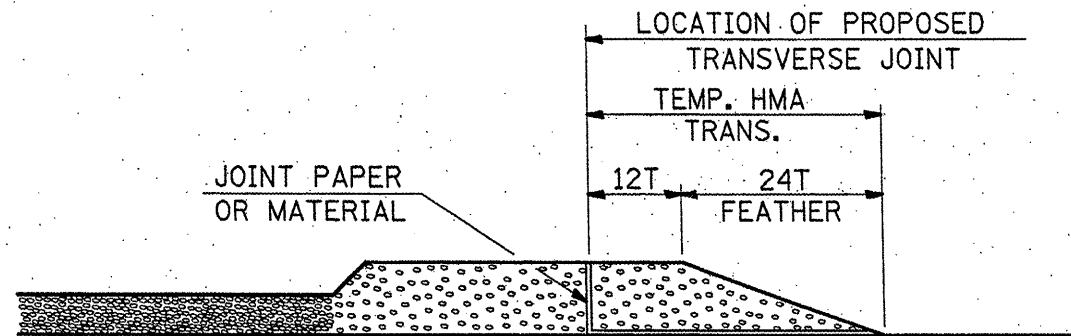

STEP III

1. JOINT PAPER OR OTHER PRESELECTED JOINT MATERIAL IS THEN PLACED IN THE CLEARED AREA AND THE EXCESS ASPHALT USED TO HAND FORM A TRANSITION TO THE DIMENSIONS SHOWN ABOVE.
2. NOTE THAT IN CONSTRUCTING THE TRANSITION, THE MAT DEPTH IS CONTINUED AS PART OF THE TRANSITION BEFORE FORMING THE FEATHER.

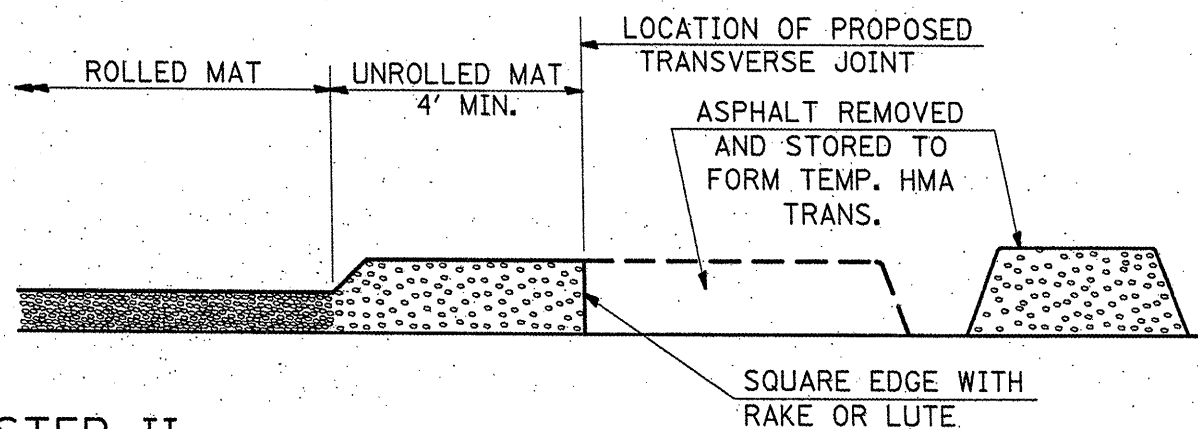

STEP II

1. MOVE THE PAVER OUT OF THE WAY AND REMOVE THE ASPHALT FROM THE AREA OF THE PROPOSED TEMPORARY HOT-MIX ASPHALT TRANSITION.
2. SQUARE UP THE END OF THE MAT WITH A RAKE OR LUTE.
3. NOTE THAT THE MAT WITHIN 4' OF THE END OF JOINT IS NOT TO BE ROLLED AT THIS TIME.

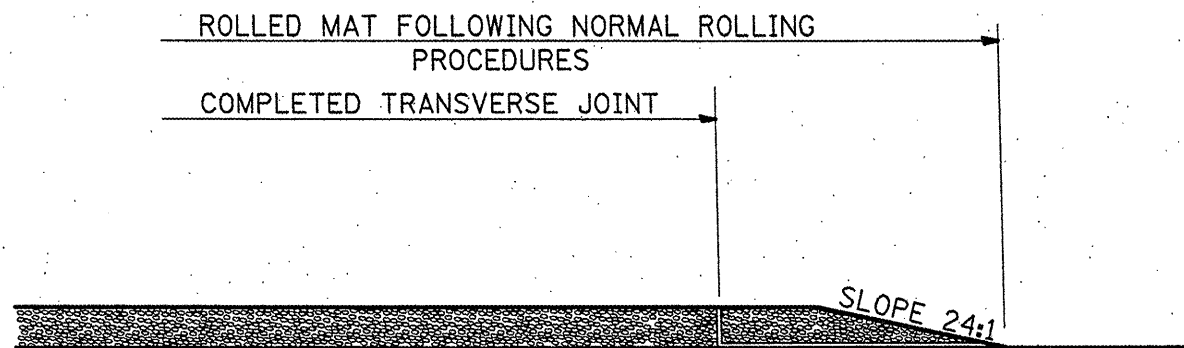

STEP IV

1. COMPLETE TEMPORARY TRANSITION BY ROLLING.
2. TO RESUME PAVING, AT THE JOINT, REMOVE TEMPORARY TRANSITION AND DISPOSE OF THE MATERIAL ACCORDING TO ART. 202.03 OF THE STD. SPECS. (COST INCLUDED IN THE CONTRACT).
3. CONSTRUCTING THE TEMPORARY TRANSITIONS WILL NOT BE PAID FOR SEPARATELY IN ACCORDANCE WITH ARTICLE 406.14 OF THE STANDARD SPECIFICATIONS.

| REVISIONS | |
|-----------|----------|
| REDRAWN | 2-15-89 |
| REVISED | 8-16-94 |
| REVISED | 01-09-07 |
| REVISED | |

STD. 9-26

| | | | |
|---|---------------------|------------|-----------|
| FILE NAME = | USER NAME = moardkr | DESIGNED - | REVISED - |
| c:\pwork\p\1007\MCCOROKR\d0105182\d98825-ah-mso.dgn | | DRAWN - | REVISED - |
| | | CHECKED - | REVISED - |
| | | DATE - | REVISED - |

STATE OF ILLINOIS
DEPARTMENT OF TRANSPORTATION

| | | | | |
|--------------------------|-----------------|---------|---|-----------|
| F.A.P. RTE. | SECTION | COUNTY | TOTAL SHEETS | SHEET NO. |
| 885 | D9 SMART FY10-1 | JOHNSON | 18 | 17 |
| SCALE: _____ | | | SHEET NO. _____ OF _____ SHEETS | |
| STA. _____ TO STA. _____ | | | FED. ROAD DIST. NO. _____ ILLINOIS FED. AID PROJECT | |

UNEVEN LANES SIGN

W8-11 (48" x 48")



COLORS:

LEGEND AND BORDER - BLACK NON-REFLECTORIZED
BACKGROUND - ORANGE REFLECTORIZED

NOTE: PRIOR TO ALLOWING TRAFFIC ON ANY PORTION OF THE ROADWAY THAT HAS BEEN COLDMILLED OR BEFORE RESURFACING OPERATIONS BEGIN, THE CONTRACTOR SHALL HAVE ERECTED "UNEVEN PAVEMENT" SIGNS THAT CONFORM TO THE ABOVE DETAILS. A MINIMUM OF ONE SIGN AT EACH END OF THE IMPROVEMENT WILL BE REQUIRED. THE CONTRACTOR SHALL MAINTAIN THE "UNEVEN PAVEMENT" SIGNS UNTIL THE RESURFACING OPERATIONS ARE COMPLETED.

IF AT ANY TIME THE SIGNS ARE IN PLACE BUT NOT APPLICABLE, THEY SHALL BE TURNED FROM THE VIEW OF MOTORISTS OR COVERED AS DIRECTED BY THE ENGINEER.

THE COST OF FURNISHING, ERECTING, MAINTAINING, AND REMOVING THE REQUIRED SIGNS SHALL BE INCLUDED IN THE CONTRACT.

| REVISIONS | |
|-----------|----------|
| DRAWN | 10-23-01 |
| REVISION | 10-23-01 |
| REVISION | 10-23-01 |
| REVISION | 10-23-01 |

STD. 9-31

ILLINOIS STANDARD

W8-I106

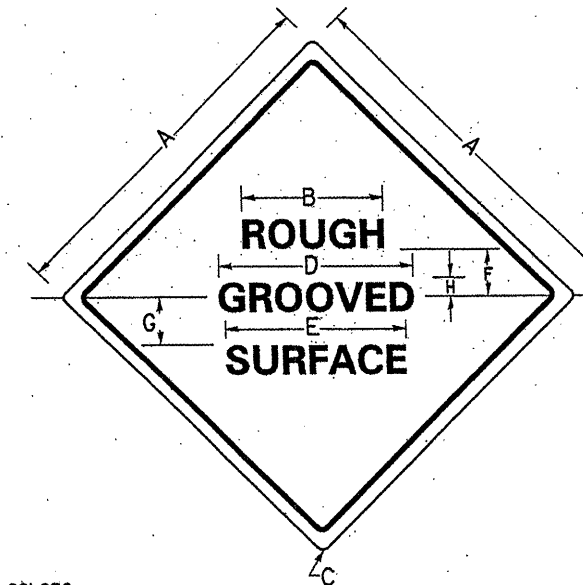

COLORS:

LEGEND AND BORDER BLACK NON-REFLECTORIZED
BACKGROUND ORANGE REFLECTORIZED

| SIGN SIZE | DIMENSIONS | | | | | | | |
|-----------|------------|------|-----|------|------|-----|------|-----|
| | A | B | C | D | E | F | G | H |
| 48x48 | 48.0 | 24.1 | 3.0 | 34.0 | 33.0 | 6.0 | 13.0 | 3.5 |

| SIGN SIZE | SERIES LINES | | | MAR-GIN | BOR-DER | BLANK STD. |
|-----------|--------------|----|----|---------|---------|------------|
| | 1 | 2 | 3 | | | |
| 48x48 | 7C | 7C | 7C | 0.8 | 1.2 | B4-48D |

NOTE: PRIOR TO ALLOWING TRAFFIC ON ANY PORTION OF THE ROADWAY THAT HAS BEEN COLDMILLED, THE CONTRACTOR SHALL HAVE ERECTED "ROUGH GROOVED SURFACE" SIGNS THAT CONFORM TO THE ABOVE DETAILS. A MINIMUM OF ONE SIGN AT EACH END OF THE IMPROVEMENT WILL BE REQUIRED. THE CONTRACTOR SHALL MAINTAIN THE "ROUGH GROOVED SURFACE" SIGNS UNTIL THE COLDMILLED SURFACE IS COVERED WITH LEVELING BINDER OR SURFACE COARSE.

IF AT ANY TIME THE SIGNS ARE IN PLACE BUT NOT APPLICABLE, THEY SHALL BE TURNED FROM THE VIEW OF MOTORISTS OR COVERED AS DIRECTED BY THE ENGINEER.

THE COST OF FURNISHING, ERECTING, MAINTAINING, AND REMOVING THE REQUIRED SIGNS SHALL BE INCLUDED IN THE CONTRACT.

ALL DIMENSIONS ARE IN INCHES UNLESS OTHERWISE NOTED.

| REVISIONS | |
|-----------|----------|
| REDRAWN | 10-23-01 |
| STD. | 9-39 |

| FILE NAME | USER NAME | DESIGNED | REVISION |
|---|-----------|----------|----------|
| ci\pwwork\VPW1001\MCCORD\K\d0105162\d99825-shr-miso.dgn | mccordkr | --- | --- |
| | | DRAWN | REVISION |
| | | CHECKED | REVISION |
| | | DATE | REVISION |

STATE OF ILLINOIS
DEPARTMENT OF TRANSPORTATION

SCALE: _____ SHEET NO. ___ OF ___ SHEETS STA. _____ TO STA. _____

| F.A.P. RTE. | SECTION | COUNTY | TOTAL SHEETS | SHEET NO. |
|---|-----------------|---------|--------------------|-----------|
| 885 | 09 SMART EY10-1 | JOHNSON | 18 | 18 |
| FED. ROAD DIST. NO. ILLINOIS FED. AID PROJECT | | | CONTRACT NO. 98825 | |