

F.A.P. RTE.	SECTION	COUNTY	TOTAL SHEETS	SHEET NO.
595	1-3-K	ROCK ISLAND	476	129
STA. 12+80		TO STA. 18+12.58		
FED. ROAD DIST. NO.		ILLINOIS FED. AID PROJECT		

PROP. CURVE 52-RAMP3-2
 P.I. STA. = 14+52.63
 $\Delta = 26^\circ 44' 19''$ (LT)
 $D = 19^\circ 05' 55''$
 $R = 300.00'$
 $T = 71.30'$
 $L = 140.00'$
 $E = 8.36'$
 $e = 8.0\%$
 $T.R. = 0$
 $P.C.S.E. RUN = 185.51' w/ 61.22' on curve$
 $T.R. = 45'$
 $P.T.S.E. RUN = 175'$
 $P.C. STA = 13+81.33$
 $P.T. STA = 15+21.33$

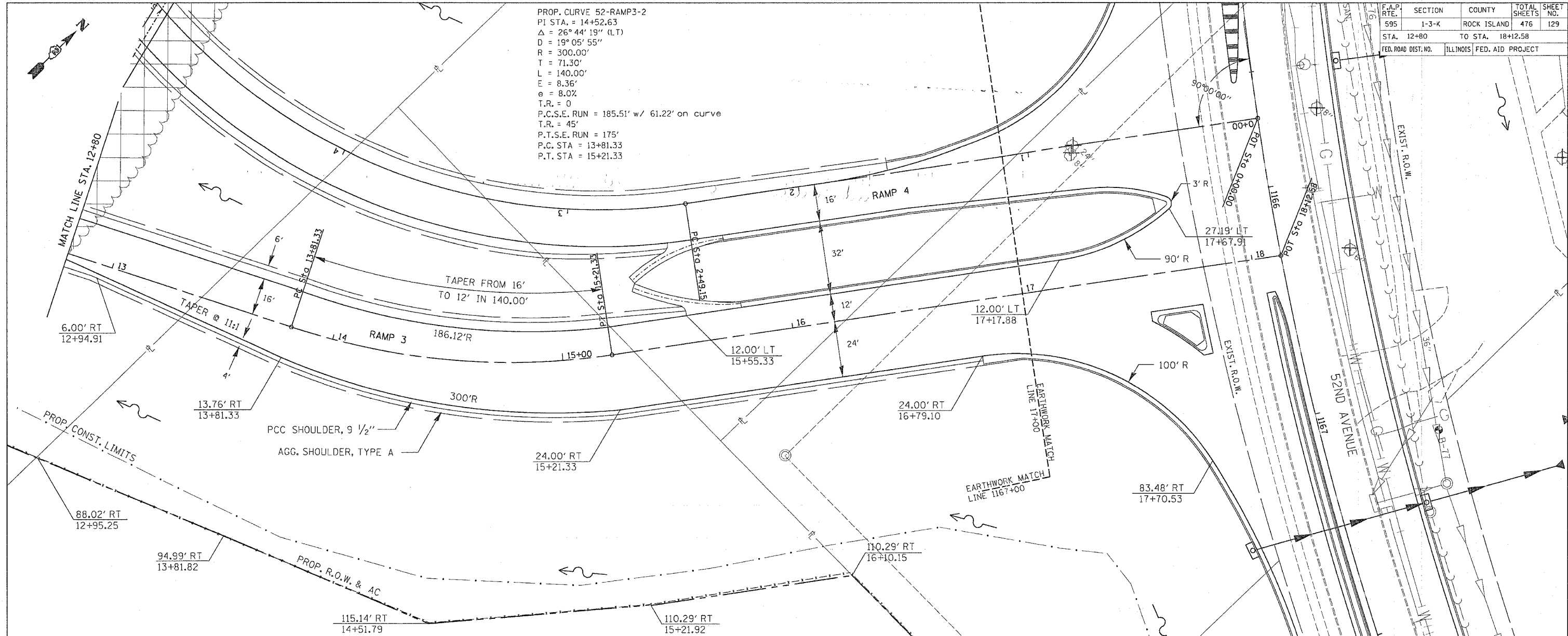

DATE	BY	REVISION

DATE	BY	REVISION

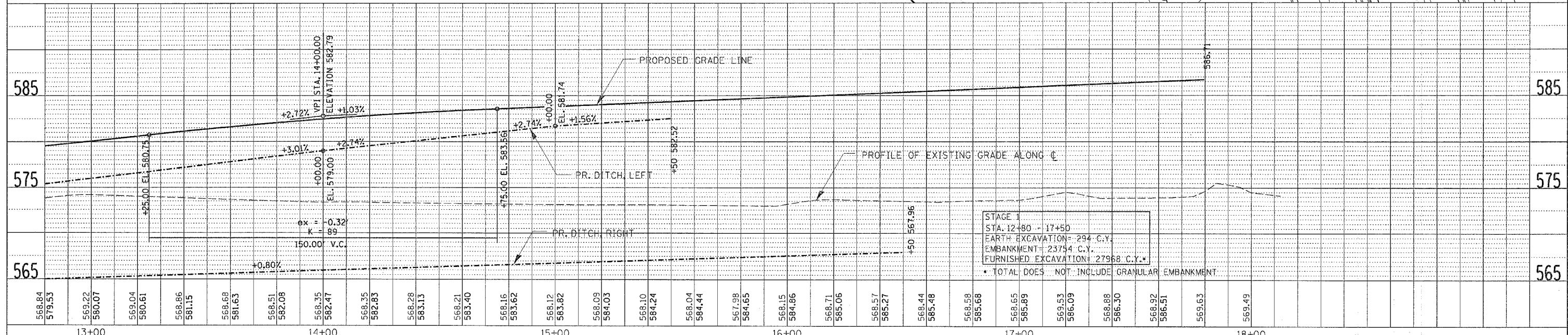

STAGE 1
 STA. 12+80 - 17+50
 EARTH EXCAVATION - 294 C.Y.
 EMBANKMENT - 23754 C.Y.
 FURNISHED EXCAVATION - 27968 C.Y.*
 * TOTAL DOES NOT INCLUDE GRANULAR EMBANKMENT