

F.A.P. RTE.	SECTION	COUNTY	TOTAL SHEETS	SHEET NO.
595	1-3-K	ROCK ISLAND	476	131
STA. 6+40		TO STA. 12+80		
FED. ROAD DIST. NO.		ILLINOIS		FED. AID PROJECT

PLAN	REVISIONS	DATE
NO.		
BY		
CHECKED		
APPROVED		
DATE		

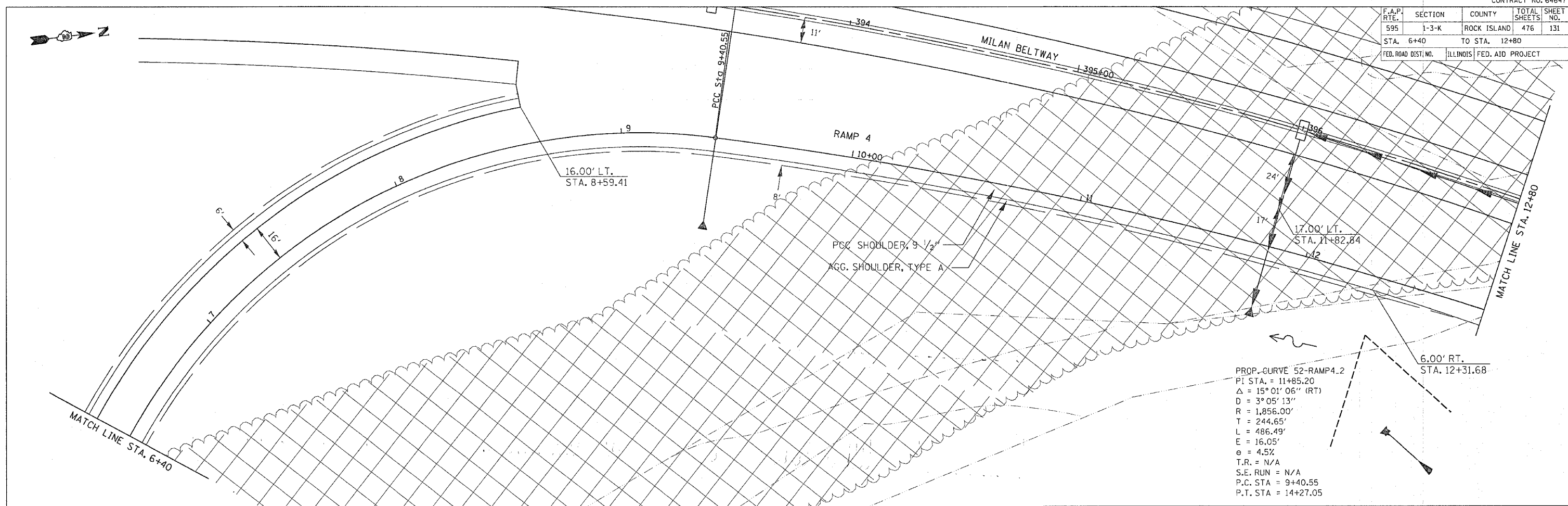

PROP. CURVE 52-RAMP4.2
 PI STA. = 11+85.20
 Δ = 15° 01' 06" (RT)
 D = 3° 05' 13"
 R = 1,856.00'
 T = 244.65'
 L = 486.49'
 E = 16.05'
 e = 4.5%
 T.R. = N/A
 S.E. RUN = N/A
 P.C. STA = 9+40.55
 P.T. STA = 14+27.05

PROFILE	REVISIONS	DATE
NO.		
BY		
CHECKED		
APPROVED		
DATE		

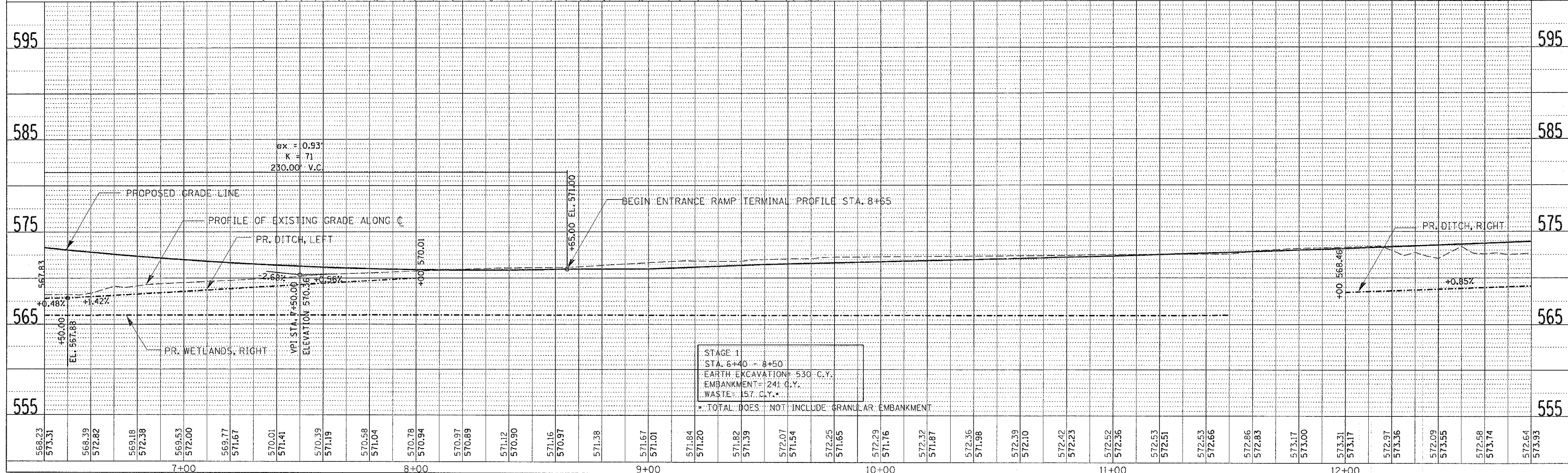

STAGE 1
 STA. 8+40 - 8+50
 EARTH EXCAVATION = 530 C.Y.
 EMBANKMENT = 241 C.Y.
 WASTE = 157 C.Y.
 TOTAL DOES NOT INCLUDE GRANULAR EMBANKMENT

52ND AVENUE RAMP 4 - STA. 6+40 TO STA. 12+80