

F.A.P. RTE.	SECTION	COUNTY	TOTAL SHEETS	SHEET NO.
595	1-3-K	ROCK ISLAND	476	132
STA. 12+80		TO STA. 14+27.05		
FED. ROAD DIST. NO.		ILLINOIS FED. AID PROJECT		

PLAN	REVIEWED	DATE
NOTE BOOK NO.	PLOTTED	
	ALIGNED	
	CHECKED	
	CADD FILE NAME	

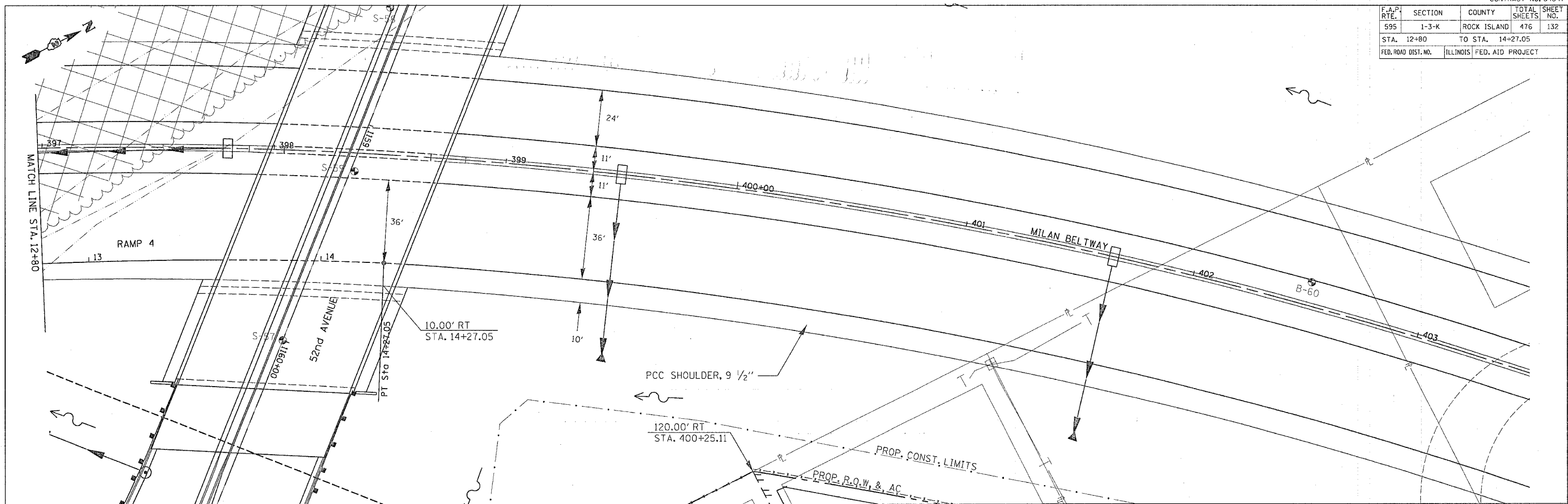

PROFILE	REVIEWED	DATE
NOTE BOOK NO.	PLOTTED	
	GRADES CHECKED	
	STRUCTURE NOTATIONS OK'D	

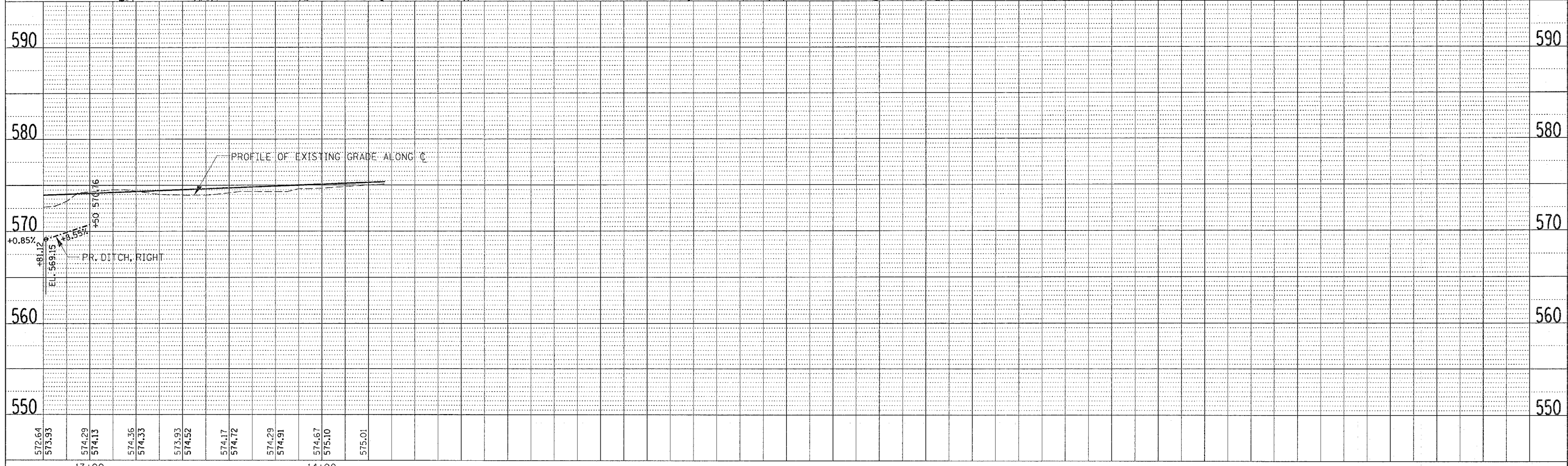

52ND AVENUE RAMP 4 - STA. 12+80 TO STA. 14+27.05