

F.A.P. RTE.	SECTION	COUNTY	TOTAL SHEETS	SHEET NO.
595	1-3-K	ROCK ISLAND	476	146
STA.		TO STA.		
FED. ROAD DIST. NO.		ILLINOIS	FED. AID PROJECT	



INTERCHANGE LAYOUT

PROP. CURVE BIKE-3
 PI STA. = 607+21.02
 $\Delta = 9^\circ 26' 06''$ (RT)
 $D = 14^\circ 19' 26''$
 $R = 400.00'$
 $T = 33.01'$
 $L = 65.87'$
 $E = 1.36'$
 P.C. STA = 606+88.01
 P.T. STA = 607+53.88

PROP. CURVE BIKE-4
 PI STA. = 608+29.38
 $\Delta = 10^\circ 59' 40''$ (LT)
 $D = 57^\circ 17' 45''$
 $R = 100.00'$
 $T = 9.62'$
 $L = 19.19'$
 $E = 0.46'$
 P.C. STA = 608+19.75
 P.T. STA = 608+38.94

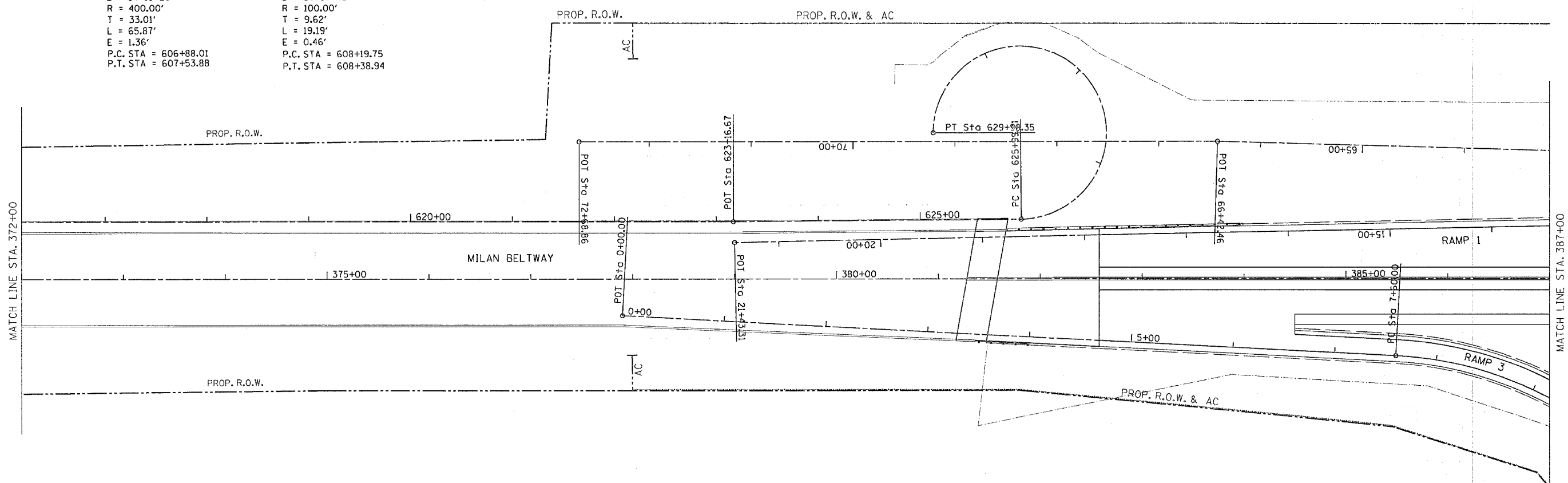

PROP. CURVE 52-RAMP3-1
 PI STA. = 9+64.85
 $\Delta = 59^\circ 04' 44''$ (RT)
 $D = 15^\circ 51' 00''$
 $R = 361.49'$
 $T = 204.85'$
 $L = 372.74'$
 $E = 54.01'$
 $e = 8.0\%$
 $T.R. = 0$
 P.C.S.E. RUN = 166' w/ 66' on curve
 $T.R. = 0$
 S.E. RUN = 185.51' w/ 61.22' on curve
 P.C. STA = 7+60.00
 P.T. STA = 11+32.74