

F.A.P. RTE.	SECTION	COUNTY	TOTAL SHEETS	SHEET NO.
595	1-3-K	ROCK ISLAND	476	180
STA.		TO STA.		
FED. ROAD DIST. NO.		ILLINOIS FED. AID PROJECT		

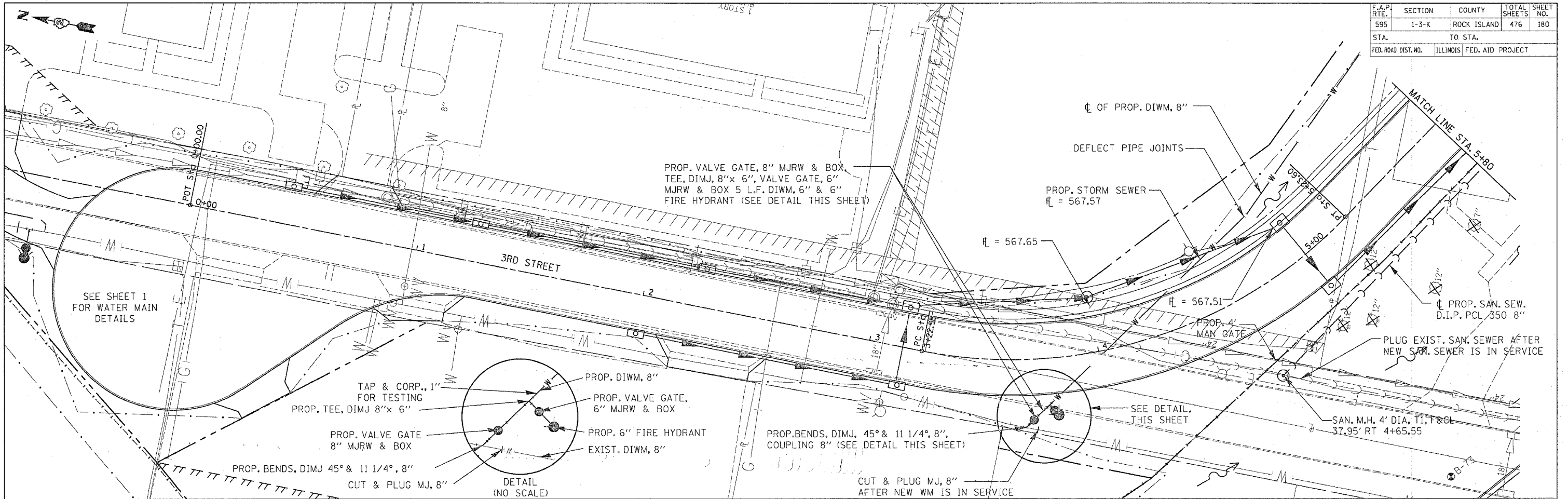

PLAN	SURVEYED	DATE
NOTE BOOK	GRADES CHECKED	BY
NO.	PLANS CHECKED	
	FILED	

PROFILE	SURVEYED	DATE
NOTE BOOK	GRADES CHECKED	BY
NO.	PLANS CHECKED	
	FILED	

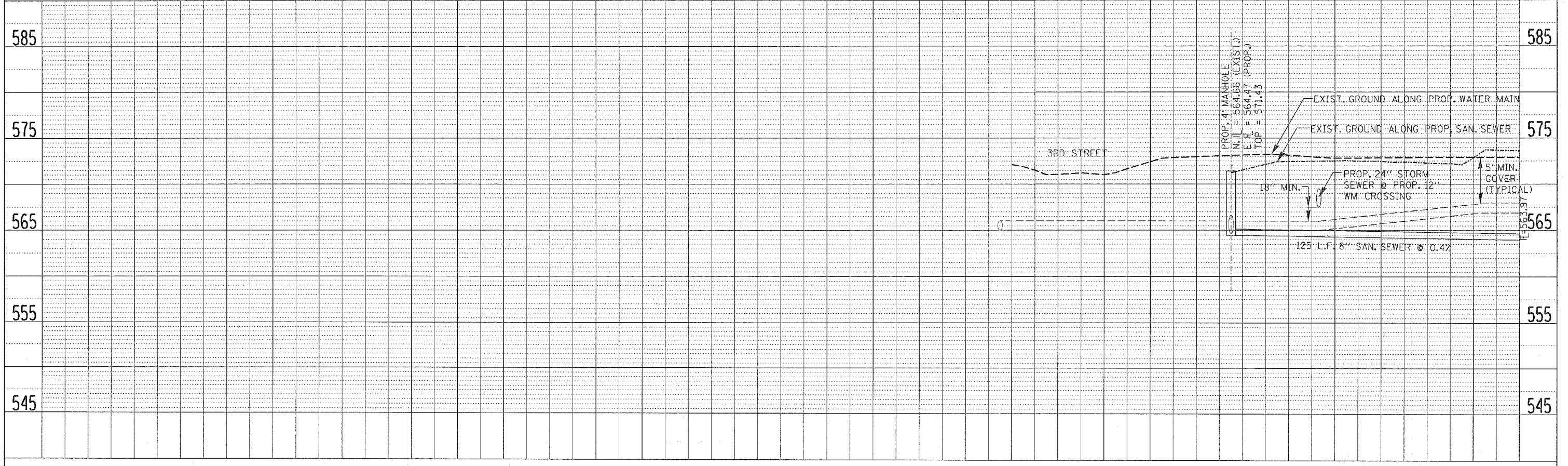

**3RD STREET - STA. 0+00 TO STA. 5+80**