

04-22-2016 LETTING ITEM 051

STATE OF ILLINOIS  
DEPARTMENT OF TRANSPORTATION  
DIVISION OF HIGHWAYS

# PROPOSED HIGHWAY PLANS

VARIOUS ROUTES  
SECTION D5 CRACK & JOINT SEAL 2016-1

CRACK AND JOINT SEALING  
CHAMPAIGN & VERMILION COUNTIES

C-95-054-15

(EAST FIELD AREA CRACK SEALING)

F. A. RTE.	SECTION	COUNTY	TOTAL SHEETS	SHEET NO.
VAR.	*	**	20	1

ILLINOIS CONTRACT NO. 70B55  
\*D5 CRACK & JOINT SEAL 2016-1  
\*\*CHAMPAIGN & VERMILION

D-95-054-15

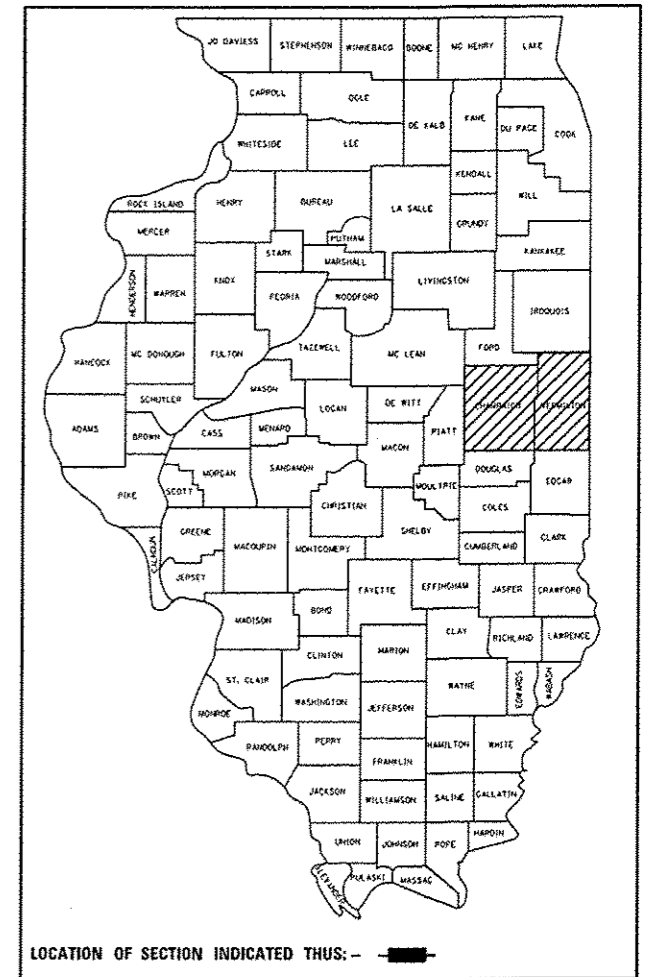

FOR INDEX OF SHEETS, SEE SHEET NO. 2  
FOR SUMMARY OF QUANTITIES, SEE SHEET NO. 7

ADT - SEE LOCATION MAPS

FOR LOCATION MAPS, SEE SHEETS 4-6

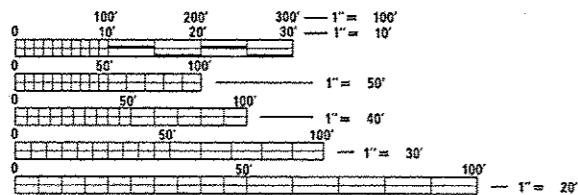

FULL SIZE PLANS HAVE BEEN PREPARED USING STANDARD ENGINEERING SCALES. REDUCED SIZED PLANS WILL NOT CONFORM TO STANDARD SCALES. IN MAKING MEASUREMENTS ON REDUCED PLANS, THE ABOVE SCALES MAY BE USED.

J.U.L.I.E.  
JOINT UTILITY LOCATION INFORMATION FOR EXCAVATION  
1-800-892-0123 HENSLEY AND  
OR 811 SOMER TOWNSHIP

PROJECT ENGINEER: NANCY FASIG  
SQUAD LEADER: STEVE COOMBES  
(217) 465-4181  
CONTRACT NO. 70B55

STATE OF ILLINOIS  
DEPARTMENT OF TRANSPORTATION  
DIVISION OF HIGHWAYS

SUBMITTED January 26, 2016  
Steve Coombes  
DEPUTY DIRECTOR OF HIGHWAYS, REGION ENGINEER

March 18, 2016  
Margaret M. Addis PE  
ENGINEER OF DESIGN AND ENVIRONMENT

March 18, 2016  
Chris Coombes PE  
DIRECTOR OF HIGHWAYS, CHIEF ENGINEER

PRINTED BY THE AUTHORITY  
OF THE STATE OF ILLINOIS

## INDEX OF SHEETS

SHEET NO.	DESCRIPTION
1	COVER SHEET
2	INDEX OF SHEETS
2	LIST OF STANDARDS
3	GENERAL NOTES
4-6	LOCATION MAPS
7	SUMMARY OF QUANTITIES
8-19	EXISTING TYPICAL CROSS SECTIONS
20	DETAIL FOR CRACK AND JOINT SEALING

## LIST OF STANDARDS

STANDARD NO.	NAME OF STANDARD
000001-06	STANDARD SYMBOLS, ABBREVIATIONS AND PATTERNS
001006	DECIMAL OF AN INCH AND OF A FOOT
701306-03	LANE CLOSURE, 2L, 2W, SLOW MOVING OPERATIONS DAY ONLY FOR SPEEDS > 45MPH
701400-08	APPROACH TO LANE CLOSURE, FREEWAY/EXPRESSWAY
701406-10	LANE CLOSURE, FREEWAY/EXPRESSWAY, DAY OPERATIONS ONLY
701411-09	LANE CLOSURE, MULTILANE, AT ENTRANCE OR EXIT RAMP, FOR SPEEDS > 45 MPH
701456-03	PARTIAL EXIT RAMP CLOSURE FREEWAY/EXPRESSWAY
701602-07	URBAN LANE CLOSURE, MULTILANE, 2W 2W WITH BIDIRECTIONAL LEFT TURN LANE
701606-10	URBAN SINGLE LANE CLOSURE, MULTILANE, 2W WITH MOUNTABLE MEDIAN
701701-10	URBAN LANE CLOSURE, MULTILANE INTERSECTION
701901-05	TRAFFIC CONTROL DEVICES

\*\*CHAMPAIGN & VERMILION

FILE NAME #	USER NAME # coombesf	DESIGNED -	REVISED -	<b>STATE OF ILLINOIS DEPARTMENT OF TRANSPORTATION</b>	<b>INDEX OF SHEETS &amp; LIST OF STANDARDS</b>	F.A. RTE.	SECTION	COUNTY	TOTAL SHEETS	SHEET NO.
p:\N\284884\INTEG\Illinois.gov\PKIDOT\do	ments\DDT Office\District 5\Projects\057	DRAWN Date\Design\0570855-sht-plan.dgn	REVISED -			VAR.	*	**	20	2
PLOT SCALE = 48,0000' / in.	CHECKED -	REVISED -	*DS CRACK & JOINT SEAL 2016-1			CONTRACT NO. 70855				
PLOT DATE = 1/15/2016	DATE -	REVISED -	ILLINOIS FED. AID PROJECT							
MODELNAME#					SCALE: N/A	SHEET 1 OF 1 SHEETS		STA. TO STA.		

## GENERAL NOTES

**G.N. 100**

ENGLISH UNITS OF MEASUREMENT SHALL GOVERN OVER AND SUPERSEDE ANY METRIC UNITS SHOWN IN THIS CONTRACT. WHERE INCLUDED, METRIC UNITS ARE FOR INFORMATION ONLY.

**G.N. 100A**

ELECTRONIC FILES AND/OR ELECTRONIC SURVEY INFORMATION INCLUDING CADD FILES WILL NOT BE AVAILABLE TO THE CONTRACTOR.

**G.N.-107.12A**

RAILROAD PROTECTIVE LIABILITY INSURANCE IS NOT INCLUDED IN THIS CONTRACT. ALL ROUT AND SEAL OPERATIONS SHALL STOP AT THE RAILROAD RIGHT-OF-WAY LINE UNLESS THE RAILROAD RIGHT-OF-WAY LINE IS LESS THAN 25.0 FEET FROM THE RAILROAD TRACKS THEN THE ROUT AND SEAL OPERATIONS SHALL STOP 25.0 FEET FROM THE RAILROAD TRACKS. THE RAILROAD RIGHT-OF-WAY LINE SHALL BE DETERMINED IN THE FIELD BY THE RESIDENT ENGINEER.

**G.N. 451 (SPECIAL)**

THE INTENT OF THIS PROJECT IS TO ONLY BLOW OUT AND SEAL THE LONGITUDINAL JOINTS & CRACKS (I.E. - NO ROUTING). THE TRANSVERSE CRACKS WILL BE SEALED AS DESCRIBED AT EACH LOCATION LISTED IN THIS NOTE. ANY CHANGES TO THE INTENT OF ROUTING AND SEALING OPERATIONS SHALL BE APPROVED IN ADVANCE BY THE ENGINEER.

LOCATIONS SHALL BE DONE IN THE NUMERICAL ORDER GIVEN IN THE PLANS.

THE FOLLOWING APPLICATION RATES WERE USED TO CALCULATE MATERIAL FOR SEALING JOINTS AND CRACKS AT ALL LOCATIONS:  
LONGITUDINAL (OR NON-ROUTED) = 0.2 LBS / LINEAR FOOT

ALL PCC BRIDGE DECKS AND PAVEMENTS ARE TO BE OMISSIONS. BRIDGE DECKS WITH HMA OVERLAYS ARE TO BE SEALED ONLY (NO ROUTING).

**LOCATION #1 - I-57 N.B. & S.B. FROM OLYMPIAN DR. TO 2 MILES S. OF THOMASBORO**

- 1) LONGITUDINAL JOINTS AND CRACKS EQUAL TO OR GREATER THAN 1/4" IN WIDTH ALONG CENTER LINE, TURN LANES, EDGE OF PAVEMENT / SHOULDERS AND OTHER PAVING JOINTS (AS DIRECTED BY THE ENGINEER) SHALL BE SEALED.
- 2) LONGITUDINAL CRACKS WITHIN THE MARKED LANES SHALL **NOT** BE SEALED.
- 3) LONGITUDINAL PAVING JOINTS, PARALLEL TO THE MAINLINE, AT SIDE ROADS AND ENTRANCES SHALL BE SEALED AS NEEDED. ALL OTHER CRACKS AT THESE LOCATIONS ARE TO BE OMITTED.
- 4) LONGITUDINAL JOINTS WITH DOUBLE CRACKS ALONG THE CENTERLINE OR ALONG THE EDGE OF PAVEMENT / SHOULDER SHALL BE SEALED AS NEEDED.

APPROXIMATE QUANTITIES AT THIS LOCATION:  
LONGITUDINAL: 180,869 FOOT  
SEALER: 36,174 POUNDS

**LOCATION #2 - IL 47 FROM THE FORD COUNTY LINE TO US 136**

- 1) LONGITUDINAL JOINTS AND CRACKS EQUAL TO OR GREATER THAN 1/4" IN WIDTH ALONG CENTER LINE, TURN LANES, EDGE OF PAVEMENT / SHOULDERS AND OTHER PAVING JOINTS (AS DIRECTED BY THE ENGINEER) SHALL BE SEALED.
- 2) LONGITUDINAL CRACKS WITHIN THE MARKED LANES SHALL **NOT** BE SEALED.
- 3) LONGITUDINAL PAVING JOINTS, PARALLEL TO THE MAINLINE, AT SIDE ROADS AND ENTRANCES SHALL BE SEALED AS NEEDED. ALL OTHER CRACKS AT THESE LOCATIONS ARE TO BE OMITTED.
- 4) LONGITUDINAL JOINTS WITH DOUBLE CRACKS ALONG THE CENTERLINE OR ALONG THE EDGE OF PAVEMENT / SHOULDER SHALL BE SEALED AS NEEDED.

APPROXIMATE QUANTITIES AT THIS LOCATION:  
LONGITUDINAL: 31,421 FOOT  
SEALER: 6,284 POUNDS

**LOCATION #3 - US 136 (MAIN ST. IN DANVILLE) FROM NATIONAL AVE. TO KANSAS AVE.**

- 1) LONGITUDINAL JOINTS AND CRACKS EQUAL TO OR GREATER THAN 1/4" IN WIDTH ALONG CENTER LINE, TURN LANES, EDGE OF PAVEMENT / SHOULDERS AND OTHER PAVING JOINTS (AS DIRECTED BY THE ENGINEER) SHALL BE SEALED.
- 2) LONGITUDINAL CRACKS WITHIN THE MARKED LANES SHALL **NOT** BE SEALED.
- 3) LONGITUDINAL PAVING JOINTS, PARALLEL TO THE MAINLINE, AT SIDE ROADS AND ENTRANCES SHALL BE SEALED AS NEEDED. ALL OTHER CRACKS AT THESE LOCATIONS ARE TO BE OMITTED.
- 4) LONGITUDINAL JOINTS WITH DOUBLE CRACKS ALONG THE CENTERLINE OR ALONG THE EDGE OF PAVEMENT / SHOULDER SHALL BE SEALED AS NEEDED.

APPROXIMATE QUANTITIES AT THIS LOCATION:  
LONGITUDINAL: 14,763 FOOT  
SEALER: 2,953 POUNDS

**LOCATION #4 - US 150 / IL 1 FROM MAIN ST. IN DANVILLE TO 16TH ST. IN TILTON**

- 1) LONGITUDINAL JOINTS AND CRACKS EQUAL TO OR GREATER THAN 1/4" IN WIDTH ALONG CENTER LINE, TURN LANES, EDGE OF PAVEMENT / SHOULDERS AND OTHER PAVING JOINTS (AS DIRECTED BY THE ENGINEER) SHALL BE SEALED.
- 2) LONGITUDINAL CRACKS WITHIN THE MARKED LANES SHALL **NOT** BE SEALED.
- 3) LONGITUDINAL PAVING JOINTS, PARALLEL TO THE MAINLINE, AT SIDE ROADS AND ENTRANCES SHALL BE SEALED AS NEEDED. ALL OTHER CRACKS AT THESE LOCATIONS ARE TO BE OMITTED.
- 4) LONGITUDINAL JOINTS WITH DOUBLE CRACKS ALONG THE CENTERLINE OR ALONG THE EDGE OF PAVEMENT / SHOULDER SHALL BE SEALED AS NEEDED.
- 5) TRANSVERSE CRACKS EQUAL TO OR GREATER THAN 1/4" IN WIDTH SHALL BE SEALED.

APPROXIMATE QUANTITIES AT THIS LOCATION:  
LONGITUDINAL: 37,605 FOOT  
SEALER: 7,521 POUNDS

\*\*CHAMPAIGN & VERMILION

FILE NAME =	USER NAME = coombesf	DESIGNED -	REVISED -	<b>STATE OF ILLINOIS DEPARTMENT OF TRANSPORTATION</b>	<b>GENERAL NOTES</b>	F.A. RTE.	SECTION	COUNTY	TOTAL SHEETS	SHEET NO.
pm\11\08*EBID\INTEG\illinois.gov\PI\DOT\Documents\DOT Offices\District 5\Projects\057\DRAWING>Data\Design\0570855-shl-plan.dgn		CHECKED -	REVISED -			VAR.	.	**	20	3
#MODELNAME#	PLOT SCALE = 48.0000' / 1" /	DATE -	REVISED -		SCALE: N/A	SHEET 1 OF 1 SHEETS		STA. TO STA.	*05 CRACK & JOINT SEAL 2016-1 CONTRACT NO. 70855	
	PLOT DATE = 1/15/2016					ILLINOIS FED. AID PROJECT				

**LOCATION MAPS FOR LOCATION #1**  
**I-57 FROM OLYMPIAN DR. TO 2 MI. S OF THOMASBORO**  
**CHAMPAIGN COUNTY**

**ADT**

LOCATION 1: AVERAGE ADT = 22,750 (2015)

**I 57 SOUTHBOUND**

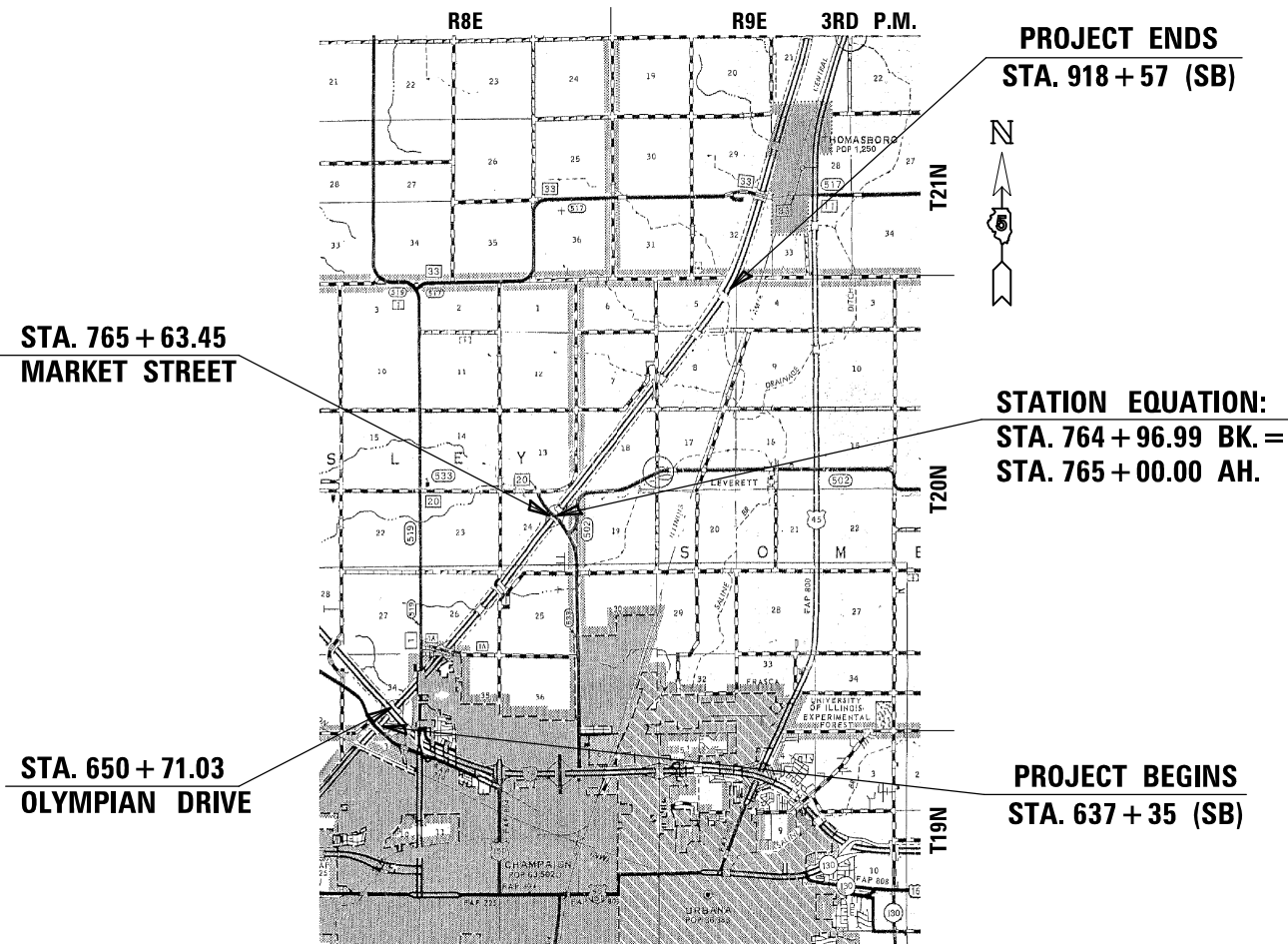

LOCATION MAP



GROSS LENGTH = 28,118.99 FT. = 5.326 MILE  
 NET LENGTH = 28,118.99 FT. = 5.326 MILE

**I 57 NORTHBOUND**

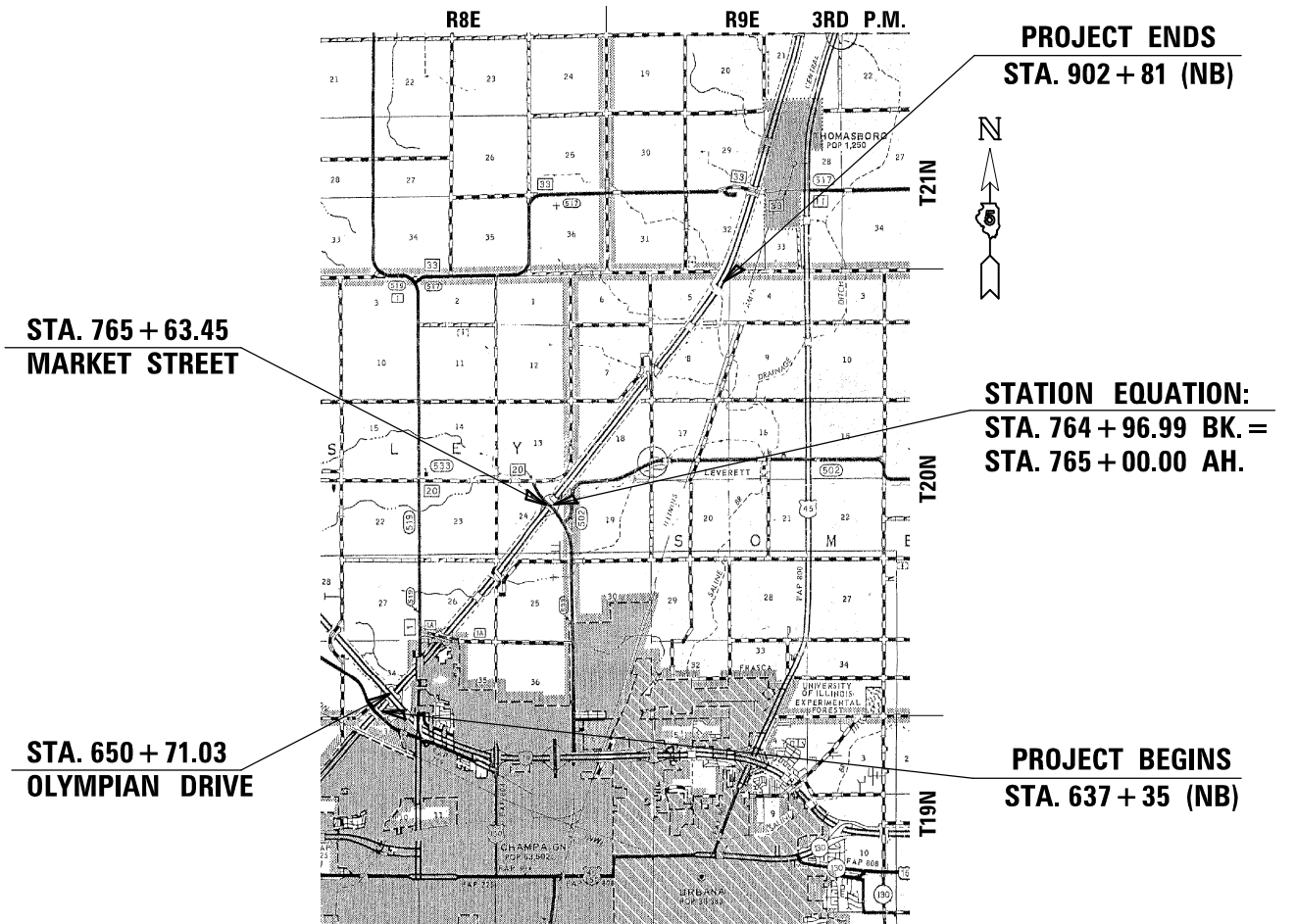

LOCATION MAP

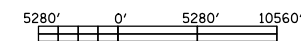

GROSS LENGTH = 26,542.99 FT. = 5.027 MILE  
 NET LENGTH = 26,542.99 FT. = 5.027 MILE

FILE NAME =	USER NAME = coombessf	DESIGNED -	REVISED -
p:\1\084EBID\INTEG.illinois.gov\PIWIDOT\Documents\IDOT Offices\District 5\Projects\057\DRAWING\Design\0570855-shr-plan.dgn		CHECKED -	REVISED -
\$MODELNAME\$	PLOT DATE = 1/15/2016	DATE -	REVISED -

**STATE OF ILLINOIS**  
**DEPARTMENT OF TRANSPORTATION**

**LOCATION MAPS FOR LOCATION #1**

SCALE: N/A SHEET 1 OF 1 SHEETS STA. TO STA.

F.A. RTE.	SECTION	COUNTY	TOTAL SHEETS	SHEET NO.
VAR.	.	**	20	4
*D5 CRACK & JOINT SEAL 2016-1			CONTRACT NO. 70B55	
ILLINOIS FED. AID PROJECT				

\*\*CHAMPAIGN & VERMILION

**LOCATION MAP FOR LOCATION #2**  
**F.A.P. 326 (IL 47) FROM THE FORD COUNTY LINE TO U.S. 136**  
**CHAMPAIGN COUNTY**

**ADT**

LOCATION 2: AVERAGE ADT = 3,500 (2015)

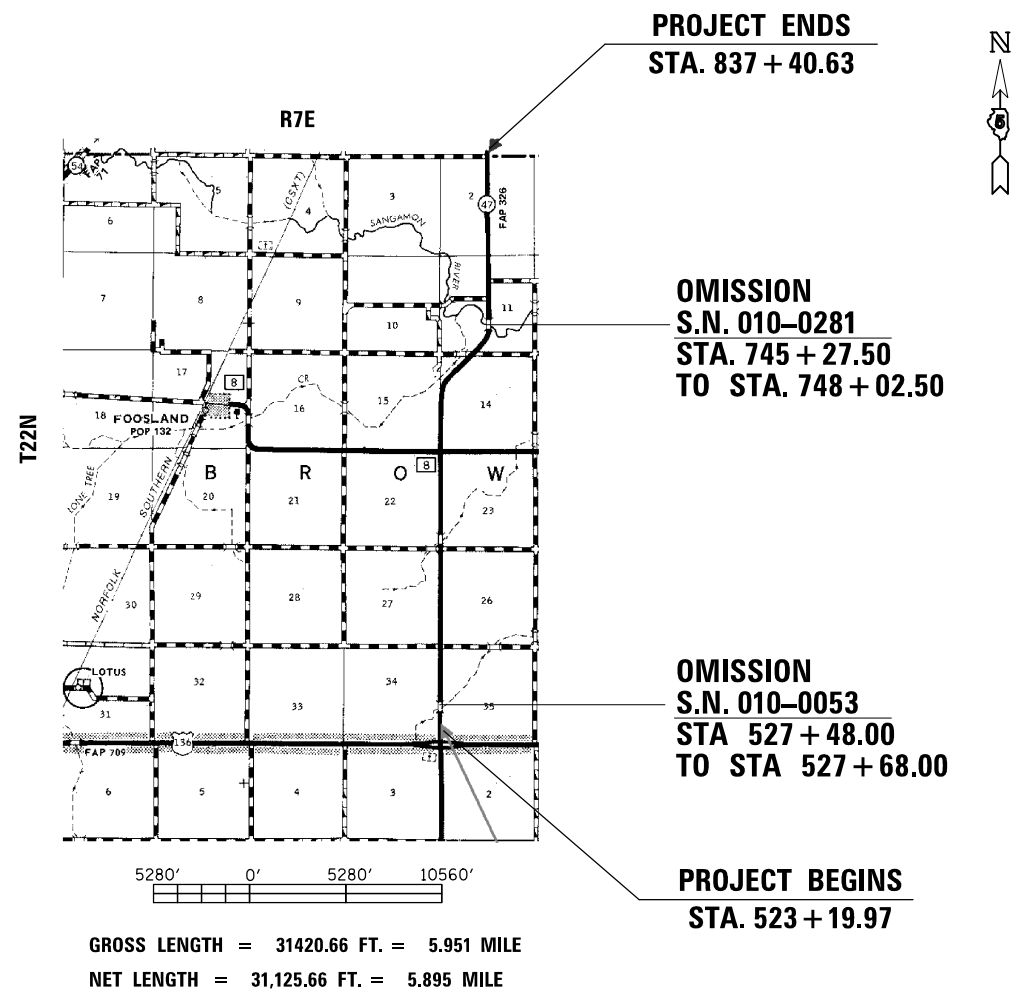

**LOCATION MAP FOR LOCATION #3**  
**F.A.P. 729 (U.S. 136 /MAIN ST.) FROM NATIONAL AVE. TO KANSAS AVE.**  
**VERMILION COUNTY**

**ADT**

LOCATION 3: AVERAGE ADT = 8,050 (2015)

\* STATIONS ARE IN METRIC AND REFLECT THE STATIONING USED FOR THE LAST CONSTRUCTION SECTION. ENGLISH STATIONING COULD NOT BE DETERMINED FOR THIS SECTION.

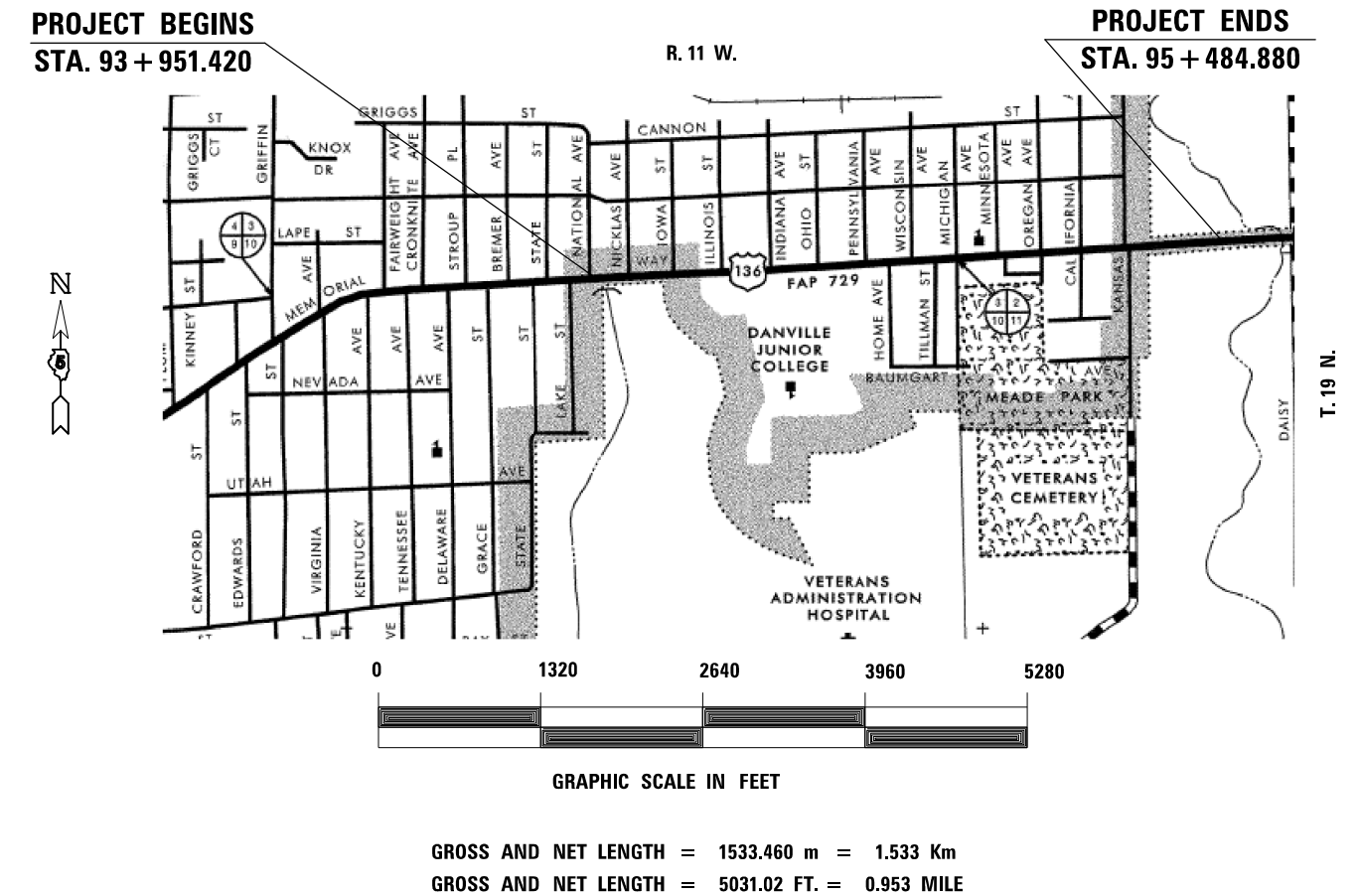

FILE NAME =	USER NAME = coombessf	DESIGNED -	REVISED -
p:\IL\084EBID\INTEG.illinois.gov\PI\DOT\Documents\DOT Offices\District 5\Projects\057\DRAWING\057\0855-sht-plan.dgn		CHECKED -	REVISED -
\$MODELNAME\$	PLOT DATE = 1/15/2016	DATE -	REVISED -

**STATE OF ILLINOIS**  
**DEPARTMENT OF TRANSPORTATION**

<b>LOCATION MAPS FOR LOCATIONS #2 &amp; #3</b>			
SCALE: N/A	SHEET 1	OF 1 SHEETS	STA. TO STA.

F.A. RTE.	SECTION	COUNTY	TOTAL SHEETS	SHEET NO.
VAR.	.	**	20	5
*05 CRACK & JOINT SEAL 2016-1			CONTRACT NO. 70B55	
ILLINOIS FED. AID PROJECT				

\*\*CHAMPAIGN & VERMILION

**LOCATION MAP FOR LOCATION #4**  
**F.A.P. 332 (IL 1/U.S. 150) FROM MAIN ST. IN DANVILLE TO 16TH ST. IN TILTON**  
**VERMILION COUNTY**

**ADT**

LOCATION 4: AVERAGE ADT = 21,550 (2015)

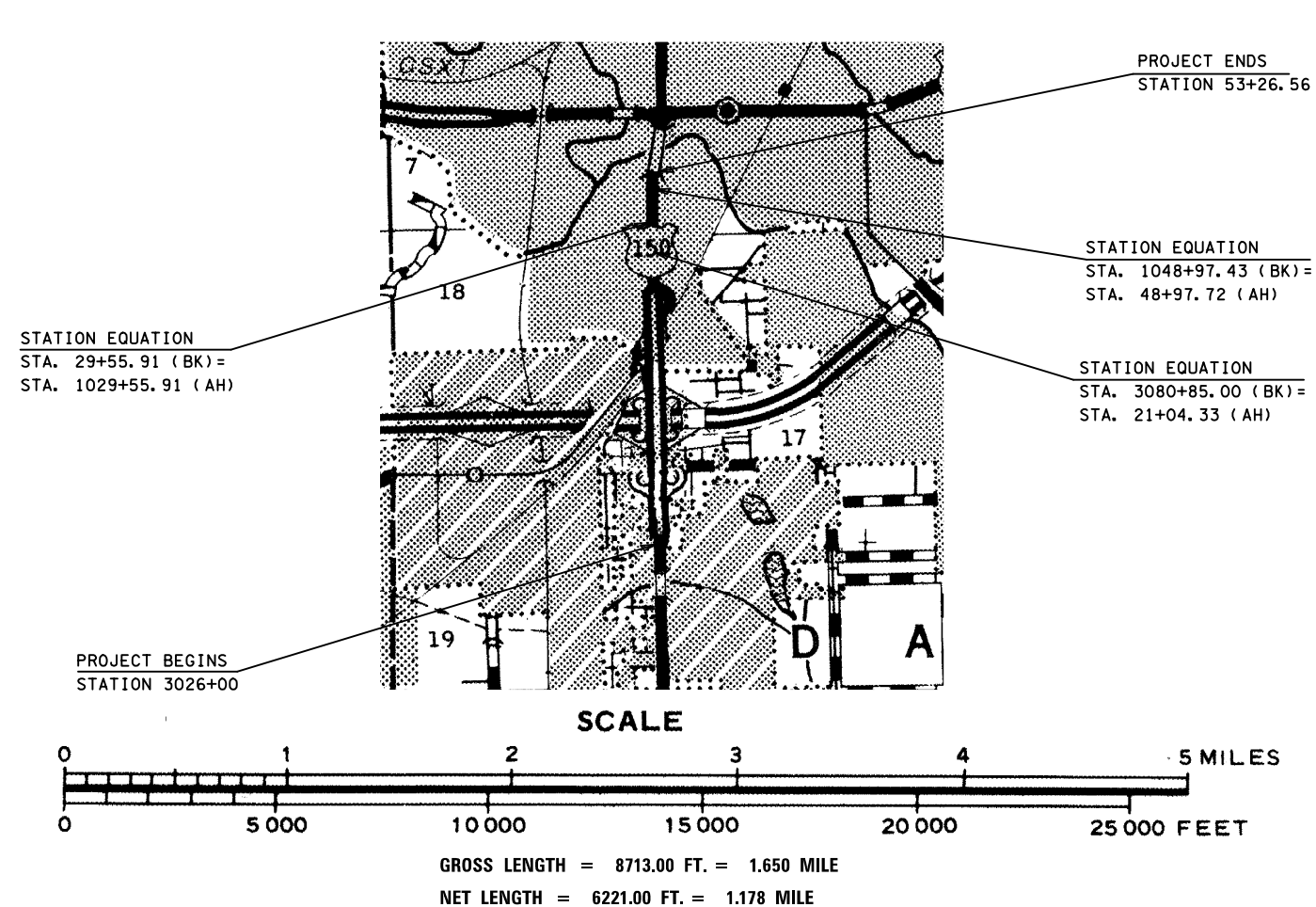

••CHAMPAIGN & VERMILION

FILE NAME =	USER NAME = coombessf	DESIGNED -	REVISED -	<b>STATE OF ILLINOIS DEPARTMENT OF TRANSPORTATION</b>	<b>LOCATION MAPS FOR LOCATIONS #2 &amp; #3</b>	F.A. RTE.	SECTION	COUNTY	TOTAL SHEETS	SHEET NO.		
p:\IL\084EBIDINTEG.illinois.gov\PI\DOT\Documents\DOT Offices\District 5\Projects\0579\DRAWING\Design\0579855-shr-plan.dgn						REVISED -	SCALE: N/A	SHEET 1	OF 1	SHEETS	STA.	TO STA.
PLOT SCALE = 40.0000' / in.						CHECKED -	REVISED -	VAR.	.	••	20	6
*MODELNAME*						DATE -	REVISED -	•D5 CRACK & JOINT SEAL 2016-1		CONTRACT NO. 70B55		
PLOT DATE = 1/15/2016				DATE -	REVISED -	ILLINOIS FED. AID PROJECT						

## SUMMARY OF QUANTITIES

LOCATION OF WORK	LOCATION	LOCATION	LOCATION	LOCATION
	#1	#2	#3	#4
COUNTY	CHAMPAIGN	CHAMPAIGN	VERMILION	VERMILION
	F.A.I. 57 (I-57)	F.A.P. 326 (IL 47)	F.A.P. 729 (U.S. 136)	F.A.P. 332 (U.S. 150/ IL 1)
FUNDING BREAKOUT	RURAL 100% STATE	RURAL 100% STATE	URBAN 100% STATE	URBAN 100% STATE
CONSTRUCTION CODE	0005	0005	0005	0005

CODE NO	ITEM DESCRIPTION	UNIT	TOTAL				
45100200	CRACK FILLING	POUND	52,932.0	36,174.0	6,284.0	2,953.0	7,521.0
67100100	MOBILIZATION	L SUM	1.0	0.4	0.2	0.2	0.2
70100420	TRAFFIC CONTROL AND PROTECTION, STANDARD 701411	EACH	20.0	8.0			12.0
70100460	TRAFFIC CONTROL AND PROTECTION, STANDARD 701306	L SUM	1.0		1.0		
70100700	TRAFFIC CONTROL AND PROTECTION, STANDARD 701406	L SUM	1.0	1.0			
70100825	TRAFFIC CONTROL AND PROTECTION, STANDARD 701456	L SUM	1.0	1.0			
70102625	TRAFFIC CONTROL AND PROTECTION, STANDARD 701606	L SUM	1.0				1.0
70102632	TRAFFIC CONTROL AND PROTECTION, STANDARD 701602	L SUM	1.0			0.5	0.5
70102635	TRAFFIC CONTROL AND PROTECTION, STANDARD 701701	L SUM	1.0			0.5	0.5
X7010410	SPEED DISPLAY TRAILER	CAL MO	1.0	1.0			
X7015005	CHANGEABLE MESSAGE SIGN	CAL DA	6.0	6.0			
*DENOTES SPECIALTY ITEM							

\*\*CHAMPAIGN & VERMILION

FILE NAME =	USER NAME = coombesef	DESIGNED -	REVISED -	<b>STATE OF ILLINOIS DEPARTMENT OF TRANSPORTATION</b>	<b>SUMMARY OF QUANTITIES</b>	F.A. RTE.	SECTION	COUNTY	TOTAL SHEETS	SHEET NO.
pu\11\084EBIDINTEG\Illinois.gov\1001\02	umanta\DOT Offices\District 5\Projects\057	DRAM\057\057\057\057\057\057\057\057	REVISOR -						20	7
	PLOT SCALE = 40.0000 / 1 in.	CHECKED -	REVISED -							
#MODELNAME*	PLOT DATE = 1/25/2016	DATE -	REVISED -		SCALE: N/A	SHEET 1	OF 1	SHEETS STA.	TO STA.	
						*DS CRACK & JOINT SEAL 2016-1		CONTRACT NO. 70B55		
						ILLINOIS FED. AID PROJECT				

# ① LOCATION #1 EXISTING TYPICAL CROSS SECTIONS

FAI ROUTE 57  
SOUTHBOUND LANES  
STATION 637+35 TO STATION 645+05  
STATION 655+75 TO STATION 703+95  
STATION 713+90 TO STATION 918+57

STATION EQUATION:  
STA. 764+96.99 BK =  
STA. 765+00.00 AH

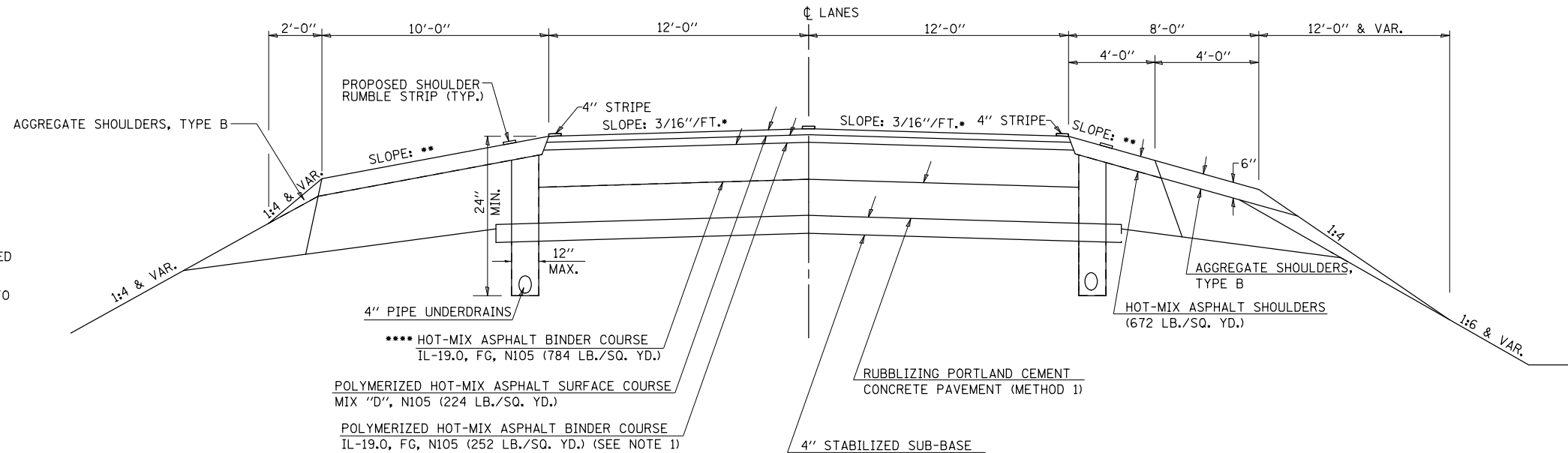

- 3/16"/FT. CROSS SLOPE TO BE ACHIEVED WITH HOT-MIX ASPHALT BINDER COURSE
- MATCH EXISTING SHOULDER SLOPE UP TO 6% MAX.
- LIFT THICKNESS - MINIMUM 2 1/4" MAXIMUM 4 1/2"
- (672 LB./SQ YD.) STA. 764+00 TO STA. 767+00  
(672 LB./SQ YD.) STA. 875+60 TO STA. 878+00

# ② LOCATION #1 EXISTING TYPICAL CROSS SECTIONS

FAI ROUTE 57  
SOUTHBOUND LANES  
STATION 645+05 TO STATION 655+75 - S.N. 010-0254  
STATION 703+95 TO STATION 713+90 - S.N. 010-0171

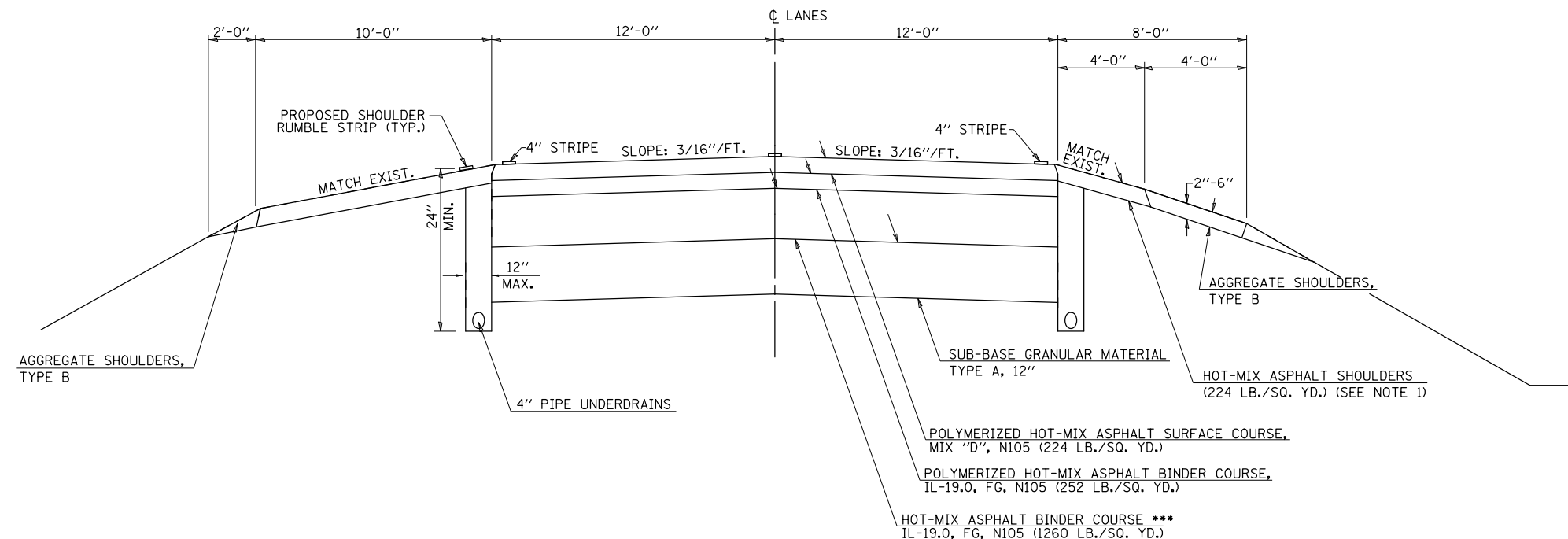

FILE NAME =	USER NAME = coombessf	DESIGNED -	REVISED -	<b>STATE OF ILLINOIS DEPARTMENT OF TRANSPORTATION</b>	<b>LOCATION #1 EXISTING TYPICAL CROSS SECTIONS</b>			F.A. RTE.	SECTION	COUNTY	TOTAL SHEETS	SHEET NO.	
pw:\IL\084EBIDINTEG.illinois.gov\PIWIDOT\Documents\IDOT Offices\District 5\Projects\057\Drawings\Design\0570855-sh1-plan.dgn		REVISIONS	REVISIONS		SCALE:	SHEET NO. 1 OF 5 SHEETS	STA.	TO STA.	VAR.			20	8
		CHECKED -	REVISIONS						•D5 CRACK & JOINT SEAL 2016-1				CONTRACT NO. 70B55
		DATE -	REVISIONS										ILLINOIS FED. AID PROJECT

••CHAMPAIGN & VERMILION





# ⑤ LOCATION #1 EXISTING TYPICAL CROSS SECTIONS

MARKET STREET  
 STATION 136+85.00 TO STATION 141+86.20 (APPROACH)  
 STATION 144+70.21 (APPROACH) TO STATION 149+62.00

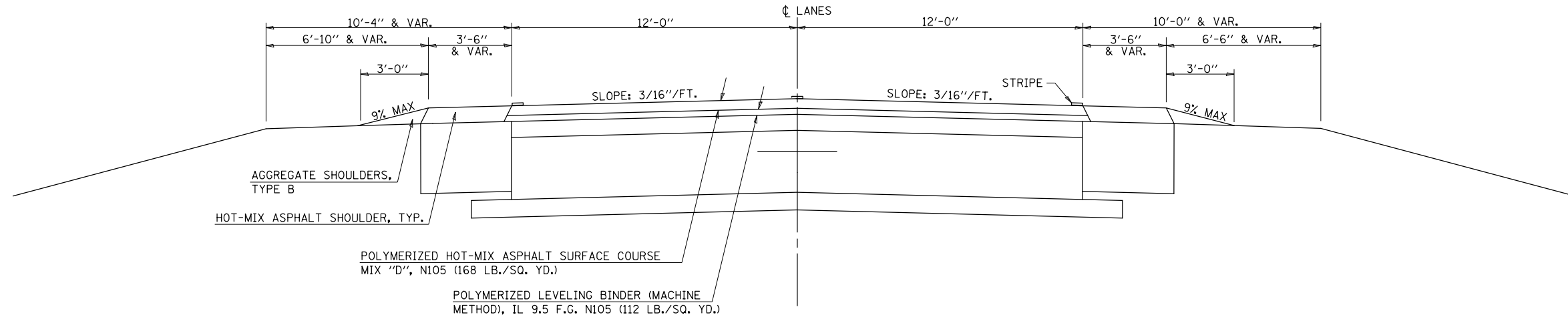

# ①R LOCATION #1 EXISTING TYPICAL CROSS SECTIONS

RAMPS AT MARKET STREET AND FAI 57  
 RAMP A STATION 307+69.00 TO STATION 317+57.00  
 RAMP B STATION 320+15.00 TO STATION 331+48.00  
 RAMP C STATION 368+21.42 TO STATION 376+09.00  
 RAMP D STATION 380+14.00 TO STATION 387+33.50

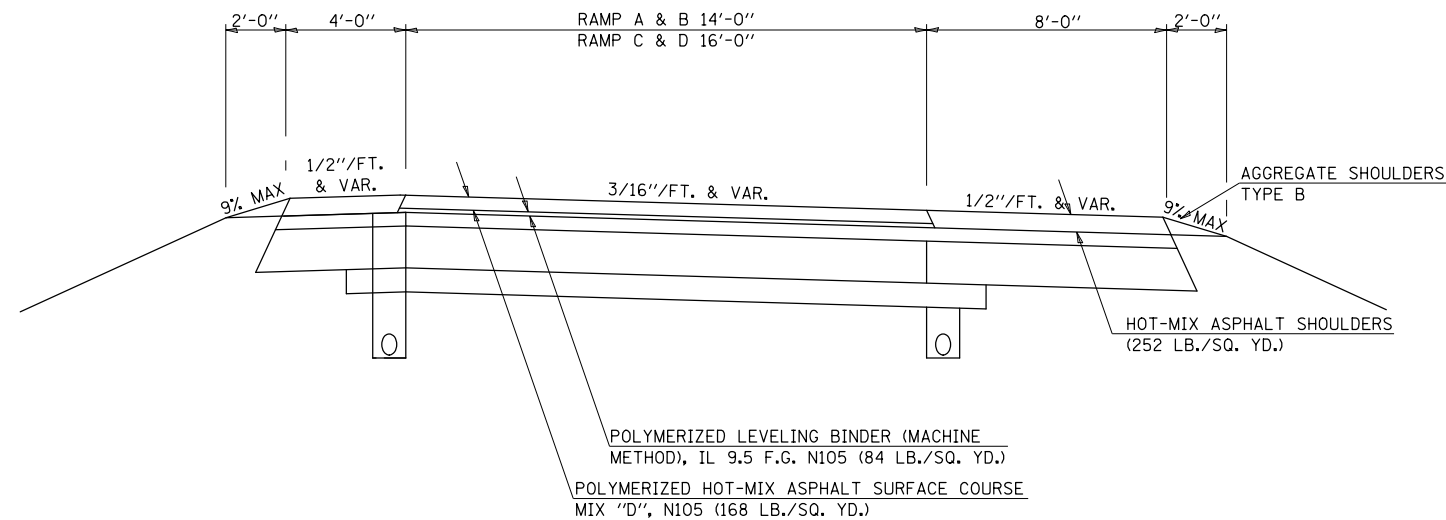

••CHAMPAIGN & VERMILION

FILE NAME =	USER NAME = coombessf	DESIGNED -	REVISED -	<b>STATE OF ILLINOIS DEPARTMENT OF TRANSPORTATION</b>	<b>LOCATION #1 EXISTING TYPICAL CROSS SECTIONS</b>			F.A. RTE.	SECTION	COUNTY	TOTAL SHEETS	SHEET NO.
p:\ill084EBIDINTEG.illinois.gov\PIDOT\Documents\IDOT Offices\District 5\Projects\057\DRAWING\Design\0570855-shr-plan.dgn	DESIGNED -	REVISED -	REVISED -					VAR.	.	••	20	10
PLOT SCALE = 40.0000' / in.	CHECKED -	REVISED -	REVISED -		•D5 CRACK & JOINT SEAL 2016-1			CONTRACT NO. 70B55				
PLOT DATE = 1/15/2016	DATE -	REVISED -	REVISED -		SCALE:	SHEET NO. 5 OF 5 SHEETS	STA.	TO STA.	ILLINOIS FED. AID PROJECT			

# 2R LOCATION #1 EXISTING TYPICAL CROSS SECTIONS

RAMPS AT OLYMPIAN DRIVE AND FAI 57  
 RAMP A STATION 10+36.00 TO STATION 15+00.00  
 RAMP B STATION 13+79.00 TO STATION 24+91.00  
 RAMP C STATION 21+65.00 TO STATION 27+49.00  
 RAMP D STATION 10+41.00 TO STATION 22+05.00

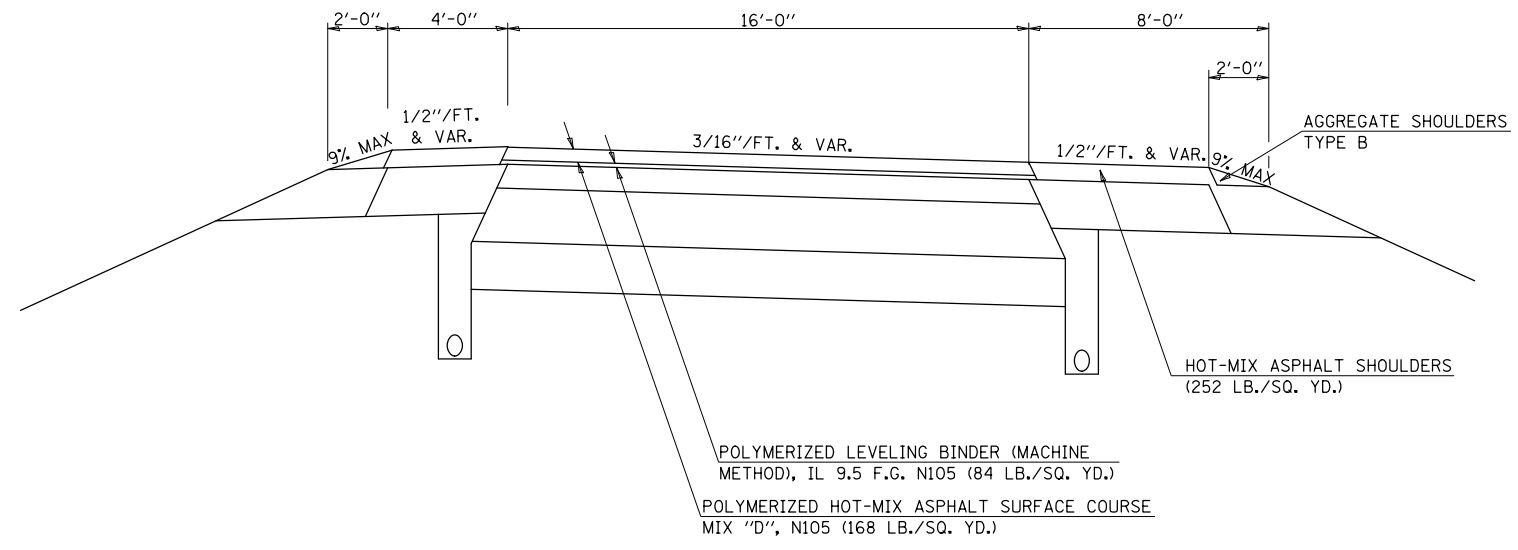

\*\*CHAMPAIGN & VERMILION

FILE NAME =	USER NAME = coombessf	DESIGNED -	REVISED -	<b>STATE OF ILLINOIS DEPARTMENT OF TRANSPORTATION</b>	<b>LOCATION #1 EXISTING TYPICAL CROSS SECTIONS</b>	F.A. RTE.	SECTION	COUNTY	TOTAL SHEETS	SHEET NO.
pw:\IL\084EBIDINTEG.illinois.gov\PIWIDOT\Documents\IDOT Offices\District 5\Projects\0570855\Drawings\Design\0570855-shr-plan.dgn		DRAWN	REVISED -						20	11
	PLOT SCALE = 40.0000' / in.	CHECKED -	REVISED -		SCALE:	SHEET NO. 4 OF 5 SHEETS	STA.	TO STA.	*D5 CRACK & JOINT SEAL 2016-1 CONTRACT NO. 70B55 ILLINOIS FED. AID PROJECT	
	PLOT DATE = 1/15/2016	DATE -	REVISED -							

# ① LOCATION #2 EXISTING TYPICAL CROSS SECTIONS

STATION	TO	STATION
523+19.97		527+48.00 *
* 527+68.00		696+50.30 ②
② 708+42.90		732+38.09 ②
① 744+34.90		745+27.50 *
* 748+02.50		774+32.30 ③

\* BRIDGE OMISSION  
 S. N. 010-0053 STA. 527+48.00 - STA. 527+68.00  
 S. N. 010-0281 STA. 745+27.50 - STA. 748+02.50

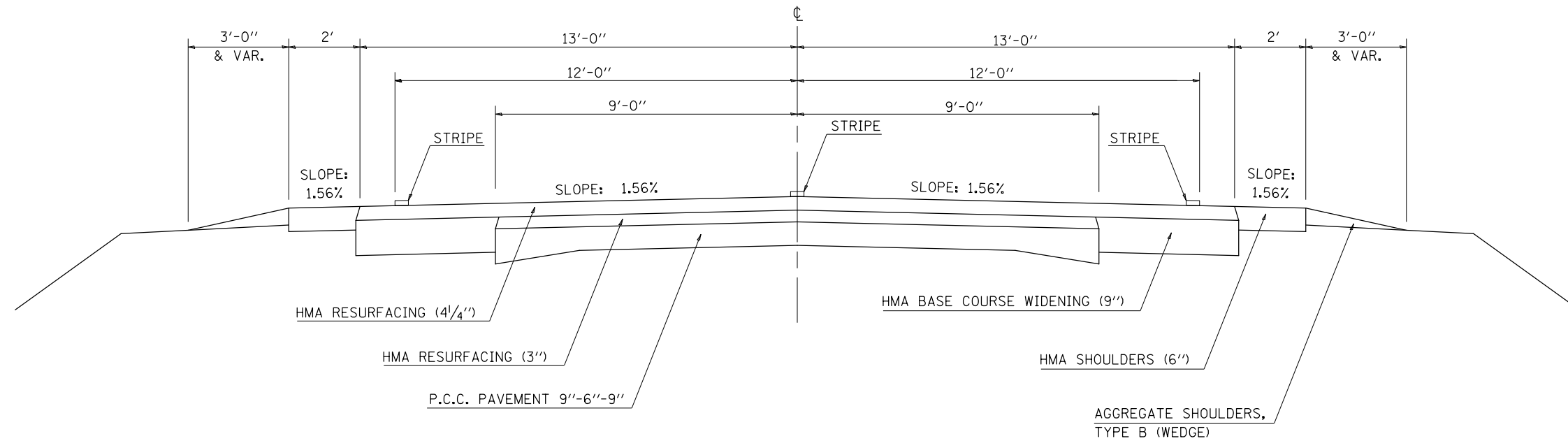

# ② LOCATION #2 EXISTING TYPICAL CROSS SECTIONS

STATION	TO	STATION
① 696+50.30		708+42.90 ①
① 732+38.09		744+34.90 ①

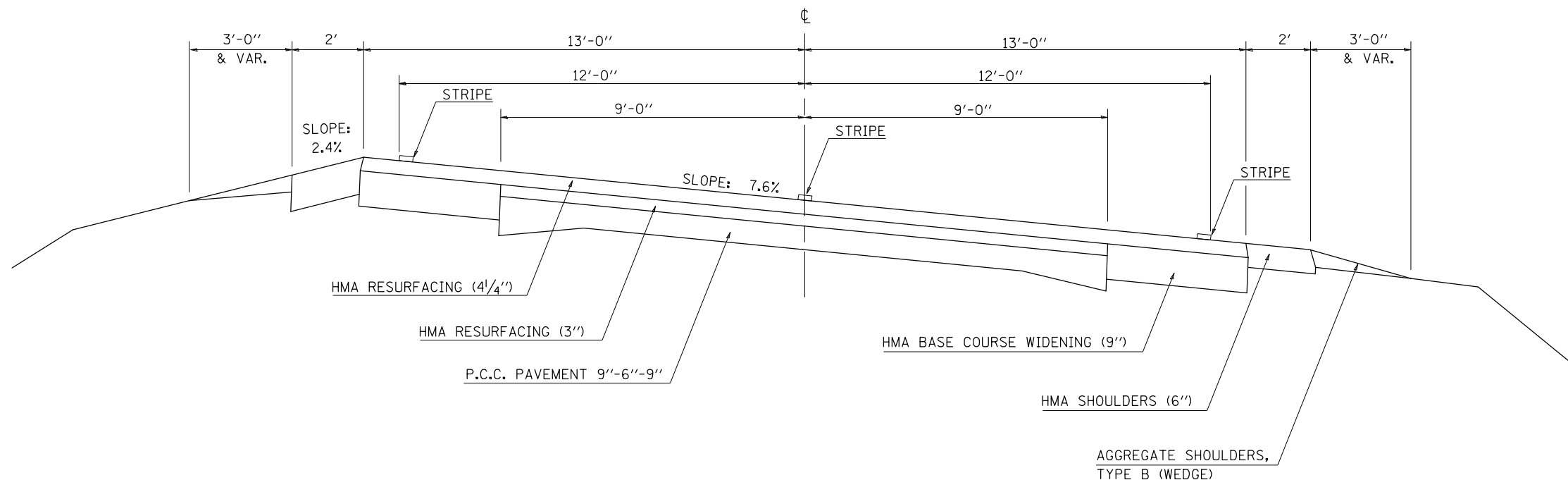

••CHAMPAIGN & VERMILION

### ③ LOCATION #2 EXISTING TYPICAL CROSS SECTIONS

STATION TO STATION  
 ① 774+32.30 837+40.63

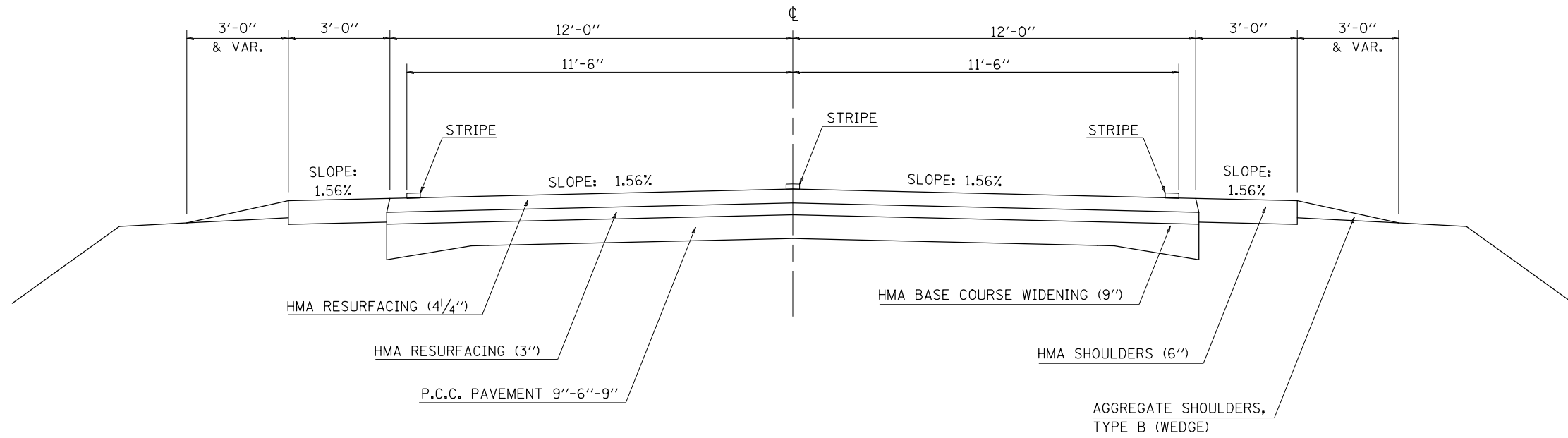

••CHAMPAIGN & VERMILION

FILE NAME =	USER NAME = coombessf	DESIGNED -	REVISED -
p:\11\084EBIDINTEG.illinois.gov\PI\DOT\Documents\DOT Offices\District 5\Projects\057	DESIGNED -	REVISED -	REVISED -
	PLOT SCALE = 40.0000' / in.	CHECKED -	REVISED -
	PLOT DATE = 1/15/2016	DATE -	REVISED -

STATE OF ILLINOIS  
 DEPARTMENT OF TRANSPORTATION

LOCATION #2 EXISTING TYPICAL CROSS SECTIONS

SCALE: SHEET NO. 4 OF 5 SHEETS STA. TO STA.

F.A. RTE.	SECTION	COUNTY	TOTAL SHEETS	SHEET NO.
VAR.	•	••	20	13
•D5 CRACK & JOINT SEAL 2016-1			CONTRACT NO. 70B55	
ILLINOIS FED. AID PROJECT				

# ① LOCATION #3 EXISTING TYPICAL CROSS SECTIONS

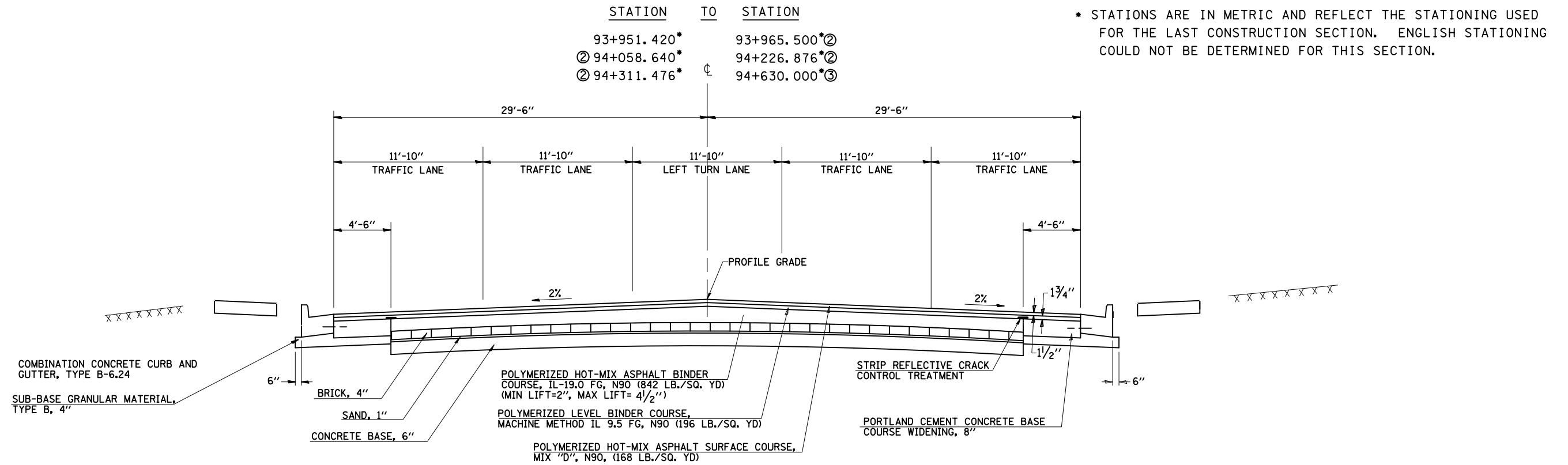

# ② LOCATION #3 EXISTING TYPICAL CROSS SECTIONS

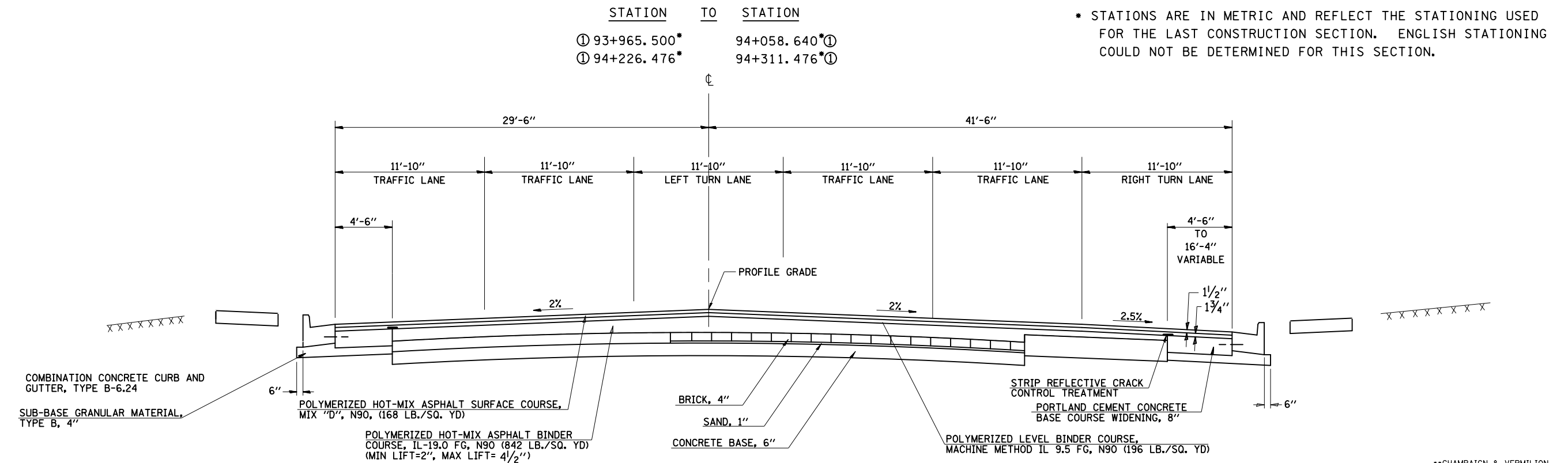

### ③ LOCATION #3 EXISTING TYPICAL CROSS SECTIONS

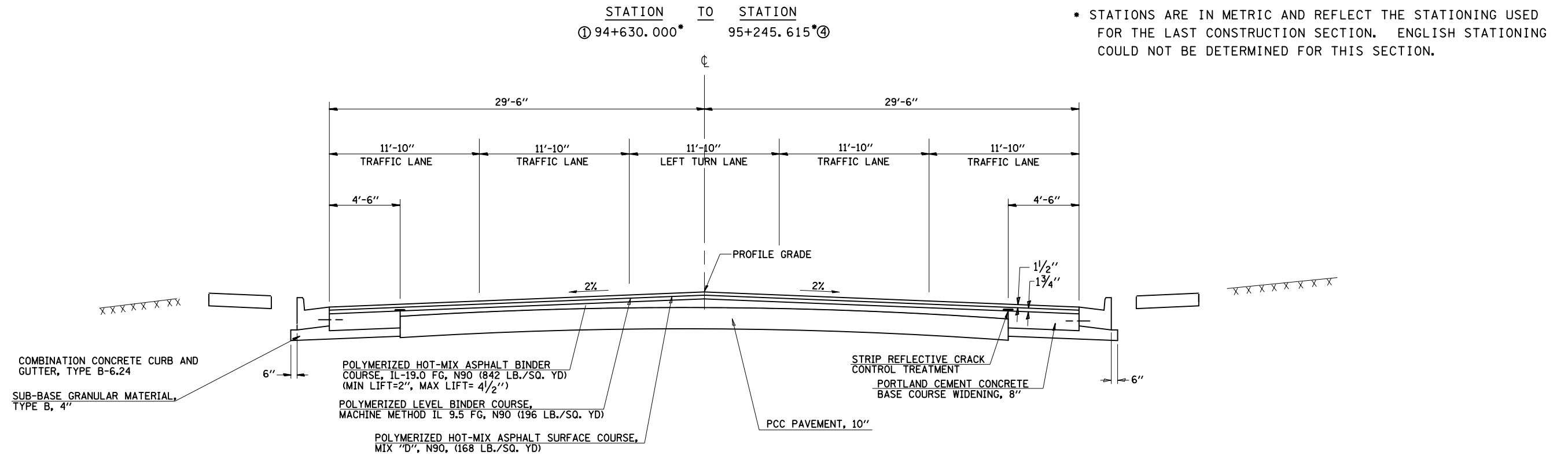

### ④ LOCATION #3 EXISTING TYPICAL CROSS SECTIONS

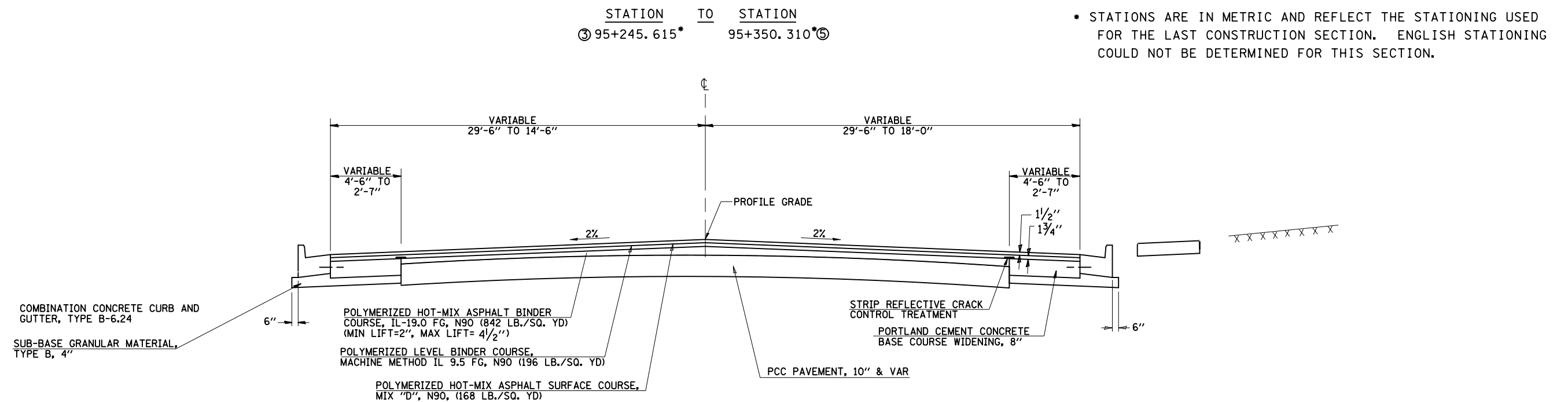

FILE NAME =	USER NAME = coombessf	DESIGNED -	REVISED -	<b>STATE OF ILLINOIS DEPARTMENT OF TRANSPORTATION</b>	<b>LOCATION #3 EXISTING TYPICAL CROSS SECTIONS</b>	F.A. RTE.	SECTION	COUNTY	TOTAL SHEETS	SHEET NO.
pw\1\084EBIDINTEG.illinois.gov\PIWIDOT\Documents\IDOT Offices\District 5\Projects\0579\BROWND\Design\0579855-shr-plan.dgn						VAR.	.	..	20	15
PLOT SCALE = 40.0000' / in.	CHECKED -	REVISIED -	REVISIED -		SCALE:	SHEET NO. 4 OF 5 SHEETS		STA.	TO STA.	
PLOT DATE = 1/15/2016	DATE -	REVISIED -	REVISIED -						CONTRACT NO. 70B55	
ILLINOIS FED. AID PROJECT										

••CHAMPAIGN & VERMILION

# ⑤ LOCATION #3 EXISTING TYPICAL CROSS SECTIONS

STATION TO STATION  
 ④ 95+350.310\* 95+474.072\*

\* STATIONS ARE IN METRIC AND REFLECT THE STATIONING USED FOR THE LAST CONSTRUCTION SECTION. ENGLISH STATIONING COULD NOT BE DETERMINED FOR THIS SECTION.

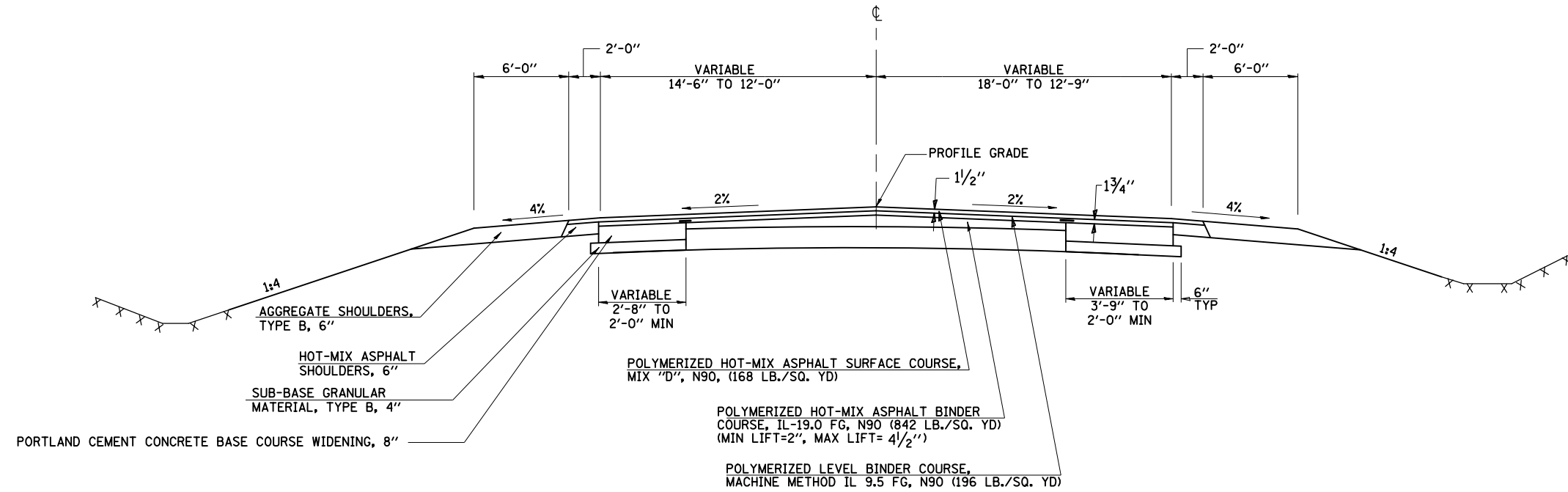

••CHAMPAIGN & VERMILION

FILE NAME =	USER NAME = coombessf	DESIGNED -	REVISED -
p:\11\084EBIDINTEG.illinois.gov\PIWIDOT\Documents\IDOT Offices\District 5\Projects\057		DRAWN	REVISED -
		CHECKED -	REVISED -
		DATE -	REVISED -

**STATE OF ILLINOIS  
 DEPARTMENT OF TRANSPORTATION**

**LOCATION #3 EXISTING TYPICAL CROSS SECTIONS**

SCALE: SHEET NO. 4 OF 5 SHEETS STA. TO STA.

F.A. RTE.	SECTION	COUNTY	TOTAL SHEETS	SHEET NO.
		••	20	16
•D5 CRACK & JOINT SEAL 2016-1			CONTRACT NO. 70B55	
ILLINOIS FED. AID PROJECT				



# ① LOCATION #4 EXISTING TYPICAL CROSS SECTIONS

STATION TO STATION  
3026+00.00 TO 3029+60.00 ②

① STA. 3026+00 TO STA. 3027+82  
4' AUXILLARY LANE

③ STA. 3026+00 TO STA. 3028+95  
4' AUXILLARY LANE

② STA. 3028+38 TO STA. 3029+00  
12' AUXILLARY LANE

④ STA. 3029+51 TO STA. 3029+60  
12' AUXILLARY LANE

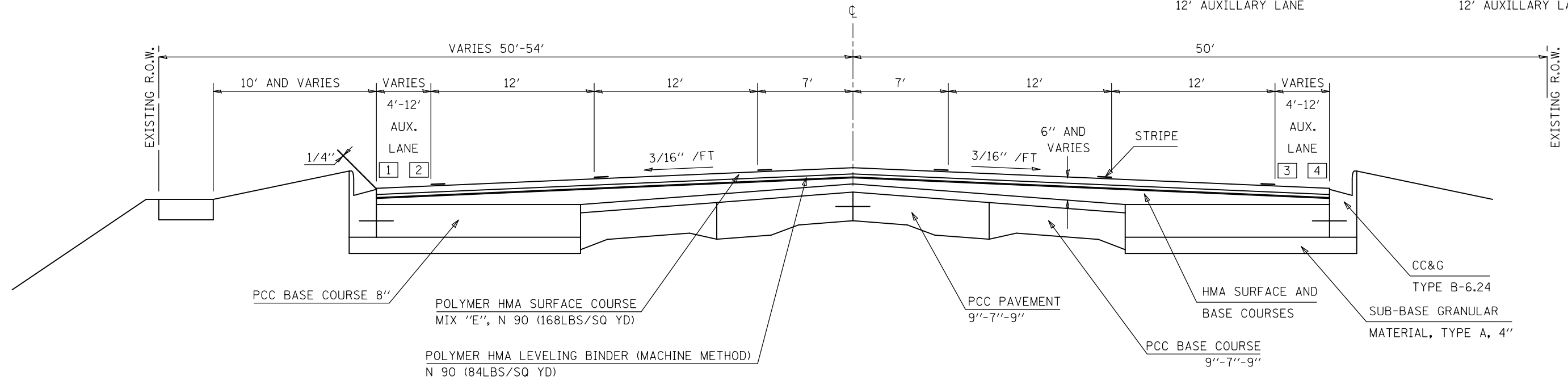

# ② LOCATION #4 EXISTING TYPICAL CROSS SECTIONS

STATION TO STATION  
① 3029+60.00 TO 3061+50.00 ③

⑤ STA. 3029+60 TO STA. 3031+65  
12' AUXILLARY LANE

⑦ STA. 3040+81 TO STA. 3041+70  
STA. 3051+80 TO STA. 3052+85  
STA. 3056+36 TO STA. 3056+97  
6' AUXILLARY LANE

⑨ STA. 3030+75 TO STA. 3033+57  
STA. 3034+74 TO STA. 3038+84  
STA. 3048+82 TO STA. 3051+70  
0' AUXILLARY LANE

⑥ STA. 3036+81 TO STA. 3039+14  
STA. 3046+70 TO STA. 3048+72  
STA. 3057+54 TO STA. 3059+36  
0' AUXILLARY LANE

⑧ STA. 3029+60 TO STA. 3030+12  
12' AUXILLARY LANE

⑩ STA. 3043+71 TO STA. 3044+65  
STA. 3056+36 TO STA. 3057+18  
16' AUXILLARY LANE

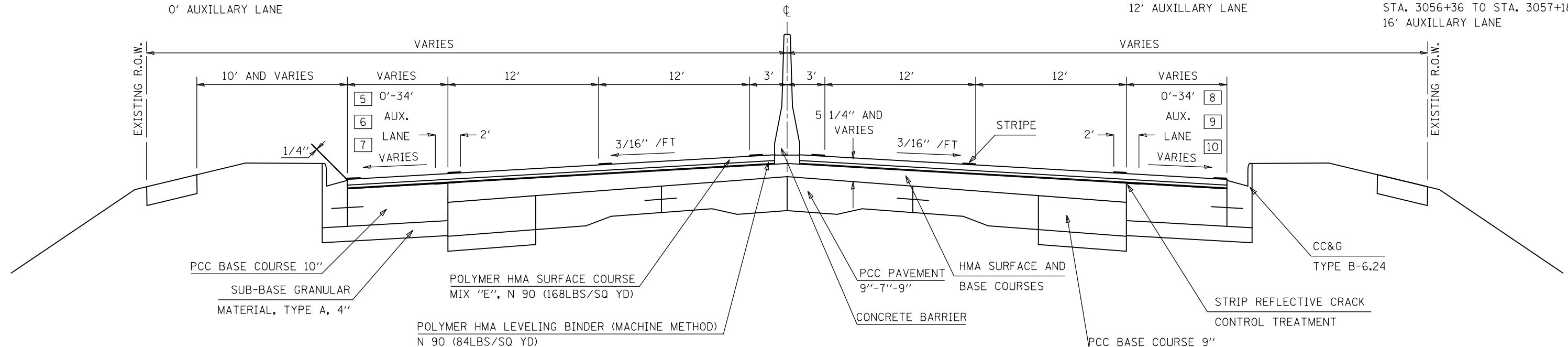

••CHAMPAIGN & VERMILION

FILE NAME =	USER NAME = coombessf	DESIGNED -	REVISED -
p:\11\084EBID\INTEG.illinois.gov\PIWIDOT\Documents\IDOT Offices\District 5\Projects\0579\Drawings\Design\0579855-sh1-plan.dgn		REVISIONS	
PLOT SCALE = 40.0000' / in.	CHECKED -	REVISED -	
PLOT DATE = 1/15/2016	DATE -	REVISED -	

STATE OF ILLINOIS  
DEPARTMENT OF TRANSPORTATION

LOCATION #4 EXISTING TYPICAL CROSS SECTIONS

SCALE: SHEET NO. 4 OF 5 SHEETS STA. TO STA.

F.A. RTE.	SECTION	COUNTY	TOTAL SHEETS	SHEET NO.
			20	17
•D5 CRACK & JOINT SEAL 2016-1			CONTRACT NO. 70B55	
ILLINOIS FED. AID PROJECT				

### ③ LOCATION #4 EXISTING TYPICAL CROSS SECTIONS

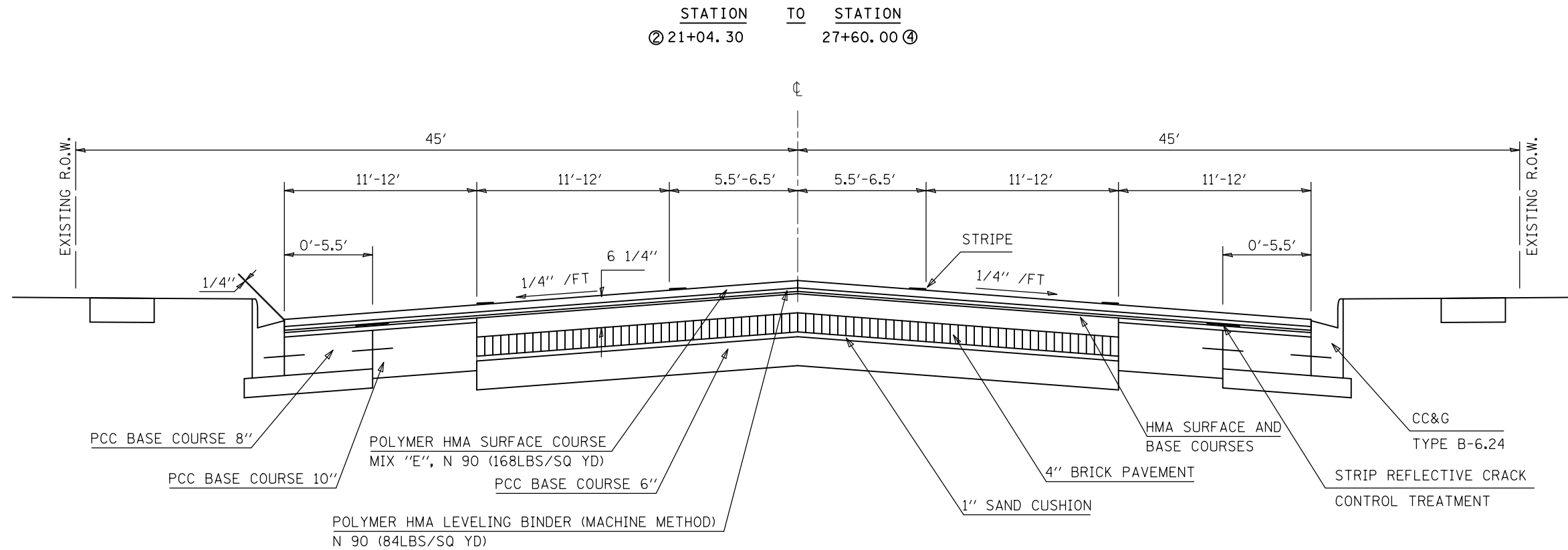

### ④ LOCATION #4 EXISTING TYPICAL CROSS SECTIONS

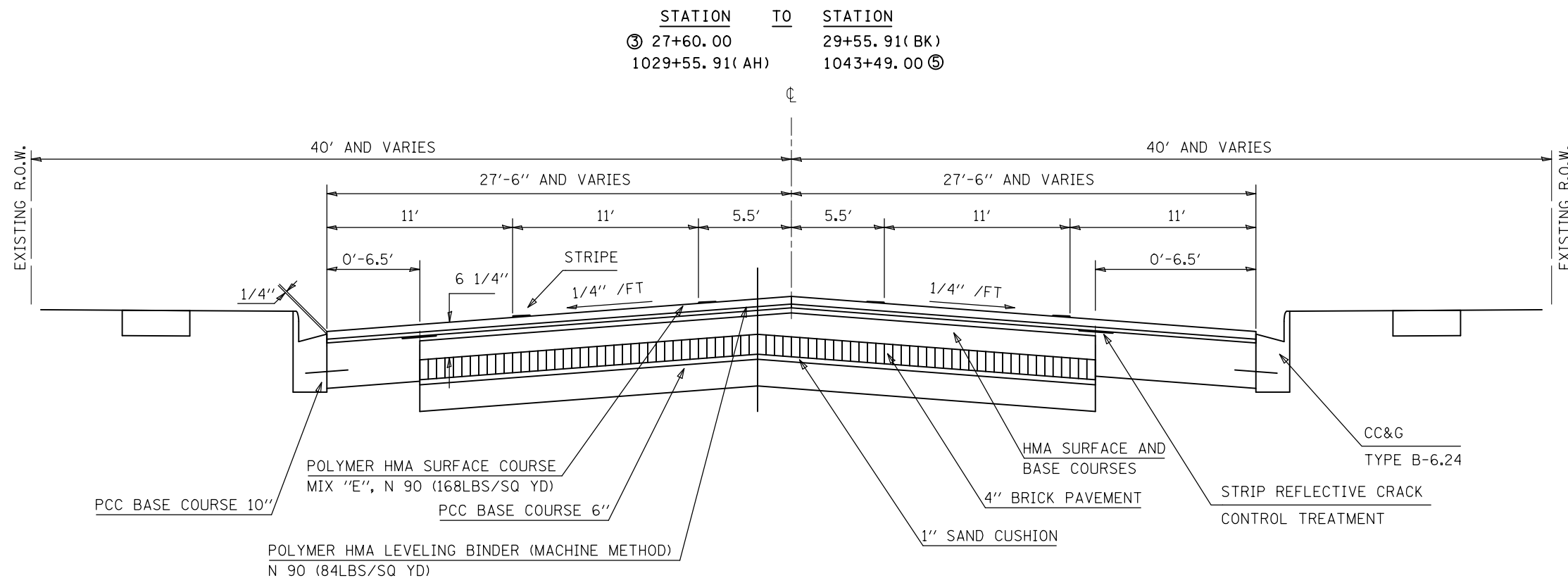

FILE NAME =	USER NAME = coombessf	DESIGNED -	REVISED -	<b>STATE OF ILLINOIS DEPARTMENT OF TRANSPORTATION</b>	<b>LOCATION #4 EXISTING TYPICAL CROSS SECTIONS</b>	F.A. RTE.	SECTION	COUNTY	TOTAL SHEETS	SHEET NO.
pw:\IL\084EBIDINTEG.illinois.gov\PWIDOT\Documents\IDOT Offices\District 5\Projects\057\DRAWING\Design\0570855-shr-plan.dgn									20	18
PLOT SCALE = 40.0000' / in.	CHECKED -	REVISOR -	DATE -		SCALE:	SHEET NO. 4 OF 5 SHEETS	STA.	TO STA.	CONTRACT NO. 70B55	
PLOT DATE = 1/15/2016									ILLINOIS FED. AID PROJECT	

••CHAMPAIGN & VERMILION

# ⑤ LOCATION #4 EXISTING TYPICAL CROSS SECTIONS

STATION TO STATION  
 ④ 1043+49.00 1048+97.43 (BK)  
 48+97.72 (AH) 53+26.56

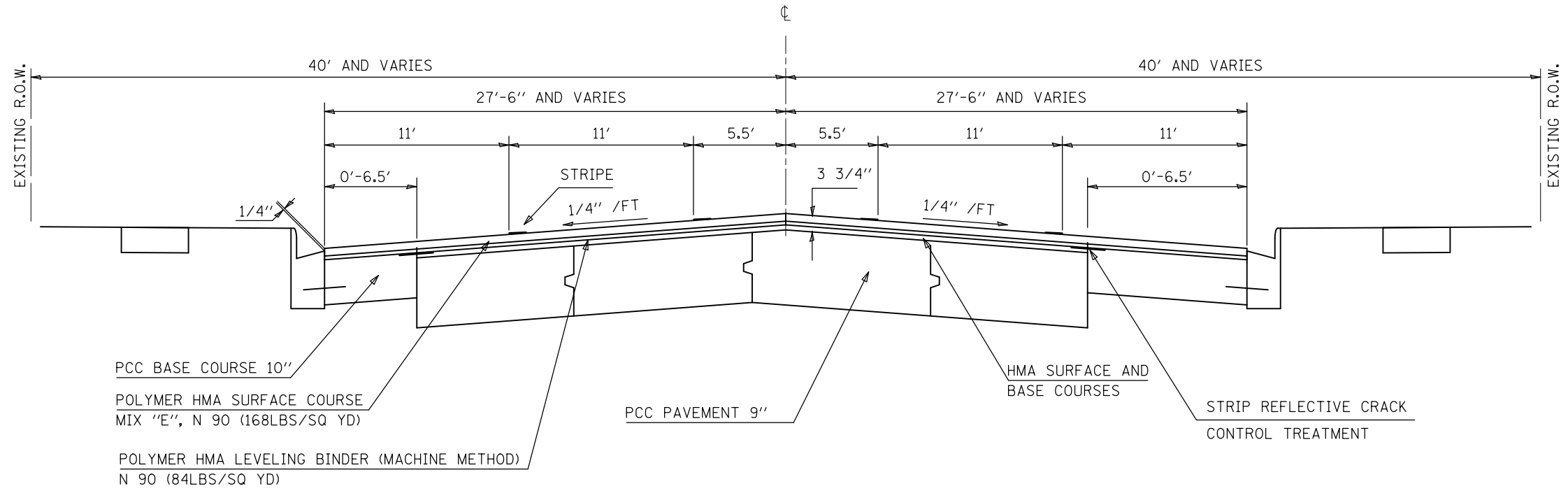

••CHAMPAIGN & VERMILION

FILE NAME =	USER NAME = coombessf	DESIGNED -	REVISED -	<b>STATE OF ILLINOIS DEPARTMENT OF TRANSPORTATION</b>	<b>LOCATION #4 EXISTING TYPICAL CROSS SECTIONS</b>	F.A. RTE.	SECTION	COUNTY	TOTAL SHEETS	SHEET NO.
pw:\IL\084EBIDINTEG.illinois.gov\PIWIDOT\Documents\DOT Offices\District 5\Projects\0570855\Drawings\Design\0570855-sh1-plan.dgn	DESIGNED -	REVISED -	REVISED -			VAR.	.	••	20	19
PLOT SCALE = 40.0000' / in.	CHECKED -	REVISED -	REVISED -			•D5 CRACK & JOINT SEAL 2016-1		CONTRACT NO. 70B55		
PLOT DATE = 1/15/2016	DATE -	REVISED -	REVISED -			SCALE:	SHEET NO. 4 OF 5 SHEETS	STA.	TO STA.	ILLINOIS FED. AID PROJECT

### HMA PAVEMENT

(USE PAY ITEMS : 45100100 CRACK ROUTING (PAVEMENT)  
AND 45100200 CRACK FILLING)

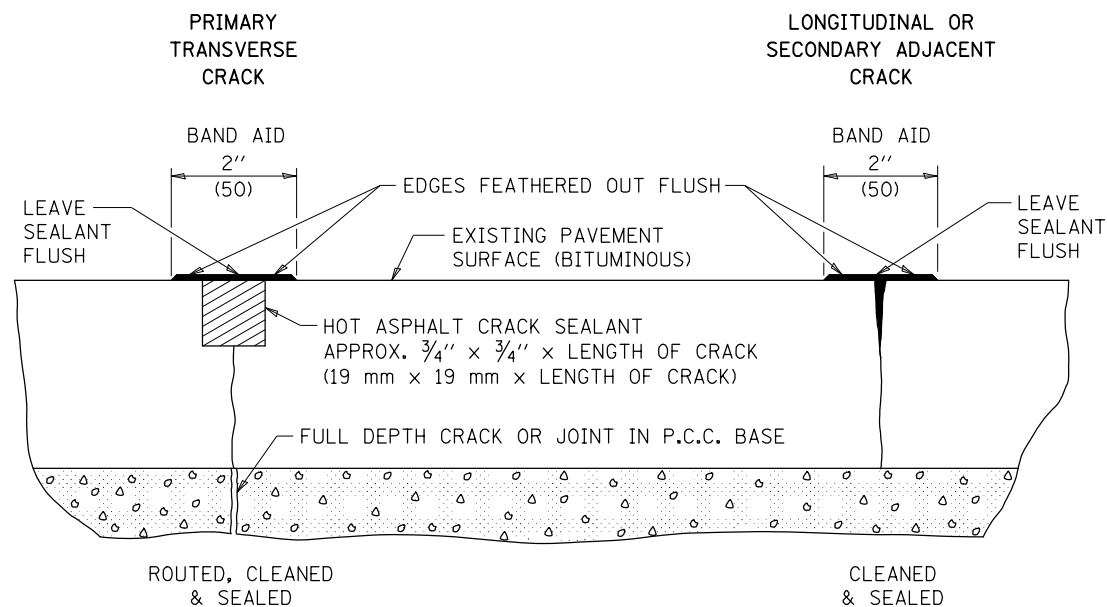

### PCC PAVEMENT

(USE PAY ITEMS : 45200100 JOINT OR CRACK ROUTING (P.C.C. PAVEMENT & SHOULDER)  
AND 45200300 JOINT OR CRACK FILLING)

#### TRANSVERSE CRACKS AND JOINTS AND CENTERLINE JOINT

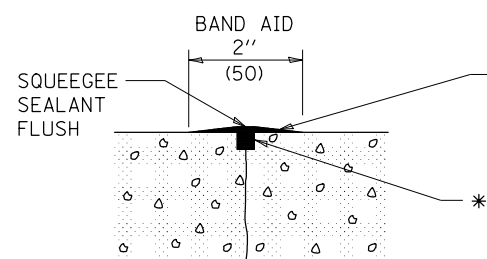

#### LONGITUDINAL SHOULDER JOINT

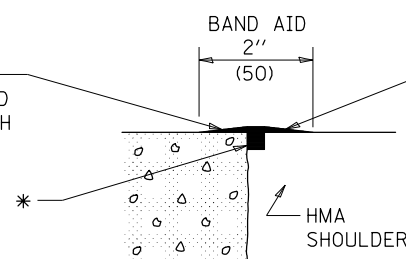

#### ANY WIDE LONGITUDINAL JOINT OR CRACK

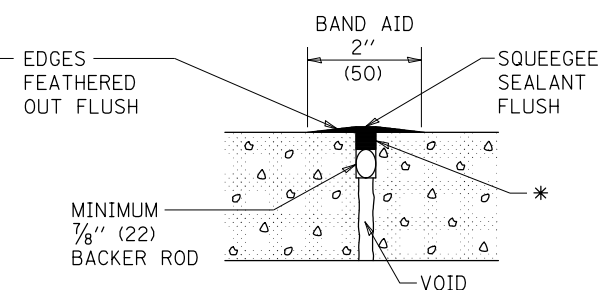

\* HOT ASPHALT CRACK SEALANT  
APPROX. 3/4 \" x 3/4 \" x LENGTH OF CRACK.  
ACTUAL QUANTITY WILL VARY AS NEEDED FOR  
PRIMARY OR SECONDARY WORKING CRACK.

#### LONGITUDINAL RANDOM CRACK

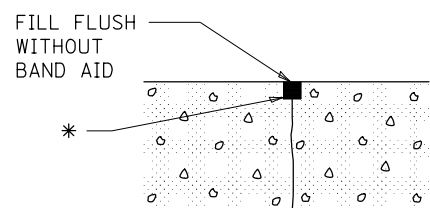

#### TRANSVERSE EXPANSION JOINT

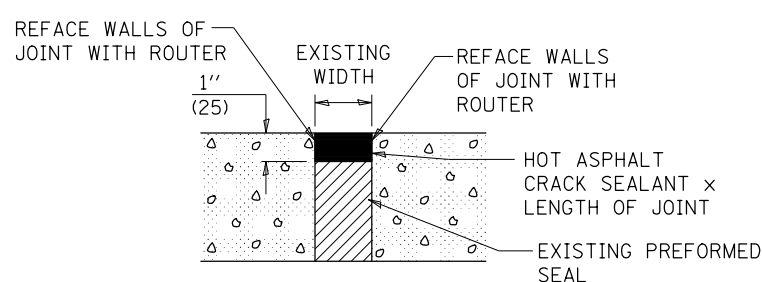

Note: All dimensions are in INCHES  
(millimeters) unless otherwise shown.

\*\*CHAMPAIGN & VERMILION

### DISTRICT 5 DETAIL NO. 45AAAAAA

FILE NAME =	USER NAME = coombessf	DESIGNED -	REVISED - 12/06
pw:\IL\084EBIDINTEG.illinois.gov\PI\DOT\Documents\DOT Offices\District 5\Projects\0570855\Drawings\0570855-shr-plan.dgn		CHECKED -	REVISED - 08/07
		DATE -	REVISED - 12/08
			REVISED -

STATE OF ILLINOIS  
DEPARTMENT OF TRANSPORTATION

### CRACK AND JOINT SEALING

SCALE: SHEET NO. 1 OF 1 SHEETS STA. TO STA.

F.A. RTE.	SECTION	COUNTY	TOTAL SHEETS	SHEET NO.
		**	20	20
*D5 CRACK & JOINT SEAL 2016-1			CONTRACT NO. 70B55	
FED. ROAD DIST. NO. ILLINOIS FED. AID PROJECT				