

04-22-2016 LETTING ITEM 125

STATE OF ILLINOIS
DEPARTMENT OF TRANSPORTATION
DIVISION OF HIGHWAYS

F.A. RTE.	SECTION	COUNTY	TOTAL SHEETS	SHEET NO.
FAU 407	14-00018-00-SG	WILL	14	1
FAU 424				
FAP 332	STRS-4009(348)	ILLINOIS	CONTRACT NO. 61C56	
FAU 423				

FOR INDEX OF SHEETS, SEE SHEET NO. 2

FOR INDEX OF HIGHWAY STANDARDS, SEE SHEET NO. 2

PROJECT LOCATED IN THE VILLAGE OF BEECHER

PLANS FOR PROPOSED FEDERAL AID PROJECT

FAU ROUTE 407 (CHURCH ROAD) AT CARDINAL CREEK BOULEVARD
FAU ROUTE 424 (CARDINAL CREEK BLVD) AT CHURCH ROAD
FAP ROUTE 332 (DIXIE HIGHWAY) AT MILLER STREET
FAU ROUTE 423 (PENFIELD STREET) AT HODGES STREET

SAFE ROUTES TO SCHOOL
PROJECT: STRS-4009(348)
SECTION: 14-00018-00-SG
VILLAGE OF BEECHER
WILL COUNTY

C-91-120-16
LOCATION MAP

PROJECT LOCATION
CHURCH ROAD
CARDINAL CREEK BOULEVARD

TRAFFIC DATA

CHURCH ROAD
POSTED SPEED LIMIT = 30 MPH, 2014 ADT = 1,050 VPD

CARDINAL CREEK BOULEVARD
POSTED SPEED LIMIT = 30 MPH, 2014 ADT = < 1,000 VPD

DIXIE HIGHWAY
POSTED SPEED LIMIT = 35 MPH, 2014 ADT = 8,850 VPD

PENFIELD STREET
POSTED SPEED LIMIT = 25 MPH, 2014 ADT = 1,800 VPD

DESIGN DESIGNATION

- CHURCH ROAD - MAJOR COLLECTOR
- CARDINAL CREEK BOULEVARD - MAJOR COLLECTOR
- DIXIE HIGHWAY - PRINCIPAL ARTERIAL
- PENFIELD STREET - MAJOR COLLECTOR

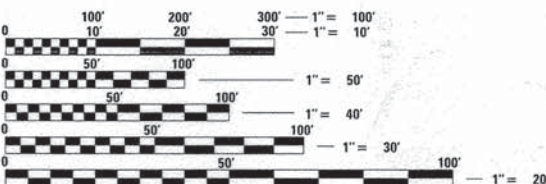

FULL SIZE PLANS HAVE BEEN PREPARED USING STANDARD ENGINEERING SCALES. REDUCED SIZED PLANS WILL NOT CONFORM TO STANDARD SCALES. IN MAKING MEASUREMENTS ON REDUCED PLANS, THE ABOVE SCALES MAY BE USED.

J.U.L.I.E. DESIGN STAGE REQUEST
DIG. No. A1892825



CONTACT JULIE AT 811 OR 800-892-0123 WITH THE FOLLOWING:
COUNTY = WILL
CITY-TWNSHP. = BEECHER - WASHINGTON
SEC. & 1/4 SEC. NO. = 16S, T33N, R14E
48 HOURS (2 working days) BEFORE YOU DIG

CONTRACT NO. 61C56

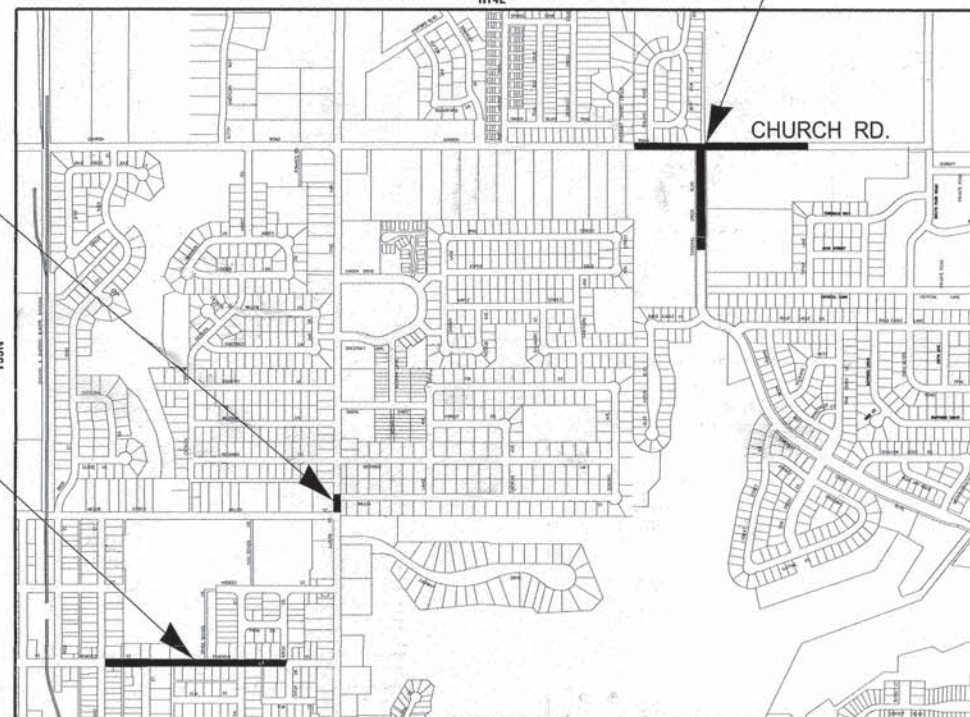

SECTION 16S, T33N, R14E, OF THE THIRD PRINCIPAL MERIDIAN
WASHINGTON TOWNSHIP
GROSS LENGTH = 4,400 FT. = 0.83 MILE
NET LENGTH = 4,400 FT. = 0.83 MILE



LOCATION OF SECTION INDICATED THUS: - [black rectangle] -

THOMAS M. SLATER
62-050844
LICENSED PROFESSIONAL ENGINEER
Thomas M. Slater 2/1/16

PROJECT MANAGER
"LICENSE EXPIRES 11-30-2017"

STATE OF ILLINOIS
DEPARTMENT OF TRANSPORTATION
DIVISION OF HIGHWAYS

APPROVED *[Signature]* 2/1/16
WILLIAM ADAMSTRA, P.E.
VILLAGE OF BEECHER

PASSED FEBRUARY 9, 2016
[Signature] CHRISTOPHER HOLT
DISTRICT 1 ENGINEER OF LOCAL ROADS AND STREETS

RELEASING FOR BID BASED ON LIMITED REVIEW February 16, 2016
[Signature]
DEPUTY DIRECTOR OF HIGHWAYS, REGION 1 ENGINEER

PRINTED BY THE AUTHORITY OF THE STATE OF ILLINOIS

B&W PROJECT NO.: 150194 DATE: 11-20-15

BAXTER & WOODMAN
Consulting Engineers

1/20/2016 10:51:24 PM ...C:\000\Proj\150194\B&W\150194-SRTS\CADD\50945HIT_Cover.dgn
FEDERAL AID PROGRAM ENGINEER FAWAD AGUEEL, PE PT0E (847-705-4021), SCHAMBERG, IL

GENERAL NOTES

- ALL CONSTRUCTION SHALL BE DONE IN ACCORDANCE WITH THE DETAILS IN THE PLANS, THE SPECIAL PROVISIONS INCLUDED IN THE CONTRACT DOCUMENTS, AND THE LATEST EDITION OF THE FOLLOWING STATE OF ILLINOIS SPECIFICATIONS: "THE STANDARD SPECIFICATIONS FOR ROAD AND BRIDGE CONSTRUCTION" (REFERRED TO AS THE "STANDARD SPECIFICATIONS"), THE "SUPPLEMENTAL SPECIFICATIONS AND RECURRING SPECIAL PROVISIONS", THE "MANUAL ON UNIFORM TRAFFIC CONTROL DEVICES FOR STREETS AND HIGHWAYS", THE "MANUAL OF TEST PROCEDURES FOR MATERIALS" AND THE "STANDARD SPECIFICATIONS FOR WATER AND SEWER MAIN CONSTRUCTION IN ILLINOIS".
- UTILITY LOCATIONS HAVE NOT BEEN SHOWN ON THESE PLANS THE CONTRACTOR SHALL BE RESPONSIBLE FOR THE PROTECTION OF ALL UNDERGROUND OR SURFACE UTILITIES, INCLUDING SPRINKLER SYSTEMS, EVEN THOUGH THEY MAY NOT BE SHOWN ON THE PLANS. THE CONTRACTOR SHALL ALSO VERIFY THE DEPTHS OF THE EXISTING UTILITIES IF NECESSARY TO VERIFY THAT GRADE CONFLICTS WILL NOT OCCUR WITH ANY PROPOSED UTILITIES PRIOR TO CONSTRUCTION AND ORDERING ANY MATERIALS. ANY RELOCATION OR LOWERING OF UTILITIES SHALL BE COORDINATED BY THE CONTRACTOR. THE COST OF THIS EXPLORATION SHALL BE INCLUDED IN THE COST OF THE PROPOSED UTILITY CONSTRUCTION.
- THE CONTRACTOR SHALL NOTIFY THE VILLAGE PUBLIC WORKS ADMINISTRATOR AT LEAST 48 HOURS IN ADVANCE OF BEGINNING WORK TO OBTAIN VILLAGE UTILITY LOCATIONS.
- THE CONTRACTOR MAY OBTAIN MUNICIPAL WATER IN BULK, AT NO CHARGE, AS LONG AS THERE IS NOT A "WATERING BAN" IN EFFECT. THE INDISCRIMINATE USE OF FIRE HYDRANTS IS STRICTLY PROHIBITED. WATER FOR CONSTRUCTION SHALL BE METERED OR OTHERWISE ACCOUNTED FOR AND A DAILY LOG MAINTAINED. THE CONTRACTOR SHALL PROVIDE THE WATER TRUCK AND DRIVER REQUIRED TO OBTAIN AND TRANSPORT THIS WATER. THE VILLAGE RESERVES THE RIGHT TO RESTRICT OR REFUSE THE USE OF VILLAGE WATER IF DEEMED NECESSARY.
- ACCESS TO PRIVATE DRIVEWAYS SHALL BE PROVIDED AT ALL TIMES EXCEPT DURING ACTUAL CONSTRUCTION ADJACENT THERE TO. TEMPORARY RAMPS SHALL BE CONSTRUCTED AS NEEDED TO PROVIDE SUCH ACCESS, UTILIZING CRUSHED STONE OR CRUSHED GRAVEL.
- IT WILL BE THE CONTRACTOR'S RESPONSIBILITY TO NOTIFY THE ENGINEER, RESIDENTS AND THE VILLAGE WHEN ACCESS TO DRIVEWAYS WILL BE TEMPORARILY CLOSED DUE TO CURB AND GUTTER AND/OR DRIVEWAY REPLACEMENT. THE CONTRACTOR SHALL DISTRIBUTE NOTICES PROVIDED BY THE VILLAGE TO RESIDENTS AT LEAST 24 HOURS PRIOR TO PLANNED CLOSURE. EVERY EFFORT SHALL BE MADE TO ACCOMMODATE ACCESS TO THESE PROPERTIES INCLUDING KNOCKING ON DOORS WHEN DRIVEWAYS ARE ABOUT TO BE CLOSED.
- TRANSVERSE EXPANSION JOINTS 3/4" SHALL BE PLACED EVERY 50 FEET OR AS DETERMINED BY THE ENGINEER. TRANSVERSE CONTRACTION JOINTS SHALL BE PLACED EVERY 5-FEET.
- A 1/2-INCH THICK EXPANSION JOINT SHALL BE PROVIDED AT THE JUNCTION OF THE DRIVEWAY APRON AND CURB, AND AT THE JUNCTION OF THE DRIVEWAY APRON AND THE SIDEWALK. THIS WORK WILL BE INCLUDED IN THE COST OF PORTLAND CEMENT CONCRETE DRIVEWAY PAVEMENT.
- DETECTABLE WARNINGS SHALL BE CONSTRUCTED WITH THE INSTALLATION OF ULTRA-ADA PADS #726, 24"x60" MINIMUM NOMINAL SIZE PANEL MANUFACTURED BY ULTRA TECH. THE DOMES LOCATED ON THE PANEL SHALL PARALLEL THE PAVEMENT CROSS WALK WITH THE CLOSEST EDGE LOCATED AT THE BACK OF CURB. THE CONTRASTING PANEL COLOR SHALL BE SELECTED BY THE VILLAGE. INSTALLATION SHALL OCCUR IN ACCORDANCE WITH THE MANUFACTURER'S RECOMMENDATIONS.
- IN AREAS WHERE THE EXISTING DRIVEWAY, SIDEWALK, OR CURB AND GUTTER IS TO BE REMOVED AND REPLACED, THE REMOVAL AND DISPOSAL OF ANY ADDITIONAL MATERIAL REQUIRED TO ESTABLISH THE PROPOSED DRIVEWAY, SIDEWALK, OR CURB AND GUTTER SUBGRADE ELEVATION SHALL BE INCLUDED IN THE APPROPRIATE REMOVAL PAY ITEMS.
- ALL POSTS, RAILROAD TIES, AND DECORATIVE TIMBER IN CONFLICT WITH THE PROPOSED IMPROVEMENTS SHALL BE REMOVED AND RELOCATED AS DETERMINED BY THE ENGINEER AT THE TIME OF CONSTRUCTION AND SHALL BE INCLUDED IN THE COST OF EARTH EXCAVATION. EVERY EFFORT SHALL BE MADE BY THE CONTRACTOR WHEN REMOVING THESE ITEMS TO PRESERVE THEM FROM HARM. ITEMS NOT RELOCATED SHALL BE PROPERLY DISPOSED OF BY THE CONTRACTOR.
- THE IDOT DISTRICT 1 DETAIL FOR COMBINATION CONCRETE CURB AND GUTTER REMOVAL AND REPLACEMENT SHOWN IN THE PLANS SHALL BE MODIFIED TO INCLUDE THE FOLLOWING. THE WORK SHALL INCLUDE SAW-CUTTING AND REMOVING THE EXISTING PAVEMENT A MINIMUM OF 6-INCHES MEASURED FROM THE EXISTING EDGE OF PAVEMENT, AND FILLING THE 6" GAP WITH CLASS SI CONCRETE TO AN ELEVATION 2-1/2" BELOW THE PROPOSED CURB AND GUTTER FLAG. IF THE CONCRETE IS POURED HIGHER THAN 2-1/2" FROM THE GUTTER FLAG FOR STREETS TO BE RESURFACED, THE CONTRACTOR WILL BE REQUIRED TO GRIND ADDITIONAL CONCRETE TO THE REQUIRED 2-1/2" DEPTH. THE AREA BEHIND THE PROPOSED CURB AND GUTTER SHALL BE RESTORED WITH NATIVE SOD IN ACCORDANCE WITH SECTION 1081.03 RATHER THAN SALT TOLERANT SOD.
- THE CONTRACTOR SHALL CONTACT THE IDOT TRAFFIC CONTROL SUPERVISOR, ANDREW SCHUETZE AT (847) 705-4470 72 HOURS IN ADVANCED OF BEGINNING WORK ON IL 1 (DIXIE HIGHWAY).

INDEX OF SHEETS

SHEET NO.	TITLE
1	COVER SHEET
2	GENERAL NOTES, HIGHWAY STANDARDS AND INDEX OF SHEETS
3	SUMMARY OF QUANTITIES
4 5	TYPICAL SECTIONS
6	SIDEWALK PLANS
7	SIGNAGE PLAN - CARDINAL CREEK BOULEVARD AND CHURCH ROAD
8	SIGNAGE PLAN - IL ROUTE 1 (DIXIE HIGHWAY)
9	SIGNAGE PLAN - PENFIELD STREET AT HODGES STREET
10	MISCELLANEOUS DETAILS
11	DISTRICT ONE DETAIL - BD24 CURB OR CURB AND GUTTER REMOVAL AND REPLACEMENT
12	DISTRICT ONE DETAIL - TC10 TRAFFIC CONTROL AND PROTECTION FOR SIDE ROADS, INTERSECTIONS, AND DRIVEWAYS
13	DISTRICT ONE DETAIL - TC13 DISTRICT ONE TYPICAL PAVEMENT MARKINGS
14	DISTRICT ONE DETAIL - TC22 ARTERIAL ROAD INFORMATION SIGN

HIGHWAY STANDARDS

000001-06	STANDARD SYMBOLS, ABBREVIATIONS AND PATTERNS
280001-07	TEMPORARY EROSION CONTROL SYSTEMS
424001-08	PERPENDICULAR CURB RAMPS FOR SIDEWALKS
424006-02	DIAGONAL CURB RAMPS FOR SIDEWALKS
424011-02	CORNER PARALLEL CURB RAMPS FOR SIDEWALKS
424016-02	MID-BLOCK CURB RAMPS FOR SIDEWALKS
606001-06	CONCRETE CURB TYPE B AND COMBINATION CONCRETE CURB AND GUTTER
701006-05	OFF-RD OPERATIONS, 2L, 2W, SHORT TIME OPERATIONS
701301-04	LANE CLOSURE, 2L, 2W, SHORT TIME OPERATIONS
701502-06	URBAN LANE CLOSURE, 2L, 2W, WITH BIDIRECTIONAL LEFT TURN LANE
701701-10	URBAN LANE CLOSER, MULTILANE INTERSECTION
701801-06	SIDEWALK, CORNER OR CROSSWALK CLOSURE
701901-05	TRAFFIC CONTROL DEVICES
720001-01	SIGN PANEL MOUNTING DETAILS
720006-04	SIGN PANEL ERECTION DETAILS
728001-01	TELESCOPING STEEL SIGN SUPPORT
880001-01	SPAN WIRE MOUNTED SIGNALS AND FLASHING BEACON INSTALLATION
878001-10	CONCRETE FOUNDATION DETAILS

COPYRIGHT © 2017 BY BAXTER & WOODMAN, INC.
 STATE OF ILLINOIS PROFESSIONAL ENGINEERING
 LICENSE NO. 184-00021 - EXPIRES 6/30/2017
 T111# 034445 AM 2/17/2016
 ...:\projects\150194SHT-GenNotes.dgn
 ...:\CAD\Drawings\150194_SHT-GEN.dwg



DESIGNED - L.J.F.	REVISED -
DRAWN - KAR	REVISED -
CHECKED - TMS	REVISED -
DATE - 11-20-15	FILE - 150194SHT-GenNotes.dgn

**VILLAGE OF BEECHER
SAFE ROUTES TO SCHOOL**

**GENERAL NOTES, HIGHWAY STANDARDS
AND INDEX OF SHEETS**

SCALE: NONE

STA.

TO STA.

*FAU 407
FAU 424
FAP 332
FAU 423

F.A. RTE.	SECTION	COUNTY	TOTAL SHEETS	SHEET NO.
*	14-00018-00-SG	WILL	14	2
			CONTRACT NO. 61C56	
FED. ROAD DIST. NO.		ILLINOIS FED. AID PROJECT STRS-4009(348)		

COPYRIGHT © 2017 BY BAXTER & WOODMAN, INC.
 STATE OF ILLINOIS - PROFESSIONAL DESIGN FIRM
 LICENSE NO. - JBA-001821 - EXPIRES 6/30/2017
 11/3/2016 11:34:53 AM
 I:\CHICAGO\BEECHER\50194-SHT\50194SHT-500.dgn

SUMMARY OF QUANTITIES				
CODE NO.	ITEM DESCRIPTION	UNIT	TOTAL	CONSTRUCTION TYPE CODE 0021
21101625	TOPSOIL FURNISH AND PLACE, 6"	SQ YD	51	51
25000400	NITROGEN FERTILIZER NUTRIENT	POUND	1	1
25000500	PHOSPHORUS FERTILIZER NUTRIENT	POUND	1	1
25000600	POTASSIUM FERTILIZER NUTRIENT	POUND	1	1
25200100	SODDING	SQ YD	51	51
25200200	SUPPLEMENTAL WATERING	UNIT	3	3
35101600	AGGREGATE BASE COURSE, TYPE B 4"	SQ YD	124	124
* 40800050	INCIDENTAL HOT-MIX ASPHALT SURFACING	TON	1	1
42001300	PROTECTIVE COAT	SQ YD	125	125
42400200	PORTLAND CEMENT CONCRETE SIDEWALK 5 INCH	SQ FT	1112	1112
42400800	DETECTABLE WARNINGS	SQ FT	132	132
44000600	SIDEWALK REMOVAL	SQ FT	932	932
67100100	MOBILIZATION	L SUM	1	1
* # 66900200	NON-SPECIAL WASTE DISPOSAL	CUYD	29	29
* # 66900450	SPECIAL WASTE PLANS AND REPORTS	L SUM	1	1
* # 66900530	SOIL DISPOSAL ANALYSIS	EACH	1	1
# 70102622	TRAFFIC CONTROL AND PROTECTION, STANDARD 701502	L SUM	1	1
# 70102635	TRAFFIC CONTROL AND PROTECTION, STANDARD 701701	L SUM	1	1
# 70102640	TRAFFIC CONTROL AND PROTECTION, STANDARD 701801	L SUM	1	1
* 72000100	SIGN PANEL - TYPE 1	SQ FT	409	409
* 72400100	REMOVE SIGN PANEL ASSEMBLY - TYPE A	EACH	9	9
* 72800100	TELESCOPING STEEL SIGN SUPPORT	FOOT	240	240
* 78000600	THERMOPLASTIC PAVEMENT MARKING - LINE 12"	FOOT	366	366

* INDICATES SPECIALTY ITEM
INDICATES SPECIAL PROVISION

SUMMARY OF QUANTITIES				
CODE NO.	ITEM DESCRIPTION	UNIT	TOTAL	CONSTRUCTION TYPE CODE 0021
78300100	PAVEMENT MARKING REMOVAL	SQ FT	366	366
# Z0004562	COMBINATION CONCRETE CURB AND GUTTER REMOVAL AND REPLACEMENT	FOOT	118	118
# Z0030850	TEMPORARY INFORMATION SIGNING	SQ FT	182	182
# Z0017400	DRAINAGE & UTILITY STRUCTURES TO BE ADJUSTED	EACH	2	2
* # X0325714	FLASHING BEACON, POST MOUNTED, SOLAR POWERED INSTALLATION	EACH	6	6

* INDICATES SPECIALTY ITEM
INDICATES SPECIAL PROVISION



DESIGNED - L.J.F.	REVISED -
DRAWN - KAR	REVISED -
CHECKED - TMS	REVISED -
DATE - 11-20-15	FILE - 150194SHT-500.dgn

VILLAGE OF BEECHER
SAFE ROUTES TO SCHOOL

SUMMARY OF QUANTITIES

SCALE: NONE

STA. TO STA.

F.A. RTE.
FAU 407
FAU 424
FAP 332
FAU 423

SECTION	COUNTY	TOTAL SHEETS	SHEET NO.
14-00018-00-SG	WILL	14	3
CONTRACT NO. 61C56			
FED. ROAD DIST. NO. ILLINOIS FED. AID PROJECT STRS-4009(348)			

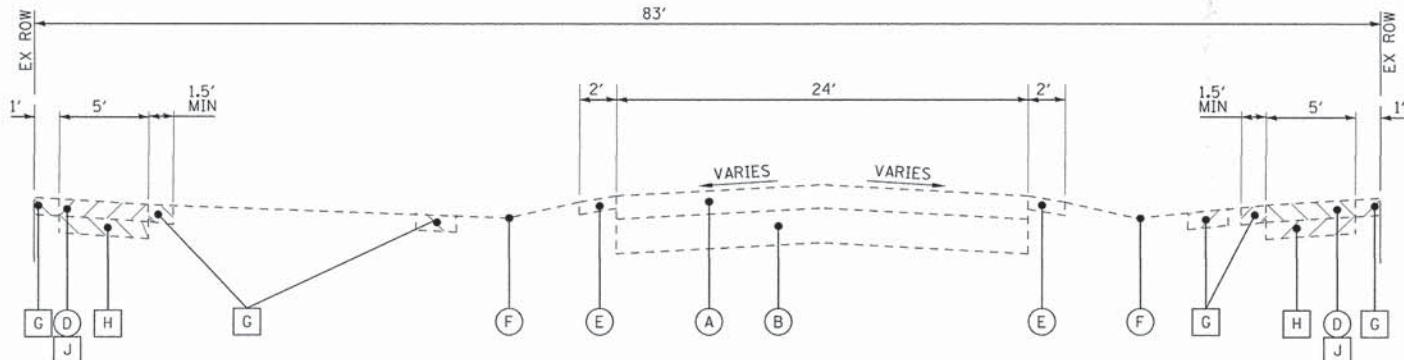

**EXISTING TYPICAL SECTION
CHURCH ROAD**

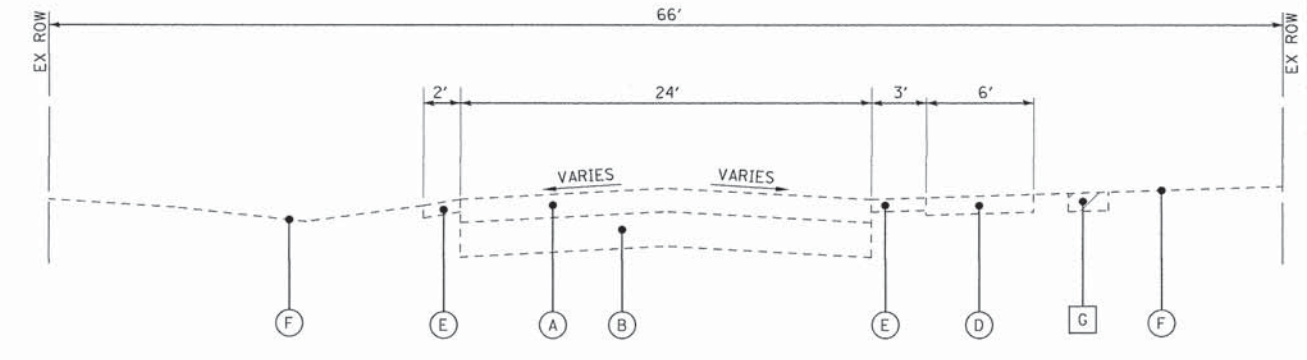

**EXISTING TYPICAL SECTION
CARDINAL CREEK BOULEVARD**

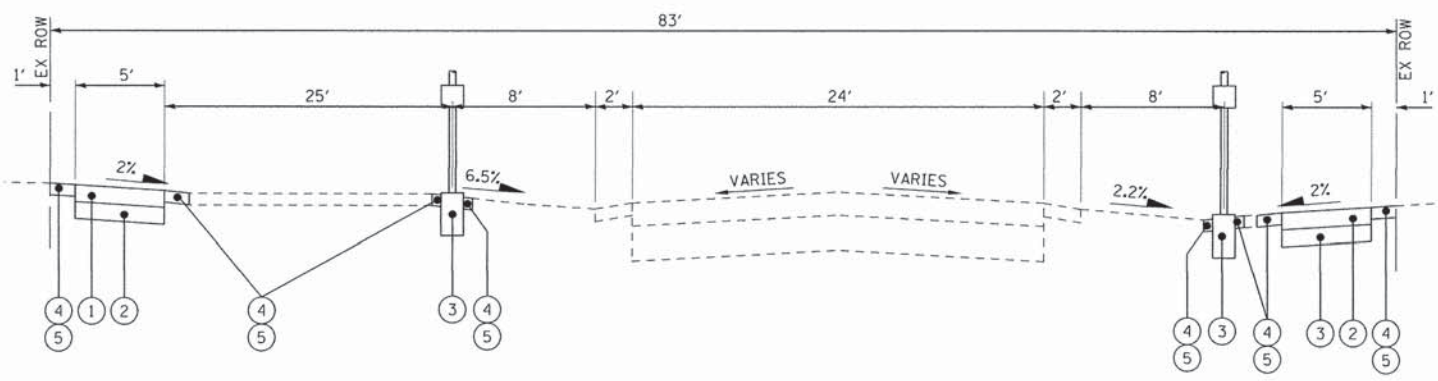

**PROPOSED TYPICAL SECTION
CHURCH ROAD**

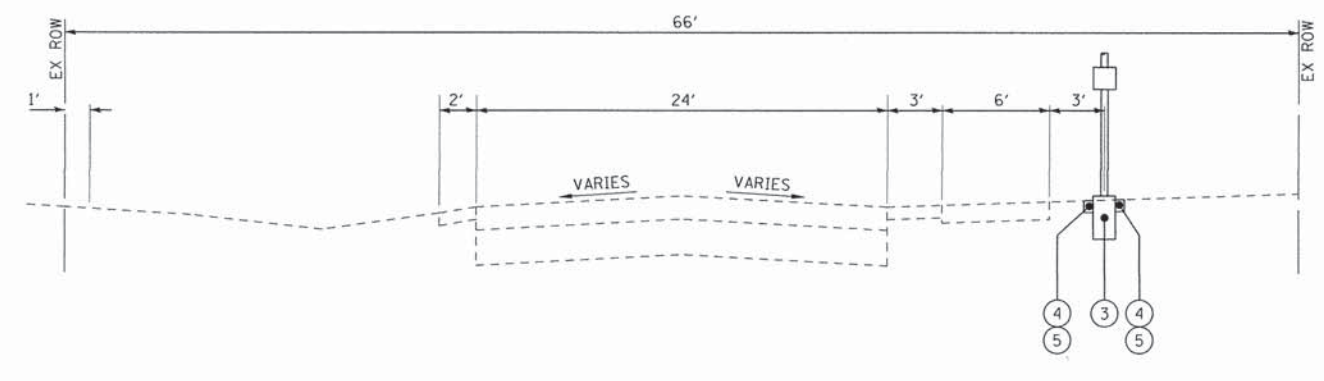

**PROPOSED TYPICAL SECTION
CARDINAL CREEK BOULEVARD**

HOT-MIX ASPHALT MIXTURE REQUIREMENTS

HOT-MIX ASPHALT MIXTURE REQUIREMENTS	
MIXTURE TYPE	AIR VOIDS @ Ndes
INCIDENTAL HOT-MIX ASPHALT SURFACING	
HOT-MIX ASPHALT SURFACE COURSE, MIX "D", N50 (IL 9.5mm); ; 2 1/2"	4% @ 50 GYR

THE UNIT WEIGHT USED TO CALCULATE ALL HOT-MIX ASPHALT SURFACE MIXTURE QUANTITIES IS 112LB/SY-IN.
 THE 'AC TYPE' FOR POLYMERIZED HMA MIXES SHALL BE "SBS/SBR PG 76-22" AND FOR NON-POLYMERIZED HMA THE "AC TYPE" SHALL BE "PG 64-22" UNLESS MODIFIED BY DISTRICT ONE SPECIAL PROVISIONS.
 FOR HMA FULL DEPTH "AC TYPE" SEE SPECIAL PROVISIONS
 FOR USE OF RECYCLED MATERIALS SEE SPECIAL PROVISIONS.

EXISTING LEGEND

- (A) EXISTING HOT-MIX ASPHALT SURFACE AND BINDER COURSE
- (B) EXISTING AGGREGATE BASE COURSE
- (C) EXISTING COMBINATION CONCRETE CURB AND GUTTER, TYPE B-6.24
- (D) EXISTING SIDEWALK
- (E) EXISTING AGGREGATE SHOULDER
- (F) GROUND SURFACE
- (G) REMOVAL AND DISPOSAL OF UNSUITABLE MATERIAL (TOPSOIL) NON-SPECIAL WASTE DISPOSAL
- (H) EARTH EXCAVATION- NON-SPECIAL WASTE DISPOSAL
- (J) SIDEWALK REMOVAL
- [Hatched Box] ITEM TO BE REMOVED

PROPOSED LEGEND

- (1) PORTLAND CEMENT CONCRETE SIDEWALK - 5 INCH
- (2) AGGREGATE BASE COURSE, TYPE B - 4"
- (3) SIGNAGE
- (4) TOPSOIL FURNISH AND PLACE, 6"
- (5) SODDING

COPYRIGHT © 2017 BY BAXTER & WOODMAN, INC.
 STATE OF ILLINOIS PROFESSIONAL DESIGN FIRM
 LICENSE NO. 184-00321 - EXPIRES 4/30/2017
 7/11/JF
 11/3/2016



DESIGNED - L/JF	REVISED -
DRAWN - KAR	REVISED -
CHECKED - TMS	REVISED -
DATE - 11-20-15	FILE - 150194SHT-TypSec.dgn

**VILLAGE OF BEECHER
SAFE ROUTES TO SCHOOL**

TYPICAL SECTIONS

SCALE: NONE STA. TO STA.

*FAU 407
 FAU 424
 FAP 332
 FAU 423

F.A. RTE.	SECTION	COUNTY	TOTAL SHEETS	SHEET NO.
*	14-00018-00-SG	WILL	14	4
CONTRACT NO. 61C56				
FED. ROAD DIST. NO. ILLINOIS FED. AID PROJECT STRS-4009348				

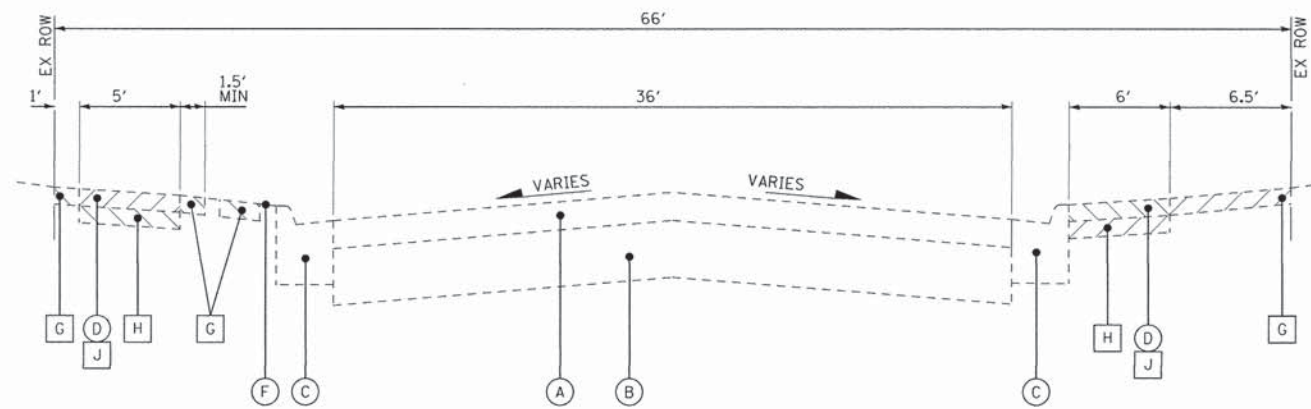

**EXISTING TYPICAL SECTION
IL RTE 1 (DIXIE HIGHWAY)**

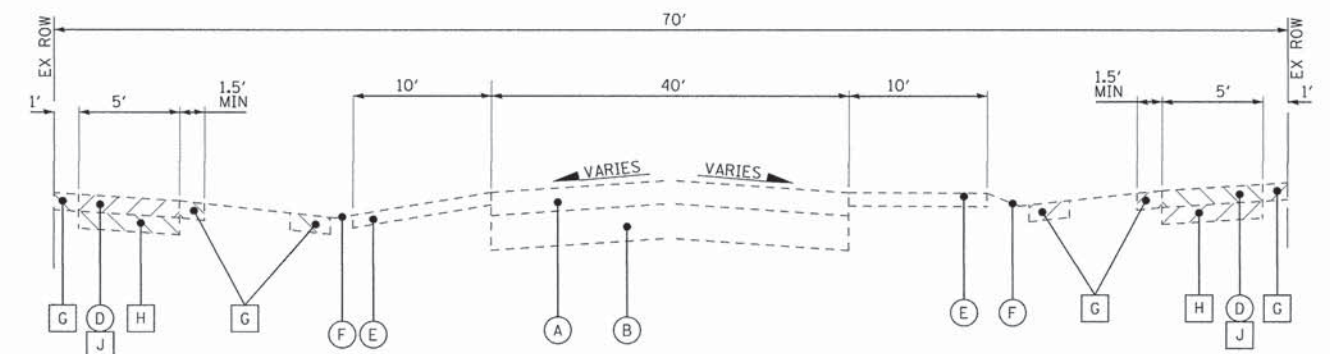

**EXISTING TYPICAL SECTION
PENFIELD STREET**

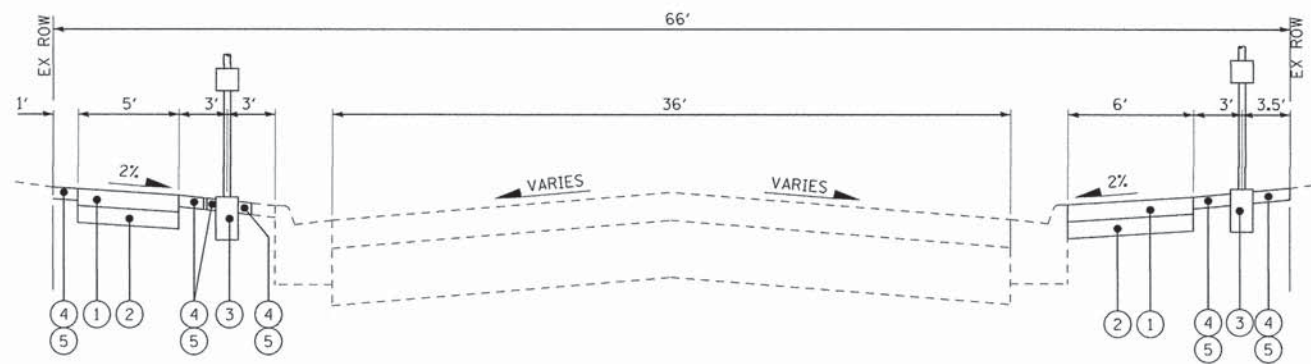

**PROPOSED TYPICAL SECTION
IL RTE 1 (DIXIE HIGHWAY)**

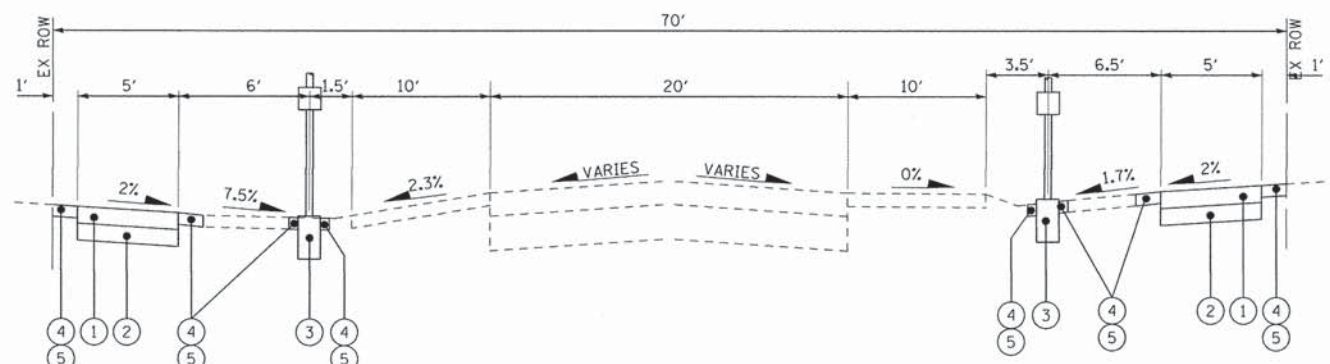

**PROPOSED TYPICAL SECTION
PENFIELD STREET**

EXISTING LEGEND

- (A) EXISTING HOT-MIX ASPHALT SURFACE AND BINDER COURSE
- (B) EXISTING AGGREGATE BASE COURSE
- (C) EXISTING COMBINATION CONCRETE CURB AND GUTTER, TYPE B-6.24
- (D) EXISTING SIDEWALK
- (E) EXISTING AGGREGATE SHOULDER
- (F) GROUND SURFACE
- (G) REMOVAL AND DISPOSAL OF UNSUITABLE MATERIAL (TOPSOIL) NON-SPECIAL WASTE DISPOSAL
- (H) EARTH EXCAVATION NON-SPECIAL WASTE DISPOSAL
- (J) SIDEWALK REMOVAL
- [Hatched Box] ITEM TO BE REMOVED

PROPOSED LEGEND

- (1) PORTLAND CEMENT CONCRETE SIDEWALK - 5 INCH
- (2) AGGREGATE BASE COURSE, TYPE B - 4"
- (3) SIGNAGE
- (4) TOPSOIL FURNISH AND PLACE, 6"
- (5) SODDING

COPYRIGHT © 2017 BY BAXTER & WOODMAN, INC.
 ALL RIGHTS RESERVED.
 LICENSE NO. 184-00121 - EXPIRES 4/30/2017
 7:41:33 AM 11/30/2016 11:35:00 AM



DESIGNED - L.J.F.	REVISED -
DRAWN - KAR	REVISED -
CHECKED - T.M.S.	REVISED -
DATE - 11-20-15	FILE - 150194SHT-TypSec.dgn

**VILLAGE OF BEECHER
SAFE ROUTES TO SCHOOL**

TYPICAL SECTIONS

SCALE: NONE

STA. TO STA.

*FAU 407
FAU 424
FAP 332
FAU 423

F.A. RTE.	SECTION	COUNTY	TOTAL SHEETS	SHEET NO.
*	14-00018-00-SG	WILL	14	5
CONTRACT NO. 61C56				
FED. ROAD DIST. NO. ILLINOIS FED. AID PROJECT STRS-409(348)				

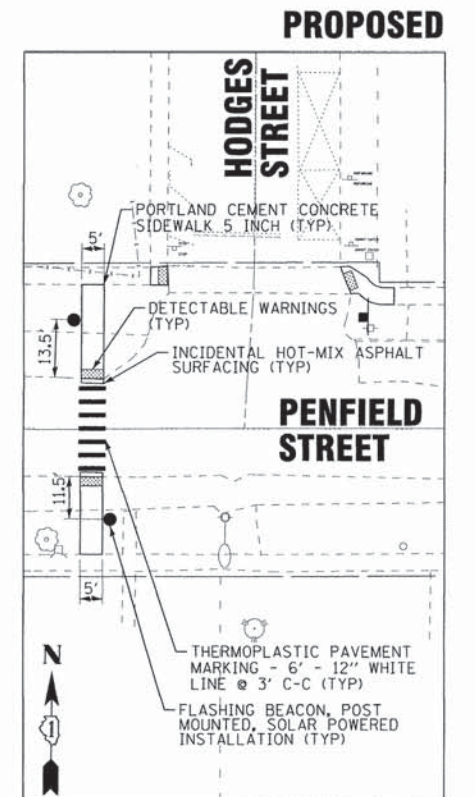
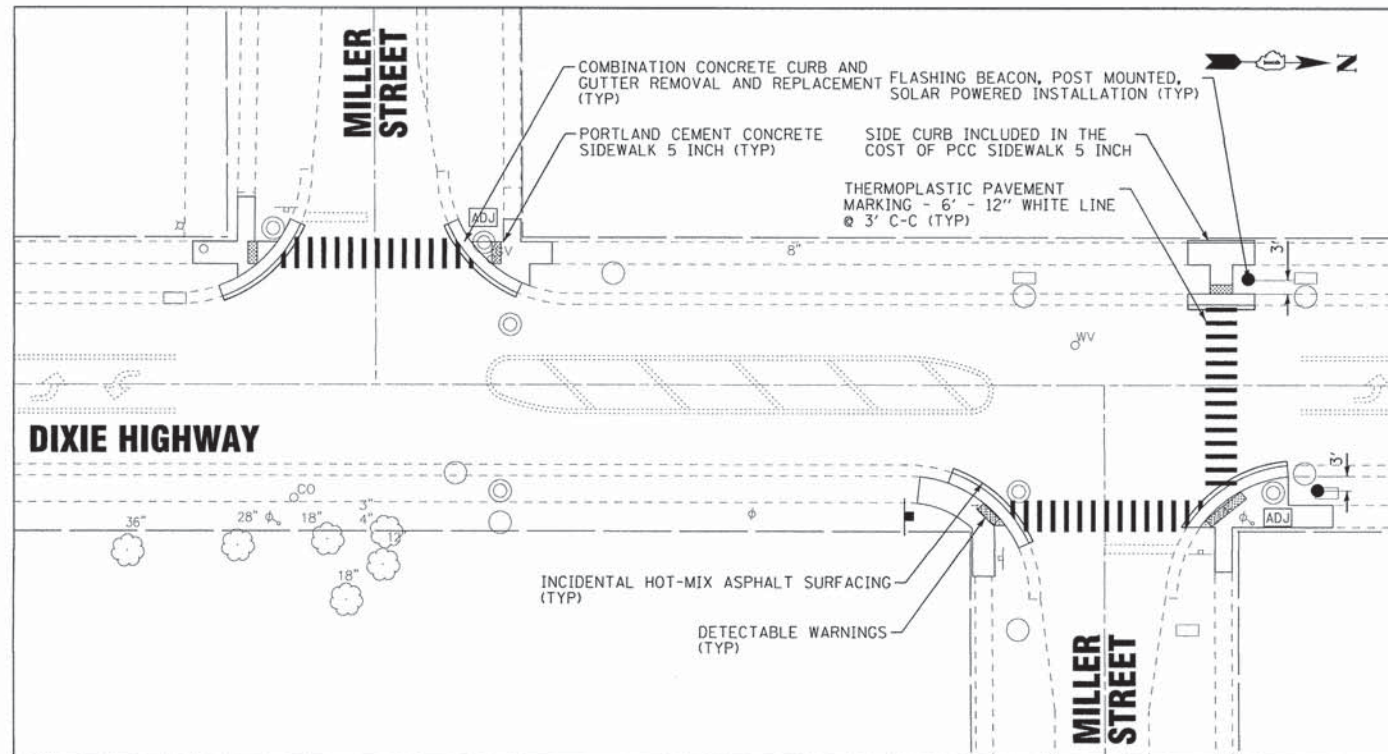
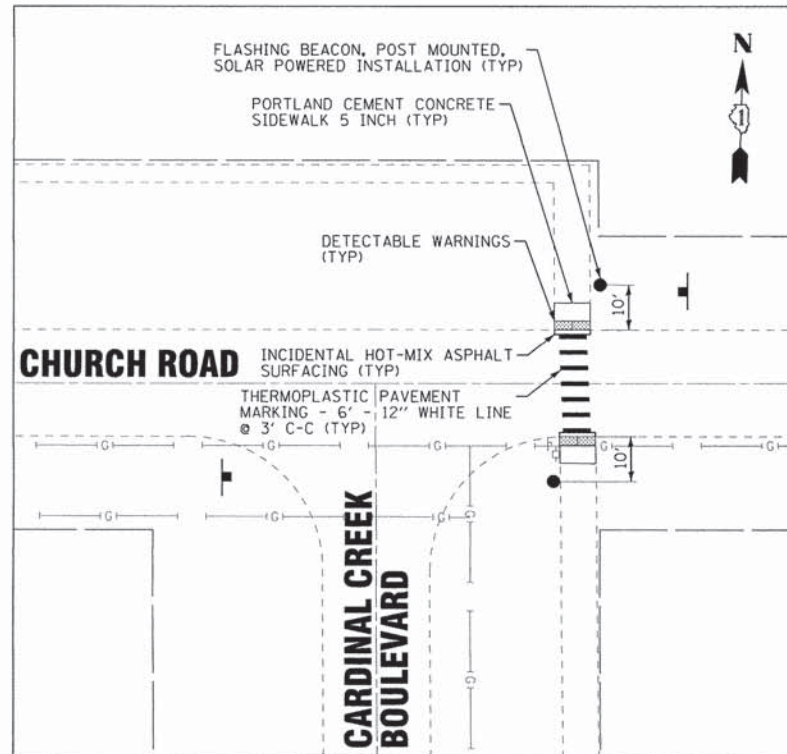
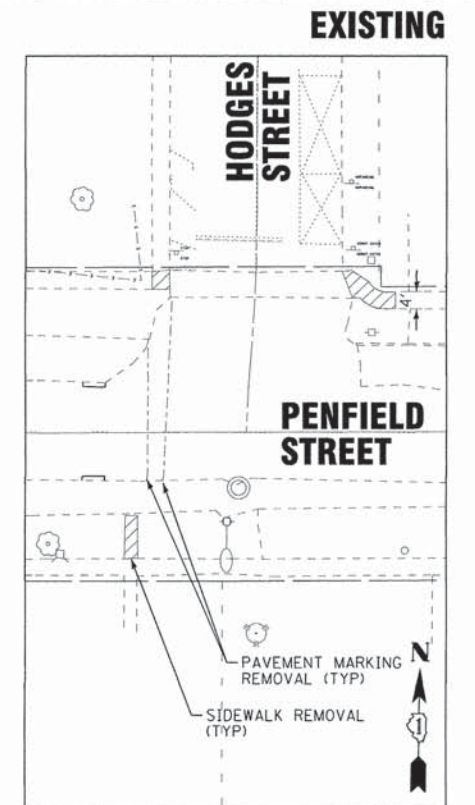
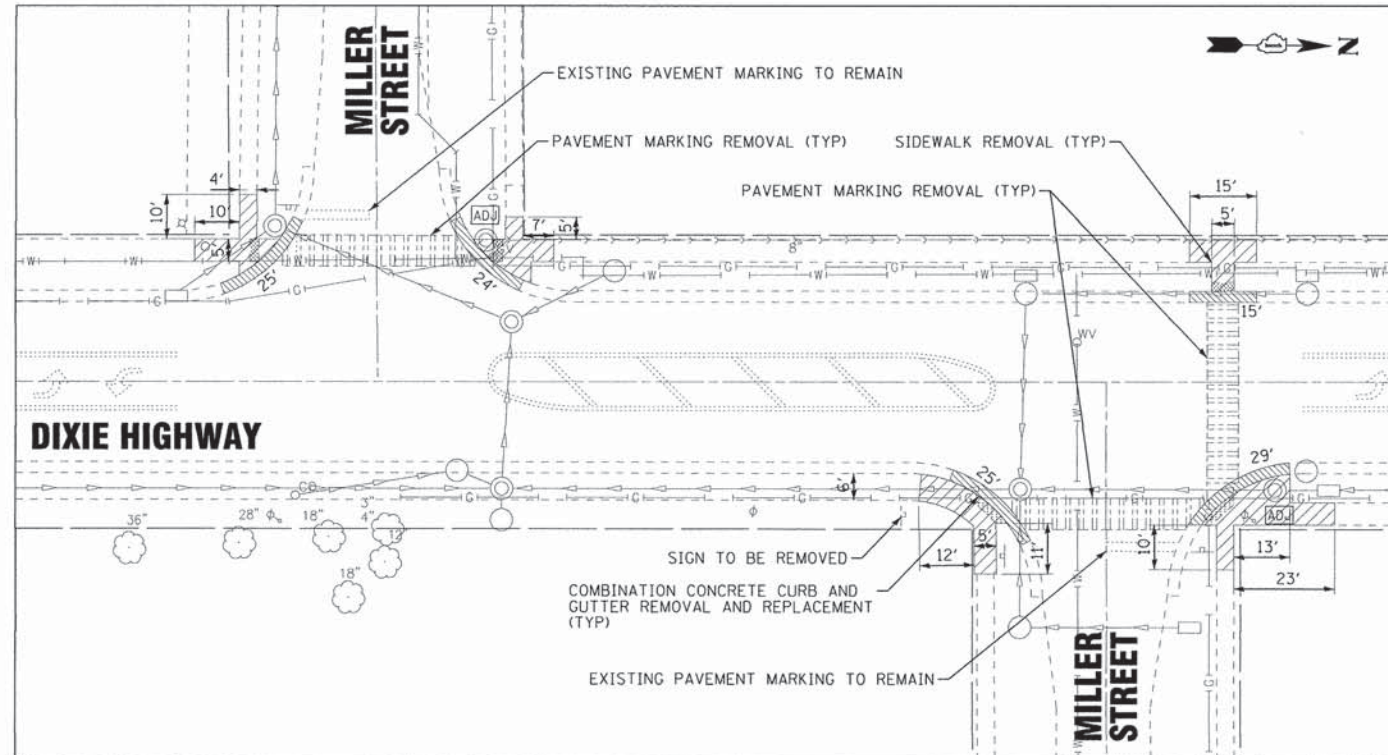
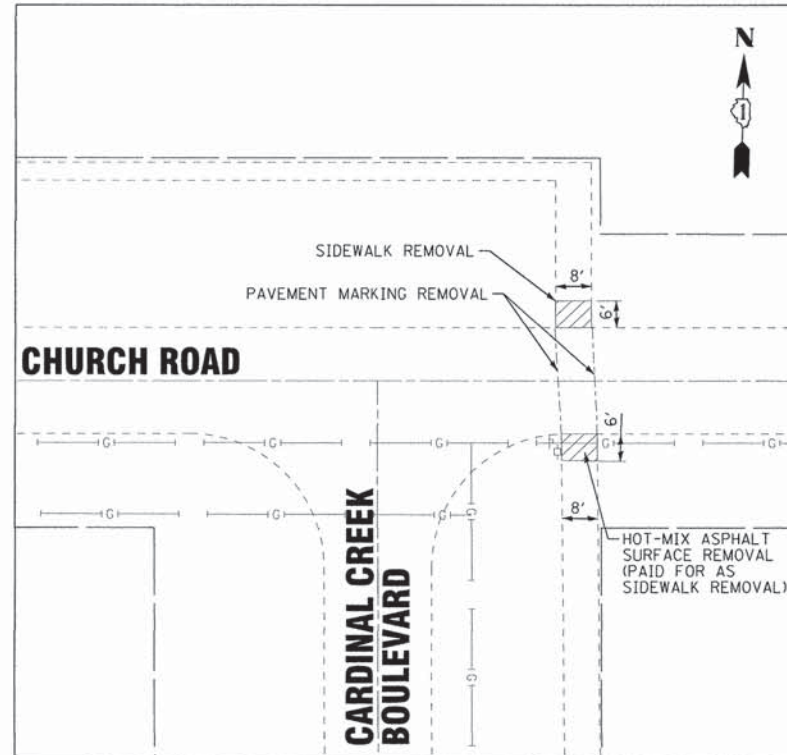

COPYRIGHT © 2017 BY BAXTER & WOODMAN, INC.
 STATE OF ILLINOIS PROFESSIONAL ENGINEERING
 LICENSE NO. 184-00121 - EXPIRES 4/30/2017
 7/4/17
 \\s014dev\us04f-bm_default.sht
 \\caddy\p015\5084_P142_PEN.tbl
 I:\Chicago\BEECHER\5094-SRTS\CADD\5094SHT-Plan4_SIDEWALK_DETAILS.dgn
 2/3/2016

BAXTER & WOODMAN
Consulting Engineers

DESIGNED - L.J.F.	REVISED -
DRAWN - KAR	REVISED -
CHECKED - T.M.S.	REVISED -
DATE - 11-20-15	FILE - 150194SHT-Plan4_SIDEWALK_DETAILS.dgn

**VILLAGE OF BEECHER
SAFE ROUTES TO SCHOOL**

SIDEWALK PLANS

SCALE: 1" = 20'

STA. TO STA.

*FAU 407
FAU 424
FAP 332
FAU 423

F.A. RTE.	SECTION	COUNTY	TOTAL SHEETS	SHEET NO.
*	14-00018-00-SG	WILL	14	6
FED. ROAD DIST. NO.			CONTRACT NO. 61C56	
ILLINOIS FED. AID PROJECT STRS-4009(348)				

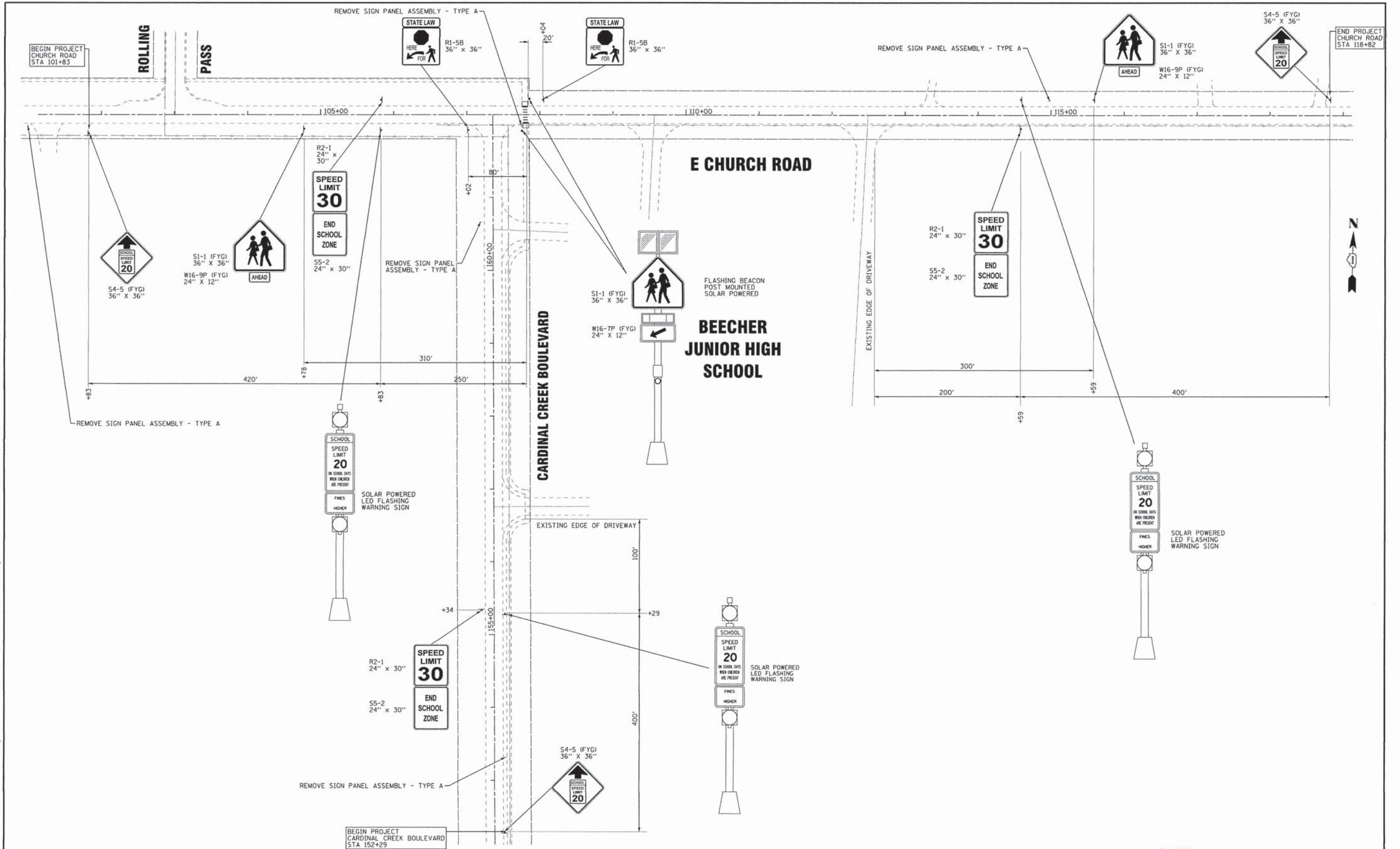

COPYRIGHT © 2017 BY BAXTER & WOODMAN, INC.
 ALL RIGHTS RESERVED. THIS DOCUMENT IS THE PROPERTY OF BAXTER & WOODMAN, INC. AND IS NOT TO BE REPRODUCED OR TRANSMITTED IN ANY FORM OR BY ANY MEANS, ELECTRONIC OR MECHANICAL, INCLUDING PHOTOCOPYING, RECORDING, OR BY ANY INFORMATION STORAGE AND RETRIEVAL SYSTEM, WITHOUT THE WRITTEN PERMISSION OF BAXTER & WOODMAN, INC.
 LICENSE NO. 184-00021 - EXPIRES 4/30/2017
 7/11/17 11:35:02 AM
 I:\Chicago\BEECHER\5094-SRTS\CADD\5094SHT-Plan3_Church.dgn



DESIGNED -	LJF	REVISED -	
DRAWN -	KAR	REVISED -	
CHECKED -	TMS	REVISED -	
DATE -	11-20-15	FILE -	150194SHT-Plan3_Church.dgn

**VILLAGE OF BEECHER
SAFE ROUTES TO SCHOOL**

**SIGNAGE PLAN -
CARDINAL CREEK BOULEVARD & CHURCH ROAD**

SCALE: 1" = 60' STA. TO STA.

*FAU 407
FAU 424
FAP 332
FAU 423

F.A. RTE.	SECTION	COUNTY	TOTAL SHEETS	SHEET NO.
*	14-00018-00-SG	WILL	14	7
FED. ROAD DIST. NO.			ILLINOIS FED. AID PROJECT STRS-4009(348)	
CONTRACT NO. 61C56				

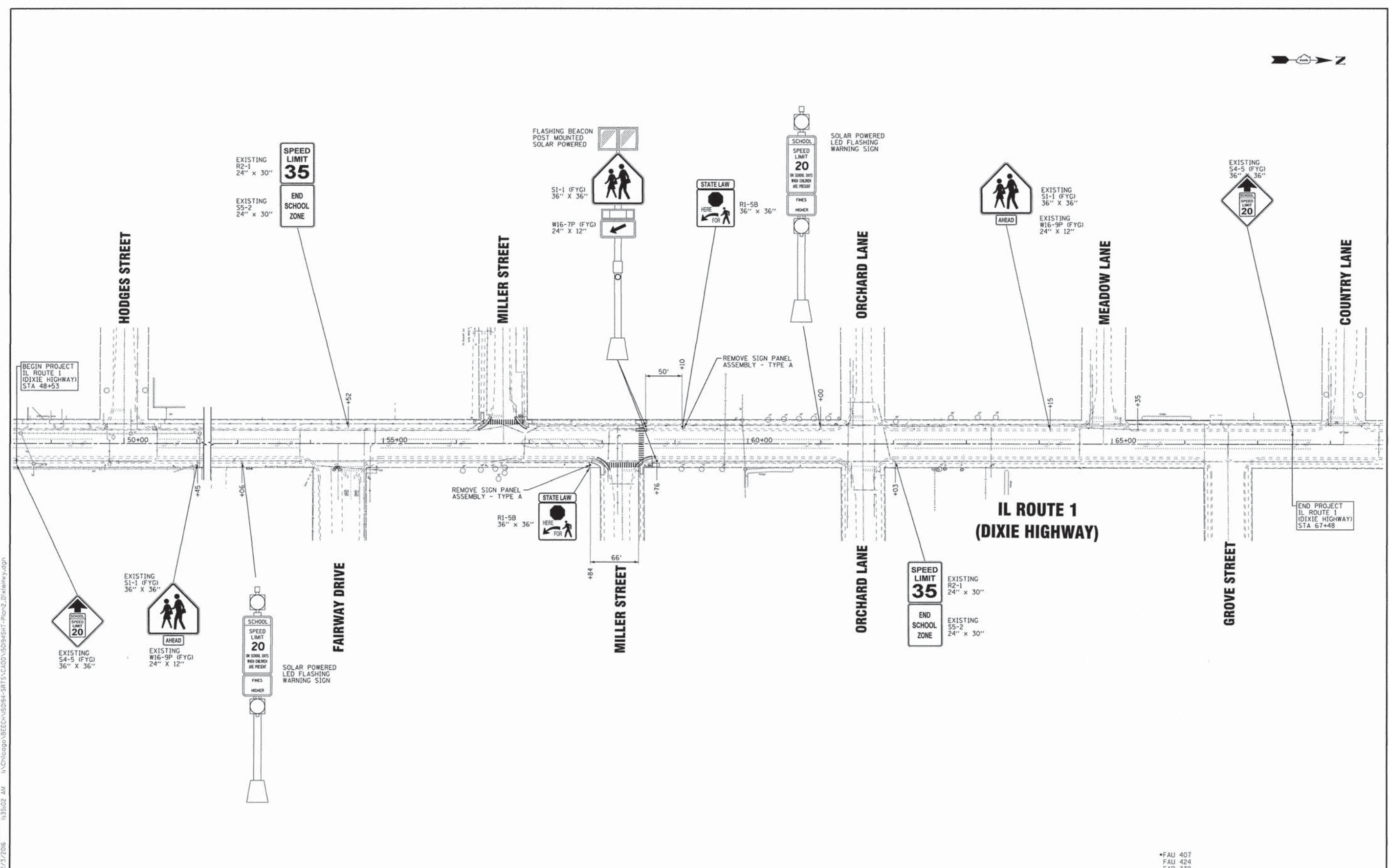

COPYRIGHT © 2017 BY BAXTER & WOODMAN, INC. ALL RIGHTS RESERVED. ILLINOIS PROFESSIONAL ENGINEER LICENSE NO. 184-001211 EXPIRES 4/30/2017 7:41:27
 \sbs\dw\150194SHT-Plan2.DixieHwy.dgn
 ...CADDY\PROJ\150194_SHT\PLAN2\BEG1.DWG
 i:\chicago\BEECH\150194-SHT\150194SHT-Plan2.DixieHwy.dgn
 03/30/2017 10:35:02 AM

BAXTER & WOODMAN
Consulting Engineers

DESIGNED - L.J.F.	REVISED -
DRAWN - KAR	REVISED -
CHECKED - T.M.S.	REVISED -
DATE - 11-20-15	FILE - 150194SHT-Plan2.DixieHwy.dgn

**VILLAGE OF BEECHER
SAFE ROUTES TO SCHOOL**

SIGNAGE PLAN - IL ROUTE 1 (DIXIE HIGHWAY)

SCALE: 1" = 60'

STA. TO STA.

FAU 407
FAU 424
FAP 332
FAU 423

F.A. RTE.	SECTION	COUNTY	TOTAL SHEETS	SHEET NO.
*	14-00018-00-SG	WILL	14	8
CONTRACT NO. 61C56				
FED. ROAD DIST. NO. [ILLINOIS] FED. AID PROJECT STRS-400913481				

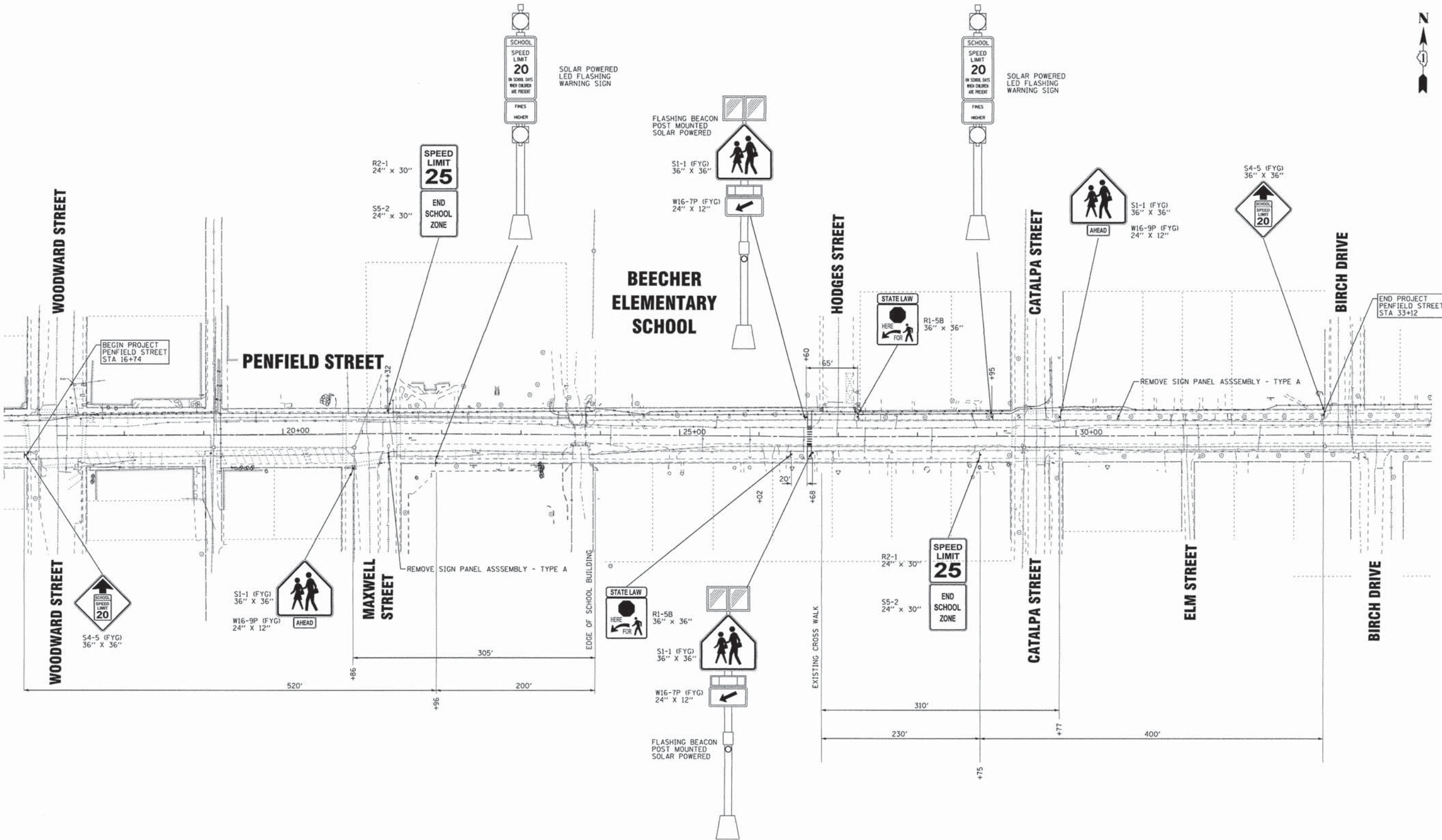

COPYRIGHT © 2017 BY BAXTER & WOODMAN, INC.
 ALL RIGHTS RESERVED. PROFESSIONAL ENGINEER
 LICENSE NO. 0012020 EXP. 02/28/2021
 7/11/17
 I:\Projects\150194SHT-Plan1_Penfield.dgn
 11/20/15 10:30:03 AM

BAXTER & WOODMAN Consulting Engineers	DESIGNED - L.J.F.	REVISED -
	DRAWN - KAR	REVISED -
	CHECKED - T.M.S.	REVISED -
	DATE - 11-20-15	FILE - 150194SHT-Plan1_Penfield.dgn

**VILLAGE OF BEECHER
SAFE ROUTES TO SCHOOL**

SIGNAGE PLAN - PENFIELD STREET AT HODGES STREET

SCALE: 1" = 60' STA. TO STA.

*FAU 407 FAU 424 FAP 332 FAU 423	F.A. RTE.	SECTION	COUNTY	TOTAL SHEETS	SHEET NO.
	*	14-00018-00-SG	WILL	14	9
	CONTRACT NO. 61C56				
FED. ROAD DIST. NO. ILLINOIS FED. AID PROJECT STRS-40093481					

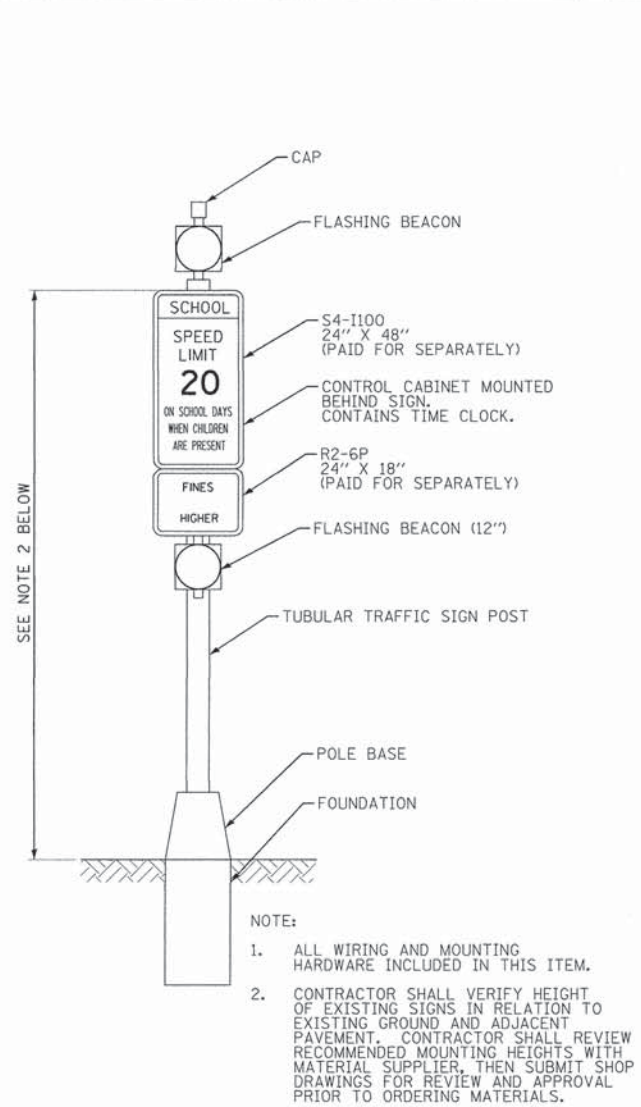

SOLAR POWERED LED FLASHING WARNING SIGN
NOT TO SCALE

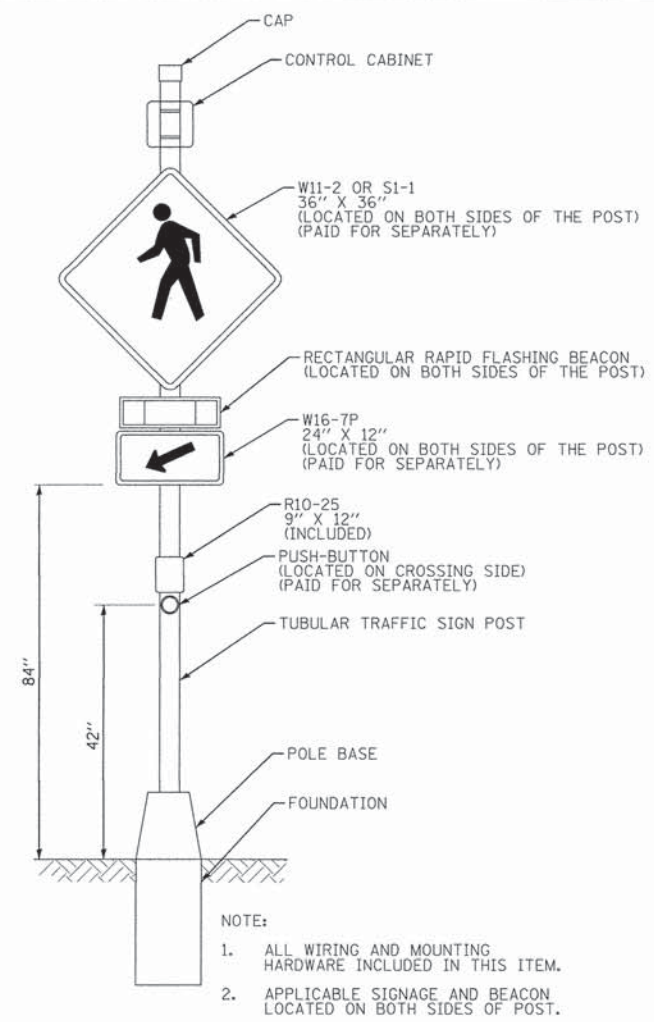

FLASHING BEACON, POST MOUNTED, SOLAR POWERED INSTALLATION DETAIL
NOT TO SCALE

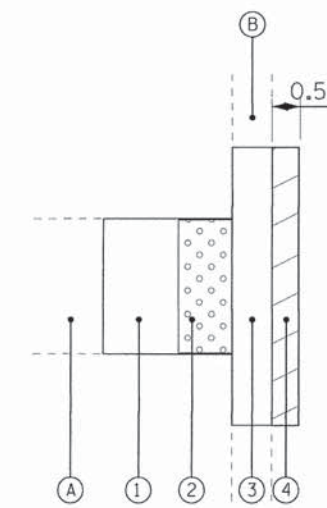

EXISTING LEGEND

- (A) EXISTING SIDEWALK
- (B) EXISTING CURB AND GUTTER

PROPOSED LEGEND

- (1) PORTLAND CEMENT CONCRETE SIDEWALK
- (2) DETECTABLE WARNINGS
- (3) PROPOSED CONCRETE CURB AND GUTTER
- (4) INCIDENTAL HOT-MIX ASPHALT SURFACING

INCIDENTAL HOT-MIX ASPHALT PAVING DETAIL

SIGN SCHEDULE			
S4-I100 24" X 48"	S1-1 (FYG) 36" X 36"	R1-5b 36" X 36"	R62E (CAL) PUSH BUTTON FOR PEDESTRIAN WARNING LIGHTS CROSS WITH CAUTION PUSHBUTTON SIGN 9" X 12"
R2-6P 24" X 18"	W16-7PR (FYG) 12" X 24"	W16-7PL (FYG) 12" X 24"	STATE LAW BLACK LEGEND AND BORDER ON FLOURESCENT YELLOW-GREEN BACKGROUND 36" X 6"

* SIGN SHOULD BE FLOURESCENT YELLOW-GREEN IN COLOR

COPYRIGHT © 2017 BY BAXTER & WOODMAN, INC.
 ALL RIGHTS RESERVED.
 LICENSE NO. 184-00121 EXPIRES 4/30/2017
 7/6/17
 I:\Projects\150194SHT-De+alls.dgn
 11/20/2017 10:35:04 AM



DESIGNED - LJF	REVISED -
DRAWN - KAR	REVISED -
CHECKED - TMS	REVISED -
DATE - 11-20-15	FILE - 150194SHT-De+alls.dgn

**VILLAGE OF BEECHER
SAFE ROUTES TO SCHOOL**

MISCELLANEOUS DETAILS

SCALE: 1" = 60'

STA. TO STA.

*FAU 407
FAU 424
FAP 332
FAU 423

F.A. RTE.	SECTION	COUNTY	TOTAL SHEETS	SHEET NO.
*	14-00018-00-SG	WILL	14	10
CONTRACT NO. 61C56			FED. ROAD DIST. NO. ILLINOIS FED. AID PROJECT STRS-40093481	

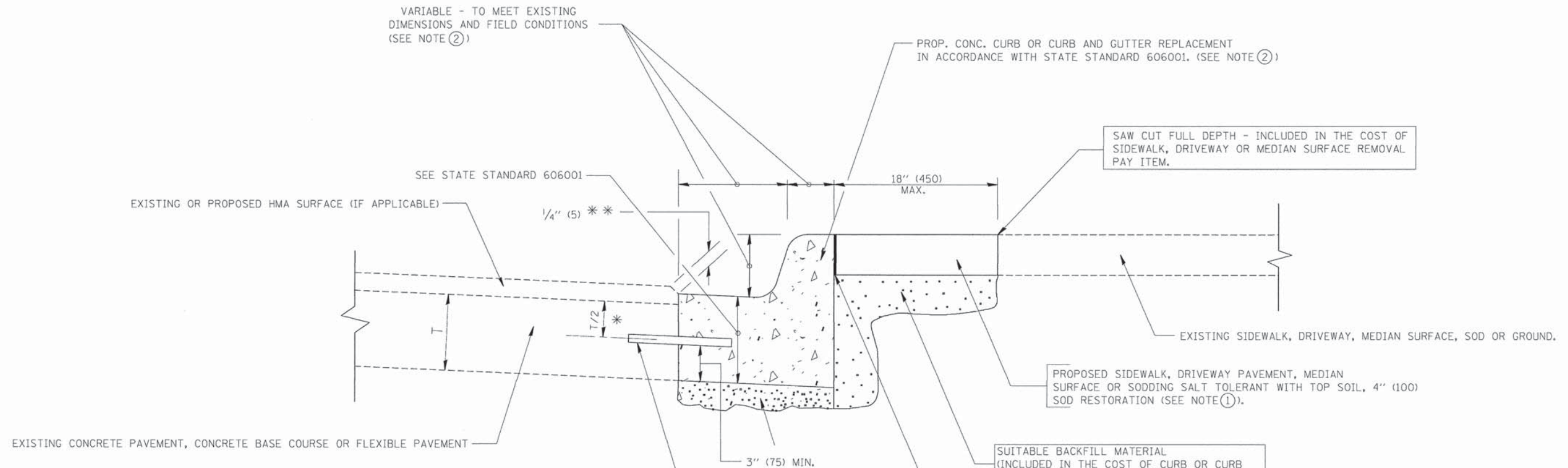

* 3" (75) MINIMUM FROM TOP AND BOTTOM OF THE CONCRETE PAVEMENT OR BASE COURSE.
 ** IF THE FINAL SURFACE OF THE PAVEMENT IS CONCRETE, THE GUTTER IS TO BE FLUSH WITH THE PAVEMENT.

- NOTE: ① SIDEWALK, DRIVEWAY PAVEMENT OR MEDIAN SURFACE SHALL BE SIMILAR TO THE MATERIAL BEING REMOVED AND WILL BE PAID FOR SEPARATELY.
 SODDING, SALT TOLERANT AND TOP SOIL, FURNISH AND PLACE 4" WILL BE PAID FOR SEPARATELY.
- ② FERTILIZER FOR THE PLACEMENT OF THE SOD IS NOT REQUIRED
- ③ CURB OR CURB AND GUTTER REPLACEMENT SHALL MATCH THE SHAPE OF THE EXISTING CURB OR CURB AND GUTTER UNLESS OTHERWISE SPECIFIED.
- ④ FOR CURB OR CURB AND GUTTER REMOVAL AND REPLACEMENT ADJACENT TO FLEXIBLE PAVEMENT DELETE EPOXY COATED TIE BARS.
- ⑤ LONGITUDINAL BARS, IF ENCOUNTERED IN THE EXISTING CURB OR CURB AND GUTTER, ARE NOT TO BE REPLACED. CUTTING AND REMOVING LONGITUDINAL BARS SHALL BE INCLUDED IN THE COST OF CURB OR CURB AND GUTTER REMOVAL AND REPLACEMENT.
- ⑥ THE COST OF HMA SURFACE REMOVAL IN THE EXISTING GUTTER FLAG SHALL BE INCLUDED IN THE COST OF THE CURB AND GUTTER REMOVAL AND REPLACEMENT.
- ⑦ THE REMOVAL AND REPLACEMENT OF THE EXISTING CURB OR CURB AND GUTTER SHALL BE DONE IN ACCORDANCE WITH THE APPLICABLE PORTIONS OF SECTION 440 AND 606 OF THE STANDARD SPECIFICATIONS.
- ⑧ THE LOCATIONS OF REMOVAL AND REPLACEMENT OF EXISTING CURB OR CURB AND GUTTER SHALL BE DETERMINED BY THE RESIDENT ENGINEER AT THE TIME OF CONSTRUCTION.

UNSUITABLE SUB-BASE MATERIAL TO BE REMOVED, IF DIRECTED BY THE ENGINEER, SHALL BE REPLACED WITH EITHER SUB-BASE GRANULAR MATERIAL, TYPE B OR ADDITIONAL THICKNESS OF CONCRETE.

REMOVAL AND REPLACEMENT 4" (100) OR LESS IS INCLUDED IN THE COST OF CURB OR CURB AND GUTTER REMOVAL AND REPLACEMENT.

REMOVAL AND REPLACEMENT IN EXCESS OF 4" (100) WILL BE PAID FOR IN ACCORDANCE WITH ARTICLE 109.04 OF THE STANDARD SPECIFICATIONS.

PROPOSED #6 (20) EPOXY COATED TIE BARS 24" (600) LONG AT 24" (600) CENTERS WILL NOT BE PAID FOR SEPARATELY. DELETE EPOXY COATED TIE BARS IF EXISTING TIE BARS ARE USUABLE AS DETERMINED BY THE ENGINEER. (SEE NOTE 3).

BASIS OF PAYMENT:
 THIS WORK WILL BE PAID FOR AT THE CONTRACT UNIT PRICE PER FOOT (METER) FOR "CURB REMOVAL AND REPLACEMENT" OR "COMBINATION CONCRETE CURB AND GUTTER REMOVAL AND REPLACEMENT".

CURB OR CURB AND GUTTER REMOVAL AND REPLACEMENT

*FAU 407
 FAU 424
 FAP 332
 FAU 423

ALL DIMENSIONS ARE IN INCHES (MILLIMETERS) UNLESS OTHERWISE SHOWN.

COPYRIGHT © 2014 BY BAYTEK & WOODMAN, INC.
 STATE OF ILLINOIS - PROFESSIONAL DESIGN FIRM
 1301 W. MONROE ST., SUITE 100, CHICAGO, IL 60604
 312.467.1000 FAX 312.467.1001
 www.baytekandwoodman.com

FILE NAME =	USER NAME = drvakosgn	DESIGNED - A. HOUSEH	REVISED - R. SHAH 10-03-96
c:\pwork\p\ridot\drvakosgn\dr128315\bd24.dgn		DRAWN -	REVISED - A. ABBAS 03-21-97
	PLOT SCALE = 5/8" = 1' IN.	CHECKED -	REVISED - M. GOMEZ 01-22-01
	PLOT DATE = 12/15/2009	DATE - 03-11-94	REVISED - R. BORO 12-15-09

**STATE OF ILLINOIS
 DEPARTMENT OF TRANSPORTATION**

CURB OR CURB AND GUTTER REMOVAL AND REPLACEMENT			
SCALE: NONE	SHEET NO. 1 OF 1 SHEETS	STA.	TO STA.

F.A. RTE.	SECTION	COUNTY	TOTAL SHEETS	SHEET NO.
*	14-00018-00-SG	WILL	14	11
BD600-06 (BD-24)		CONTRACT NO. 61C56		
FED. ROAD DIST. NO. 1 ILLINOIS FED. AID PROJ. STRS-4009(348)				

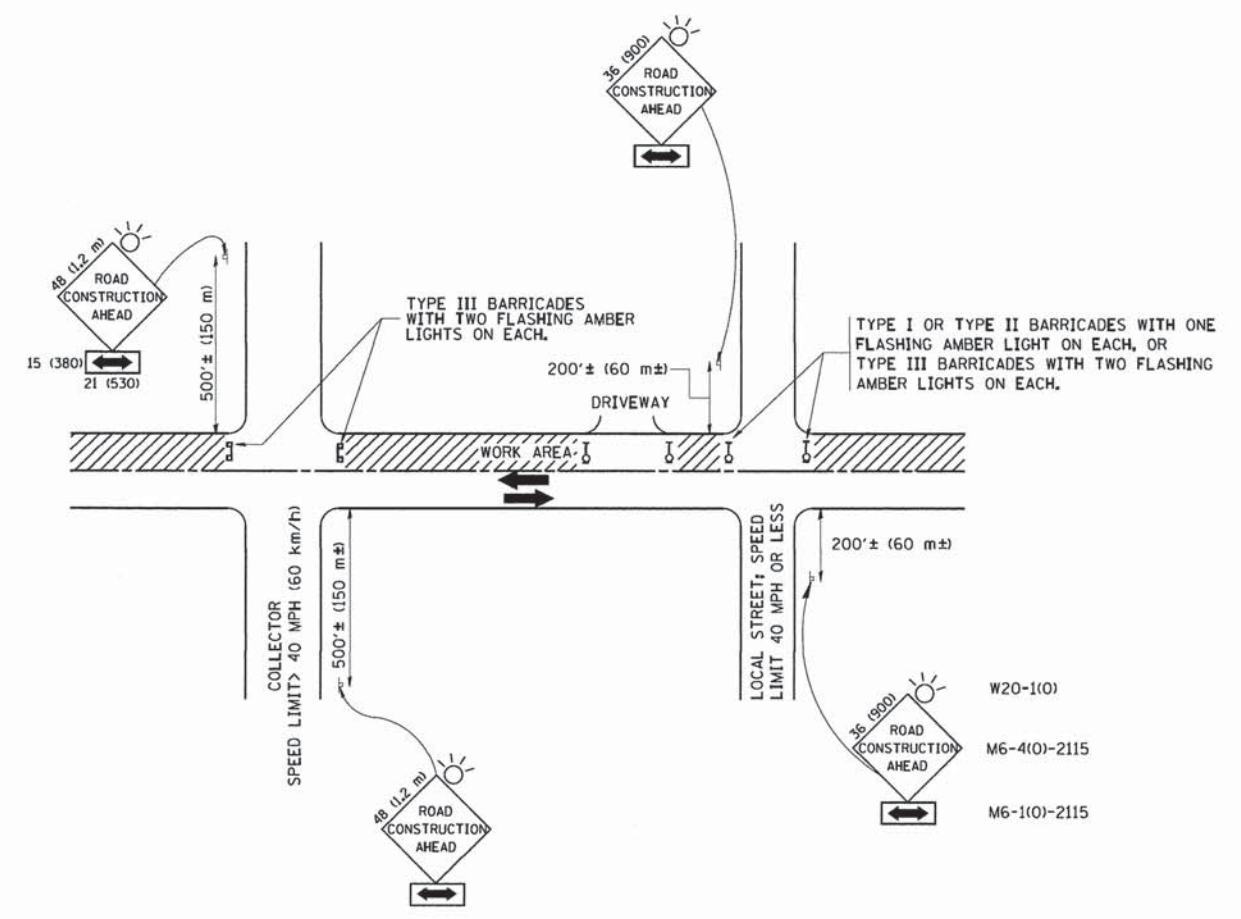

TRAFFIC CONTROL AND PROTECTION FOR SIDE ROADS, INTERSECTIONS, AND DRIVEWAYS

NOTES:

- A. FOR NO LANE RESTRICTION ON THE SIDE ROAD OR DRIVEWAYS
 - 1. SIDE ROAD WITH A SPEED LIMIT OF 40 MPH (60 km/h) OR LESS AS SHOWN ON THE DRAWING AND AS DIRECTED BY THE ENGINEER:
 - a) ONE ROAD CONSTRUCTION AHEAD SIGN 36 x 36 (900x900) WITH A FLASHER AND FLAG MOUNTED ON IT APPROXIMATELY 200' (60 m) IN ADVANCE OF THE MAIN ROUTE.
 - b) THE CLOSED PORTION OF THE MAIN ROUTE SHALL BE PROTECTED BY BLOCKING WITH TYPE I, TYPE II OR TYPE III BARRICADES, 1/3 OF THE CROSS SECTION OF THE CLOSED PORTION.
 - 2. SIDE ROAD WITH A SPEED LIMIT GREATER THAN 40 MPH (60 km/h) AS SHOWN ON THE DRAWING AND AS DIRECTED BY THE ENGINEER:
 - a) ONE ROAD CONSTRUCTION AHEAD SIGN 48 x 48 (1.2 m x 1.2 m) WITH A FLASHER MOUNTED ON IT APPROXIMATELY 500' (150 m) IN ADVANCE OF THE MAIN ROUTE.
 - b) THE CLOSED PORTION OF THE MAIN ROUTE SHALL BE PROTECTED BY BLOCKING WITH TYPE III BARRICADES, 1/2 OF THE CROSS SECTION OF THE CLOSED PORTION.
- 3. WHEN THE SIDE ROAD LIES BETWEEN THE BEGINNING OF THE MAINLINE SIGNING AND THE WORK ZONE, A SINGLE HEADED ARROW (M6-1) SHALL BE USED IN LIEU OF THE DOUBLE HEADED ARROW (M6-4).

- B. FOR A LANE CLOSURE ON A SIDE ROAD OR DRIVEWAY:

USE APPLICABLE PORTIONS OF THE TYPICAL APPLICATION OF TRAFFIC CONTROL DEVICES (STD. 701501, STD. 701606 OR THE APPROPRIATE STANDARD). THE SPACING OF SIGNS AND BARRICADES SHALL BE ADJUSTED FOR FIELD CONDITIONS AS DIRECTED BY THE ENGINEER. THE DIRECTIONAL ARROW SHALL BE COVERED OR REMOVED WHEN NO LONGER CONSISTENT WITH THE SIDE ROAD LANE CLOSURE.
- C. ADVANCE WARNING SIGNS ARE TO BE OMITTED ON DRIVEWAY UNLESS OTHERWISE NOTED.
- D. THE TRAFFIC CONTROL AND PROTECTION FOR SIDE ROADS, INTERSECTIONS, AND DRIVEWAYS SHALL BE INCIDENTAL TO THE COST OF SPECIFIED TRAFFIC CONTROL STANDARDS OR ITEMS.

* FAU 407
 * FAU 424
 * FAP 332
 * FAU 423
 All dimensions are in millimeters (inches) unless otherwise shown.

COPYRIGHT © 2014 BY BAYTER & WOODMAN, INC.
 STATE OF ILLINOIS - PROFESSIONAL DESIGN FIRM
 2/2/2014
 W:\projects\22x34\1c18.dgn

FILE NAME = W:\projects\22x34\1c18.dgn	USER NAME = geglianobt	DESIGNED - LHA	REVISED - J. OBERLE 10-18-95
PLOT SCALE = 50.000 "/ IN.	CHECKED -	REVISOR - A. HOUSEH 03-06-96	REVISED - A. HOUSEH 10-15-96
PLOT DATE = 1/4/2008	DATE - 06-89	REVISOR - T. RAMMACHER 01-06-00	REVISED -

**STATE OF ILLINOIS
 DEPARTMENT OF TRANSPORTATION**

TRAFFIC CONTROL AND PROTECTION FOR SIDE ROADS, INTERSECTIONS, AND DRIVEWAYS			
SCALE: NONE	SHEET NO. 1 OF 1 SHEETS	STA.	TO STA.

F.A. R.T.E.	SECTION	COUNTY	TOTAL SHEETS	SHEET NO.
*	14-00018-00-SG	WILL	14	12
TC-10			CONTRACT NO. 61C56	
FED. ROAD DIST. NO. 1 ILLINOIS FED. AID PROJECTS-4009(348)				

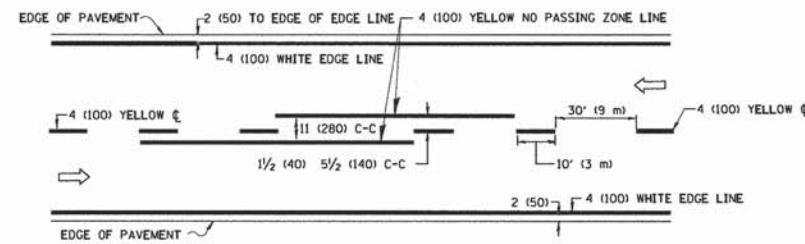

2-LANE ROADWAY

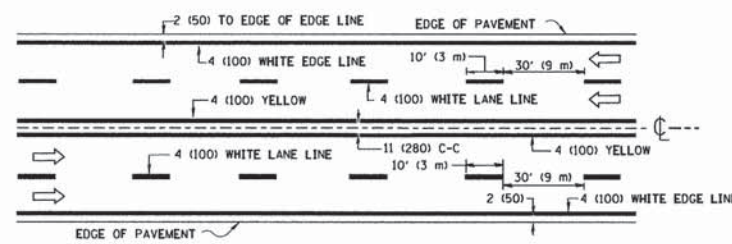

MULTI-LANE UNDIVIDED

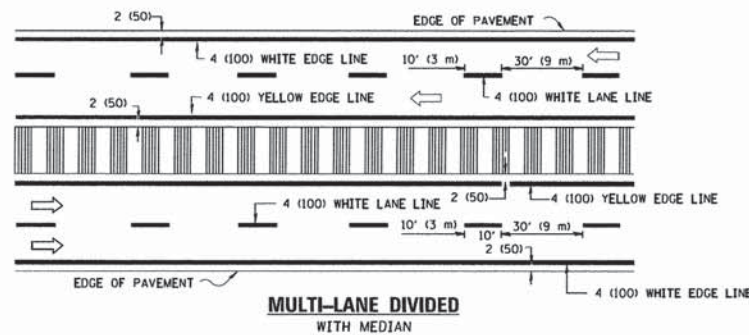

TYPICAL LANE AND EDGE LINE MARKING

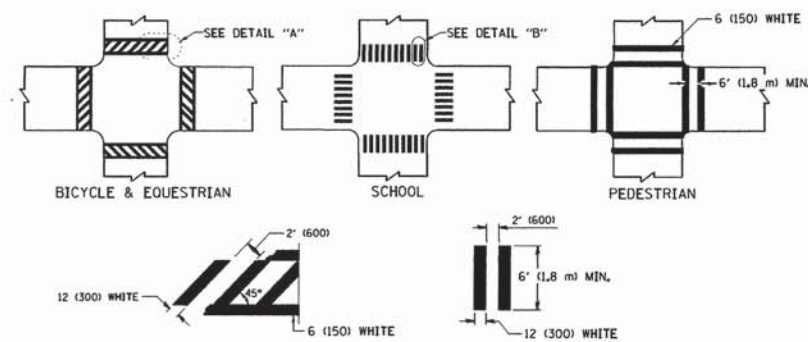

TYPICAL CROSSWALK MARKING

* MARKINGS SHALL BE INSTALLED PARALLEL TO THE CENTERLINE OF THE ROAD WHICH IT CROSSES

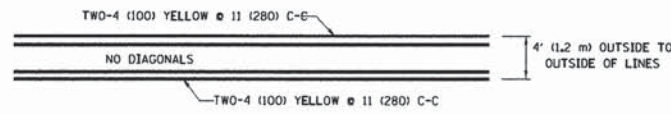

4' (1.2 m) WIDE MEDIANS ONLY

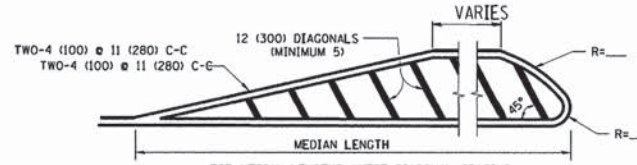

MEDIANS OVER 4' (1.2 m) WIDE

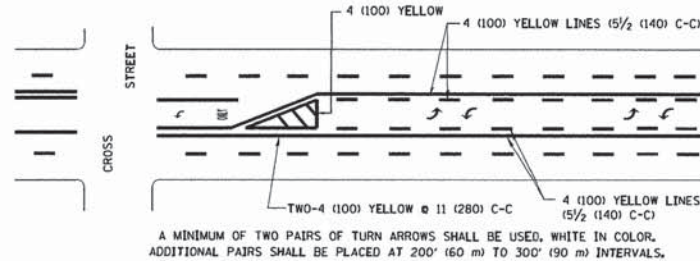

TYPICAL PAINTED MEDIAN MARKING

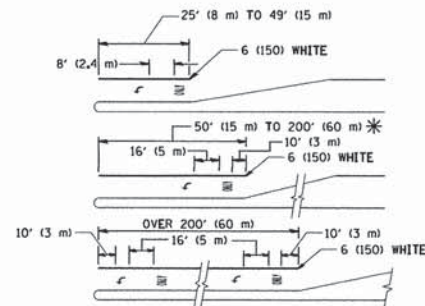

TYPICAL LEFT (OR RIGHT) TURN LANE

TYPICAL TURN LANE MARKING

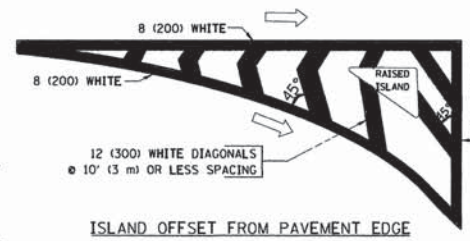

ISLAND OFFSET FROM PAVEMENT EDGE

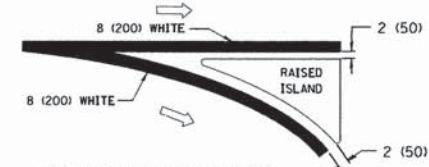

ISLAND AT PAVEMENT EDGE

TYPICAL ISLAND MARKING

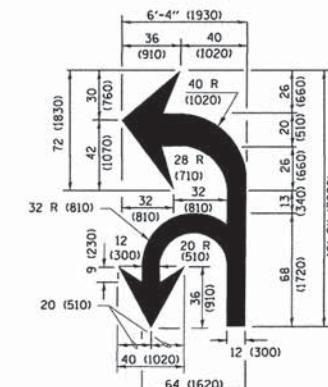

COMBINATION LEFT AND U-TURN

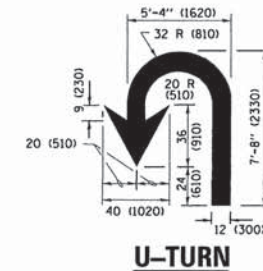

U-TURN

LANE REDUCTION TRANSITION

* LANE REDUCTION ARROWS REQUIRED AT SPEEDS OF 45 MPH OR GREATER OR WHEN SPECIFIED IN PLANS.

D(FT)	SPEED LIMIT
345	30
425	35
500	40
580	45
665	50
750	55

TYPE OF MARKING	WIDTH OF LINE	PATTERN	COLOR	SPACING /REMARKS
CENTERLINE ON 2 LANE PAVEMENT	4 (100)	SKIP-DASH	YELLOW	10' (3 m) LINE WITH 30' (9 m) SPACE
CENTERLINE ON MULTI-LANE UNDIVIDED PAVEMENT	2 @ 4 (100)	SOLID	YELLOW	11 (280) C-C
NO PASSING ZONE LINES FOR BOTH DIRECTIONS	4 (100) 2 @ 4 (100)	SOLID SOLID	YELLOW YELLOW	5 1/2 (140) C-C FROM SKIP-DASH CENTERLINE 11 (280) C-C OMIT SKIP-DASH CENTERLINE BETWEEN
LANE LINES	4 (100) 5 (125) ON FREEWAYS	SKIP-DASH SKIP-DASH	WHITE WHITE	10' (3 m) LINE WITH 30' (9 m) SPACE
DOTTED LINES (EXTENSIONS OF CENTER, LANE OR TURN LANE MARKINGS)	SAME AS LINE BEING EXTENDED	SKIP-DASH	SAME AS LINE BEING EXTENDED	2' (600) LINE WITH 6' (1.8 m) SPACE
EDGE LINES	4 (100)	SOLID	YELLOW-LEFT WHITE-RIGHT	OUTLINE MEDIANS IN YELLOW
TURN LANE MARKINGS	6 (150) LINE; FULL SIZE LETTERS & SYMBOLS 18' (2.4m)	SOLID	WHITE	SEE TYPICAL TURN LANE MARKING DETAIL
TWO WAY LEFT TURN MARKING	2 @ 4 (100) EACH DIRECTION 8' (2.4m) LEFT ARROW	SKIP-DASH AND SOLID IN PAIRS	YELLOW WHITE	10' (3 m) LINE WITH 30' (9 m) SPACE FOR SKIP-DASH; 5 1/2 (140) C-C BETWEEN SOLID LINE AND SKIP-DASH LINE SEE TYPICAL TWO-WAY LEFT TURN MARKING DETAIL
CROSSWALK LINES (PEDESTRIAN) A. DIAGONALS (BIKE & EQUESTRIAN) B. LONGITUDINAL BARS (SCHOOL)	2 @ 6 (150) 12 (300) @ 45° 12 (300) @ 90°	SOLID SOLID SOLID	WHITE WHITE WHITE	NOT LESS THAN 6' (1.8 m) APART 2' (600) APART 2' (600) APART SEE TYPICAL CROSSWALK MARKING DETAILS.
STOP LINES	24 (600)	SOLID	WHITE	PLACE 4' (1.2 m) IN ADVANCE OF AND PARALLEL TO CROSSWALK, IF PRESENT, OTHERWISE PLACE AT DESIRED STOPPING POINT, PARALLEL TO CROSSROAD CENTERLINE, WHERE POSSIBLE
PAINTED MEDIANS	2 @ 4 (100) WITH 12 (300) DIAGONALS @ 45° NO DIAGONALS USED FOR 4' (1.2 m) WIDE MEDIANS	SOLID	YELLOW; TWO WAY TRAFFIC WHITE; ONE WAY TRAFFIC	11 (280) C-C FOR THE DOUBLE LINE SEE TYPICAL PAINTED MEDIAN MARKING.
GORE MARKING AND CHANNELIZING LINES	8 (200) WITH 12 (300) DIAGONALS @ 45°	SOLID	WHITE	DIAGONALS: 15' (4.5 m) C-C (LESS THAN 30MPH (50 km/h)) 20' (6 m) C-C (30 MPH (50 km/h)) TO 45MPH (70 km/h)) 30' (9 m) C-C (OVER 45MPH (70 km/h))
RAILROAD CROSSING	24 (600) TRANSVERSE LINES; "RR" IS 6' (1.8 m) LETTERS; 16 (400) LINE FOR "X"	SOLID	WHITE	SEE STATE STANDARD 780001 AREA OF: "R"=3.6 SQ. FT. (0.33 m²) EACH "X"=54.0 SQ. FT. (5.0 m²)
SHOULDER DIAGONALS (REQUIRED FOR SHOULDERS ≥ 8')	12 (300) @ 45°	SOLID	WHITE - RIGHT YELLOW - LEFT	50' (15 m) C-C (LESS THAN 30MPH (50 km/h)) 75' (25 m) C-C (30 MPH (50 km/h)) TO 45MPH (70 km/h)) 150' (45 m) C-C (OVER 45MPH (70 km/h))
U TURN ARROW	SEE DETAIL	SOLID	WHITE	16.3 SF
2 ARROW COMBINATION LEFT AND U TURN	SEE DETAIL	SOLID	WHITE	39.4 SF

FOR FURTHER DETAILS ON PAVEMENT MARKING REFER TO STANDARD SPECIFICATIONS FOR ROAD AND BRIDGE CONSTRUCTION AND STATE STANDARD 780001.

FAP 332 All dimensions are in inches (millimeters) unless otherwise shown.
FAU 423

FILE NAME	USER NAME	DESIGNED	REVISED
pw\11084EBID\INTEG\allinois.gov\PID0T\Documents\DOT Offices\District 1\Projects\Dist 1\BRANN\CADDData\CADsheets\tcl3.dgn	lszekrf	EVERS	-T. RAMMACHER 10-27-94
		CHECKED	REVISED - C. JUCIUS 09-09-09
		DATE	REVISED - C. JUCIUS 07-01-13
			REVISED - C. JUCIUS 12-21-15

**STATE OF ILLINOIS
DEPARTMENT OF TRANSPORTATION**

DISTRICT ONE TYPICAL PAVEMENT MARKINGS			
SCALE: NONE	SHEET 1	OF 1 SHEETS	STA. TO STA.

F.A. RTE.	SECTION	COUNTY	TOTAL SHEETS	SHEET NO.
*	14-00018-00-SG	WILL	14	13
TC-13		CONTRACT NO. 61C56		
ILLINOIS FED. AID PROJ. ECTS-4009(348)				

COPYRIGHT © 2014 BY BAYTER & WOODMAN, INC.
 STATE OF ILLINOIS - PROFESSIONAL DESIGN FIRM
 1100 W. MONROE STREET, SUITE 200
 CHICAGO, IL 60606
 312.467.1234
 www.bayterandwoodman.com

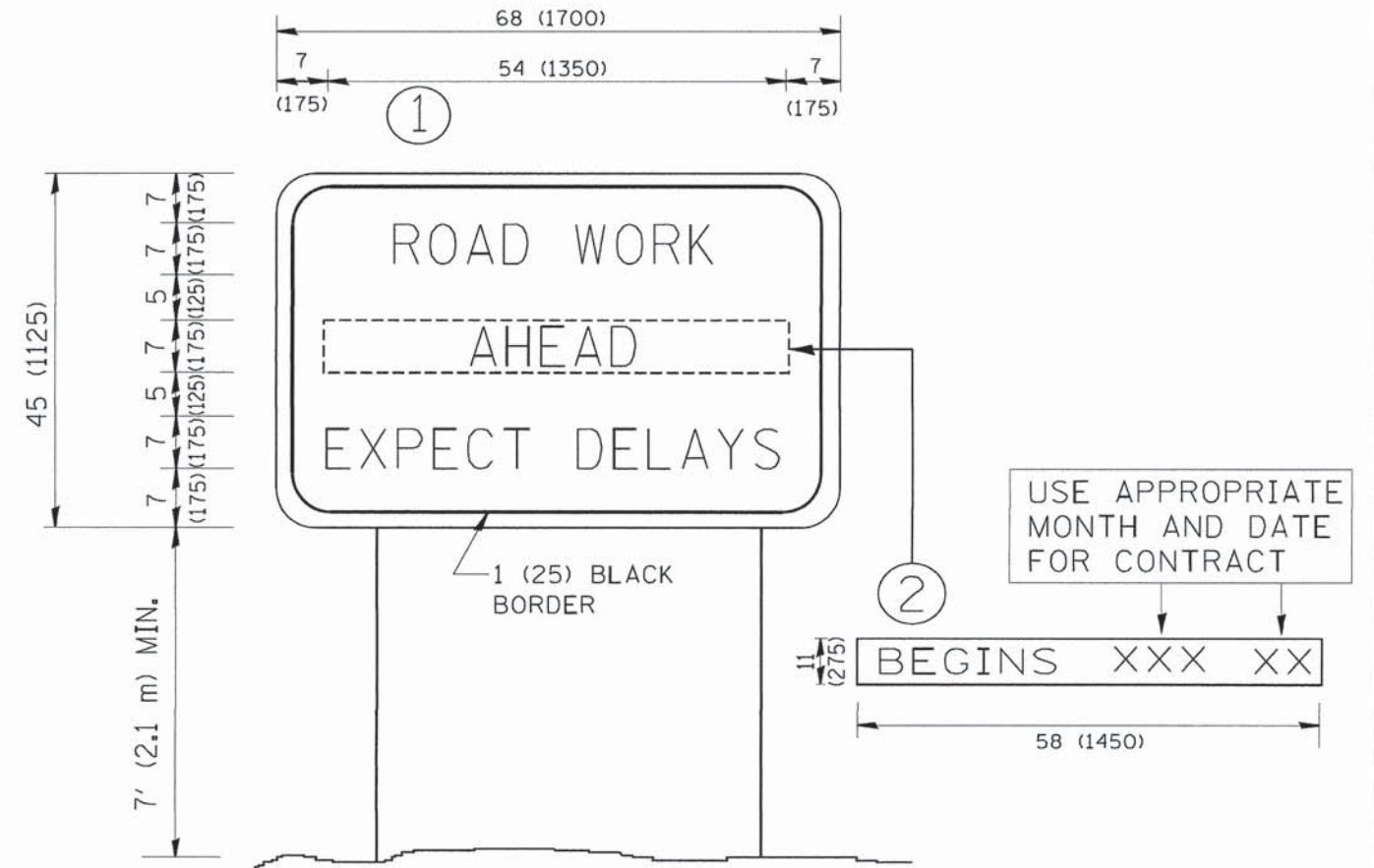

NOTES:

1. USE BLACK LETTERING ON ORANGE BACKGROUND.
2. ERECT SIGNS IN ADVANCE OF THE LOCATION FOR THE "ROAD CONSTRUCTION AHEAD" SIGN AT LOCATIONS AS DIRECTED BY THE ENGINEER.
3. ERECT SIGN ① WITH INSTALLED PANEL ② ONE WEEK PRIOR TO THE START OF CONSTRUCTION.
4. REMOVE PANEL ② SOON AFTER THE START OF CONSTRUCTION.
5. SEE SPECIAL PROVISION FOR "TEMPORARY INFORMATION SIGNING" FOR ADDITIONAL INFORMATION.
6. ONE SIGN ASSEMBLY EQUALS 25.70 SQ. FT. (2.3 SQ. M.)
7. SHALL BE PAID FOR AS TEMPORARY INFORMATION SIGNING.

ALL DIMENSIONS ARE IN INCHES (MILLIMETERS)
UNLESS OTHERWISE SHOWN.

• FAU 407
FAU 424
FAP 332
FAU 423

COPYRIGHT © 2014 BY BAYTER A. WOODMAN, INC.
 STATE OF ILLINOIS - PROFESSIONAL DESIGN FIRM
 1341 W. WASHINGTON STREET, SUITE 200
 CHICAGO, ILLINOIS 60604
 TEL: 312.226.2200
 FAX: 312.226.2201
 WWW.BAYTERWOODMAN.COM

FILE NAME = W:\diststd\22x34\tc22.dgn	USER NAME = ggglenobt	DESIGNED -	REVISED - R. MIRS 09-15-97
		DRAWN -	REVISED - R. MIRS 12-11-97
		CHECKED -	REVISED - T. RAMMACHER 02-02-99
		DATE -	REVISED - C. JUCLUS 01-31-07

**STATE OF ILLINOIS
DEPARTMENT OF TRANSPORTATION**

ARTERIAL ROAD INFORMATION SIGN			
SCALE: NONE	SHEET NO. 1 OF 1 SHEETS	STA.	TO STA.

F.A. RTE.	SECTION	COUNTY	TOTAL SHEETS	SHEET NO.
*	14-0018-00-SG	WILL	14	14
TC-22			CONTRACT NO. 61C56	
FED. ROAD DIST. NO. 1 ILLINOIS FED. AID PROJECTS-4009(348)				