

04A

PL015

TOTAL SHEETS: 5

# CONSTRUCTION PLANS

## FOR

# PINCKNEYVILLE-DU QUOIN AIRPORT

### RUNWAY - CRACK SEALING, SEAL COAT & RE-MARK RUNWAY & TAXIWAY

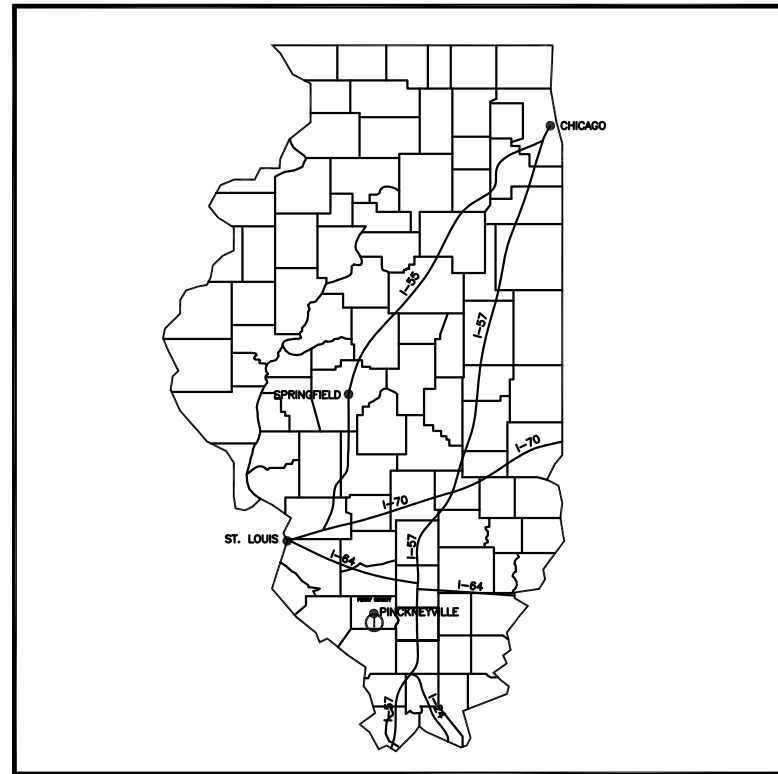

LOCATION MAP

ILLINOIS PROJECT NUMBER: PJY-4448  
 SBG PROJECT NUMBER: 3-17-SBGP-91/95

PINCKNEYVILLE, ILLINOIS

DATE: FEBRUARY 26, 2016

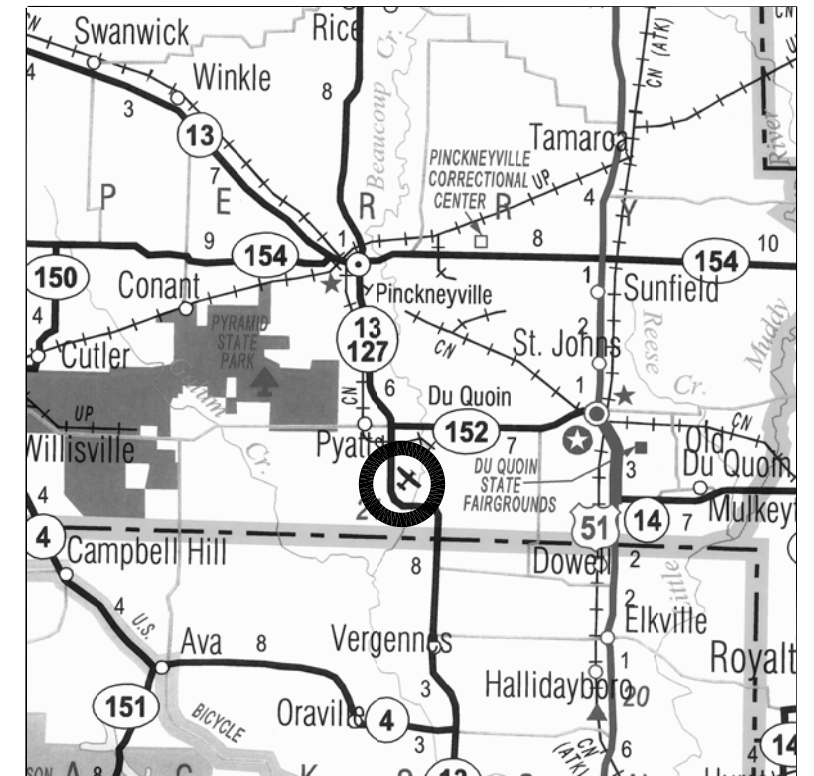
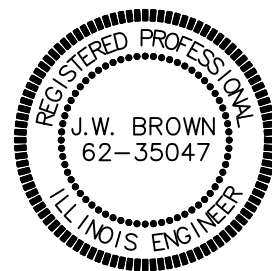

VICINITY MAP

BROWN AND ROBERTS, INC.  
 CONSULTING ENGINEER  
 PRESIDENT

SUBMITTED BY: *Jim W. Brown*  
 JIM W. BROWN, PRESIDENT

DATE SUBMITTED: 02/26/2016

LICENSE NUMBER: 062-035047  
 LICENSE EXPIRATION DATE: NOVEMBER 30, 2017

PLANS PREPARED BY:



BROWN AND ROBERTS, INC.  
 1 WESTRIDGE ROAD  
 HARRISBURG, IL. 62946  
 (618) 252-8111

PINCKNEYVILLE-DU QUOIN AIRPORT

ACTING CHAIRMAN

APPROVED BY: *Kevin Kuhnert* 2-27-16  
 KEVIN KUHNERT DATE

SECRETARY

ATTESTED BY: *Stephen Moss* 2-22-16  
 STEPHEN MOSS DATE

| INDEX OF SHEETS |   |
|-----------------|---|
| SHEET NUMBER    | DESCRIPTION                                       |
| 1               | COVER SHEET                                       |
| 2               | INDEX, SUMMARY OF QUANTITIES AND TYPICAL SECTIONS |
| 3               | RUNWAY SAFETY PLAN                                |
| 4               | RUNWAY 18-36 PLAN VIEW                            |
| 5               | TAXIWAY PLAN VIEW AND DETAILS                     |

| SUMMARY OF QUANTITIES |                                    |      |                |
|-----------------------|------------------------------------|------|----------------|
| ITEM NUMBER           | ITEM DESCRIPTION                   | UNIT | TOTAL QUANTITY |
| AR150520              | MOBILIZATION                       | L.S. | 1              |
| AR201661              | CLEAN & SEAL BITUMINOUS CRACKS     | L.F. | 8000           |
| AR608510              | EXISTING ASPHALT SURFACE TREATMENT | S.Y. | 31000          |
| AR620520              | PAVEMENT MARKING - WATERBORNE      | S.F. | 19000          |
| AR620525              | PAVEMENT MARKING - BLACK BORDER    | S.F. | 6100           |

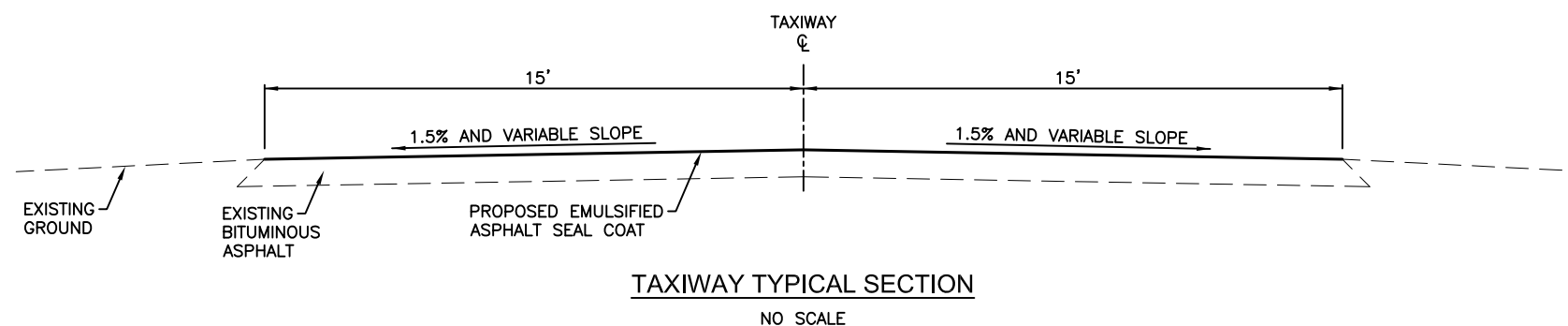
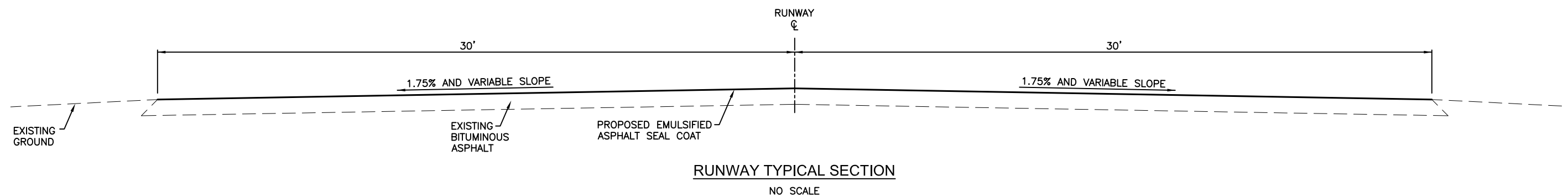

**SCOPE OF WORK**

THE PROJECT SCOPE CONSISTS OF CRACK SEALING, SEAL COATING AND RE-MARKING THE RUNWAY AND TAXIWAY, ALONG WITH OTHER NECESSARY AND RELATED WORK.

**PROPOSED SAFETY PLAN**

GENERAL - THE PINCKNEYVILLE-DU QUOIN AIRPORT CURRENTLY HAS A PAVED NORTH-SOUTH RUNWAY (4000-FT BY 60-FT).

PROJECT CONSTRUCTION SHALL BE STAGED TO MINIMIZE THE FREQUENCY OF CLOSURES OF THE EXISTING RUNWAY. ONCE THE RUNWAY IS CLOSED FOR SEAL COAT OPERATIONS, IT SHALL REMAIN CLOSED UNTIL THE RUNWAY RE-MARKING OPERATIONS HAVE BEEN COMPLETED.

**CONTRACTOR'S RESPONSIBILITIES**

IDENTIFICATION - THE CONTRACTOR'S VEHICLES AND EQUIPMENT SHALL BE PROPERLY MARKED WITH 3-FOOT SQUARE INTERNATIONAL ORANGE AND WHITE CHECKERED FLAGS ANYTIME THEY ARE ON AIRPORT PROPERTY.

THE CONTRACTOR AND HIS EMPLOYEES SHALL BE RESTRICTED TO THE WORK AREA.

EQUIPMENT PARKING AND STORAGE - THE CONTRACTOR'S EQUIPMENT PARKING, STORAGE, AND EMPLOYEE PARKING WILL BE AT THE LOCATION SHOWN ON THIS SHEET. ONLY CONTRACTOR VEHICLES AND EQUIPMENT REQUIRED FOR CONSTRUCTION WILL BE ALLOWED OUTSIDE THIS AREA.

BARRICADES AND TRAFFIC CONES - IT WILL BE THE CONTRACTOR'S RESPONSIBILITY TO PLACE AND MAINTAIN BARRICADES AND TRAFFIC CONES AS REQUIRED AND AS DIRECTED BY THE RESIDENT ENGINEER. BARRICADES, THEIR MAINTENANCE, PLACEMENT, AND REMOVAL WILL BE CONSIDERED AS AN INCIDENTAL ITEM TO THE CONTRACT AND NO ADDITIONAL COMPENSATION WILL BE ALLOWED.

THE CONTRACTOR WILL BE RESPONSIBLE FOR REPAIRING ANY DAMAGE TO EXISTING PAVEMENTS CAUSED BY HIS PERSONNEL OR EQUIPMENT.

**HAUL ROUTE AND EQUIPMENT PARKING**

THE CONTRACTOR WILL USE THE DESIGNATED HAUL ROUTE AND EQUIPMENT PARKING AREA SHOWN ON THIS SAFETY PLAN. THE PROPOSED EQUIPMENT PARKING AREA WILL BE TWO AREAS APPROXIMATELY 70-FT BY 50-FT. THE CONTRACTOR WILL BE REQUIRED TO MAINTAIN THE PROPOSED HAUL ROUTE AND PARKING AREA THROUGHOUT THE COURSE OF THE PROJECT. AT THE CONCLUSION OF THE PROJECT, ALL AREAS DISTURBED WILL BE RESTORED AS NEEDED TO ITS ORIGINAL STATE. RESTORATION OF THE HAUL ROUTE AND EQUIPMENT PARKING AREA WILL BE CONSIDERED INCIDENTAL TO THE PROJECT AND NO ADDITIONAL COMPENSATION WILL BE ALLOWED.

**UTILITY NOTE**

THE CONTRACTOR IS RESPONSIBLE FOR CONTACTING ALL UTILITY COMPANIES AND ORGANIZATIONS THAT HAVE LINES OR CONDUITS IN THE PROPOSED WORK AREA. ALL LINES AND CONDUITS SHALL BE LOCATED AND IDENTIFIED FOR DEPTH BEFORE ANY EXCAVATION BEGINS. THE CONTRACTOR SHALL CALL JULIE (1-800-892-0123) TO ACCOMPLISH THESE REQUIREMENTS. THE CONTRACTOR IS RESPONSIBLE FOR IDENTIFYING ALL NON-JULIE UTILITIES LOCATED WITHIN THE PROPOSED CONSTRUCTION LIMITS. THESE UTILITIES ARE TO BE LOCATED PRIOR TO THE START OF CONSTRUCTION.

**JULIE INFORMATION**

COUNTY.....PERRY  
 CITY.....PINCKNEYVILLE  
 TOWNSHIP/RNG.....6S/2W  
 SECTION NO.....30  
 NEAREST MAJOR ROAD INTERSECTION...IL RTE 13/127 AND IL RTE 152  
 AIRPORT ADDRESS....PINCKNEYVILLE-DU QUOIN AIRPORT  
 1352 STATE ROUTE 13/127  
 DU QUOIN, IL 62274

**AIRPORT SECURITY**

AIRPORT SECURITY WILL BE MAINTAINED AT ALL TIMES. THE PROPOSED HAUL ROUTE SHOWN ON THIS SAFETY PLAN IS THE ONLY ACCESS. CONTRACTOR EQUIPMENT AND PERSONNEL WILL BE ALLOWED TO USE. THE CONTRACTOR SHALL PROVIDE BARRICADES AT THIS ACCESS AND ENSURE THE BARRICADES ARE IN PLACE AT THE END OF EACH WORKING DAY.

**AIRCRAFT OPERATIONAL AREA**

THE CONTRACTOR, HIS EMPLOYEES, OR ANY EQUIPMENT WILL NOT PROCEED WITH ANY WORK WITHIN THE AIRCRAFT OPERATIONAL AREA WITHOUT FIRST CLOSING THE RUNWAY.

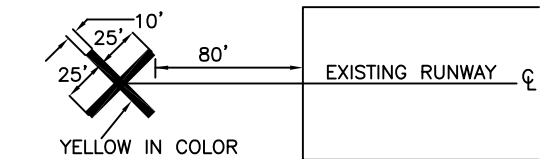

**DETAIL OF CROSS FOR CLOSED RUNWAY**  
 "NOT TO SCALE"

**NOTE:**

THE COST OF CONSTRUCTING, PLACING, MAINTAINING, AND REMOVING CROSSES WILL BE CONSIDERED INCIDENTAL TO THE CONTRACT AND NO ADDITIONAL COMPENSATION WILL BE ALLOWED. THE CROSSES WILL BE YELLOW IN COLOR AND SHALL BE MADE OF A SUITABLE MATERIAL AS APPROVED BY THE RESIDENT ENGINEER. THE CROSSES WILL BE PLACED AT THE ENDS OF THE RUNWAY AND SECURED IN A MANNER APPROVED BY THE RESIDENT ENGINEER. THE PROPOSED CROSSES WILL BE PLACED WHEN THE RUNWAY IS CLOSED AND REMOVED WHEN THE RUNWAY IS RE-OPENED. THE CONTRACTOR WILL BE RESPONSIBLE FOR THE PLACEMENT AND REMOVAL OF THE CROSSES AT NO ADDITIONAL COST TO THE CONTRACT.

**RUNWAY CLOSURE PROCEDURES:**

- \* CONTACT THE AIRPORT MANAGER OR HIS ASSIGNED REPRESENTATIVE.
- \* ISSUANCE OF NOTAM BY THE AIRPORT MANAGER OR HIS ASSIGNED REPRESENTATIVE.
- \* PLACEMENT OF CROSSES (SEE DETAIL THIS SHEET).
- \* PLACEMENT OF LIGHTED BARRICADES. ONLY AT THE TIME THAT ALL OF THE ABOVE ARE COMPLETED MAY ANY CONSTRUCTION OPERATIONS WITHIN 200-FT OF THE AFFECTED RUNWAY CENTERLINE AND WITHIN 600 FT OF THE RUNWAY END BEGIN.
- \* RUNWAY LIGHTS SHALL BE DISABLED

**RUNWAY RE-OPENING PROCEDURES:**

- \* REMOVE CROSSES.
- \* REMOVE LIGHTED BARRICADES.
- \* NOTIFY THE AIRPORT MANAGER OR HIS REPRESENTATIVE TO CANCEL THE NOTAM.
- \* CANCELLATION OF THE NOTAM. A CLOSED RUNWAY WILL NOT BE RE-OPENED UNTIL ALL EQUIPMENT AND WORK ARE FURTHER THAN 200 FT. FROM THE AFFECTED RUNWAY CENTERLINE
- \* RUNWAY LIGHTS SHALL BE REACTIVATED.

**HEIGHT OF CONSTRUCTION EQUIPMENT**

THE MAXIMUM ANTICIPATED HEIGHT OF THE CONSTRUCTION EQUIPMENT IS 20 FEET. THE TALLEST EQUIPMENT IS EXPECTED TO BE A SEMI-TRUCK WITH TRAILER IN THE UP POSITION.

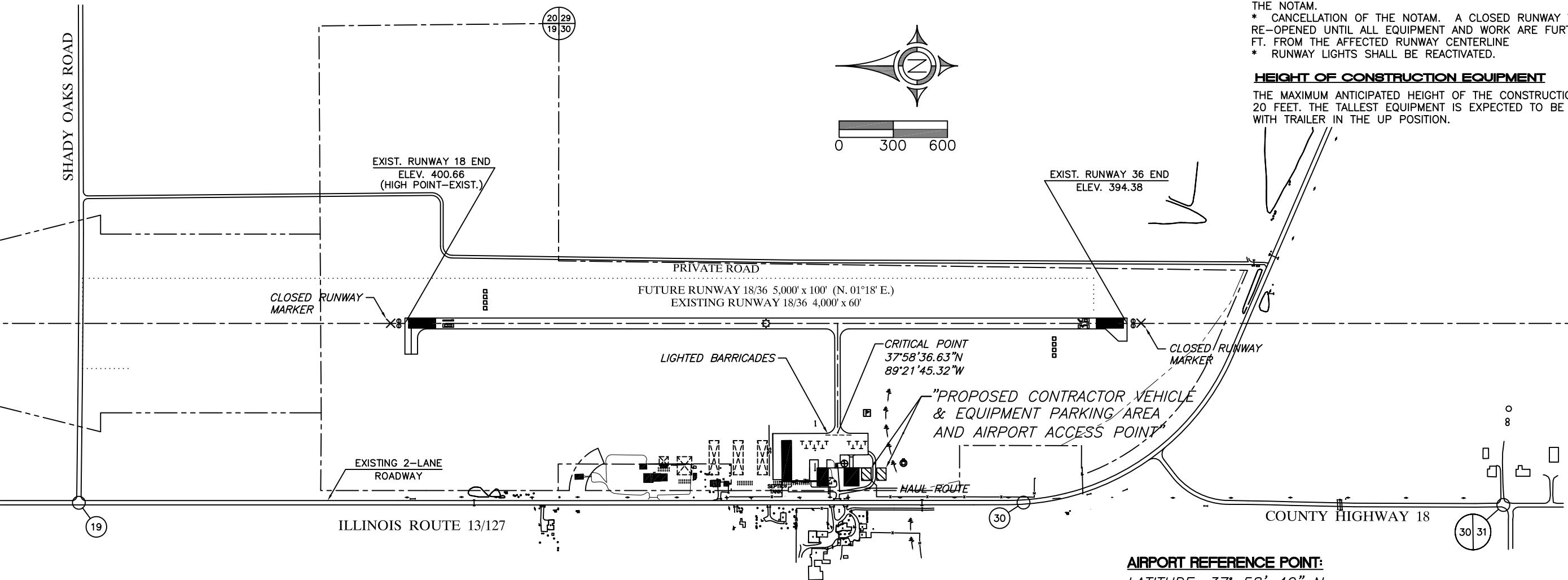

**AIRPORT REFERENCE POINT:**

LATITUDE: 37° 58' 40" N  
 LONGITUDE: 89° 21' 38" W  
 ELEVATION: 401 MSL

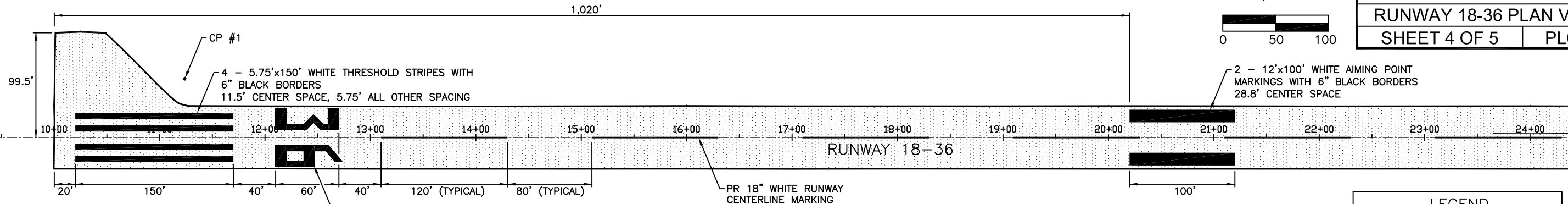
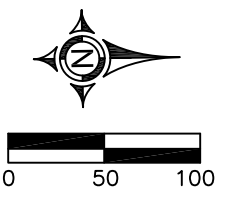

BENCHMARK AND CONTROL POINT #1  
 STA 11+23.76, 55.67' LT  
 N: 476543.27, E: 2528883.80  
 ELEV = 391.85  
 NGS MONUMENT

**LEGEND**

PROPOSED EMULSIFIED ASPHALT SEAL COAT

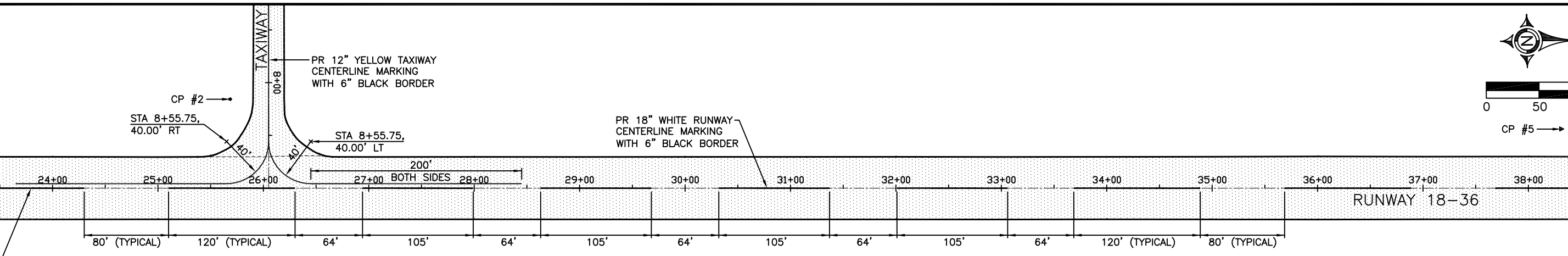

CP #2  
 STA 8+55.75, 40.00' RT

BENCHMARK AND CONTROL POINT #2  
 STA 25+68.71, 84.36' LT  
 N: 477988.48, E: 2528875.55  
 ELEV = 391.64  
 NGS MONUMENT

BENCHMARK AND CONTROL POINT #5  
 STA 38+30.92, 56.00' LT  
 N: 479250.17, E: 2528921.77  
 ELEV = 392.30  
 IRON PIN WITH CAP

3' SEPARATION EDGE TO EDGE BETWEEN TAXIWAY AND RUNWAY CENTERLINES

26 Feb 2016 - 7:30am X:\2015\15096\ac\15096 Base.dwg: Layout Tab '04 PLAN'

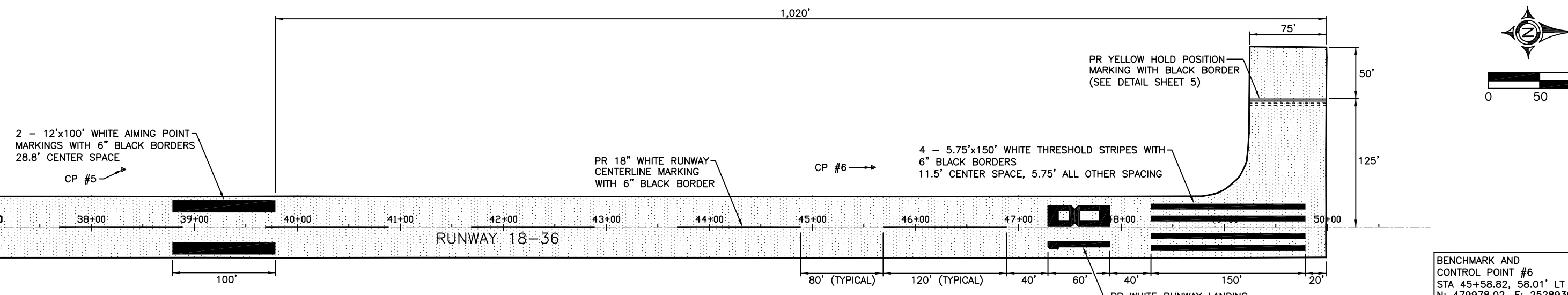

2 - 12'x100' WHITE AIMING POINT MARKINGS WITH 6" BLACK BORDERS 28.8' CENTER SPACE  
 CP #5

BENCHMARK AND CONTROL POINT #6  
 STA 45+58.82, 58.01' LT  
 N: 479978.02, E: 2528930.06  
 ELEV = 395.25  
 IRON PIN WITH CAP



**LEGEND**

PROPOSED EMULSIFIED ASPHALT SEAL COAT

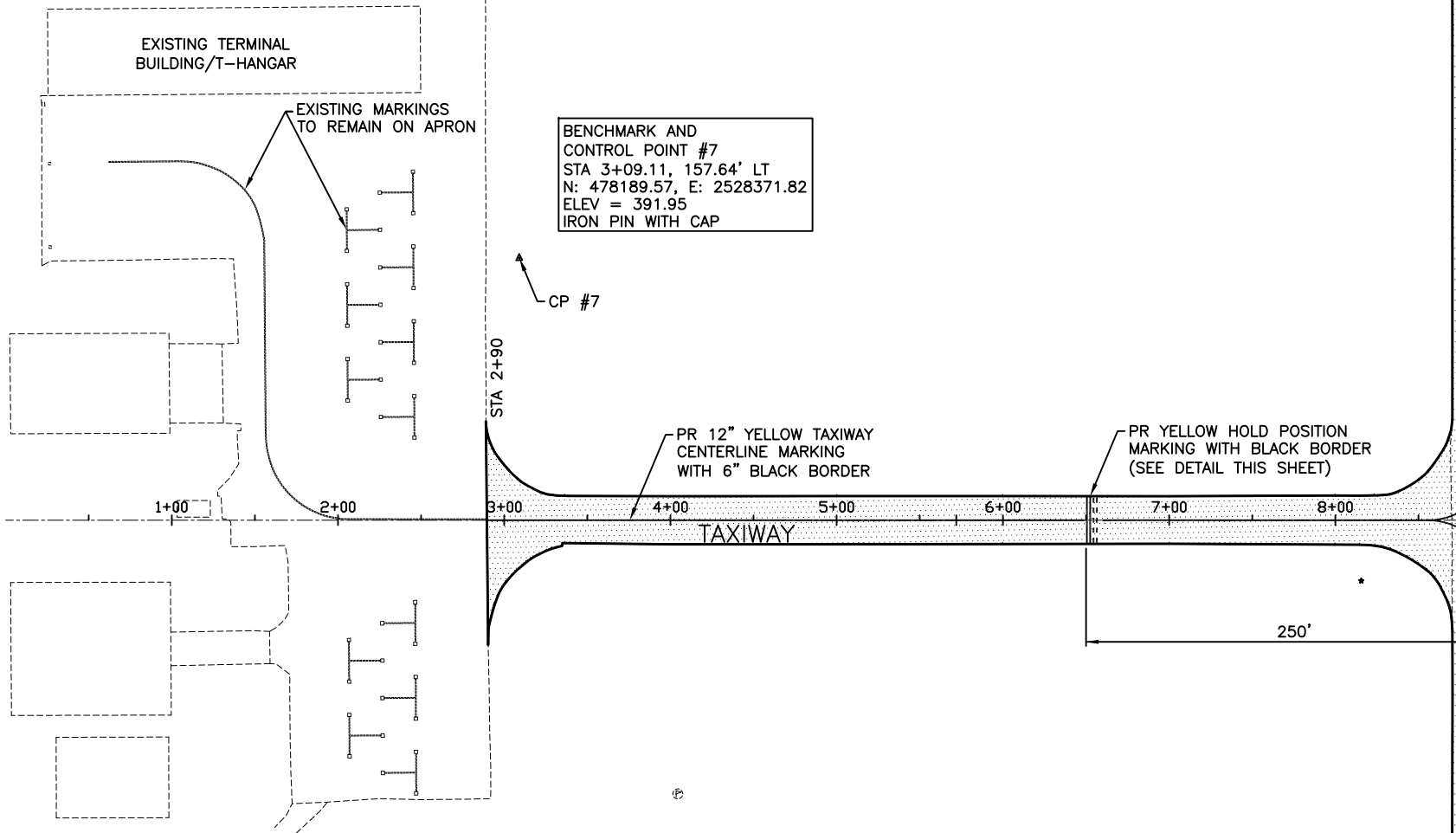

BENCHMARK AND CONTROL POINT #7  
 STA 3+09.11, 157.64' LT  
 N: 478189.57, E: 2528371.82  
 ELEV = 391.95  
 IRON PIN WITH CAP

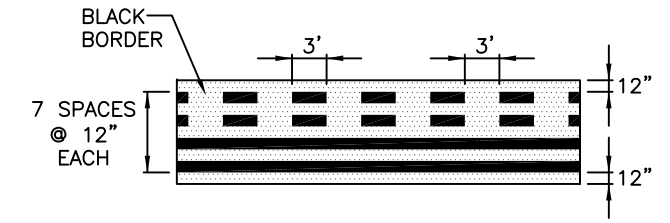

HOLD POSITION MARKING DETAIL  
 NORTH TURNAROUND  
 N.T.S.

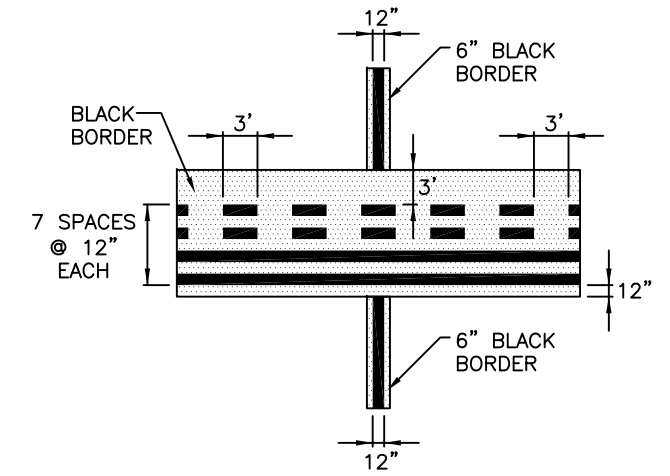

HOLD POSITION MARKING DETAIL  
 TAXIWAY  
 N.T.S.

NOTE:  
 RUNWAY DESIGNATION NUMERALS  
 TO HAVE 6" BLACK BORDERS.

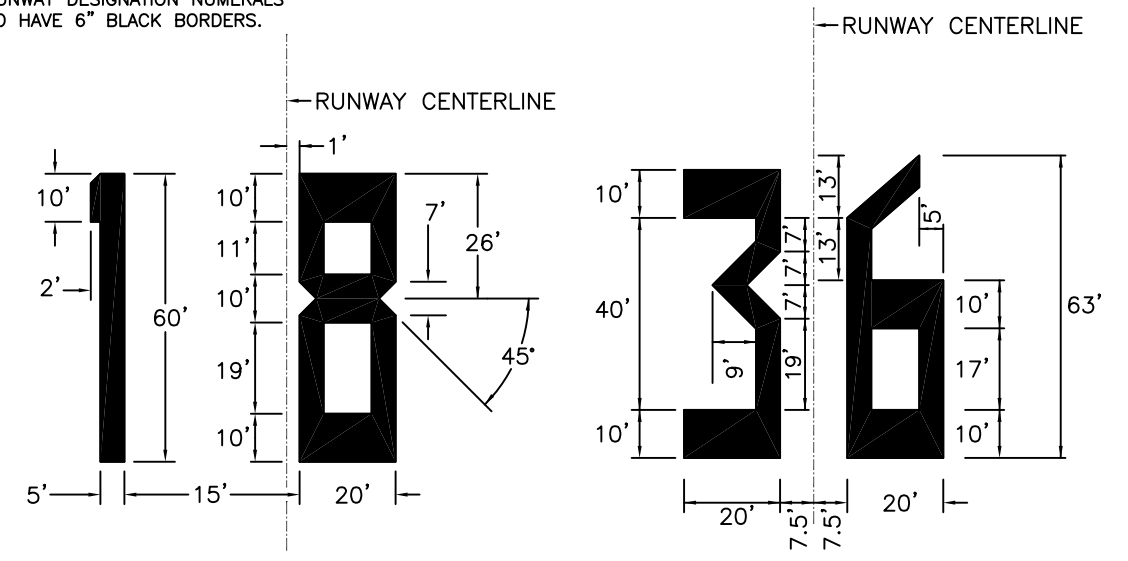

RUNWAY DESIGNATION NUMERALS  
 N.T.S.

| PAVEMENT MARKING - WATERBORNE SCHEDULE |                   |           |               |
|--|-------------------|-----------|---------------|
| DESCRIPTION                            | UNIT AREA (SQ FT) | NO. REQ'D | TOTAL (SQ FT) |
| NUMERAL 1                              | 318               | 1         | 318           |
| NUMERAL 8                              | 876               | 1         | 876           |
| NUMERAL 3                              | 633               | 1         | 633           |
| NUMERAL 6                              | 712               | 1         | 712           |
| 5.75' x 150' STRIPE                    | 863               | 8         | 6904          |
| 12' x 100' STRIPE                      | 1200              | 4         | 4800          |
| CENTERLINE STRIPE - 120'               | 180               | 14        | 2520          |
| CENTERLINE STRIPE - 105'               | 157.5             | 4         | 630           |
| TOTAL WHITE                            |                   |           | 17393         |
|  |                   |           |               |
| HOLD POSITION MARKING - RNWY 18        | 228               | 1         | 228           |
| HOLD POSITION MARKING - TAXIWAY        | 96                | 1         | 96            |
| TAXIWAY CENTERLINE                     | 1085              | 1         | 1085          |
| TOTAL YELLOW                           |                   |           | 1409          |
| TOTAL WATERBORNE                       |                   |           | 18802         |

| PAVEMENT MARKING - BLACK BORDER SCHEDULE |                   |           |               |
|--|-------------------|-----------|---------------|
| DESCRIPTION                              | UNIT AREA (SQ FT) | NO. REQ'D | TOTAL (SQ FT) |
| NUMERAL 1                                | 68                | 1         | 68            |
| NUMERAL 8                                | 133               | 1         | 133           |
| NUMERAL 3                                | 103               | 1         | 103           |
| NUMERAL 6                                | 114               | 1         | 114           |
| 5.75' x 150' STRIPE                      | 157               | 8         | 1256          |
| 12' x 100' STRIPE                        | 113               | 4         | 452           |
| CENTERLINE STRIPE - 120'                 | 123               | 14        | 1722          |
| CENTERLINE STRIPE - 105'                 | 108               | 4         | 432           |
| HOLD POSITION MARKING - RNWY 18          | 447               | 1         | 447           |
| HOLD POSITION MARKING - TAXIWAY          | 234               | 1         | 234           |
| TAXIWAY CENTERLINE                       | 1085              | 1         | 1085          |
| TOTAL BLACK BORDER                       |                   |           | 6046          |