



HANSON PROFESSIONAL SERVICES INC.

815 Commerce Drive Suite 200
Oak Brook, Illinois 60523
Telephone: 630.990.3800
Fax: 630.990.3801



CITY OF DIXON, ILLINOIS

Post Office Box 386
Dixon, Illinois 61021
Telephone: 815.288.1485

DIXON MUNICIPAL AIRPORT
CHARLES F. WALGREEN FIELD
OVERLAY RUNWAY 8-26,
REHABILITATE HANGAR PAVEMENTS

AIP PROJECT NO. 3-17-0036-B5
IDA PROJECT NO. C73-3313

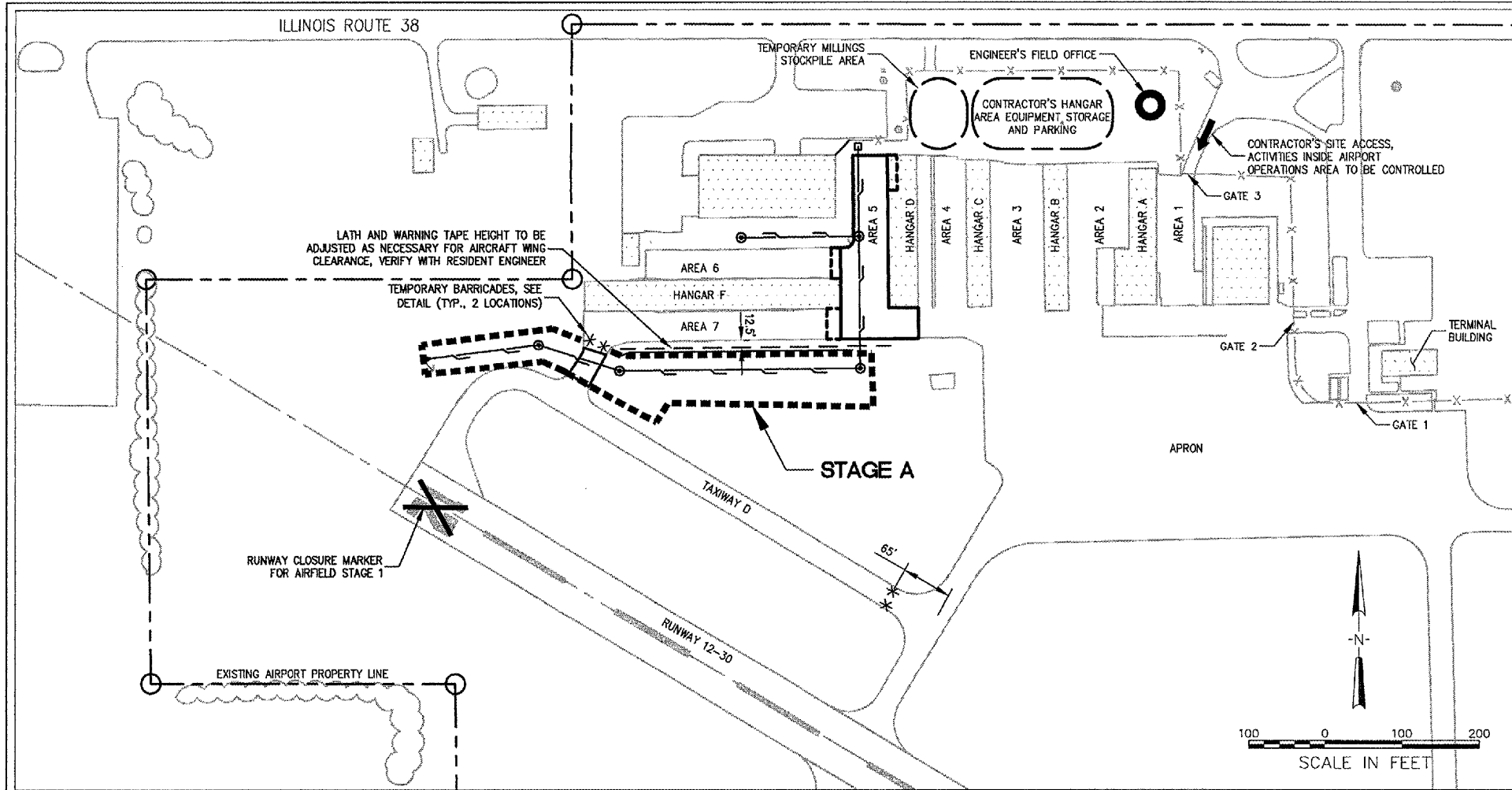

HANGAR STAGE A

NOTES:

- STAGE A TO BE COMPLETED CONCURRENTLY WITH AIRFIELD STAGE 1.
- ALL CONTRACTOR'S ACTIVITIES SHALL BE LIMITED TO THE STAGE A AREA AS SHOWN.
- ALL CONSTRUCTION EQUIPMENT WILL BE LIMITED TO A HEIGHT OF 25 FEET UNLESS PRIOR APPROVAL GIVEN BY THE ENGINEER.
- SEE CONSTRUCTION AND SAFETY NOTES, SHEET 3.

THE FOLLOWING ITEMS ARE TO BE COMPLETED IN STAGE A:

- PROVIDE CONTRACTOR'S EQUIPMENT STORAGE AND PARKING AREA.
- PROVIDE LATH AND WARNING TAPE AND TEMPORARY BARRICADES AS SHOWN.
- INSTALL TEMPORARY SOIL EROSION CONTROL MEASURES AS REQUIRED.
- INSTALL STORM SEWER PIPE AND DRAINAGE STRUCTURES WITHIN STAGE A LIMITS.
- CONSTRUCT BITUMINOUS PAVEMENT PATCHES WITHIN STAGE A LIMITS - BINDER AND TEMPORARY TAPERS ONLY.
- REGRADE SWALES WHERE NECESSARY WITHIN STAGE A LIMITS.
- TOPSOIL, SOD, SEED AND MULCH WITHIN STAGE A LIMITS.

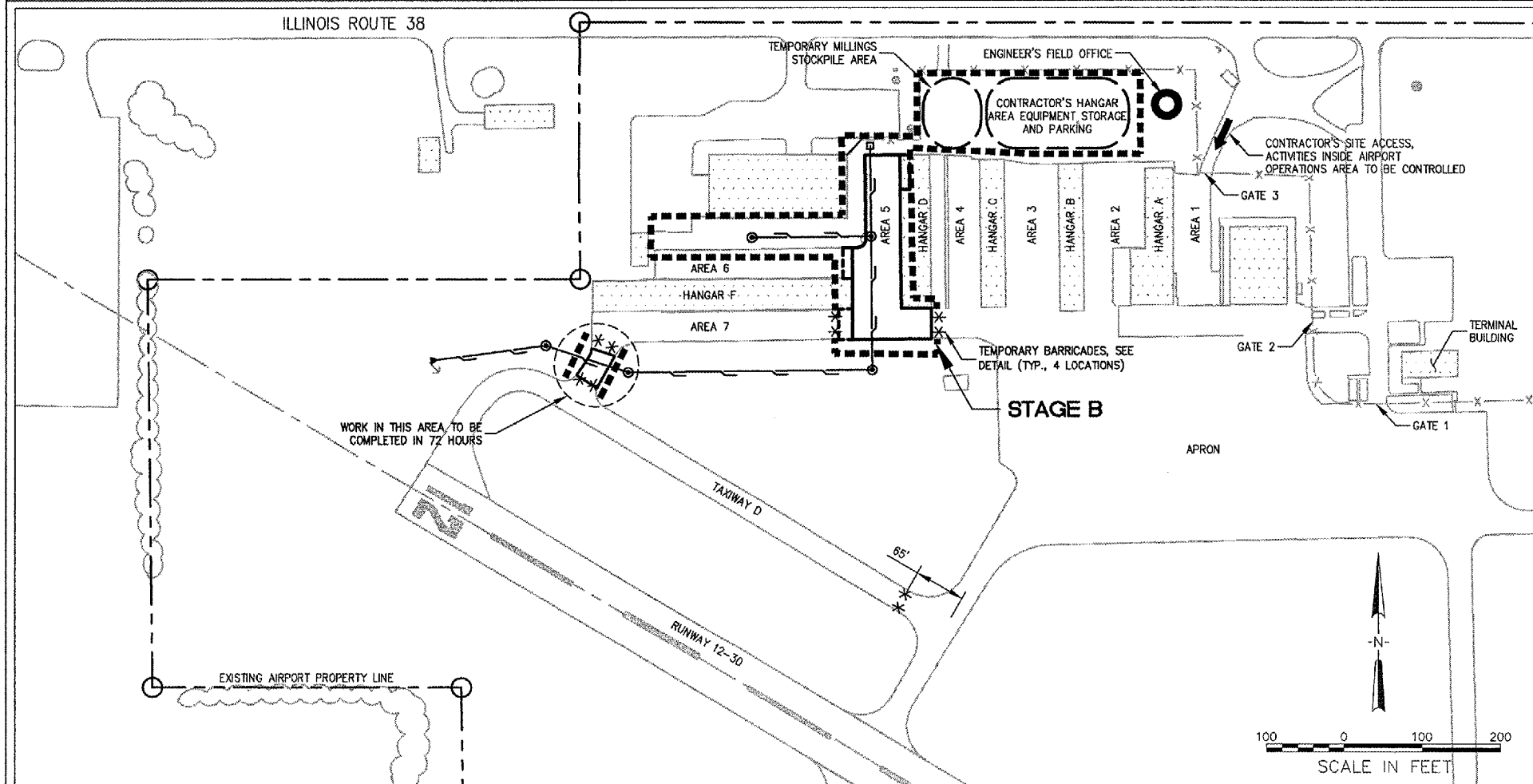

HANGAR STAGE B

NOTES:

- STAGE B TO BEGIN UPON SUBSTANTIAL COMPLETION STAGE A.
- ALL CONTRACTOR'S ACTIVITIES SHALL BE LIMITED TO THE STAGE B AREA AS SHOWN.
- ALL CONSTRUCTION EQUIPMENT WILL BE LIMITED TO A HEIGHT OF 25 FEET UNLESS PRIOR APPROVAL GIVEN BY THE ENGINEER.
- SEE CONSTRUCTION AND SAFETY NOTES, SHEET 3.

THE FOLLOWING ITEMS ARE TO BE COMPLETED IN STAGE B:

- PROVIDE TEMPORARY BARRICADES AS SHOWN.
- INSTALL TEMPORARY SOIL EROSION CONTROL MEASURES AS REQUIRED.
- MILL EXISTING PCC PAVEMENT AND UNDERCUT.
- INSTALL STORM SEWER PIPE AND DRAINAGE STRUCTURES WITHIN STAGE B LIMITS.
- INSTALL GEOTEXTILE FABRIC OVER SUBGRADE.
- PLACE DRAINAGE LAYER, PAVEMENT MILLINGS AND AGGREGATE BASE.
- INSTALL UNDERDRAINS AND TRENCH DRAINS.
- CONSTRUCT BITUMINOUS PAVEMENT.
- REMOVE TEMPORARY WEDGES AND PLACE BITUMINOUS SURFACE COURSE ON STAGE A BITUMINOUS PATCH. TAXIWAY D CLOSURE TO BE LIMITED TO 72 HOURS.
- REGRADE SHOULDERS AND SWALES WHERE NECESSARY WITHIN STAGE B LIMITS.
- TOPSOIL, SOD, SEED AND MULCH WITHIN STAGE B LIMITS.
- CLEAN UP ANY REMAINING MATERIALS AND DEBRIS AND SWEEP PAVEMENT PRIOR TO REOPENING PAVEMENT.
- REMOVE TEMPORARY BARRICADES AND SOIL EROSION CONTROL MEASURES WHEN POSSIBLE.

No.	Drawing Issue Description	Date	By

Date
12 MARCH 2004
Sheet Title

HANGAR CONSTRUCTION STAGING PLAN

84303B8004/C8005

Project Number	
TMM	01/30/04
Layout By	Date
TMM	01/30/04
Designed By	Date
RMH	03/05/04
Reviewed By	Date
KLK	
Drawn By	

52 of 68

03.005 100643 10.BRODIE [DRAWINGS] [SHEETS] [52-STAGING.DWG] MAR 12, 2004 8:46AM RJT