

Structure Number	Station	Truss Type	Design Length (L)	Number of Panels Per Unit	Panel Length (P)*
5 C 092 S001 L027.29	3046+27	II-C-A	24'-0"	6	3'-8"
5 C 092 S001 R027.13	3052+73	II-C-A	25'-0"	6	3'-10"
5 C 092 S001 L027.09	3056+65	II-C-A	26'-0"	6	4'-0"

**TYPICAL TRUSS UNIT**  
For Section B-B and Section C-C, see Base Sheet OSC-A-3.

Note: There are twice as many horizontal diagonals as there are vertical diagonals.

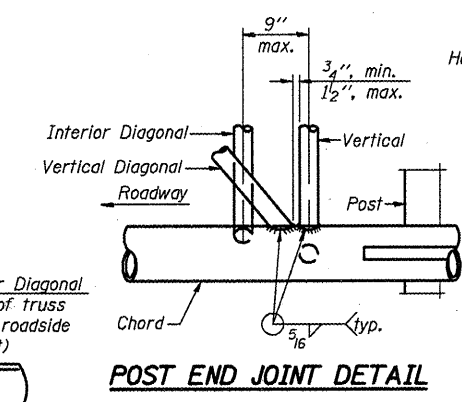

**SHOP CAMBER TABLE**

Unit Length (L)	Shop Camber at End
15'	1 1/2"
16'-17'	1 3/4"
18'-20'	2"
21'-22'	2 1/4"
23'-25'	2 1/2"
26'-27'	2 3/4"
28'-30'	3"
31'-32'	3 1/4"
33'-35'	3 1/2"
36'-37'	4"
38'-40'	4 1/2"

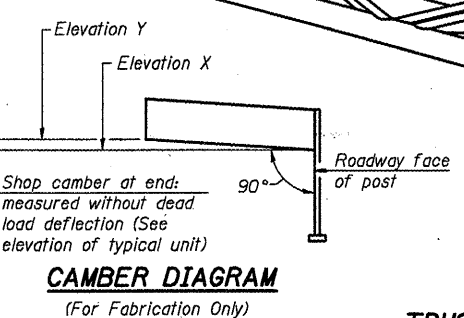

**ISOMETRIC VIEW TYPICAL TRUSS UNIT**  
ASTM B221 Alloy 6061 Temper T6

**TRUSS UNIT TABLE**

Truss Type	Dimension "a"	Dimension "b"	Dimension "s"	Limits for Panel Spacing (P)*	Up. & Low. Chord			Verticals, Horizontals, Vertical, Horizontal, and Interior Diagonals	
					O.D.	Wall	O.D.	Wall	
I-C-A	24"	54"	16"	36" min. to 48" max.	5"	5/16"	2 1/2"	5/16"	
II-C-A	36"	66"	21"	42" min. to 54" max.	6 1/2"	5/16"	3 1/4"	5/16"	
III-C-A (35' Max.)	36"	84"	21"	48" min. to 66" max.	7"	3/8"	3 1/2"	3/8"	
III-C-A (>35' to 40')	36"	84"	21"	48" min. to 66" max.	8"	3/8"	3 1/2"	3/8"	

\*P =  $\frac{L-s-3"}{\# \text{ Panels}}$

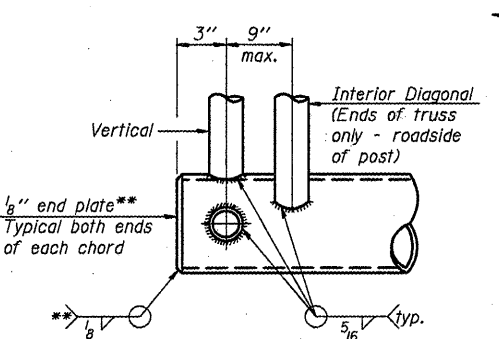

**CANTILEVER END JOINT DETAIL**  
\*\* Contractor may alternatively use standard aluminum drive-fit cap to close ends.

OSC-A-2

12-1-08

FILE NAME	USER NAME	DESIGNED	REVISION
ca:\pw\work\PW\DDT\CEARLOCKJD\d0180151\	cearlockjd	-	-
#6118-shr-deta11a.dgn		DRAWN	REVISION
PLOT SCALE = 40.0000' / IN.		CHECKED	REVISION
PLOT DATE = 1/21/2010		DATE	REVISION

STATE OF ILLINOIS  
DEPARTMENT OF TRANSPORTATION

CANTILEVER SIGN STRUCTURES TRUSS DETAILS  
ALUMINUM TRUSS & STEEL POST

SCALE: SHEET NO. OF SHEETS STA. TO STA.

F.A. RTE.	SECTION	COUNTY	TOTAL SHEETS	SHEET NO.
D-5	OSS REPL 2010-46	Various	77	56
Various			CONTRACT NO. 46110	
ILLINOIS FED. AID PROJECT				