

F.A.U. RTE.	SECTION	COUNTY	TOTAL SHEETS	SHEET NO.
1376	(136,464EXT&0506) RS-6	COOK	27	1
FED. ROAD DIST. NO. 1	ILLINOIS	CONTRACT NO. 60F67		

STATE OF ILLINOIS
DEPARTMENT OF TRANSPORTATION
DIVISION OF HIGHWAYS

D-91-211-09



FOR INDEX OF SHEETS, SEE SHEET NO. 2

IMPROVEMENT LOCATED
IN THE VILLAGES OF FRANKLIN
PARK, RIVER GROVE, &
ELMWOOD PARK

**PROPOSED
HIGHWAY PLANS**
FAU ROUTE 1376: GRAND AVE
ELM STREET TO HARLEM AVENUE
SECTION (136,464EXT&0506) RS-6
PROJECT NO.: - -
RESURFACING (3P)
COOK COUNTY
C-91-211-09

2007 ADT = 20,000 VEHICLES PER DAY
SPEED LIMIT = 30 MPH

OMISSIONS
STA 25+17.00 TO STA 28+73.00
STA 53+54.00 TO STA 55+16.00
STA 99+41.00 TO STA. 104+91.00

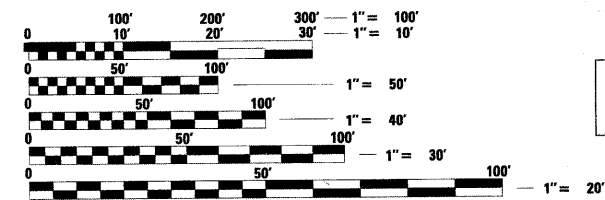

**IMPROVEMENT BEGINS
STA 10+00**

FULL SIZE PLANS HAVE BEEN PREPARED USING STANDARD
ENGINEERING SCALES. REDUCED SIZED PLANS WILL NOT
CONFORM TO STANDARD SCALES. IN MAKING MEASUREMENTS
ON REDUCED PLANS, THE ABOVE SCALES MAY BE USED.

J.U.L.I.E.
JOINT UTILITY LOCATION INFORMATION FOR EXCAVATION
1-800-892-0123
OR 811

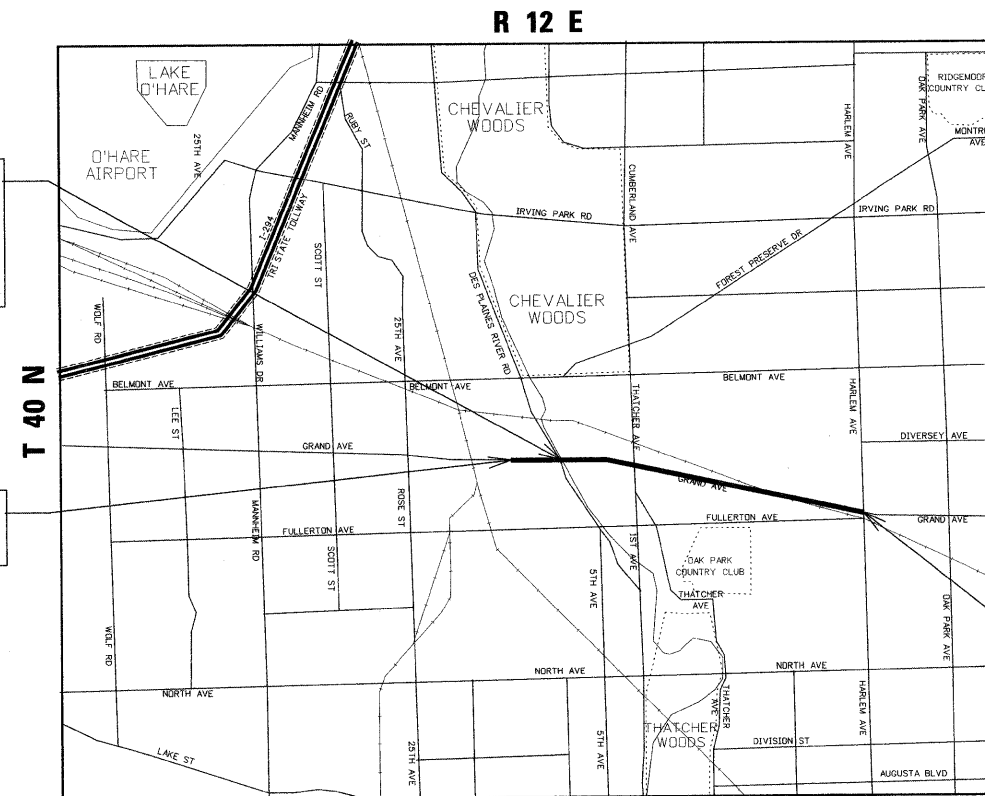

LEYDEN TOWNSHIP
LOCATION MAP

NOT TO SCALE

GROSS LENGTH OF PROJECT = 12707 FT. = 2.41 MILE
NET LENGTH OF PROJECT = 11952 FT. = 2.26 MILE
FINAL PLANS

PROJECT ENGINEER: MICHELLE AQUINO (847) 705-4606
PROJECT MANAGER: RAJENDRA SHAH (847) 705-4555

CONTRACT NO. 60F67

**IMPROVEMENT ENDS
137+06.73**

STATE OF ILLINOIS
DEPARTMENT OF TRANSPORTATION
DIVISION OF HIGHWAYS

SUBMITTED MARCH 18, 2010
Diana M. O'Keefe
DEPUTY DIRECTOR OF HIGHWAYS, REGION ENGINEER

March 19, 2010
Scott E. Still, P.E.
Acting ENGINEER OF DESIGN AND ENVIRONMENT

March 19, 2010
Christine M. Reed
DIRECTOR OF HIGHWAYS, CHIEF ENGINEER



rjngroup
Excellence through Ownership
200 West Front Street
Wheaton, IL 60187

**PRINTED BY THE AUTHORITY
OF THE STATE OF ILLINOIS**