

LEGEND

- ① THERMOPLASTIC PAVEMENT MARKING
4" YELLOW EDGE LINE
- ② THERMOPLASTIC PAVEMENT MARKING
4" WHITE EDGE LINE
- ③ THERMOPLASTIC PAVEMENT MARKING
8" WHITE GORE LINE
- ④ THERMOPLASTIC PAVEMENT MARKING
12" WHITE DIAGONALS LINE
- ⑤ PREFORMED PLASTIC PAVEMENT MARKING,
TYPE B 5" INLAID WHITE (10' LINE @ 30' SPACE)
- ⑥ THERMOPLASTIC PAVEMENT MARKING
12" WHITE CHEVRON (TYP.)
- ⑦ THERMOPLASTIC PAVEMENT MARKING
8" WHITE DOTTED (3' LINE @ 9' SPACE)
- ⑧ THERMOPLASTIC PAVEMENT MARKING
4" WHITE SKIPS (2' LINE @ 6' SPACE)
- ⑨ THERMOPLASTIC PAVEMENT MARKING
6" WHITE LINE
- ⑩ THERMOPLASTIC PAVEMENT MARKING
24" WHITE STOP BAR
- ⑪ THERMOPLASTIC PAVEMENT MARKING
LETTERS & SYMBOLS
- ⑫ POLYUREA PAVEMENT MARKING TYPE I - LINE 4" EDGE LINE
(ON CONCRETE PAVEMENT ONLY)
- ⑬ POLYUREA PAVEMENT MARKING TYPE I - LINE 5" LANE SKIPS
(10' LINE @ 30' SPACE), ON CONCRETE PAVEMENT ONLY
- ⑭ POLYUREA PAVEMENT MARKING TYPE I - LINE 4" SKIPS
(2' LINE @ 6' SPACE), ON CONCRETE PAVEMENT ONLY
- ⑮ POLYUREA PAVEMENT MARKING TYPE I - LINE 8" LINE
(ON CONCRETE PAVEMENT ONLY)
- ⑯ POLYUREA PAVEMENT MARKING TYPE I - LINE 8" DOTTED
(3' LINE @ 9' SPACE), ON CONCRETE PAVEMENT ONLY

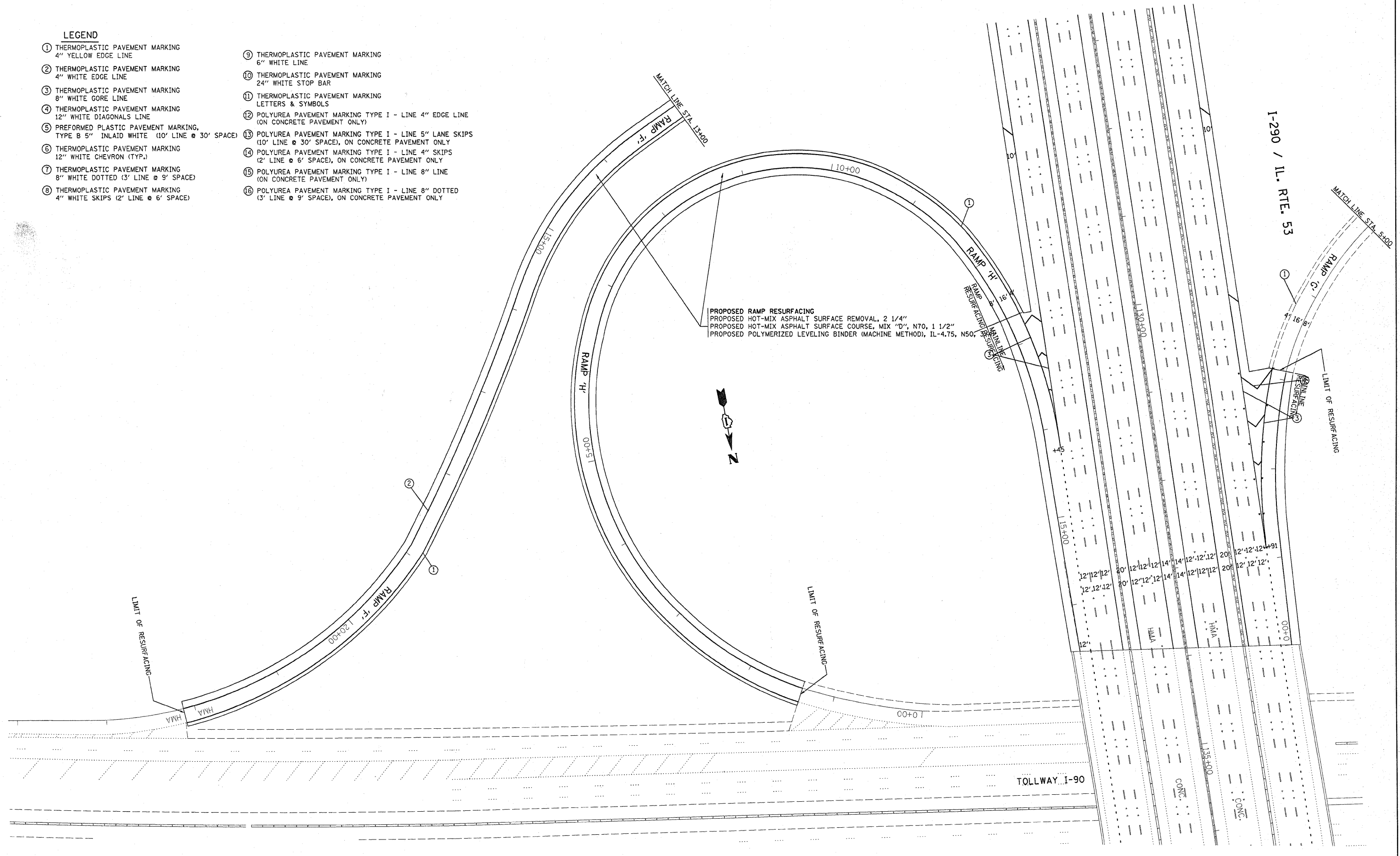

PROPOSED RAMP RESURFACING
 PROPOSED HOT-MIX ASPHALT SURFACE REMOVAL, 2 1/4"
 PROPOSED HOT-MIX ASPHALT SURFACE COURSE, MIX "D", N70, 1 1/2"
 PROPOSED POLYMERIZED LEVELING BINDER (MACHINE METHOD), IL-4.75, N50,

FILE NAME =	USER NAME = abroush	DESIGNED -	REVISED -	STATE OF ILLINOIS DEPARTMENT OF TRANSPORTATION	ROADWAY AND PAVEMENT MARKING PLAN I-290 / ILL 53 FROM ILL 72 TO US 12	F.A.I. RTE:	SECTION	COUNTY	TOTAL SHEETS	SHEET NO.	
cr\pw\work\PW100T\ABREU\H\0166688\0183310-sht-plan.dgn	PLOT SCALE = 50.0000' / IN.	DRAWN -	REVISED -			290	(531-3.1, 0305-302 K)	COOK	314	36	
PLOT DATE = 2/8/2010	DATE -	CHECKED -	REVISED -			CONTRACT NO. 60138					
						ILLINOIS FED. AID PROJECT					