

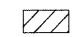

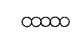
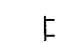

**LEGEND**

-  WORK AREA
-  IMPACT ATTENUATORS, TEMPORARY (FULLY REDIRECTIVE, NARROW), TEST LEVEL 3
-  TYPE III BARRICADE
-  TEMPORARY CONCRETE BARRIER
-  DRUM WITH STEADY BURN MONODIRECTIONAL LIGHT / DIRECTION INDICATOR BARRICADE WITH STEADY BURN MONODIRECTIONAL LIGHT (PER HWY. STD. 701401-05)
-  SIGN

**STAGING NOTES:**

1. REMOVE EXISTING SHOULDER RUMBLE STRIPS, CONFLICTING EXISTING PAVEMENT MARKINGS, AND EXISTING RAISED REFLECTIVE PAVEMENT MARKER LENSES, AND PLACE TEMPORARY PAVEMENT MARKINGS IN ACCORDANCE WITH HIGHWAY STANDARD 701411-05 AND AS SHOWN BELOW.
2. TEMPORARY TRAFFIC CONFIGURATION TO REMAIN IN PLACE THROUGHOUT THE DURATION OF CONSTRUCTION.
3. THIS WORK SHALL BE INCLUDED IN THE COST PER LUMP SUM FOR TRAFFIC CONTROL AND PROTECTION (EXPRESSWAYS).

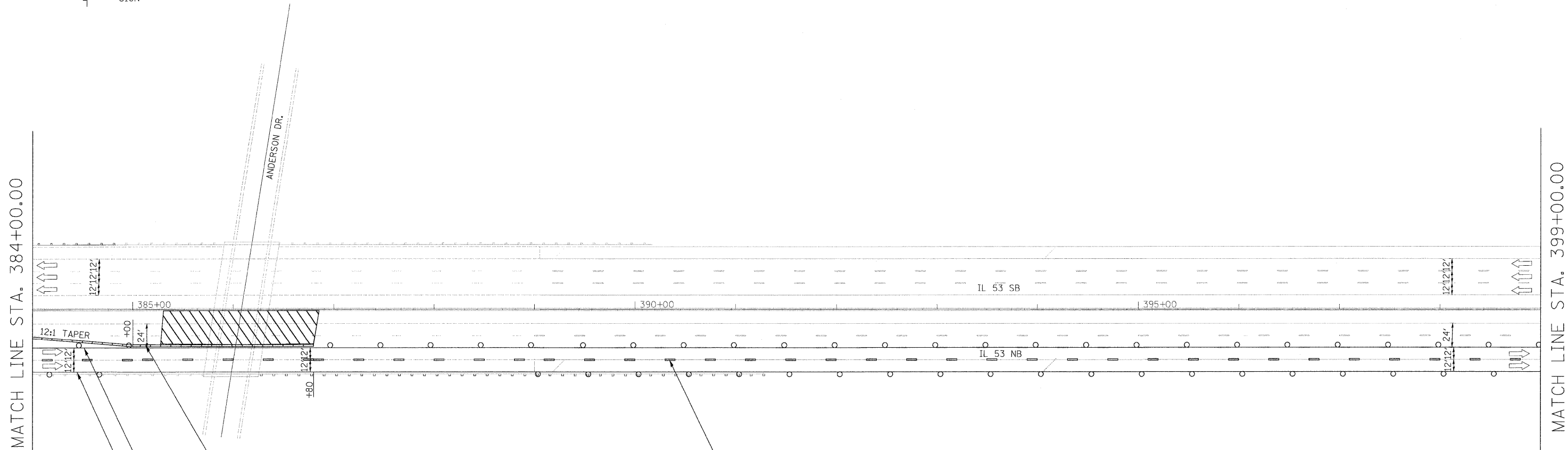

TEMPORARY CONCRETE BARRIER  
 PAVEMENT MARKING TAPE, TYPE III - LINE 4" (SOLID YELLOW)  
 PAVEMENT MARKING TAPE, TYPE III - LINE 4" (SOLID WHITE)

WET REFLECTIVE TEMPORARY TAPE, TYPE III - LINE 5" (SKIP-DASH WHITE)

**STAGE II REMOVAL & CONSTRUCTION (LOOKING NORTH)**

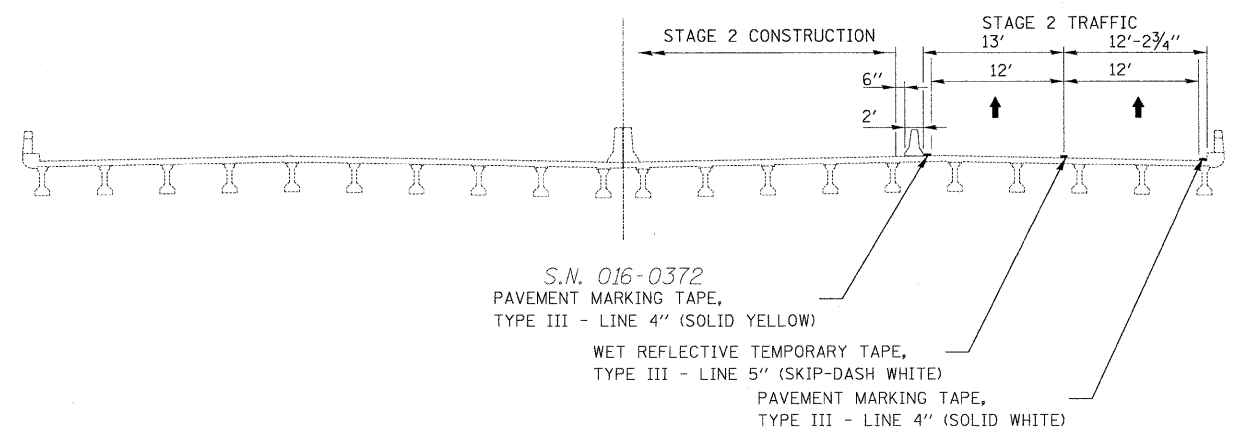

S.N. 016-0372  
 PAVEMENT MARKING TAPE, TYPE III - LINE 4" (SOLID YELLOW)

WET REFLECTIVE TEMPORARY TAPE, TYPE III - LINE 5" (SKIP-DASH WHITE)  
 PAVEMENT MARKING TAPE, TYPE III - LINE 4" (SOLID WHITE)

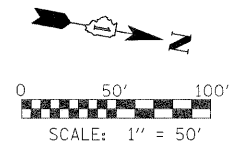

**NOTE:**  
 1. VERTICAL PANELS TO BE PLACED EVERY 100' (CURVED SECTION) OR 200' (TANGENT SECTION) ON THE OUTSIDE SHOULDER WHERE THERE IS NO GUARD RAIL OR BARRIER PRESENT.

FILE NAME =	USER NAME = #USER#	DESIGNED - CRV	REVISED -	<b>STATE OF ILLINOIS DEPARTMENT OF TRANSPORTATION</b>	<b>MAINTENANCE OF TRAFFIC PLAN STAGE 2 - NB</b>			F.A.I. RTE.	SECTION	COUNTY	TOTAL SHEETS	SHEET NO.
#FILE#		DRAWN - CRV	REVISED -		SCALE: 1"=50'	SHEET NO. 21 OF 24 SHEETS	STA. 384+00 TO STA. 399+00	290	(531-3.1, 0305-302 K) RS-5	COOK	314	113
		CHECKED - FML	REVISED -					CONTRACT NO. 60138				
		PLOT DATE = #DATE#	DATE - 12/2009	REVISED -								FED. ROAD DIST. NO. ILLINOIS FED. AID PROJECT