







**LEGEND**

-  WORK AREA
-  IMPACT ATTENUATORS, TEMPORARY (FULLY REDIRECTIVE, NARROW), TEST LEVEL 3
-  TYPE III BARRICADE
-  TEMPORARY CONCRETE BARRIER
-  DRUM WITH STEADY BURN MONODIRECTIONAL LIGHT / DIRECTION INDICATOR BARRICADE WITH STEADY BURN MONODIRECTIONAL LIGHT (PER HWY. STD. 701401-05)
-  SIGN

**STAGING NOTES:**

1. REMOVE EXISTING SHOULDER RUMBLE STRIPS, CONFLICTING EXISTING PAVEMENT MARKINGS, AND EXISTING RAISED REFLECTIVE PAVEMENT MARKER LENSES, AND PLACE TEMPORARY PAVEMENT MARKINGS IN ACCORDANCE WITH HIGHWAY STANDARD 701411-05 AND AS SHOWN BELOW.
2. TEMPORARY TRAFFIC CONFIGURATION TO REMAIN IN PLACE THROUGHOUT THE DURATION OF CONSTRUCTION.
3. THIS WORK SHALL BE INCLUDED IN THE COST PER LUMP SUM FOR TRAFFIC CONTROL AND PROTECTION (EXPRESSWAYS).

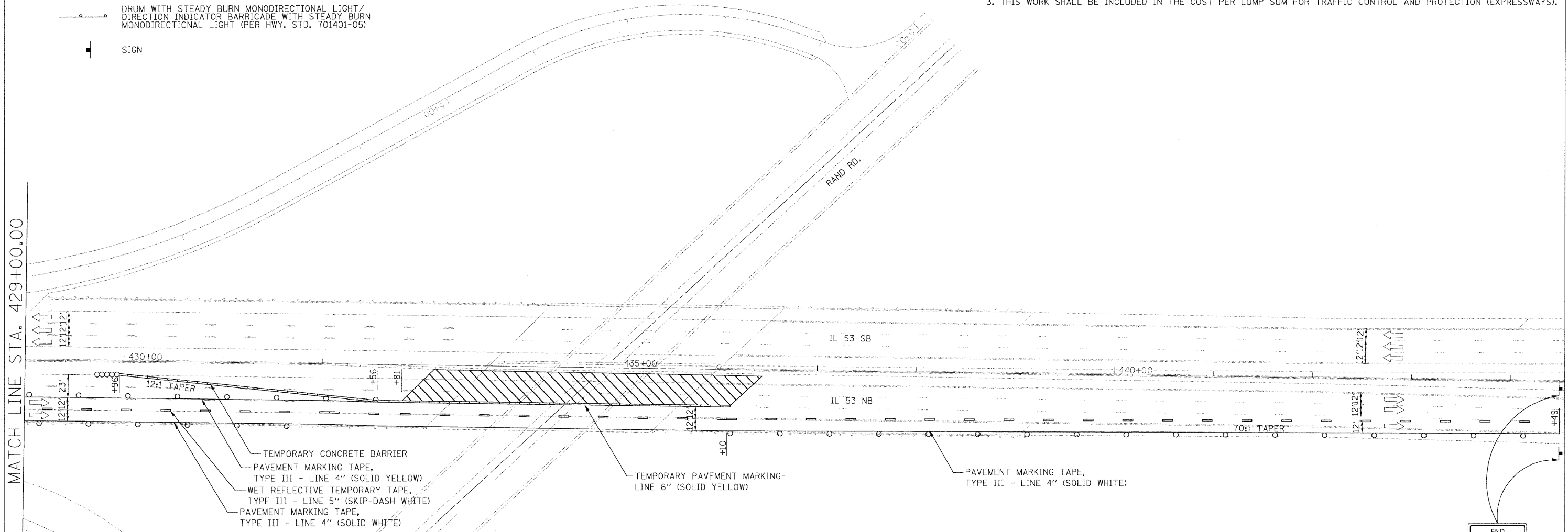

**STAGE II REMOVAL & CONSTRUCTION (LOOKING NORTH)**  
 S.N. 016-0371      S.N. 016-0973

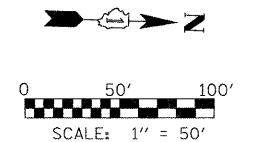
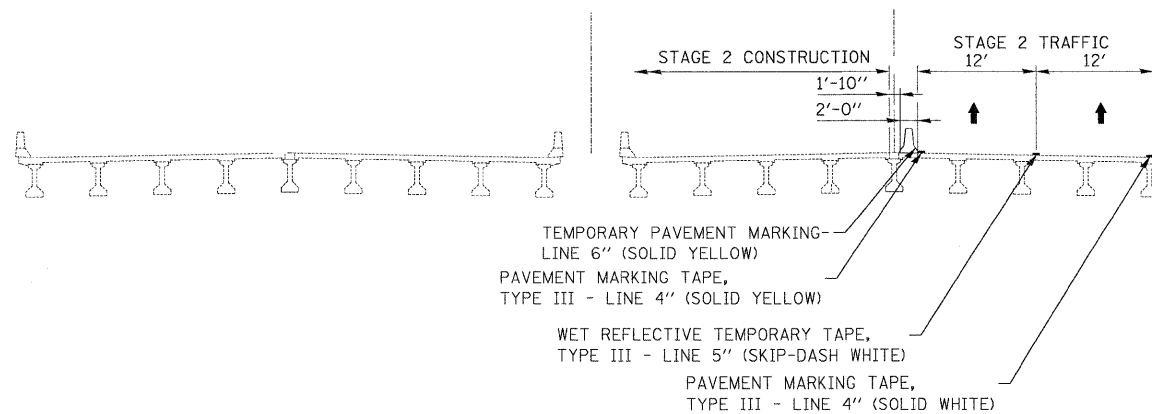

**NOTE:**  
 1. VERTICAL PANELS TO BE PLACED EVERY 100' (CURVED SECTION) OR 200' (TANGENT SECTION) ON THE OUTSIDE SHOULDER WHERE THERE IS NO GUARD RAIL OR BARRIER PRESENT.

|             |                      |                |           |
|-------------|----------------------|----------------|-----------|
| FILE NAME = | USER NAME = #USER#   | DESIGNED - CRV | REVISED - |
| #FILE#      |                      | DRAWN - CRV    | REVISED - |
|             | PLOT SCALE = #SCALE# | CHECKED - FML  | REVISED - |
|             | PLOT DATE = #DATE#   | DATE - 12/2009 | REVISED - |

**STATE OF ILLINOIS  
 DEPARTMENT OF TRANSPORTATION**

**MAINTENANCE OF TRAFFIC PLAN  
 STAGE 2 - NB**

SCALE: 1"=50'      SHEET NO. 24 OF 24 SHEETS      STA. 429+00 TO STA. 444+49

|   |                            |        |                    |           |
|---|----------------------------|--------|--------------------|-----------|
| F.A.I. RTE.                                   | SECTION                    | COUNTY | TOTAL SHEETS       | SHEET NO. |
| 290   | (531-3.1, 0305-302 K) RS-5 | COOK   | 34                 | 116       |
| FED. ROAD DIST. NO. ILLINOIS FED. AID PROJECT |                            |        | CONTRACT NO. 60138 |           |