

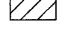

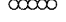
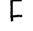

LEGEND

-  WORK AREA
-  IMPACT ATTENUATORS, TEMPORARY (FULLY REDIRECTIVE, NARROW), TEST LEVEL 3
-  TYPE III BARRICADE
-  TEMPORARY CONCRETE BARRIER
-  DRUM WITH STEADY BURN MONODIRECTIONAL LIGHT/DIRECTION INDICATOR BARRICADE WITH STEADY BURN MONODIRECTIONAL LIGHT (PER HWY. STD. 701401-05)
-  SIGN

**STAGE II REMOVAL & CONSTRUCTION
(LOOKING NORTH)**

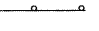
S.N. 016-1121

S.N. 016-0376

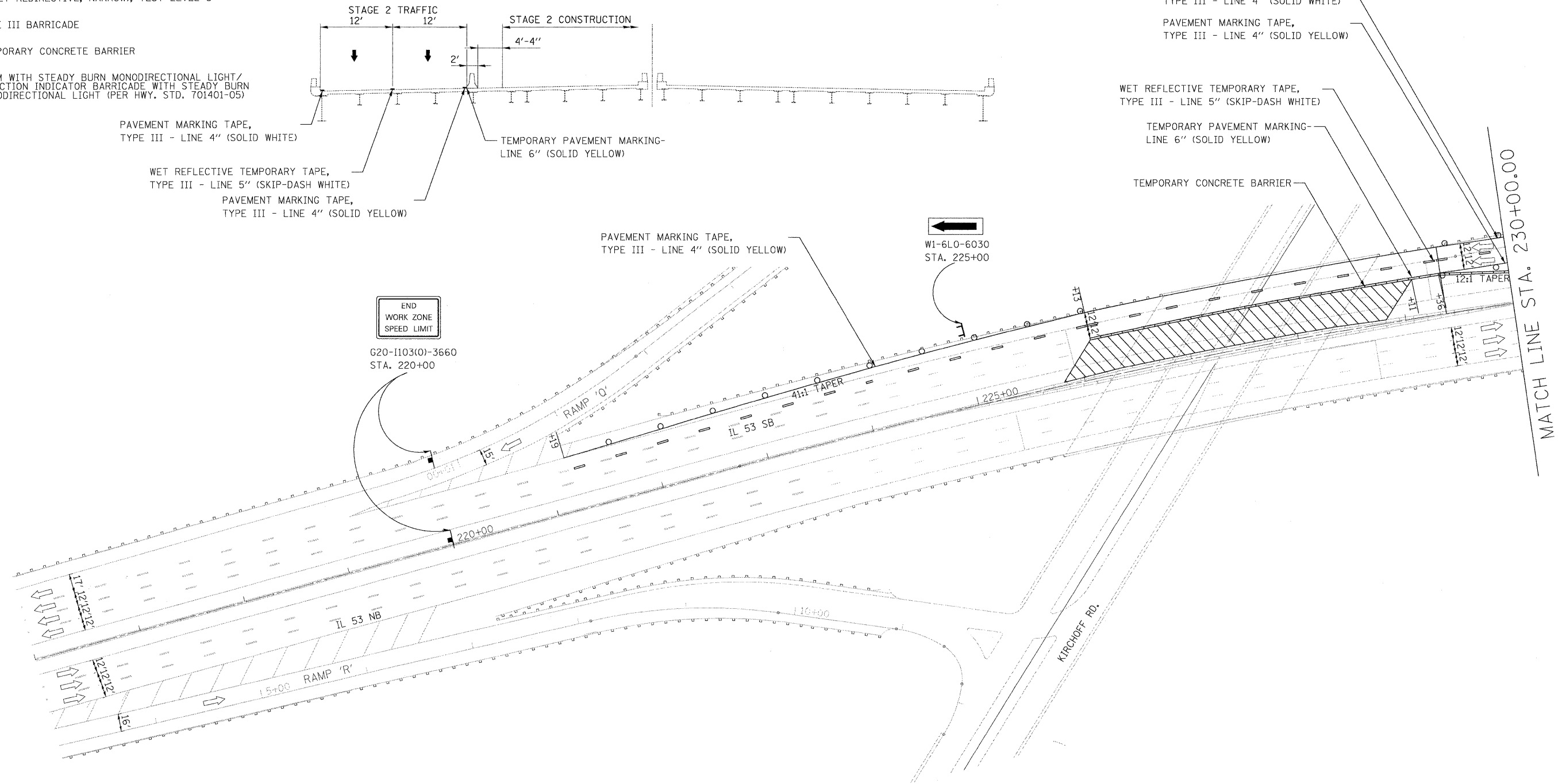

NOTE:
1. VERTICAL PANELS TO BE PLACED EVERY 100' (CURVED SECTION) OR 200' (TANGENT SECTION) ON THE OUTSIDE SHOULDER WHERE THERE IS NO GUARD RAIL OR BARRIER PRESENT.

- STAGING NOTES:**
1. REMOVE EXISTING SHOULDER RUMBLE STRIPS, CONFLICTING EXISTING PAVEMENT MARKINGS, AND EXISTING RAISED REFLECTIVE PAVEMENT MARKER LENSES, AND PLACE TEMPORARY PAVEMENT MARKINGS IN ACCORDANCE WITH HIGHWAY STANDARD 701411-05 AND AS SHOWN BELOW.
 2. TEMPORARY TRAFFIC CONFIGURATION TO REMAIN IN PLACE THROUGHOUT THE DURATION OF CONSTRUCTION.
 3. THIS WORK SHALL BE INCLUDED IN THE COST PER LUMP SUM FOR TRAFFIC CONTROL AND PROTECTION (EXPRESSWAYS).

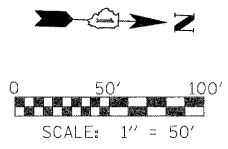

FILE NAME =	USER NAME = #USER#	DESIGNED - CRV	REVISED -
#FILE#		DRAWN - CRV	REVISED -
	PLOT SCALE = #SCALE#	CHECKED - FML	REVISED -
	PLOT DATE = #DATE#	DATE - 12/2009	REVISED -

**STATE OF ILLINOIS
DEPARTMENT OF TRANSPORTATION**

MAINTENANCE OF TRAFFIC PLAN STAGE 2 - SB		
SCALE: 1"=50'	SHEET NO. 4 OF 21 SHEETS	STA. 216+00 TO STA. 230+00

F.A.I. RTE.	SECTION	COUNTY	TOTAL SHEETS	SHEET NO.
290	(531-3.1, 0305-302 K) RS-5	COOK	314	120
FED. ROAD DIST. NO. ILLINOIS FED. AID PROJECT			CONTRACT NO. 60138	