

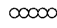

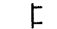

LEGEND

-  WORK AREA
-  IMPACT ATTENUATORS, TEMPORARY (FULLY REDIRECTIVE, NARROW), TEST LEVEL 3
-  TYPE III BARRICADE
-  TEMPORARY CONCRETE BARRIER
-  DRUM WITH STEADY BURN MONODIRECTIONAL LIGHT / DIRECTION INDICATOR BARRICADE WITH STEADY BURN MONODIRECTIONAL LIGHT (PER HWY. STD. 701401-05)
-  SIGN

STAGE II REMOVAL & CONSTRUCTION
(LOOKING NORTH)
@ FAI ROUTE 290

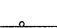
S.N. 016-1119

S.N. 016-0374

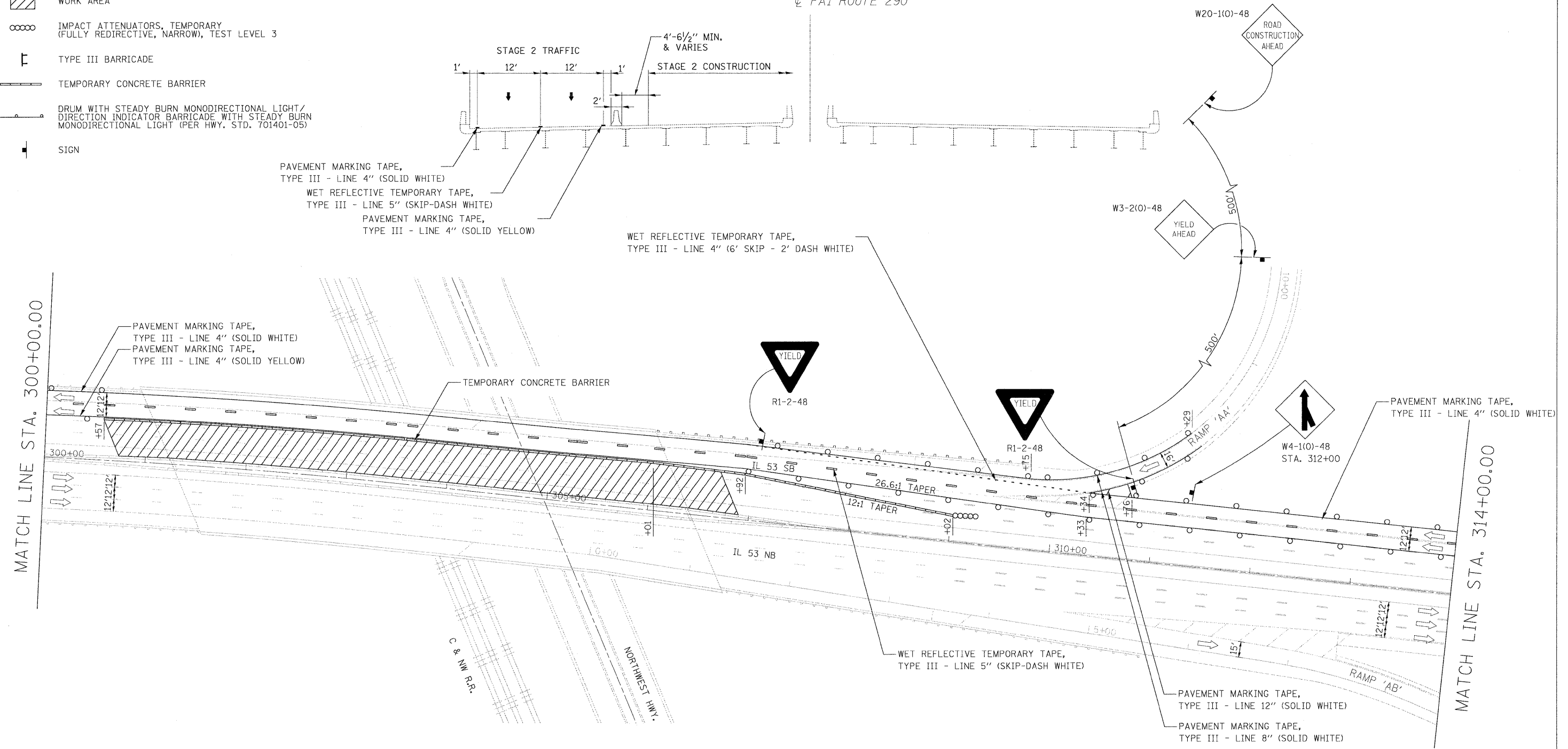

PAVEMENT MARKING TAPE,
TYPE III - LINE 4" (SOLID WHITE)
WET REFLECTIVE TEMPORARY TAPE,
TYPE III - LINE 5" (SKIP-DASH WHITE)
PAVEMENT MARKING TAPE,
TYPE III - LINE 4" (SOLID YELLOW)

WET REFLECTIVE TEMPORARY TAPE,
TYPE III - LINE 4" (6' SKIP - 2' DASH WHITE)

PAVEMENT MARKING TAPE,
TYPE III - LINE 4" (SOLID WHITE)
PAVEMENT MARKING TAPE,
TYPE III - LINE 4" (SOLID YELLOW)

PAVEMENT MARKING TAPE,
TYPE III - LINE 4" (SOLID WHITE)

WET REFLECTIVE TEMPORARY TAPE,
TYPE III - LINE 5" (SKIP-DASH WHITE)

PAVEMENT MARKING TAPE,
TYPE III - LINE 12" (SOLID WHITE)

PAVEMENT MARKING TAPE,
TYPE III - LINE 8" (SOLID WHITE)

STAGING NOTES:

1. REMOVE EXISTING SHOULDER RUMBLE STRIPS, CONFLICTING EXISTING PAVEMENT MARKINGS, AND EXISTING RAISED REFLECTIVE PAVEMENT MARKER LENSES, AND PLACE TEMPORARY PAVEMENT MARKINGS IN ACCORDANCE WITH HIGHWAY STANDARD 701411-05 AND AS SHOWN BELOW.
2. TEMPORARY TRAFFIC CONFIGURATION TO REMAIN IN PLACE THROUGHOUT THE DURATION OF CONSTRUCTION.
3. THIS WORK SHALL BE INCLUDED IN THE COST PER LUMP SUM FOR TRAFFIC CONTROL AND PROTECTION (EXPRESSWAYS).

NOTE:

1. VERTICAL PANELS TO BE PLACED EVERY 100' (CURVED SECTION) OR 200' (TANGENT SECTION) ON THE OUTSIDE SHOULDER WHERE THERE IS NO GUARD RAIL OR BARRIER PRESENT.

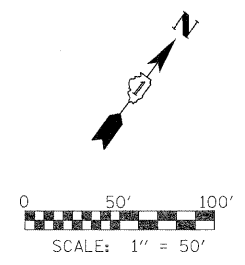

| | | | | | | | | | | | |
|-------------|----------------------|----------------|-----------|---|---|---|----------------------------|--------|--------------|-----------|--|
| FILE NAME = | USER NAME = #USER# | DESIGNED - CRV | REVISED - | STATE OF ILLINOIS DEPARTMENT OF TRANSPORTATION | MAINTENANCE OF TRAFFIC PLAN STAGE 2 - SB | F.A.I. RTE. | SECTION | COUNTY | TOTAL SHEETS | SHEET NO. | |
| #FILE# | | DRAWN - CRV | REVISED - | | | 290 | (531-3.1, 0305-302 K) RS-5 | COOK | 314 | 126 | |
| | PLOT SCALE = #SCALE# | CHECKED - FML | REVISED - | | | CONTRACT NO. 60138 | | | | | |
| | PLOT DATE = #DATE# | DATE - 12/2009 | REVISED - | | | FED. ROAD DIST. NO. ILLINOIS FED. AID PROJECT | | | | | |
| | | | | | SCALE: 1"=50' | SHEET NO. 10 OF 21 SHEETS | STA. 300+00 TO STA. 314+00 | | | | |