

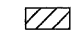

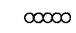

**LEGEND**

-  WORK AREA
-  IMPACT ATTENUATORS, TEMPORARY (FULLY REDIRECTIVE, NARROW), TEST LEVEL 3
-  TYPE III BARRICADE
-  TEMPORARY CONCRETE BARRIER
-  DRUM WITH STEADY BURN MONODIRECTIONAL LIGHT / DIRECTION INDICATOR BARRICADE WITH STEADY BURN MONODIRECTIONAL LIGHT (PER HWY. STD. 701401-05)
-  SIGN

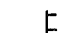

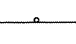
**NOTE:**  
 1. VERTICAL PANELS TO BE PLACED EVERY 100' (CURVED SECTION) OR 200' (TANGENT SECTION) ON THE OUTSIDE SHOULDER WHERE THERE IS NO GUARD RAIL OR BARRIER PRESENT.

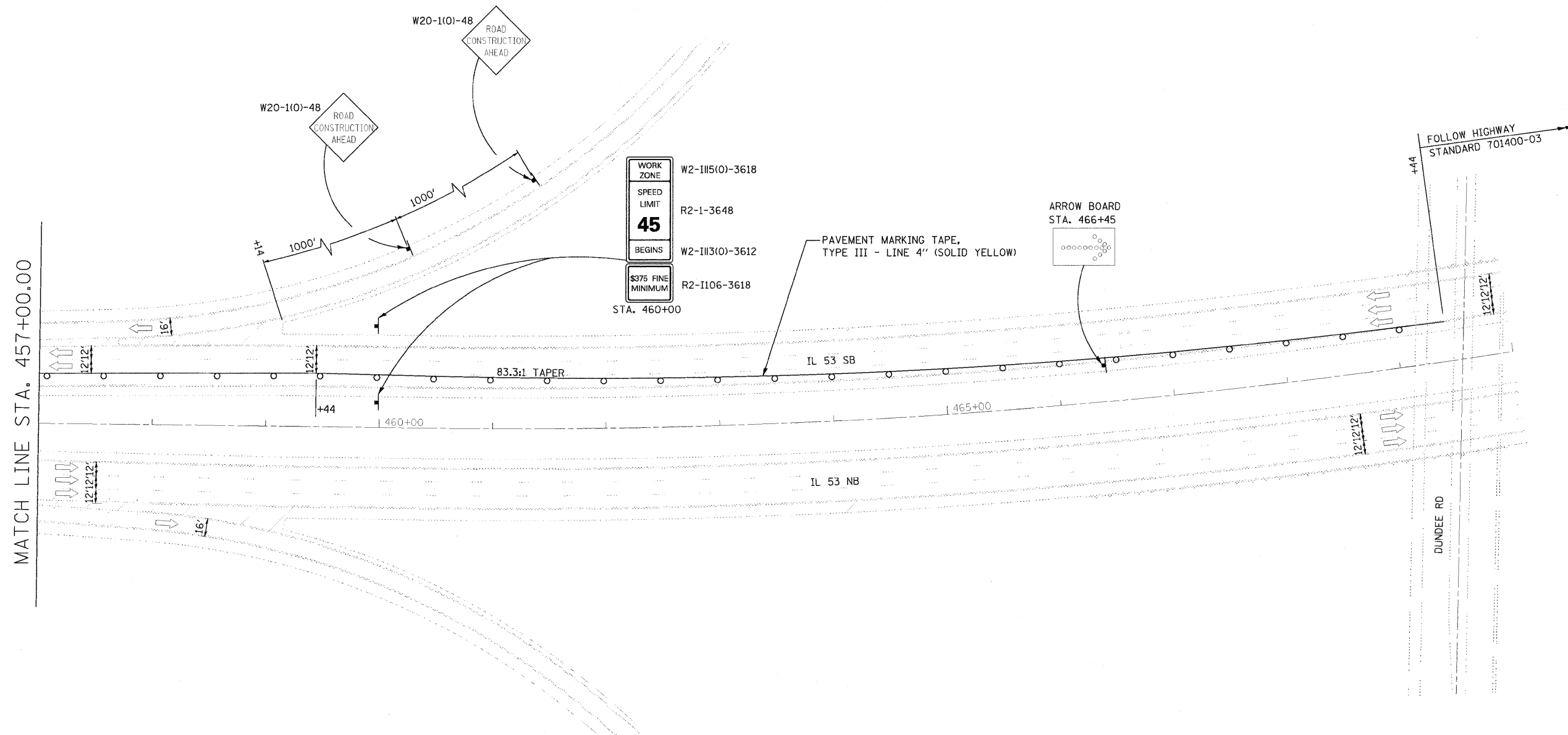
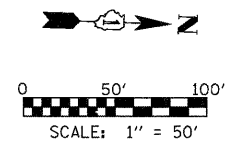

FILE NAME = #FILE#	USER NAME = #USER#	DESIGNED - CRV	REVISED -	<b>STATE OF ILLINOIS DEPARTMENT OF TRANSPORTATION</b>	<b>MAINTENANCE OF TRAFFIC PLAN STAGE 2 - SB</b>			F.A.I. RTE. 290	SECTION (531-3.1, 0305-302 K) RS-5	COUNTY COOK	TOTAL SHEETS 31	SHEET NO. 137
	PLOT SCALE = #SCALE#	CHECKED - FML	REVISED -		SCALE: 1"=50'	SHEET NO. 21 OF 21 SHEETS	STA. 457+00 TO STA. 470+00	CONTRACT NO. 60138				
	PLOT DATE = #DATE#	DATE - 12/2009	REVISED -		FED. ROAD DIST. NO.   ILLINOIS FED. AID PROJECT							