

STATE OF ILLINOIS  
DEPARTMENT OF TRANSPORTATION

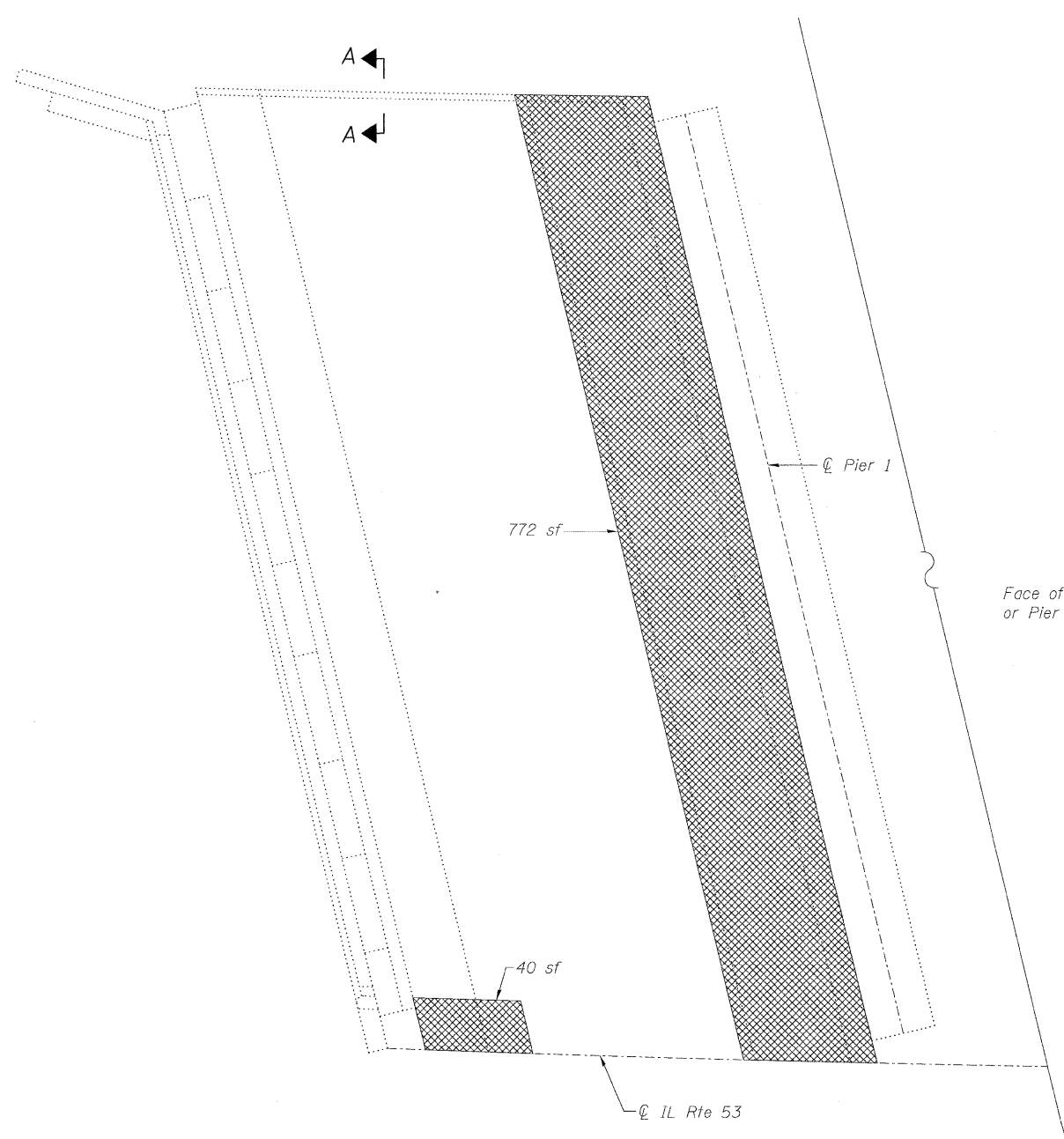

SOUTH SLOPE WALL

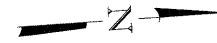
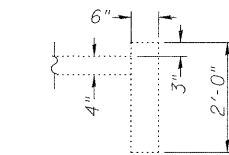

SECTION A-A

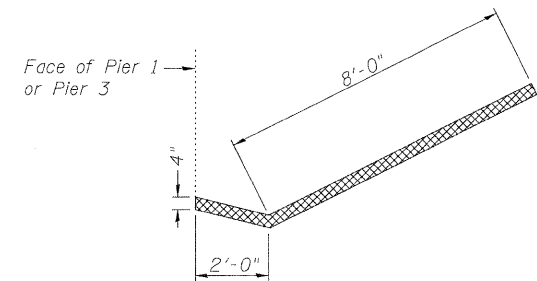

TOE OF SLOPE REMOVAL DETAILS

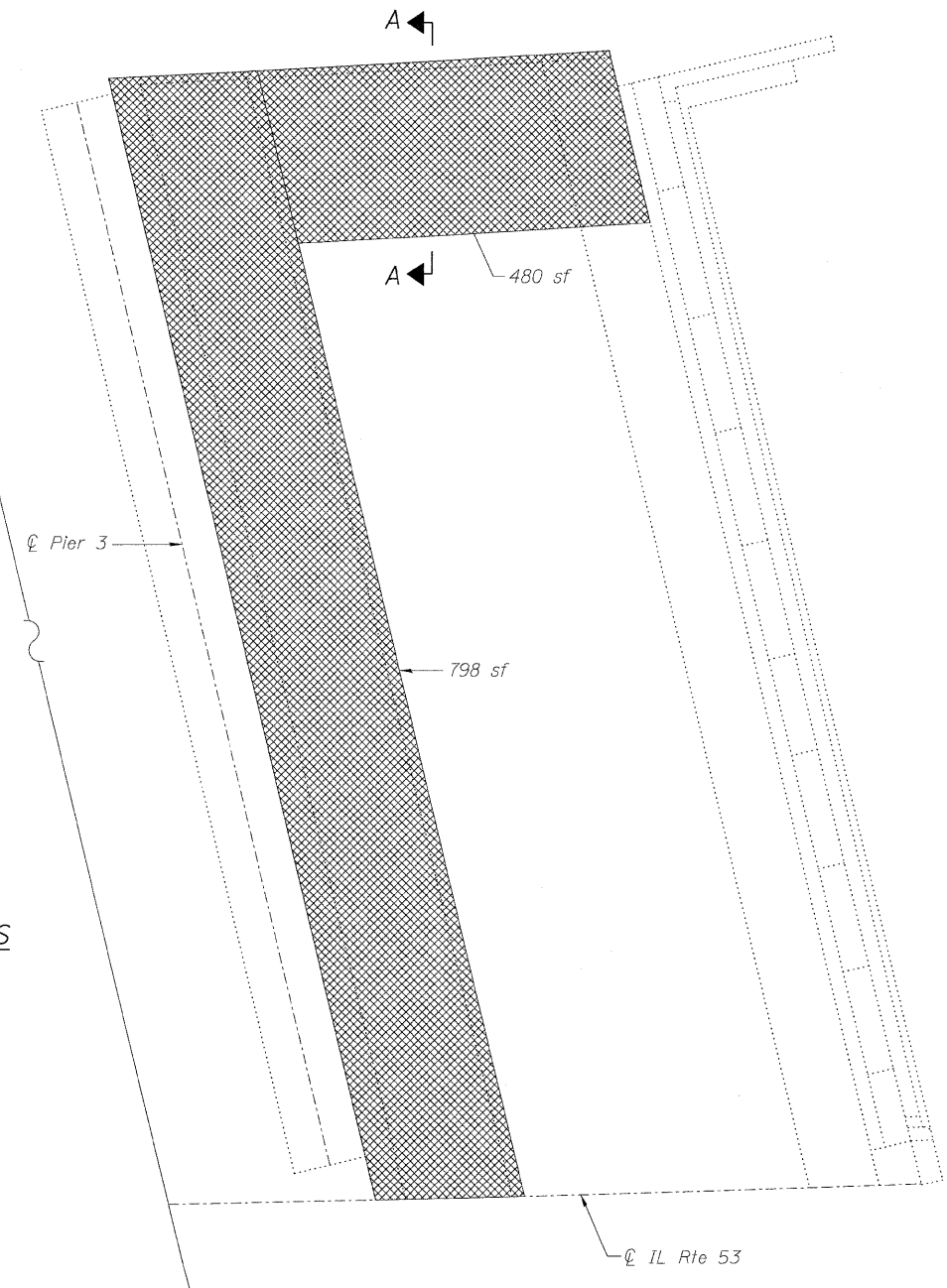

NORTH SLOPE WALL

**Note:**  
Sloped wall shall be reinforced with welded wire fabric, 6" x 6" - W4.0 x W4.0, weighing 58 lbs. per 100 sq. ft.  
Existing reinforcement shall be cleaned and incorporated into the new construction. Cost included with Slope Wall Removal.  
Existing and new welded wire fabric must be lapped at least 6".  
Repair of the existing slope walls shall include but may not be limited to the areas shown. The actual areas to be repaired will be determined by the Engineer at the time of construction.

**LEGEND**

Remove and Replace Slope Wall

sf Square Feet

**BILL OF MATERIAL**

| Item               | Unit    | Total |
|--------------------|---------|-------|
| Slope Wall Removal | Sq. Yd. | 233   |
| Slope Wall 4 inch  | Sq. Yd. | 233   |

**SLOPE WALL REPAIR  
STRUCTURE NO. 016-0970**

|   |             |                       |                         |          |                    |           |
|---|-------------|-----------------------|-------------------------|----------|--------------------|-----------|
| <br>LIN ENGINEERING, LTD.<br>Consulting Engineers<br>Chatham, Illinois<br><small>Designed By: KMH    Checked By: MTH    Drawn By: KMH<br/>Date: 12/2009    File: 016-0970.dgn</small> | SHEET NO. 8 | F.A.I. RTE.           | SECTION                 | COUNTY   | TOTAL SHEETS       | SHEET NO. |
|   | 8 SHEETS    | 290                   | (531-3.1,0305-302K)RS-5 | COOK     | 314                | 183       |
|   |             | FED. ROAD DIST. NO. _ |                         | ILLINOIS | FED. AID PROJECT   |           |
|   |             |                       |                         |          | CONTRACT NO. 60138 |           |